

**GENERAL NOTES**

1. EXISTING FIRE SPRINKLER SYSTEM TO REMAIN AND BE KEPT IN SERVICE DURING CONSTRUCTION. EXISTING SYSTEM SHALL BE MODIFIED TO ENSURE A FULLY CODE-COMPLIANT INSTALLATION WITH THE NEW SPACE LAYOUT.
2. EXISTING FIRE ALARM SYSTEM TO REMAIN AND BE KEPT IN SERVICE DURING CONSTRUCTION. EXISTING SYSTEM SHALL BE MODIFIED TO ENSURE A FULLY CODE-COMPLIANT INSTALLATION WITH THE NEW SPACE LAYOUT.
3. PORTABLE FIRE EXTINGUISHERS SHALL BE INSTALLED IN ACCORDANCE WITH IBC 2009 SECTION 906.1. PROVIDE PORTABLE FIRE EXTINGUISHERS FOR THE DURATION OF CONSTRUCTION.

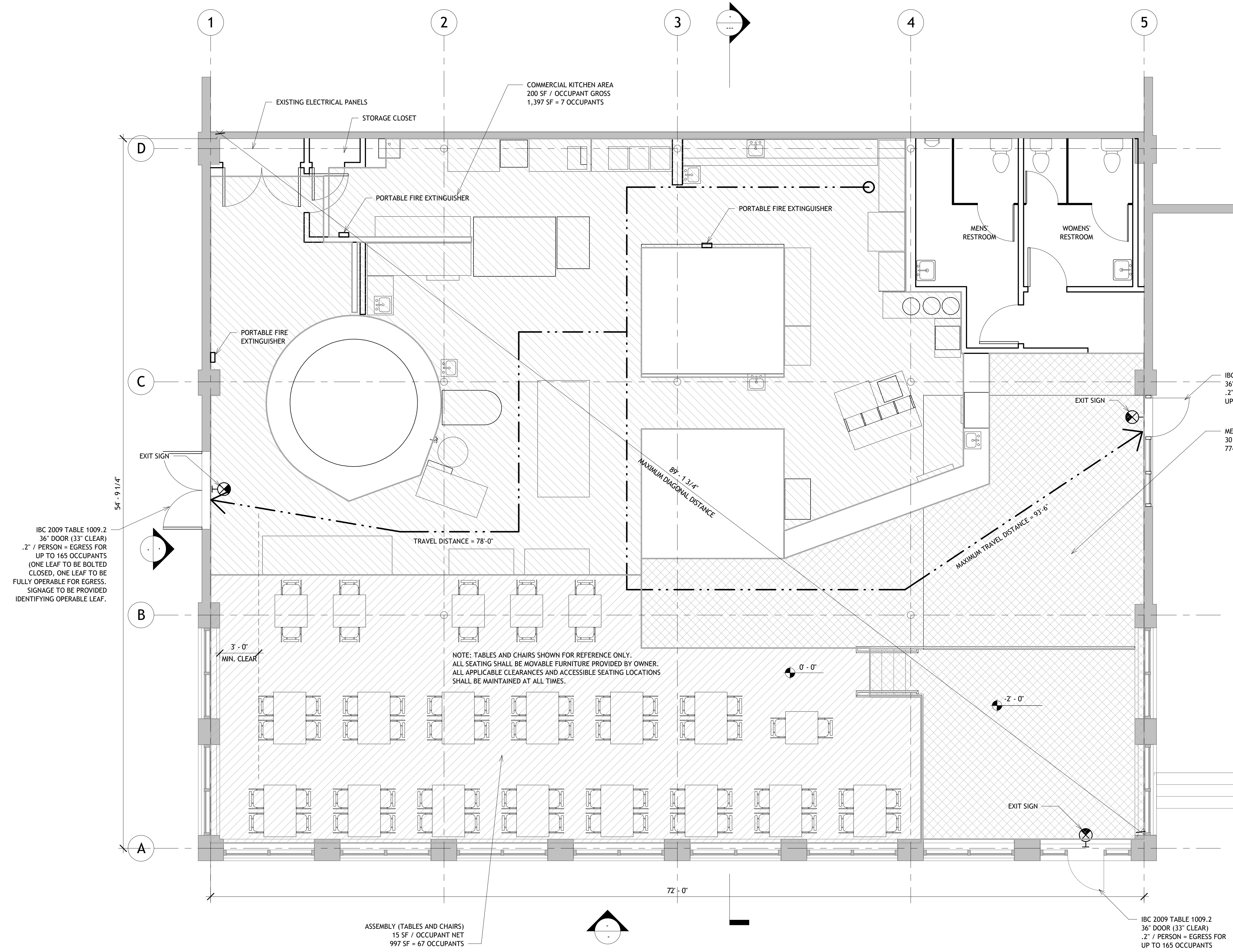

IBC 2009 TABLE 1009.2  
 36" DOOR (33" CLEAR)  
 .2' / PERSON = EGRESS FOR  
 UP TO 165 OCCUPANTS  
 (ONE LEAF TO BE BOLTED  
 CLOSED, ONE LEAF TO BE  
 FULLY OPERABLE FOR EGRESS.  
 SIGNAGE TO BE PROVIDED  
 IDENTIFYING OPERABLE LEAF.

IBC 2009 SECTION 1005.1  
 36" DOOR (33" CLEAR)  
 .2' / PERSON = EGRESS FOR  
 UP TO 165 OCCUPANTS

MERCANTILE / ORDERING AREA  
 30 SF / OCCUPANT GROSS  
 774 SF = 26 OCCUPANTS

ASSEMBLY (TABLES AND CHAIRS)  
 15 SF / OCCUPANT NET  
 997 SF = 67 OCCUPANTS

IBC 2009 TABLE 1009.2  
 36" DOOR (33" CLEAR)  
 .2' / PERSON = EGRESS FOR  
 UP TO 165 OCCUPANTS

**1 LIFE SAFETY FLOOR PLAN**  
 SCALE: 1/4" = 1'-0"

11/30/2017 10:14:37 PM

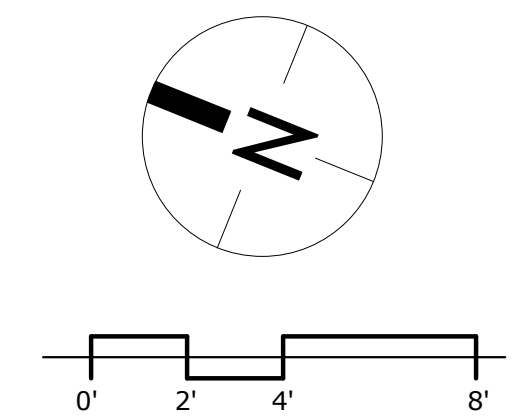

**FORAGE MARKET**

123 WASHINGTON AVE  
 PORTLAND, MAINE 04101

SEAL:



Project Status

ISSUE DATE:

REVISION DESCRIPTION DATE

REVISION	DESCRIPTION	DATE

**LIFE SAFETY PLAN**

**A-101**