

© 2016 RYAN SENATORE ARCHITECTURE

123 WASHINGTON
123 WASHINGTON AVENUE
PORTLAND, MAINE



RYAN SENATORE
ARCHITECTURE
565 CONGRESS STREET
PORTLAND, MAINE 04101
207-650-6414
senatorearchitecture.com

CONSULTANTS:

REVISIONS:
REVISION #1 - 03/08/17

DATE: JANUARY 13, 2017

PROJECT No. 1638

DRAWN BY: JPF

CHECKED BY: RJS

SCALE: AS NOTED

SHEET TITLE:
DETAILS

A5-1

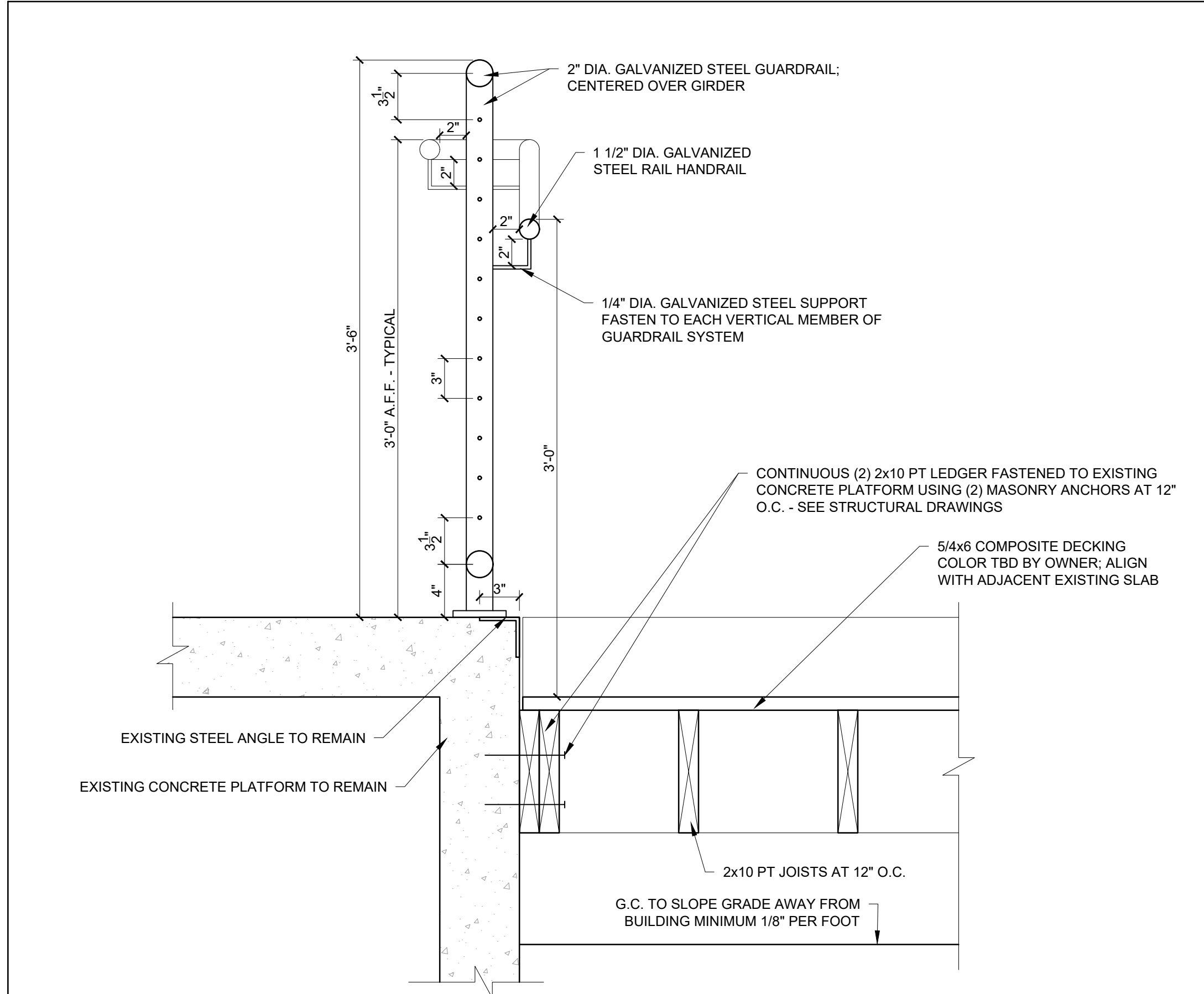

6 NEW DECK SECTION DETAIL @ EXISTING CONCRETE PLATFORM LOCATION
1/12" = 1'-0"

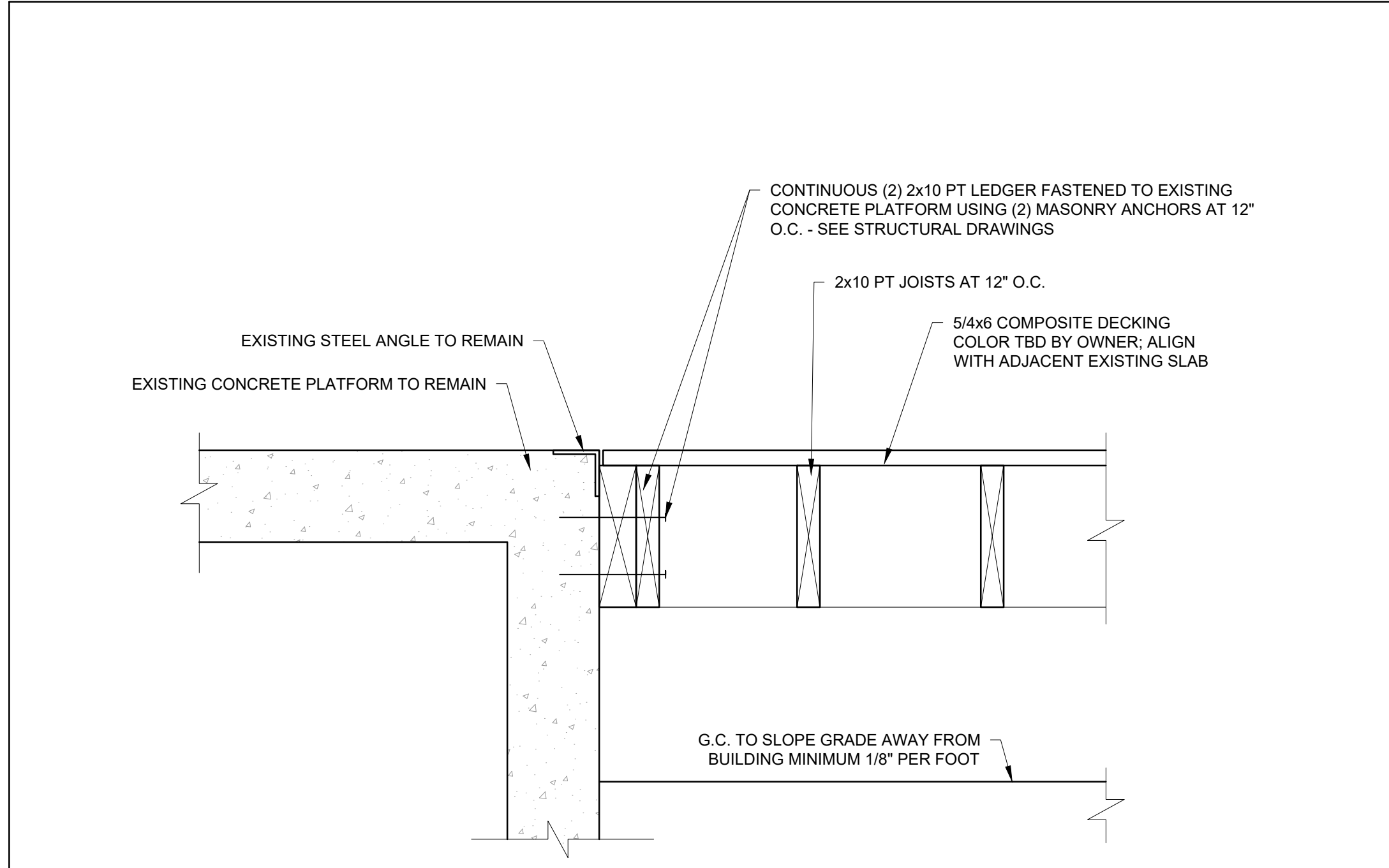

5 NEW DECK SECTION DETAIL @ EXISTING CONCRETE PLATFORM LOCATION
1/12" = 1'-0"

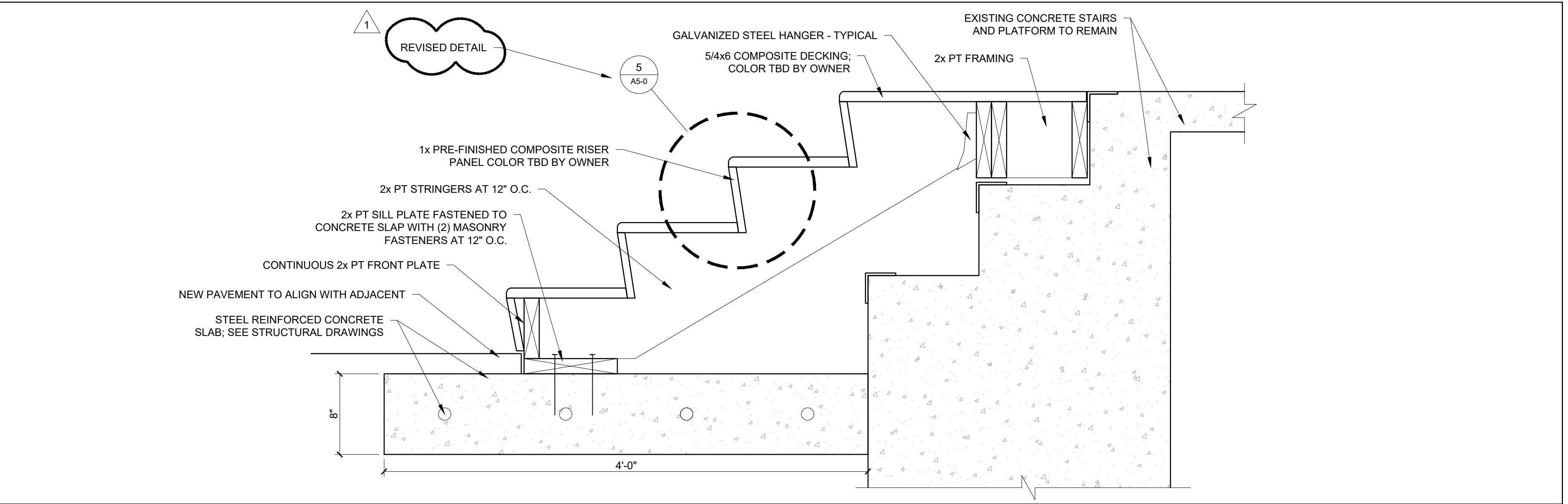

4 NEW FRAMED STAIR SECTION DETAIL
1/12" = 1'-0"

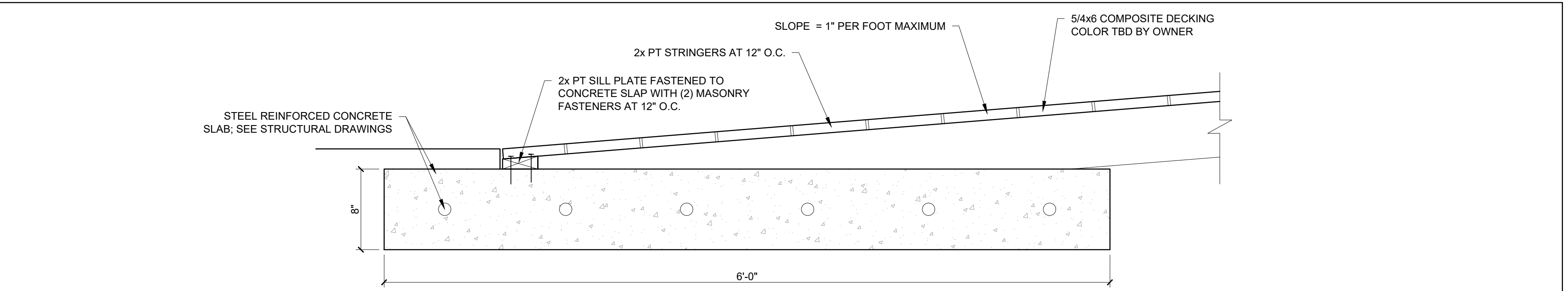

3 NEW ADA RAMP SECTION DETAIL
1/12" = 1'-0"

NOTE: SEE PLAN FOR HANDRAIL LOCATIONS

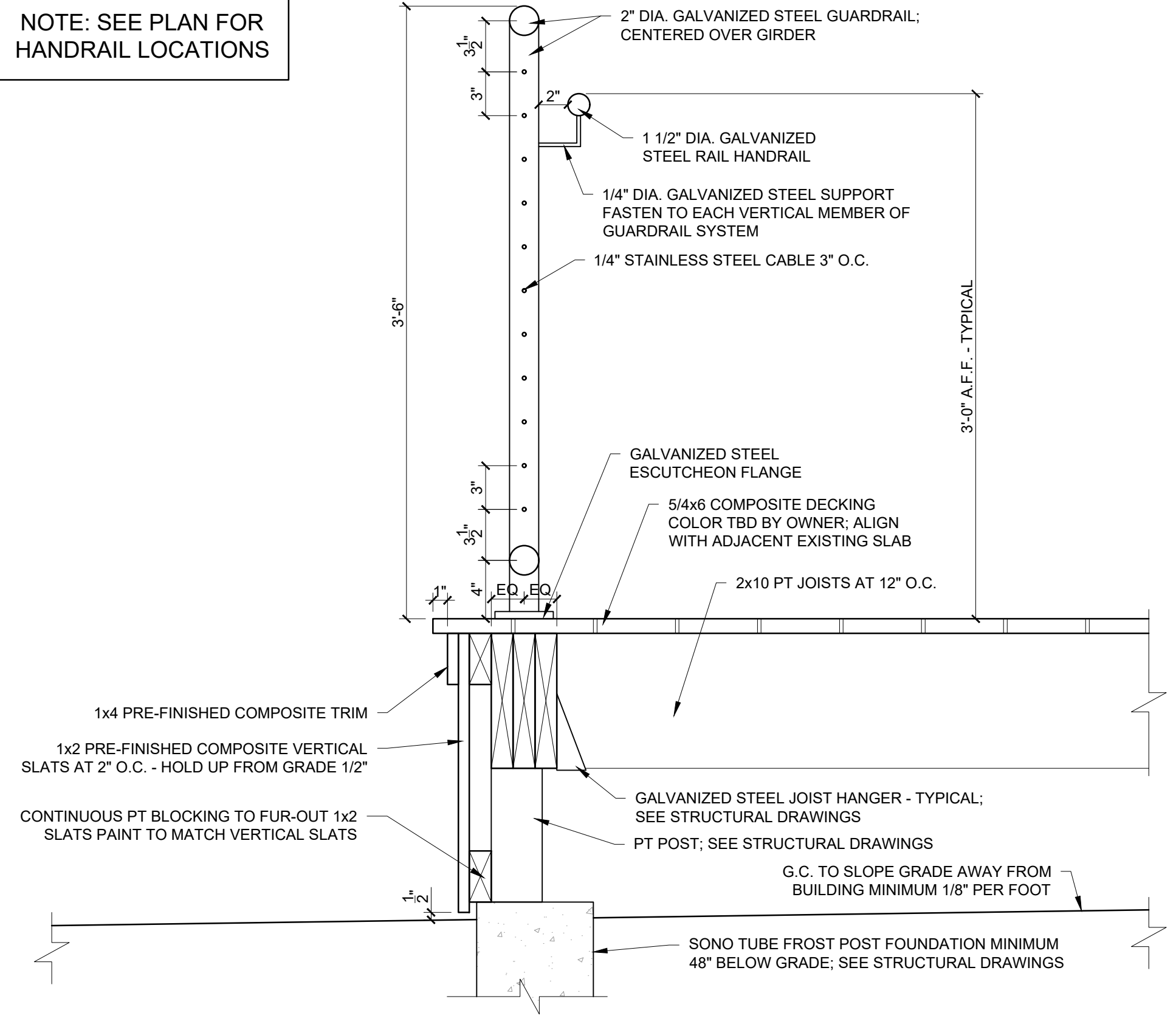

2 TYPICAL DECK AND GUARDRAIL SECTION DETAIL
1/12" = 1'-0"

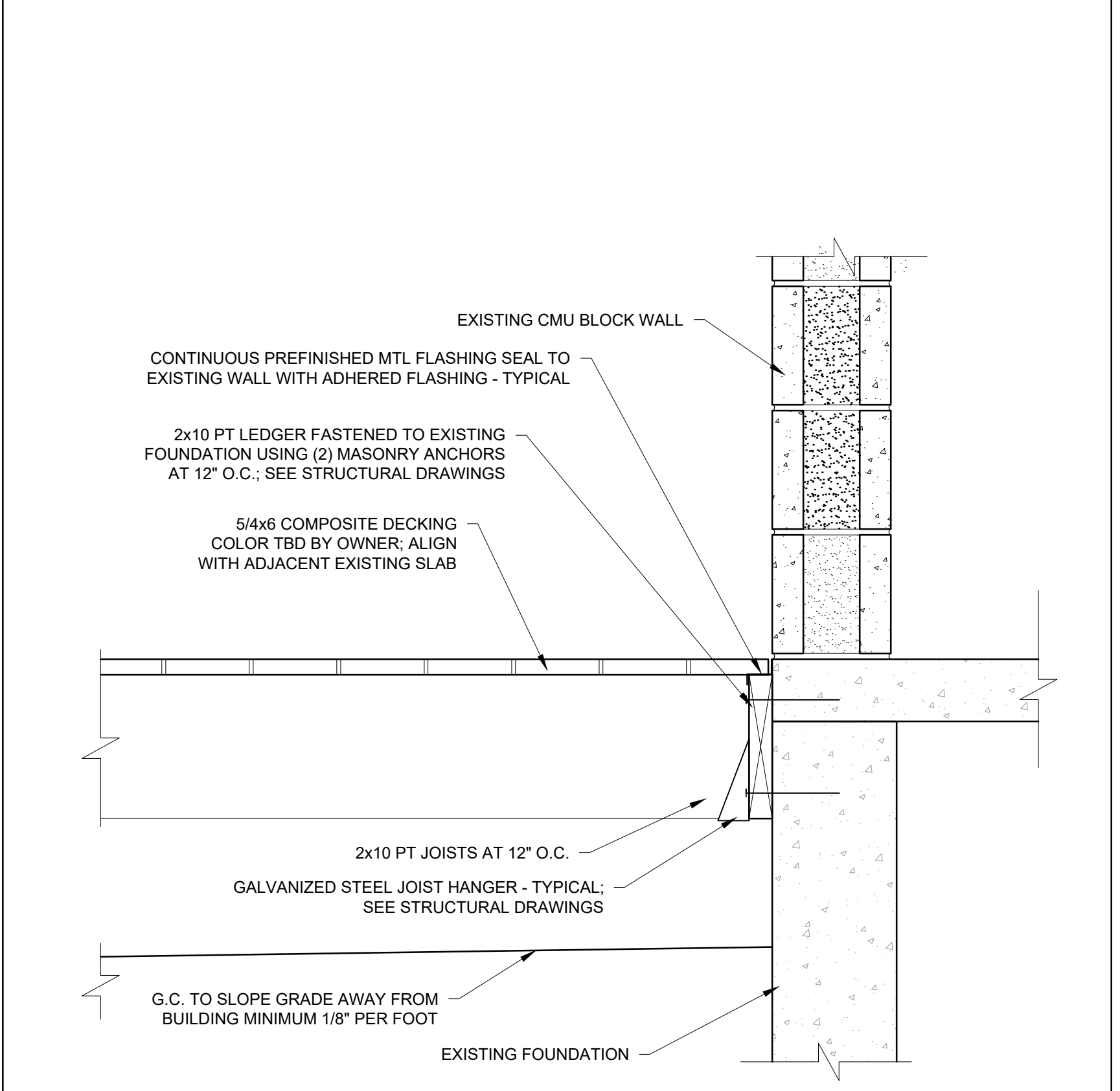

1 NEW DECK SECTION DETAIL @ EXISTING WALL LOCATION
1/12" = 1'-0"