

DEMO LEGEND	
[R-F]	REMOVE FLOORING
[R-C]	REMOVE CEILING
[---]	EXISTING WALL
[---]	DEMO WALL

- DEMO NOTES**
1. ALL HAZARDOUS MATERIALS TO BE REMOVED AND DISPOSED OF IN ACCORDANCE WITH ALL FEDERAL, STATE AND LOCAL REGULATIONS.
 2. IF ANY ELEMENTS TO BE REMOVED ARE FOUND TO BE STRUCTURAL, THE G.C. SHALL NOTIFY THE ARCHITECT IN WRITING PRIOR TO REMOVING SUCH ELEMENTS.
 3. REMOVE ALL UNUSED PLUMBING, ELECTRICAL, AND MECHANICAL ELEMENTS THAT ARE NOT PROPOSED TO BE REUSED.
 4. AT LOCATIONS OF FLOORING INDICATED TO BE REMOVED REMOVE ALL LAYERS OF FINISHED FLOORING, UNDERLAYMENT AND ADHESIVES DOWN TO SLAB OR SHEATHING.
 5. AT LOCATIONS OF CEILINGS INDICATED TO BE REMOVED REMOVE ALL CEILING TILES, GRIDS AND STRAPPING TO JOISTS OR FRAMING AS WELL AS ANY IN CEILING ELEMENTS NOT SCHEDULED TO BE REUSED.
 6. RELOCATE AND REINSTALL ANY AND ALL FUNCTIONING MECHANICAL, ELECTRICAL AND PLUMBING ELEMENTS LOCATED IN WALLS, FLOORS AND CEILINGS INDICATED TO BE REMOVED.
 7. REMOVE ALL WALL COVERINGS ON WALLS INDICATED TO BE REMOVED, REPAINTED OR RE COVERED.
 8. PATCH AND REPAIR ALL WALLS CEILINGS AND FLOORS AT LOCATIONS OF REMOVED INTERSECTING WALLS, REMOVED BUILDING, ETC.
 9. G.C. TO CONFIRM WITH STRUCTURAL ENGINEER BEFORE CUTTING SLAB.
 10. G.C. TO VERIFY EXISTING PLUMBING PIPE DEPTHS TO ENSURE NEW DRAIN LINE FROM BAR HAS ADEQUATE PITCH, PRIOR TO WORK.

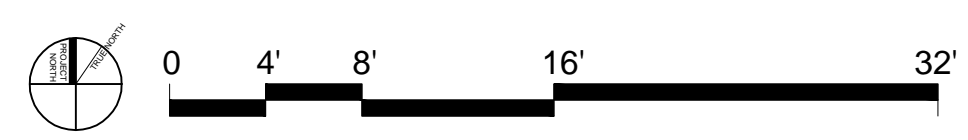

1 DEMOLITION FLOOR PLAN
1/8" = 1'-0"

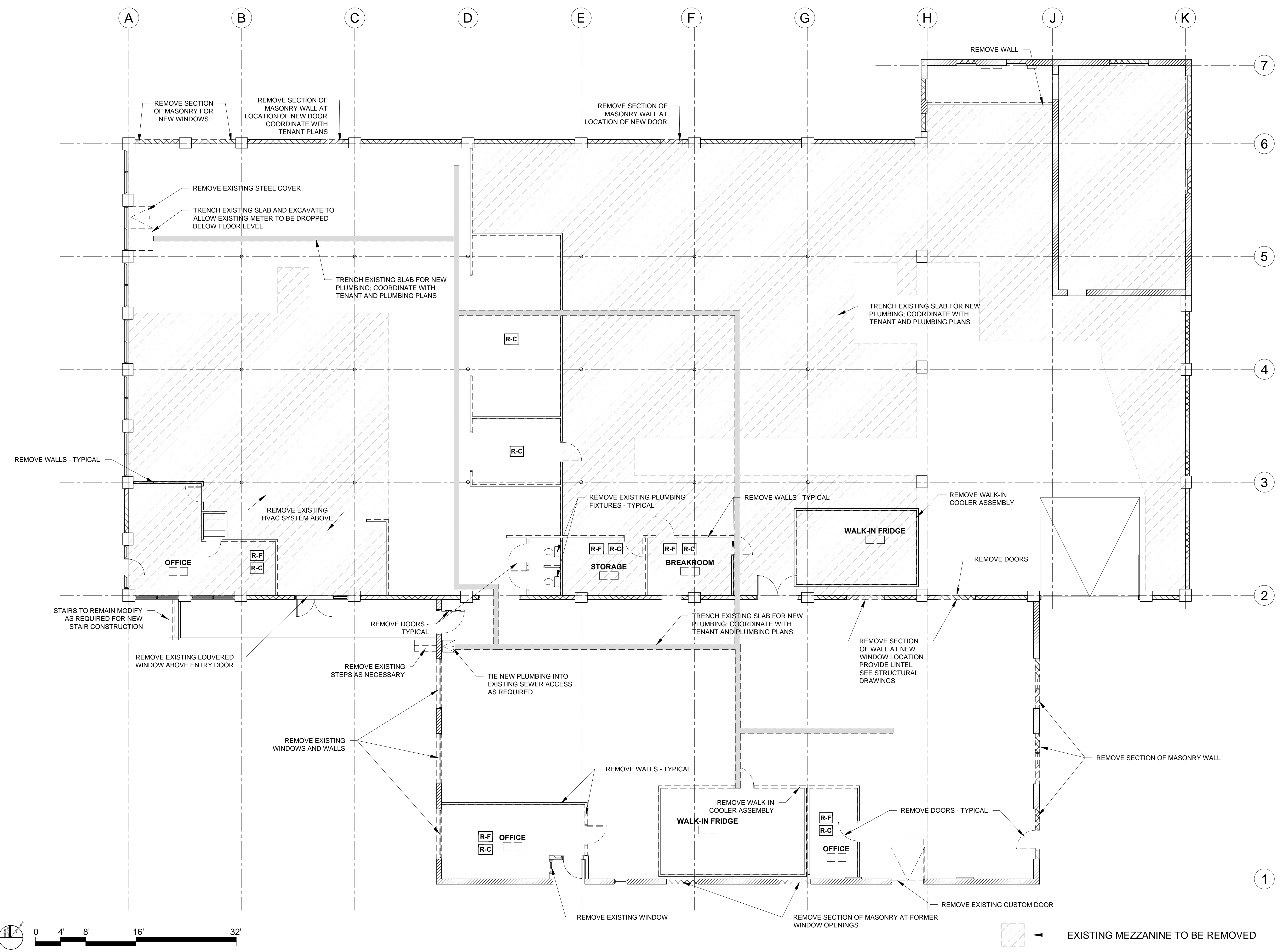

© 2016 RYAN SENATORE ARCHITECTURE

123 WASHINGTON
123 WASHINGTON AVENUE
PORTLAND, MAINE



RYAN SENATORE ARCHITECTURE
565 CONGRESS STREET
PORTLAND, MAINE 04101
207-650-6414
senatorearchitecture.com

CONSULTANTS:

REVISIONS:

DATE: DECEMBER 05, 2016

PROJECT No. 1638

DRAWN BY: JPF

CHECKED BY: RJS

SCALE: AS NOTED

SHEET TITLE:
DEMO FLOOR PLAN

AD1-0