

2 Hour

Design #

UL L505

GA File #

FC 5724**STC - N/A**

Sound Test # N/A

IIC - N/A

Test # N/A

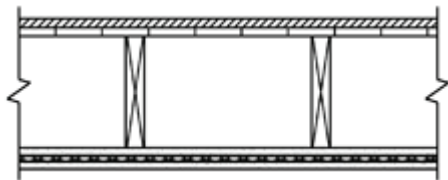
[Link to .PDF file](#)[Link to .DWG file](#)[Link to .DWG/Text file](#)

Base layer 5/8" (15.9 mm) Fire-Shield C Gypsum Board applied at right angles to 2x10 wood joists 16" o.c. with 8d nails, 2-1/2" long, 0.113" shank, 19/64" heads, 7" o.c. Resilient furring channels at 24" o.c. applied at right angles to wood joists through base layer with 8d nails, 2-1/2" long, 0.113" shank, 19/64" head, at each joist. Face layer 5/8" Fire-Shield C Gypsum Board applied at right angles to resilient furring channels with 1" type S drywall screws 12" o.c. Wood joists supporting 1" nominal T&G wood subfloor and 1" nominal wood finish floor, or 19/32" plywood finished floor with long edges T&G and 15/32" interior plywood with exterior glue subfloor perpendicular to joists with joints staggered.