

Abutting Setbacks For 89 Anderson Street: 2-19-2015

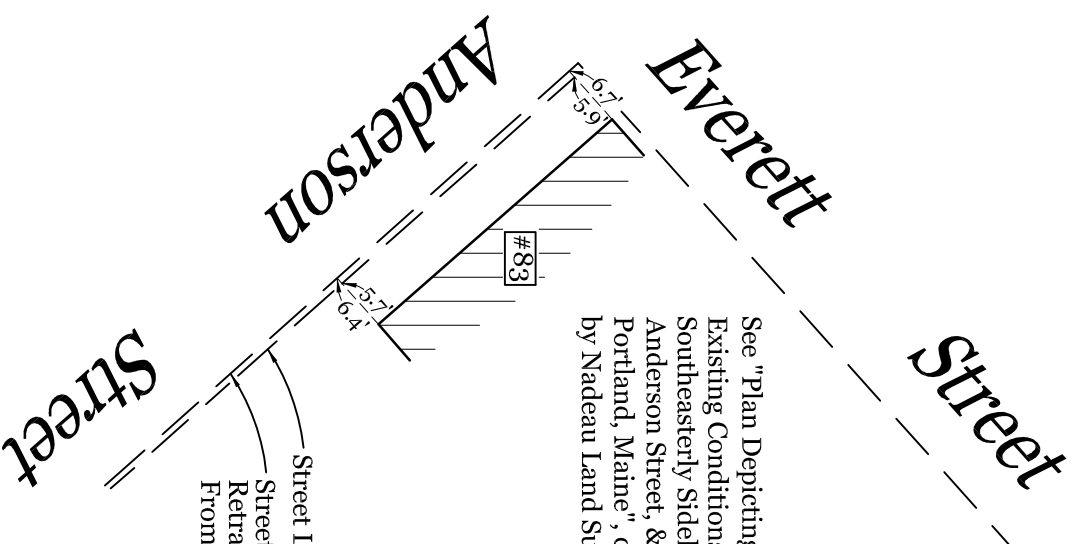
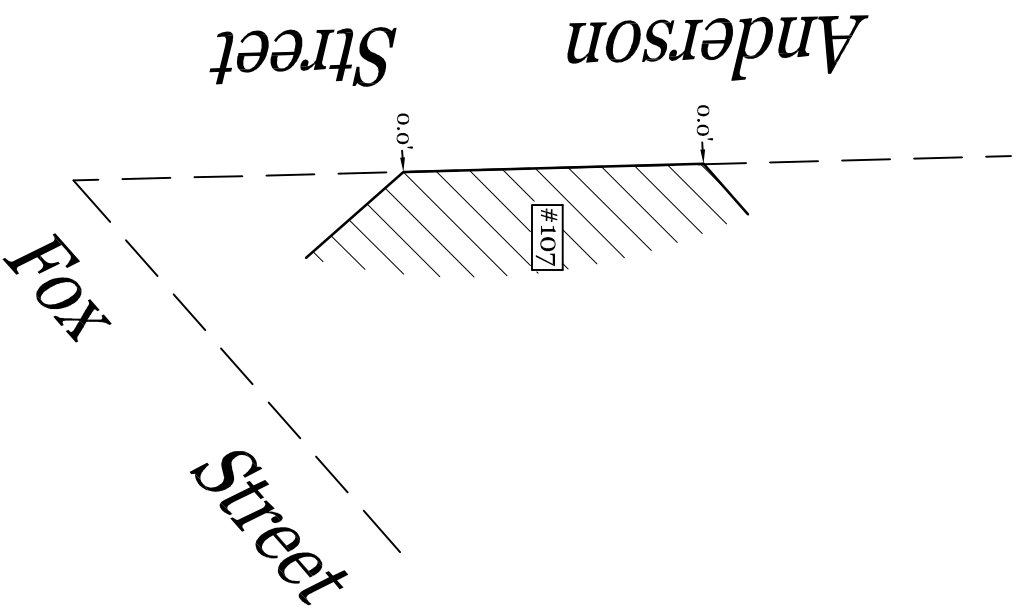

Street Line Per City's 4-1-2014
Retracement Plan (See 2-13-2015 Letter
From City Senior Surveyor Camille Alden)

See "Plan Depicting The Results Of A Boundary, Topographic & Existing Conditions Survey Made For Redfern Properties, LLC Southeasterly Sideline Of Fox Street, Northeasterly Sideline Of Anderson Street, & Northwesterly Sideline Of Everett Street Portland, Maine", dated July 21, 2014, revised September 9, 2014 by Nadeau Land Surveys, Portland, Maine.