

GENERAL NOTES:

- STORMWATER DRAINAGE INFRASTRUCTURE INDICATED ON SHEET C-30.
- LOCATION OF PROPOSED CONNECTIONS WITHIN ROAD CORRIDORS DETERMINED FROM SLOPE OF PIPE BETWEEN KNOWN INVERT LOCATIONS. CONTRACTOR TO CONTACT ENGINEER IF FIELD INFORMATION VARIES FROM INFORMATION ON PLANS.
- CONTRACTOR IS TO BE CAUTIONED THAT CERTAIN LOCATIONS AND/OR ELEVATIONS OF EXISTING UTILITIES HAVE BEEN PROVIDED THROUGH UTILITY COORDINATION OR OTHER OBSERVATIONS. INFORMATION IS NOT TO BE RELIED UPON AS EXACT OR COMPLETE. CONTRACTOR TO FIELD VERIFY AND COORDINATE WITH UTILITY COMPANY AND DIG SAFE NO LESS THAN 72 HOURS PRIOR TO ANY EXCAVATION TO REQUEST EXACT FIELD LOCATION OF ALL UTILITIES. IT SHALL BE THE RESPONSIBILITY OF THE CONTRACTOR TO RELOCATE ALL EXISTING UTILITIES WHICH CONFLICT WITH THE PROPOSED IMPROVEMENTS INDICATED IN THE CONTRACT DOCUMENTS. CONTRACTOR TO NOTIFY ENGINEER OF ANY DIFFERENTIATIONS FROM EXISTING CONDITIONS, INCLUDING UTILITY SURVEY, PRIOR TO ANY CHANGES.
- FOR ALL UTILITIES, ACORN ENGINEERING DESIGN LIMITS EXTEND TO OUTSIDE WALL OF BUILDING. METERING OF UTILITIES TO BE COMPLETED BY M.E.P. UNLESS SPECIFIED OTHERWISE.
- SEWER: SEWER UTILITIES TO BE CONSTRUCTED IN ACCORDANCE WITH CITY OF PORTLAND TECHNICAL STANDARDS. WASTE FROM KITCHEN OF COMMERCIAL UNIT ONE SHALL CONVEY WASTE TO GREASE TRAP. CONNECTION TO EXISTING SYSTEM APPROXIMATED USING SLOPE BETWEEN UP- AND DOWN-GRADIENT MANHOLES. M.E.P. TO PLACE VALVE FOR BACKFLOW PREVENTION INSIDE OF BUILDING FOR EACH SEWER CONNECTION. CONTACT ENGINEER IF FIELD CONDITIONS FROM INVERT VARY FROM DESIGN.
- WATER UTILITIES: 4" AND 8" WATER PIPE SHALL BE DUCTILE IRON PIPE UNLESS OTHERWISE APPROVED. FINAL PIPE SIZING TO BE PROVIDED BY M.E.P. ENGINEER. INTERNAL METERING, BACKFLOW PREVENTION, AND PRESSURE REDUCERS TO BE COMPLETED BY M.E.P. ENGINEER. DOMESTIC WATER PIPE SIZES WILL DETERMINE THE FINAL WATER METERING OPTIONS. METER MAY BE SMALLER THAN 4" WATER MAIN. WATER METERING, PRESSURE REDUCER AND BACKFLOW PREVENTION TO BE IN ACCORDANCE WITH THE PORTLAND WATER DISTRICT STANDARDS.
- ELECTRIC UTILITIES: ELECTRIC DESIGN TO BE FINALIZED BY M.E.P. ENGINEER. ELECTRICAL LOAD TO BE DETERMINED BY M.E.P. ENGINEER. METER LOCATION BY M.E.P. ALL ELECTRIC CONSTRUCTION SHALL CONFORM TO CMP GUIDEBOOK OF STANDARD REQUIREMENTS, MOST RECENT EDITION.
- GAS UTILITIES: PROJECT GAS LOAD AND INTERNAL GAS UTILITY DESIGN TO BE FINALIZED BY M.E.P. ENGINEER. GAS METERS TO BE LOCATED BY M.E.P.
- CABLE AND TELEPHONE PULLBOXES AND PEDestal LOCATIONS TO BE DETERMINED BY FAIRPOINT AND TIME WARNER PRIOR TO CONSTRUCTION. CONTRACTOR TO COORDINATE.

PROPOSED UNDERGROUND ELECTRIC/CABLE/TELEPHONE (ENCASED IN CONCRETE WITHIN R.O.W.) (TYP.).

APPROX LOCATION OF NEW UTILITY POLE PER CMP DETAILS. CMP TO FIELD LOCATE

APPROXIMATE TRANSFORMER LOCATION WITHIN PAD  
 PROPOSED ABOVE-GROUND TRANSFORMER (7'X7' PAD); PER CMP DETAIL XII, ILLUSTRATION NO. 21 AND NO.24. M.E.P. ENGINEER TO DESIGN TRANSFORMER, SEE NOTE 7.

CONTRACTOR TO COORDINATE BOLLARD LOCATION WITH CMP (TYP.)

CONTRACTOR TO DEMOLISH AND PLUG EXISTING SEWER SERVICE IN ACCORDANCE WITH CITY OF PORTLAND TECHNICAL STANDARDS

PROPOSED UGETC LINE (SEE NOTE 7)

PROPOSED FIRE WATER LINE (SEE NOTE 6)

PROPOSED DOMESTIC WATER SERVICE (SEE NOTE 6)

4 PROPOSED GAS METERS ON WALL PER UNITIL STANDARDS, BY M.E.P. (SEE NOTE 8)

EXISTING WATER SERVICE TO BE LOCATED, ABANDONED IN PLACE. SHUT CORPORATION AND CUT DOMESTIC SERVICE. (PWD REFERENCE SV274892/27 EVERETT ST.)

NO SURVEY FOR UNDERGROUND UTILITIES, SEE NOTE 3 THIS SHEET. (TYP.)

PROPOSED BOLLARD (TYP.)

PROPOSED GAS CONNECTION SEE NOTE 3.

FINAL LOCATION OF PULL BOXES BY M.E.P. PENDING FINAL LOCATION OF METERING BY M.E.P., SEE NOTE 7 (TYP.).

BAYSIDE MEDIUM LED FIXTURE WITH BASE.

EXISTING N.E.T.&T EASEMENT AND CABINET SHALL BE PROTECTED FROM DAMAGE AT ALL TIMES DURING CONSTRUCTION. NOTIFY FAIRPOINT PRIOR TO ANY EXCAVATION ADJACENT TO THE CABINET.

EXISTING GUY WIRE TO BE RELOCATED BY CONTRACTOR

EXISTING WATER SERVICE TO BE LOCATED, ABANDONED IN PLACE. SHUT CORPORATION AND CUT DOMESTIC SERVICE. (PWD REFERENCE SV276346).

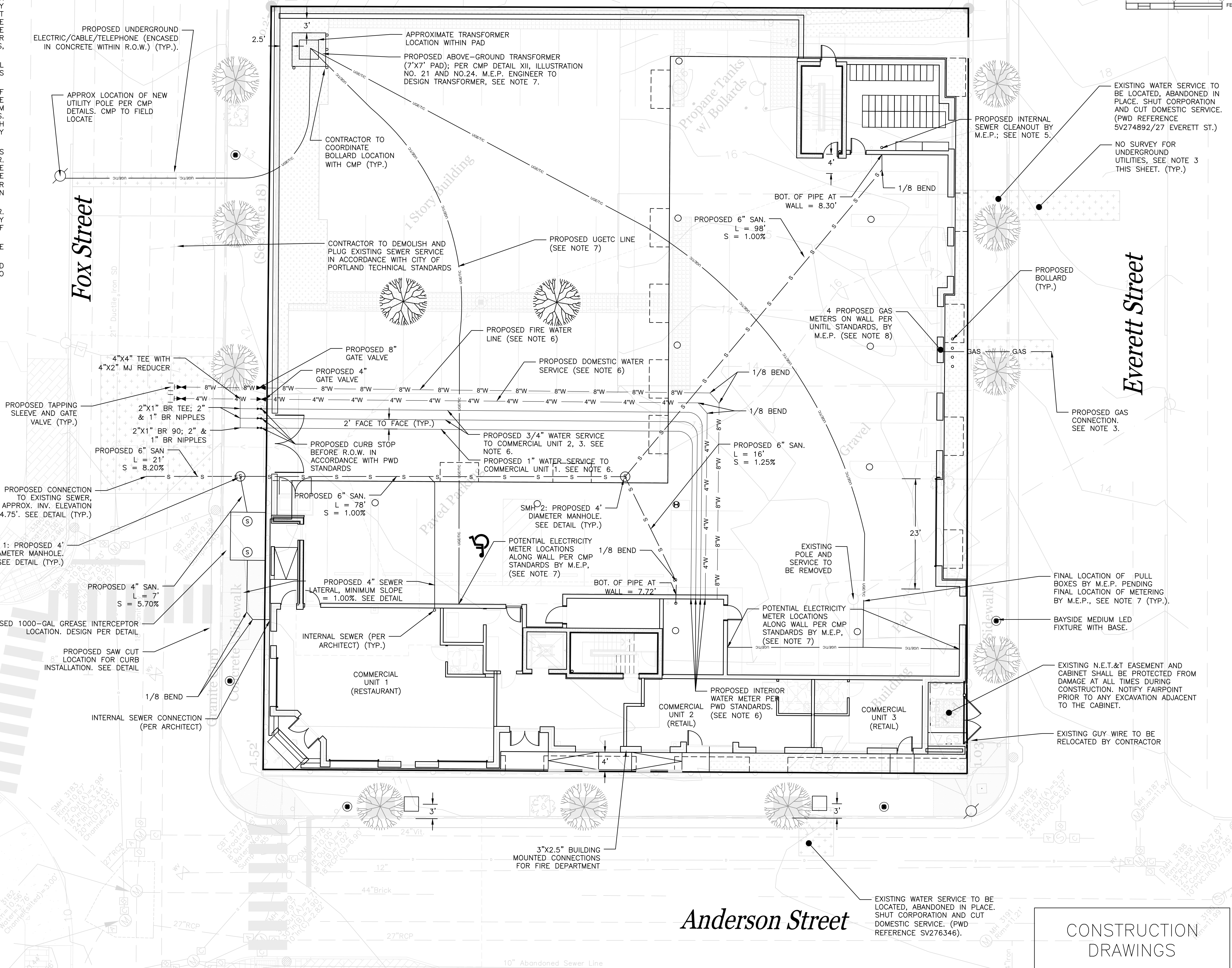

SEWER STRUCTURE SCHEDULE				
STRUCTURE	INTERIOR DIAMETER	RIM	INV. IN	INV. OUT
SMH-1	4'	11.56'	SMH-2: 6.57' GREASE: 6.70'	6.47'
SMH-2	4'	12.25'	FROM E: 7.45' FROM S: 7.45'	7.35'
GREASE INTERCEPTOR	SEE DETAIL	10.70' (SOUTH) 10.99' (NORTH)	7.35'	7.10'

CONSTRUCTION DRAWINGS

ISSUED FOR	BY	DATE
UTILITY LETTERS	WHS	11/17/14
PRE-APP MTG.	WHS	1/6/15
PRELIMINARY SUB	WHS	1/14/15
UTILITY STUB	WHS	1/14/15
COMMENT RESPONSE	WHS	1/15/15
CITY RESPONSE	WHS	5/19/15
PRICING SET	WHS	6/5/15
CONSTRUCTION	WHS	8/27/14
REVISION	REV	DATE

UTILITY PLAN  
 EAST BAYSIDE LOFTS  
 REDFERN BAYSIDE, LLC.  
 P.O. BOX 8816 PORTLAND, ME 04104

ACORN ENGINEERING, INC.  
 158 DANFORTH STREET, PORTLAND MAINE 04102  
 (207) 775-2825

ENGINEERING, INC.

THIS PLAN SHALL NOT BE MODIFIED WITHOUT WRITTEN PERMISSION FROM ACORN ENGINEERING, INC. ANY CHANGES SHALL BE AT THE USER'S SOLE RISK AND WITHOUT LIABILITY TO ACORN ENGINEERING, INC.

FILE: 1053\_CIVIL\_11-15-14  
 DATE: 10/15/2014  
 JN: 1053  
 SCALE: 1" = 10'  
 DESIGNED BY: WHS  
 DRAWN BY: MAG  
 CHECKED BY: WHS

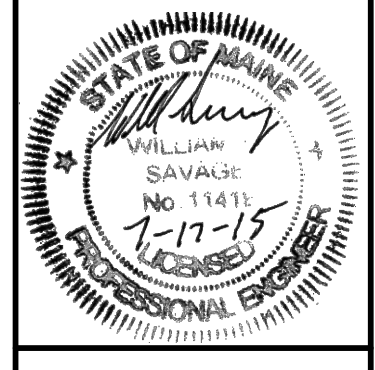

DRAWING NO.  
**C-20**