

1/4" = 1'

77 Walnut St. Portland, ME

4-6-16

Amendment to Foundation repair permit: Repair upper deck framing and deck boards.

By: Eric Favreau
Spinnaker Carpentry LLC

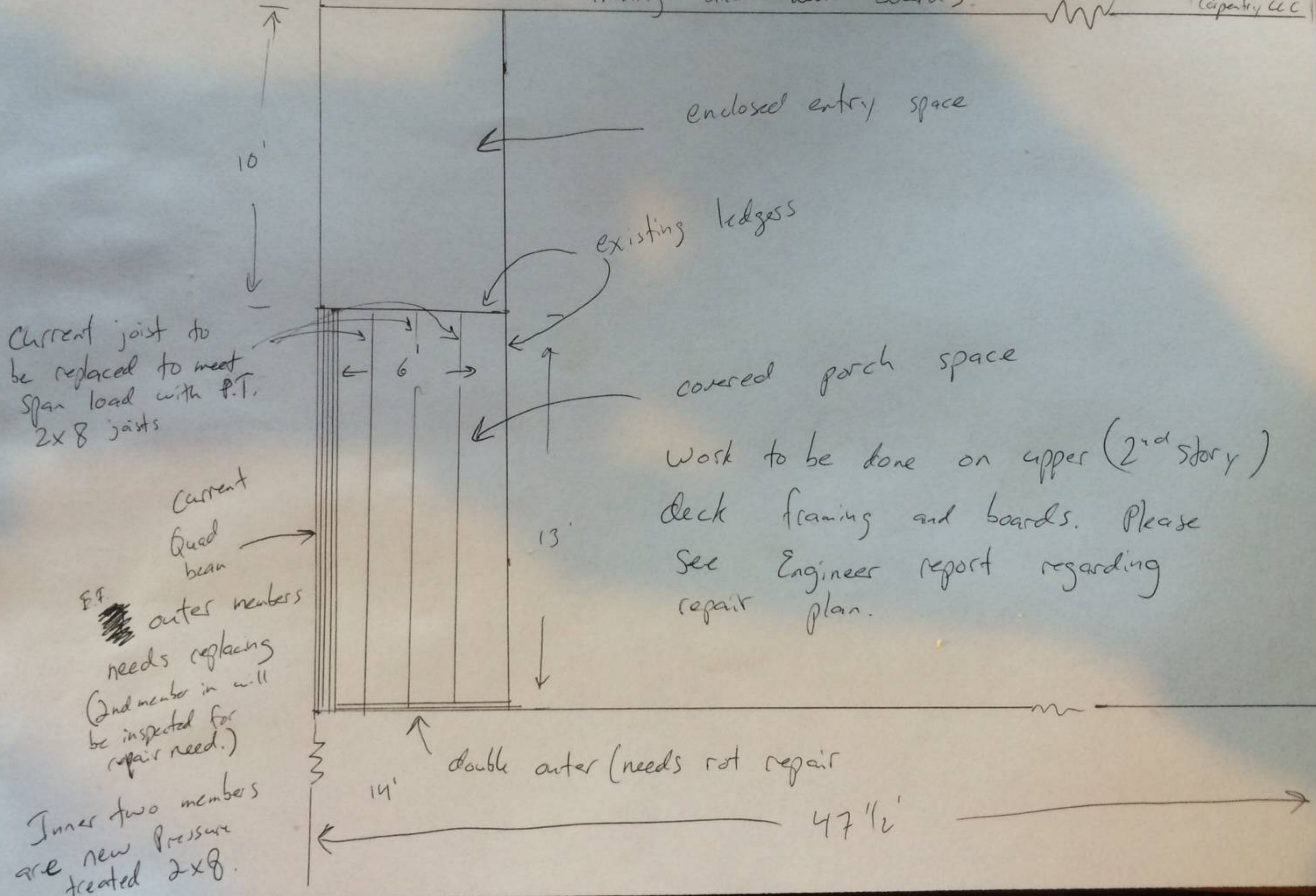

Current joist to be replaced to meet span load with P.T. 2x8 joists

enclosed entry space

existing ledgers

covered porch space

Work to be done on upper (2nd story) deck framing and boards. Please see Engineer report regarding repair plan.

Current Quad beam
E.F. outer members needs replacing (2nd member in will be inspected for repair need.)

Inner two members are new Pressure treated 2x8.

double outer (needs rot repair)

47 1/2'