

- NOTE:
- ALL DISTURBED AND PROPOSED SLOPES NOT COVERED WITH MULCH AND GREATER THAN 3:1 SHALL BE STABILIZED WITH 4" OF LOAM SEED AND EROSION CONTROL BLANKETS SC150BN BY NORTH AMERICAN GREEN OR APPROVED EQUAL.
  - ALL DISTURBED AND PROPOSED SLOPES TO BE COVERED WITH MULCH AND GREATER THAN 3:1 SHALL BE TEMPORARILY STABILIZED WITH EROSION CONTROL BLANKETS SC150BN BY NORTH AMERICAN GREEN OR APPROVED EQUAL.
  - THE UNDERDRAIN ASSOCIATED WITH THE UPHILL RETAINING WALLS AND FOUNDATION UNDERDRAIN FOR UNITS 1-18 SHALL OUTLET DOWNSTREAM OF THE UNDERDRAINED SUBSURFACE SAND FILTER'S OUTLET CONTROL STRUCTURE.
  - ALL STORM DRAIN PIPES SHALL CONFORM TO CITY OF PORTLAND TECHNICAL MANUAL SECTION 2.5.2
  - THE RETAINING WALL DRAINAGE SYSTEM INCLUDES A SECONDARY UNDERDRAIN SYSTEM FOR FUTURE CONNECTION TO A HARD PIPED SYSTEM. SHOULD ISSUES ARISE FROM GROUNDWATER FLOW THROUGH THE WEEP HOLES ON TO DOWNGRADIENT PROPERTIES, THE WEEP PIPE OUTLETS WOULD BE CAPPED AND THE SECONDARY UNDERDRAIN WOULD OUTLET TO A FUTURE CONNECTION WITHIN EAST COVE STREET. REFER TO THE STORMWATER INSPECTION & MAINTENANCE PLAN FOR ADDITIONAL INFORMATION.

DRAINAGE STRUCTURE SCHEDULE					
STRUCTURE	SIZE	TYPE	RIM	INV. IN	INV. OUT
FI-1	-	FIELD INLET	121.00'	-	115.50'
FI-2	-	FIELD INLET	120.40'	114.90'	114.90'
FI-3	-	FIELD INLET	120.40'	114.30'	114.30'
FI-4	-	FIELD INLET	121.90'	113.16'	113.16'
FI-5	-	FIELD INLET	121.90'	113.32'	113.32'
FI-6	-	FIELD INLET	119.40'	113.70'	113.70'
FI-7	-	FIELD INLET	119.40'	-	113.90'
NFI-1	6"	FIELD INLET	111.06'	-	106.50'
NFI-2	6"	FIELD INLET	111.06'	-	106.72'
CB-1	4'	4' PRECAST	110.80'	106.05'	24"/105.95' 12"/106.92'
CB-2	4'	4' PRECAST	110.80'	-	24"/105.90' 12"/106.85'
DMH-1	4'	PRECAST DRAINAGE MANHOLE	113.06'	100.76'	100.66'
DMH-2	4'	PRECAST DRAINAGE MANHOLE	108.62	100.51'	100.41'
DMH-3	4'	PRECAST DRAINAGE MANHOLE	111.45'	8"/106.30' 6"/106.30'	106.30'
EXDMH-1	EXIST.	EXISTING DRAINAGE MANHOLE	106.69	100.32'	EXIST.

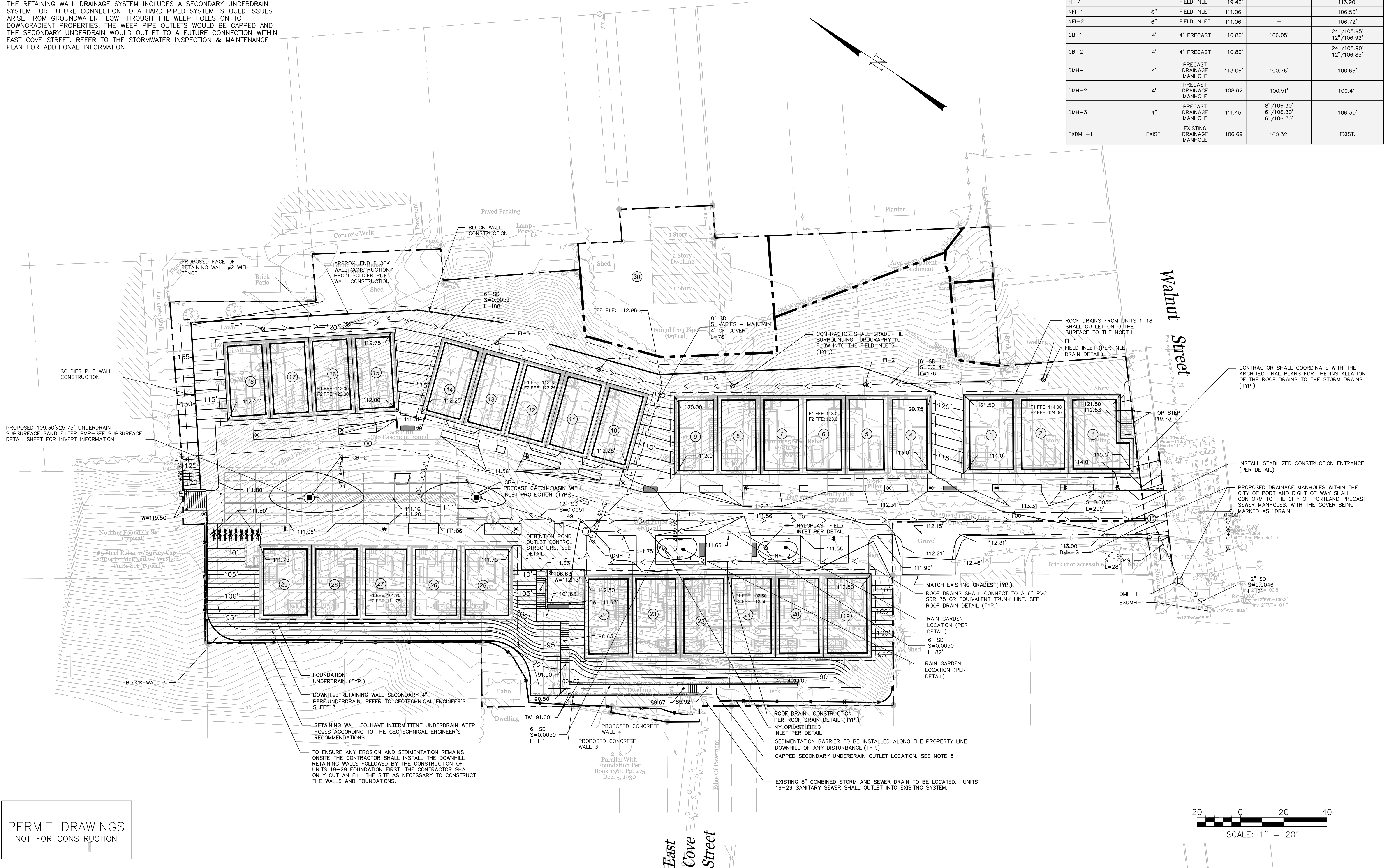

PERMIT DRAWINGS  
NOT FOR CONSTRUCTION

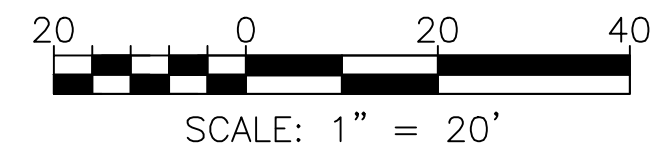

ISSUED FOR	BY
CITY SUBMISSION	WHS
WORKSHOP #2	11/12/13
FINAL SUBMISSION	WHS
MAINE DEP MCGP	12/22/13
CONDITIONS APPROVAL	WHS
	1/7/14
REVISION	REV.
STAFF COMMENTS	DATE
	WHS
	12/27/13

DRAWING NAME: **GRADING, DRAINAGE & EROSION CONTROL PLAN**

PROJECT NAME: **MUNJOY HEIGHTS**

CLIENT: **REDFERN MUNJOY, LLC.**  
P.O. BOX 8816, PORTLAND, MAINE 04104

ACORN ENGINEERING, INC.  
P.O. BOX 3332, PORTLAND, MAINE 04104  
(207) 775-2665

FILE: 1047\_CIVIL  
DATE: 11/05/13  
JN: 1047  
SCALE: 1"=20'  
DESIGN BY: WHS  
DRAWN BY: ZRJ  
CHECKED BY: WHS

STATE OF MAINE  
WILLIAM SAVAGE  
No. 11419  
-17-14  
LICENSED PROFESSIONAL ENGINEER

DRAWING NO. **C-30**