

1 BITUMINOUS PAVEMENT - DRIVEWAY
NOT TO SCALE

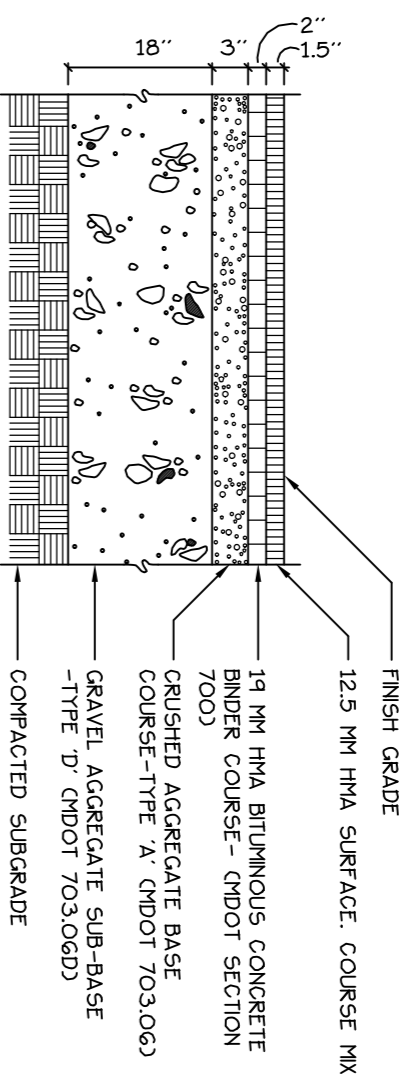

2 BITUMINOUS PAVEMENT - ROAD
NOT TO SCALE

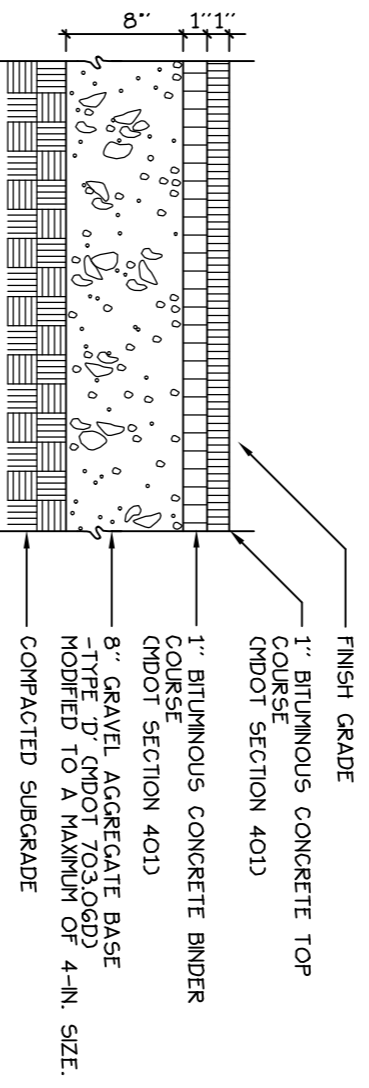

3 BITUMINOUS SIDEWALK
NOT TO SCALE

REFER TO STRUCTURAL ENGINEERING DRAWINGS FOR BRICK PAVING DETAILS AND FINISH GRADE. REFER TO LAYOUT PLAN FOR BRICK PAVING DETAILS AND FINISH GRADE. REFER TO LAYOUT PLAN FOR BRICK PAVING DETAILS AND FINISH GRADE.

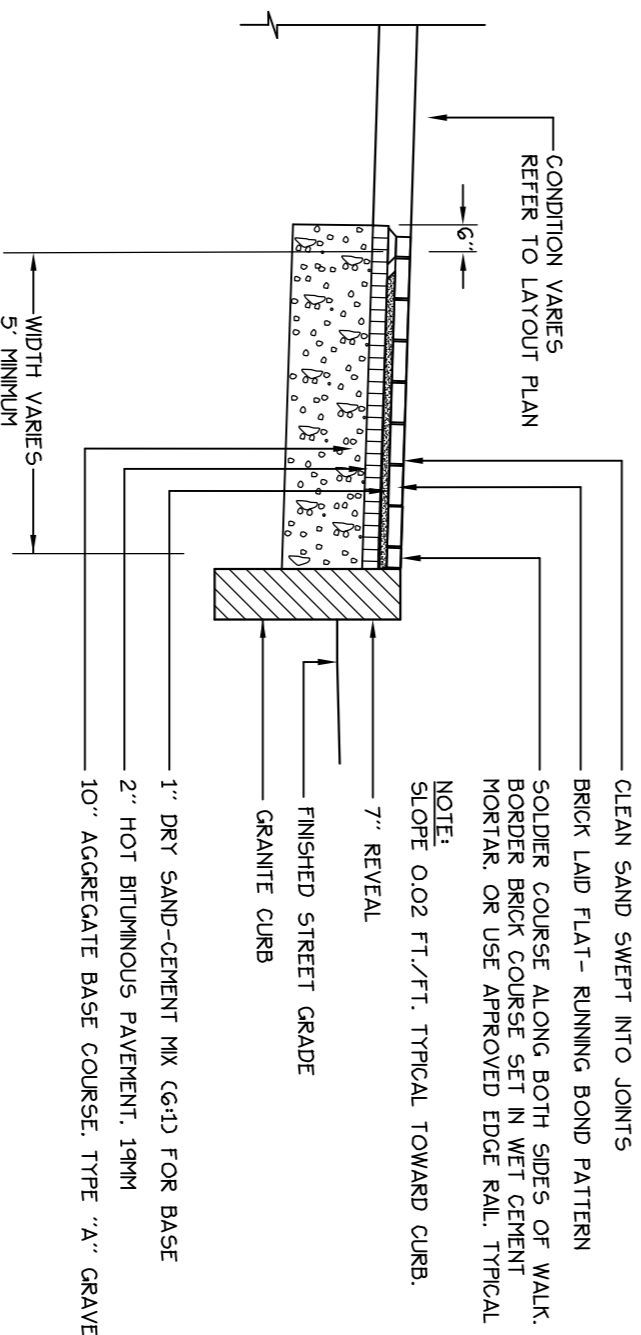

4 BRICK SIDEWALK WITH BITUMINOUS BASE AND GRANITE CURB
NOT TO SCALE

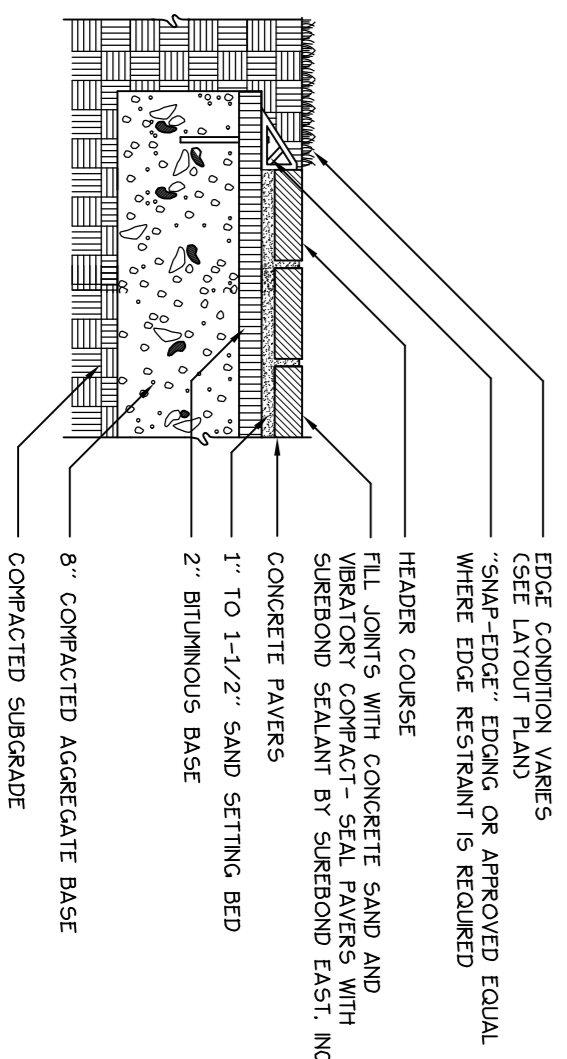

5 CONCRETE PAVERS
NOT TO SCALE

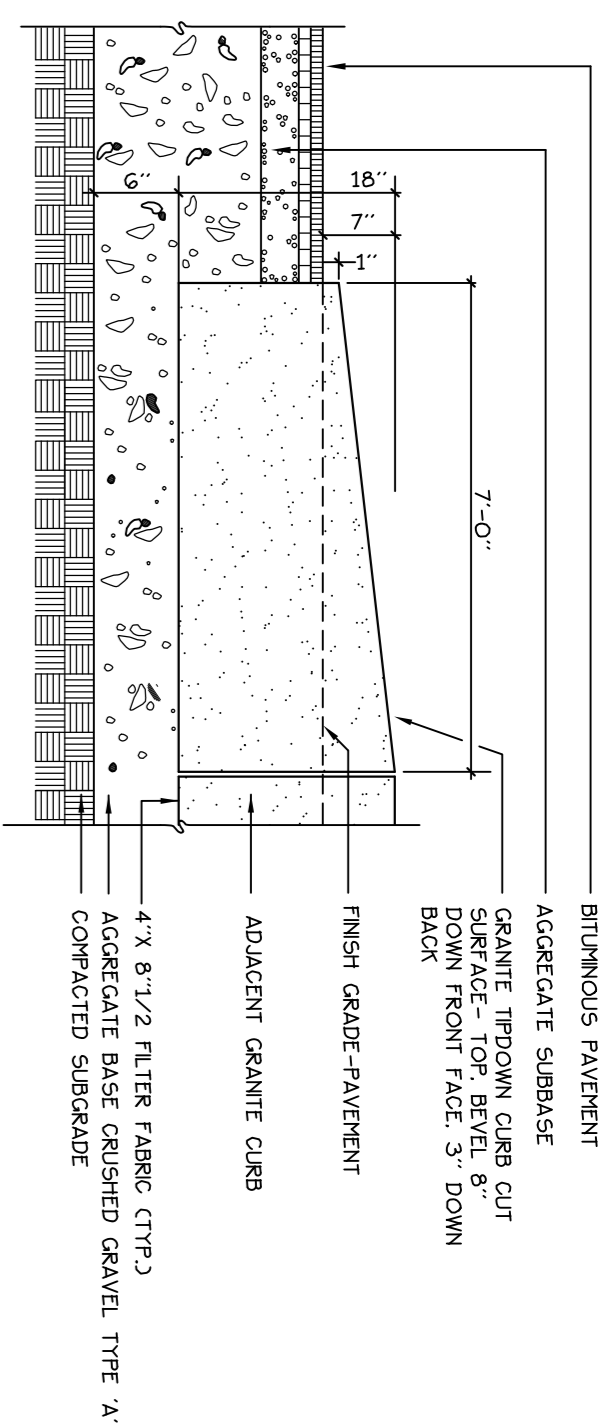

6 GRANITE TIP-DOWN CURB
NOT TO SCALE

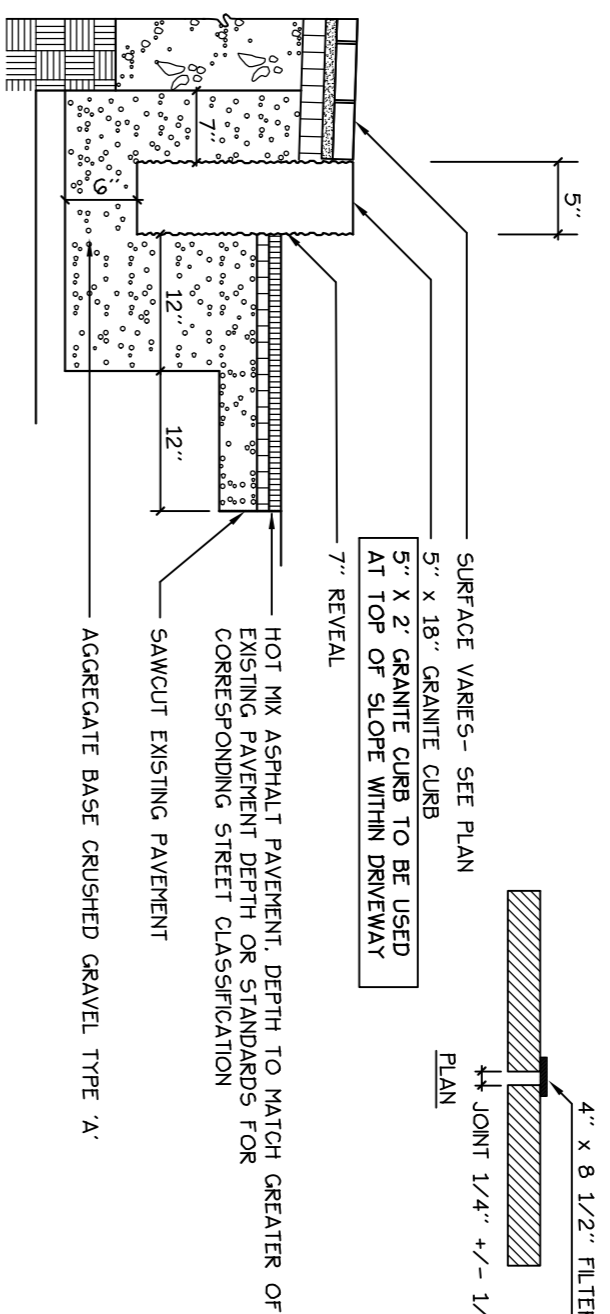

7 VERTICAL GRANITE CURB
NOT TO SCALE

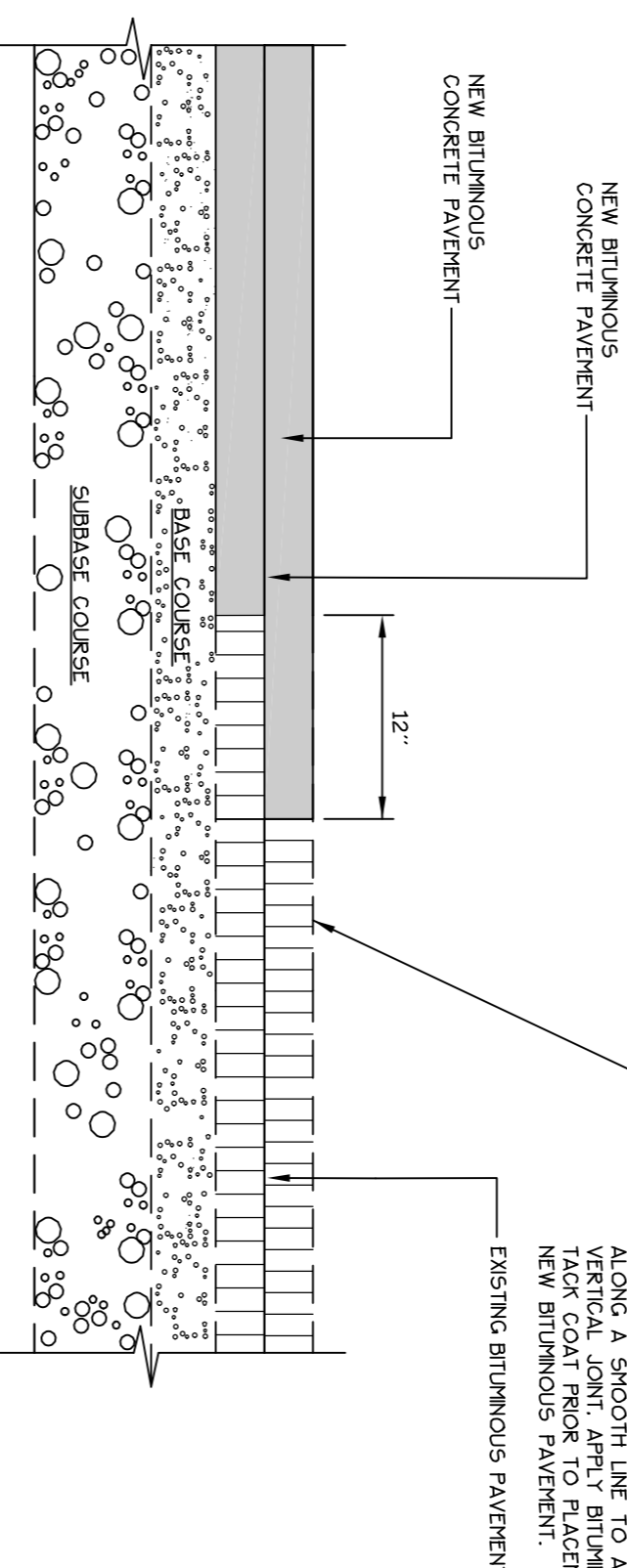

8 PAVEMENT SAWCUT DETAIL
NOT TO SCALE

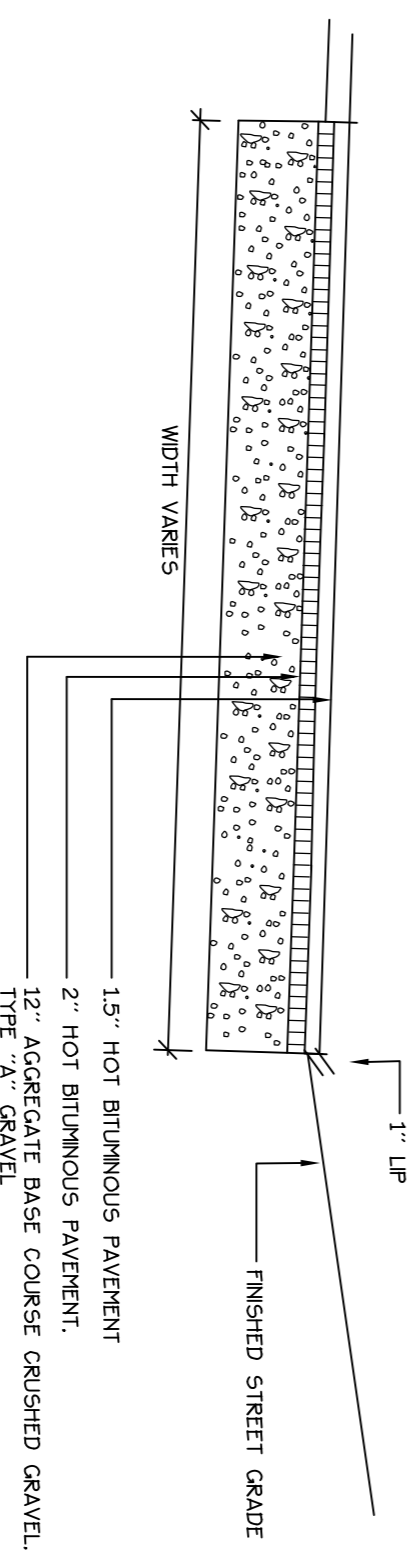

9 BITUMINOUS DRIVEWAY APRON
NOT TO SCALE

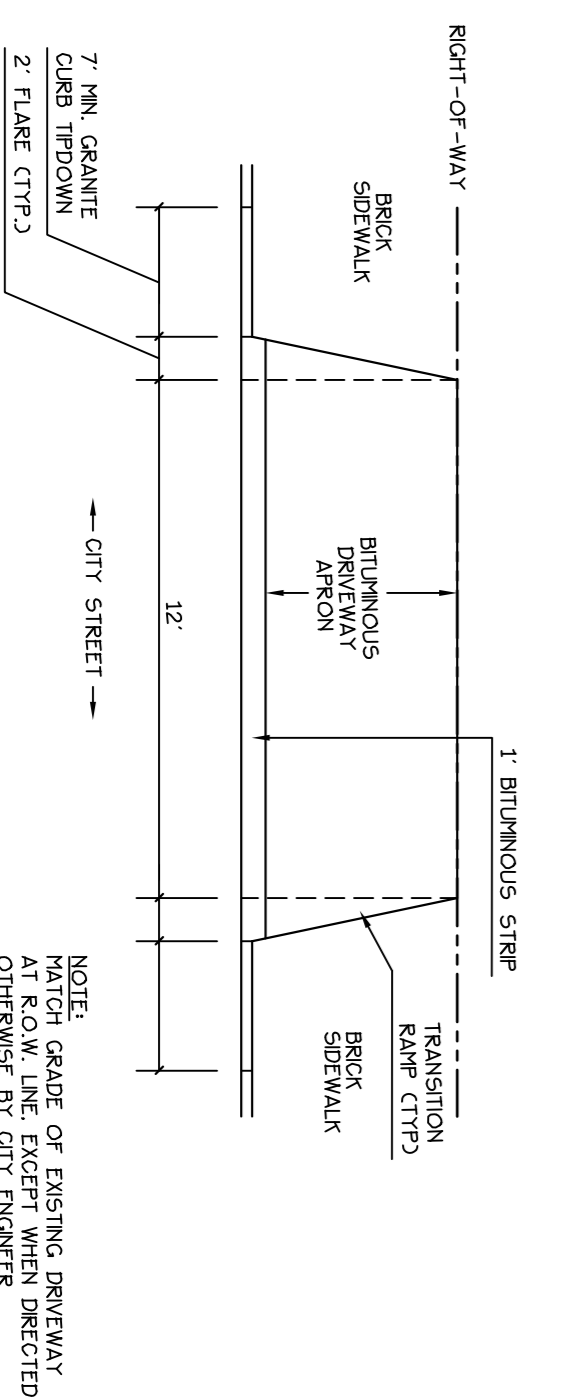

10 DRIVEWAY APRON LAYOUT
NOT TO SCALE

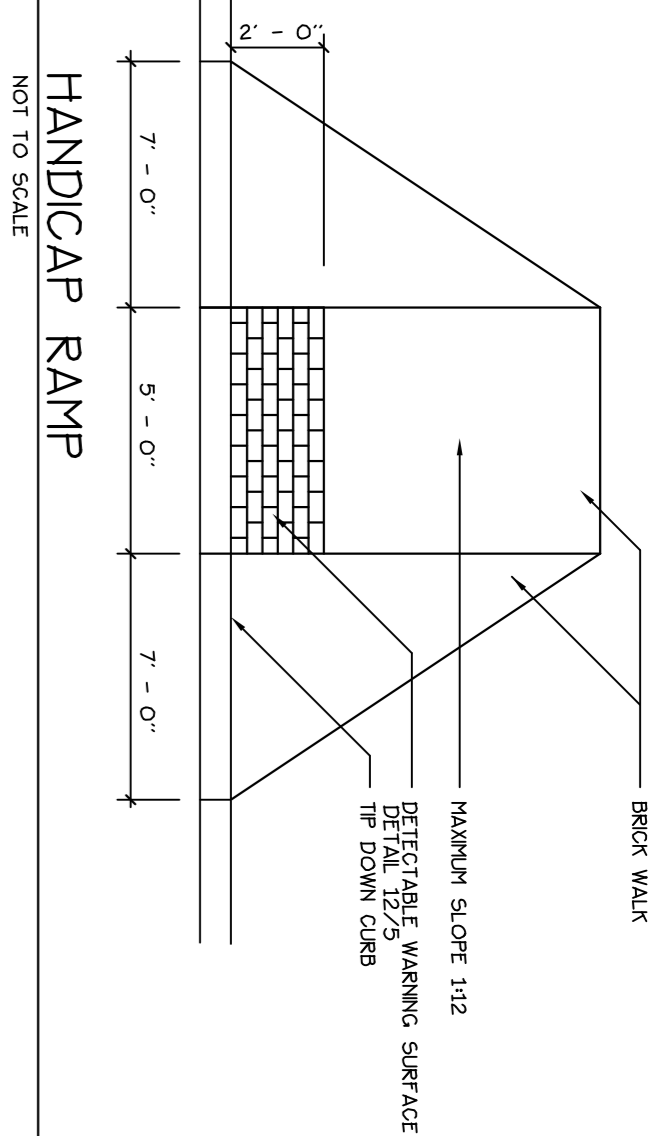

11 HANDICAP RAMP
NOT TO SCALE

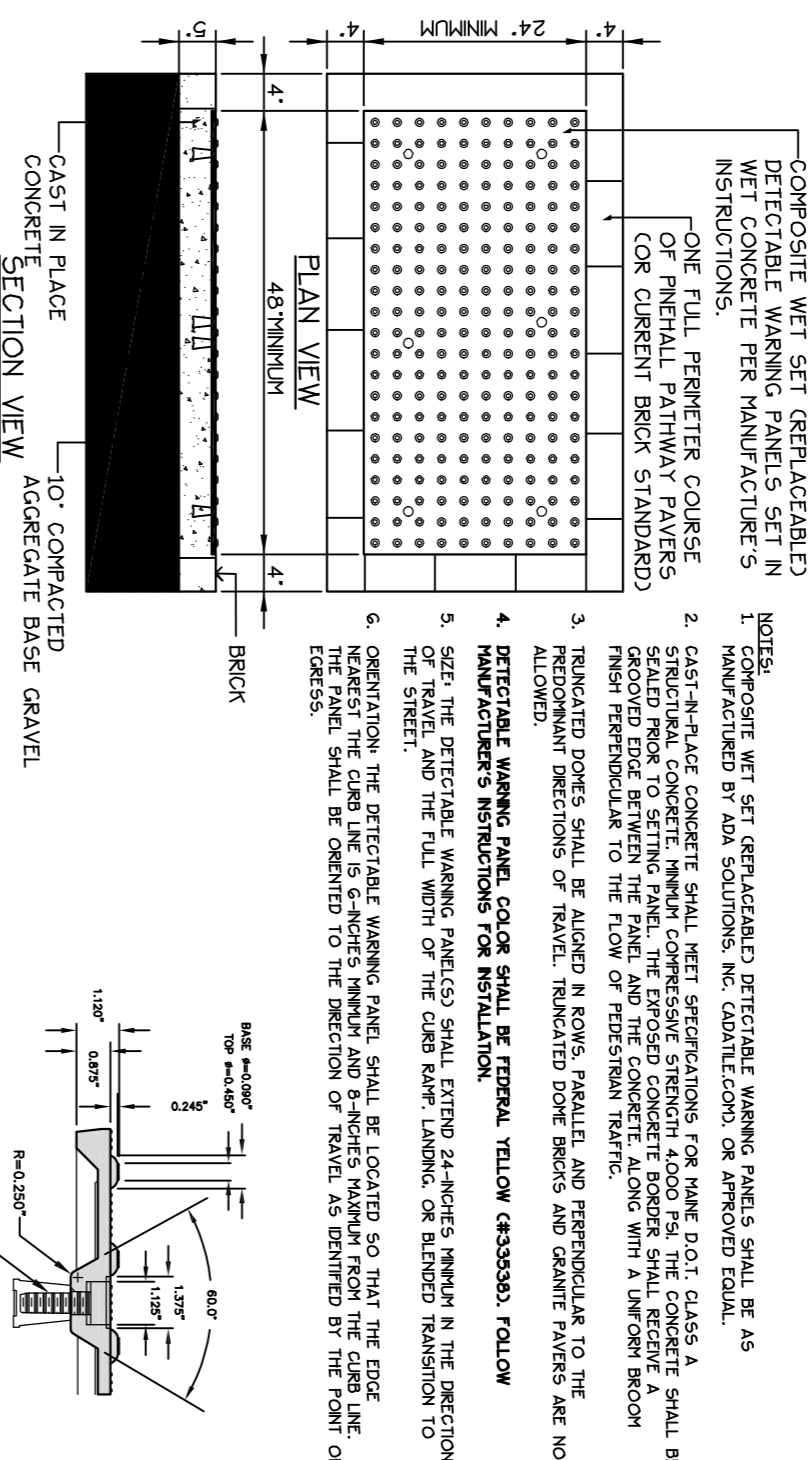

12 SIDEWALK RAMP DETECTABLE WARNING TILE
NOT TO SCALE

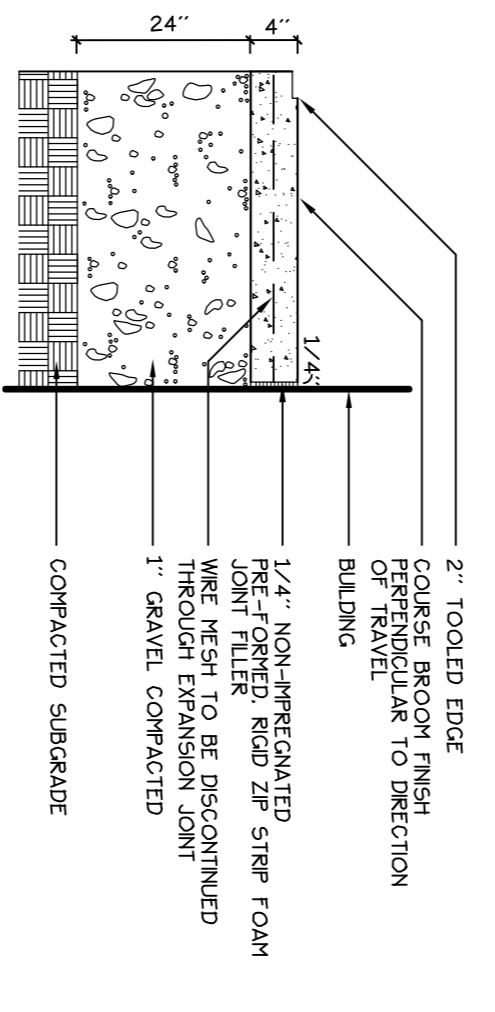

13 CONCRETE ENTRY SLAB - NORTH SIDE ENTRANCE
NOT TO SCALE

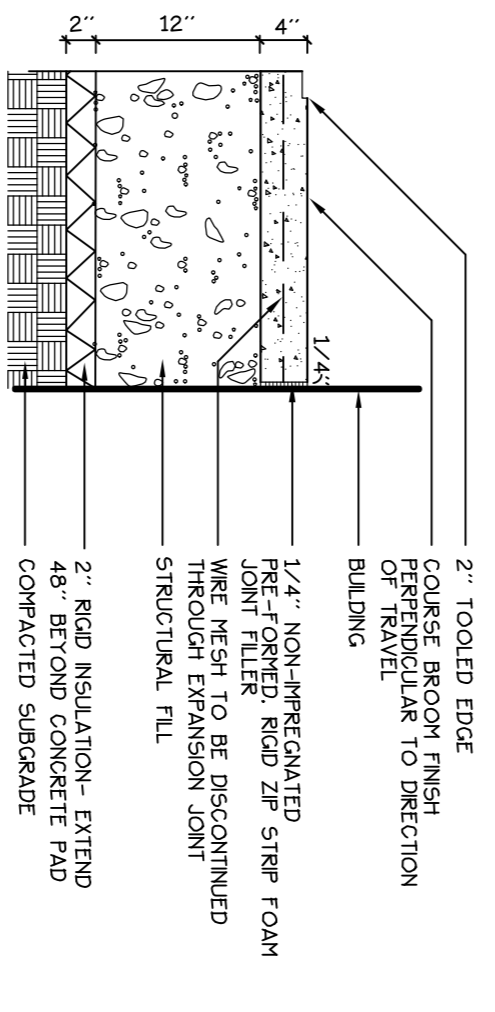

14 CONCRETE ENTRY SLAB - SOUTH SIDE ENTRANCE
NOT TO SCALE

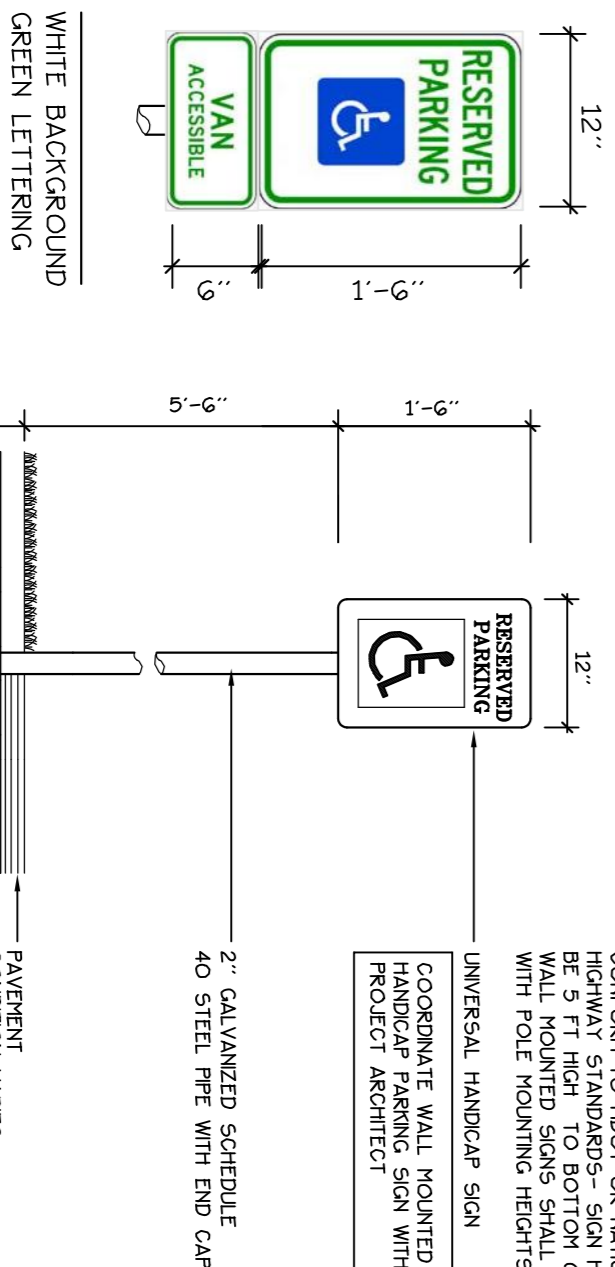

15 HANDICAP PARKING SIGNAGE
NOT TO SCALE

Prepared For:
Applicant:
AVESTA HOUSING
307 Cumberland Avenue
Portland, Maine
Prepared By:
MITCHELL & ASSOCIATES
1111 The Staples School
70 Center Street
Burlington, Maine 04401
(857) 774-4429



CITY OF PORTLAND
APPROVED SITE PLAN
Subject to Conditions of Approval
and Standard Conditions
DATE OF APPROVAL: June 10, 2014
PLANNER: Christine Grimando
PROJECT NO.: 2014-053

WASHINGTON AVENUE EFFICIENCIES

134 Washington Avenue Portland, Maine

Date:
APRIL 14, 2014

Issued For:
SITE PLAN AND SUBDIVISION
PLAN REVIEW

Revisions:

Reproduction or reuse of
this document without the
written consent of Mitchell &
Associates is prohibited.

Title:
SITE DETAILS

Scale:
AS NOTED

Sheet No.:
5

