

© 2005 TFH ARCHITECTS

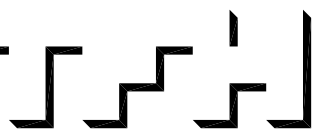

CUMBERLAND AVENUE - SOUTH ANDERSON STREET
PEOPLE'S REGIONAL OPPORTUNITY PROGRAM
PORTLAND, MAINE



TFH ARCHITECTS
100 COMMERCIAL STREET
PORTLAND MAINE 04101
TELEPHONE 207 775 6141
ARCHITECTURE PLANNING

CONSULTANTS:

CIVIL:
Potham & Greer
170 US Route One
Falmouth, ME 04105
207-781-5242
STRUCTURAL:
Structural Design Consulting
Five Biskam Lane
Falmouth, ME 04105-2448
207-476-8038
MECHANICAL:
Walley Engineering
10 Denforth Place
Portland, ME 04102
207-633-2921
ELECTRICAL:
Bennett Engineering
7 Emerald Road
Freeport, ME 04032
207-866-9476

REVISIONS:

DATE: 01/14/05

PROJECT No. 0203

DRAWN BY: SA

CHECKED BY: DAM

SCALE: AS NOTED

SHEET TITLE:

ROOF PLAN

A1.4

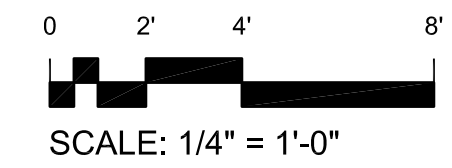
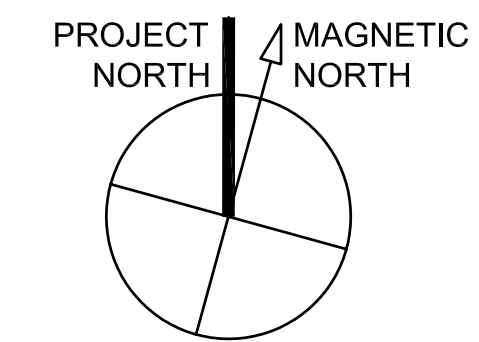

SCALE: 1/4" = 1'-0"

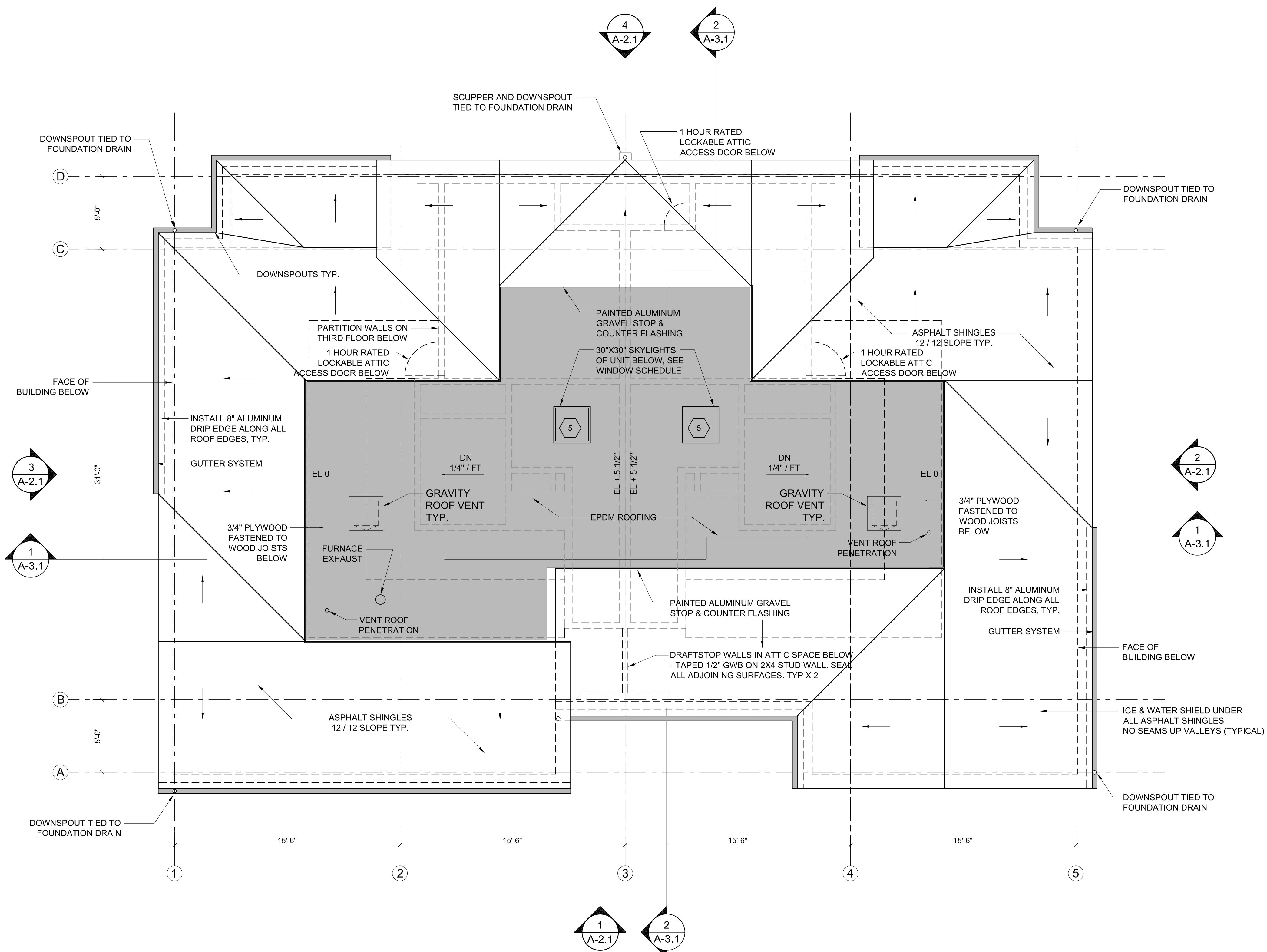

1 ROOF PLAN
1/4" = 1'-0"