

CAD FILE: FILE SCALE: PLOT DATE:

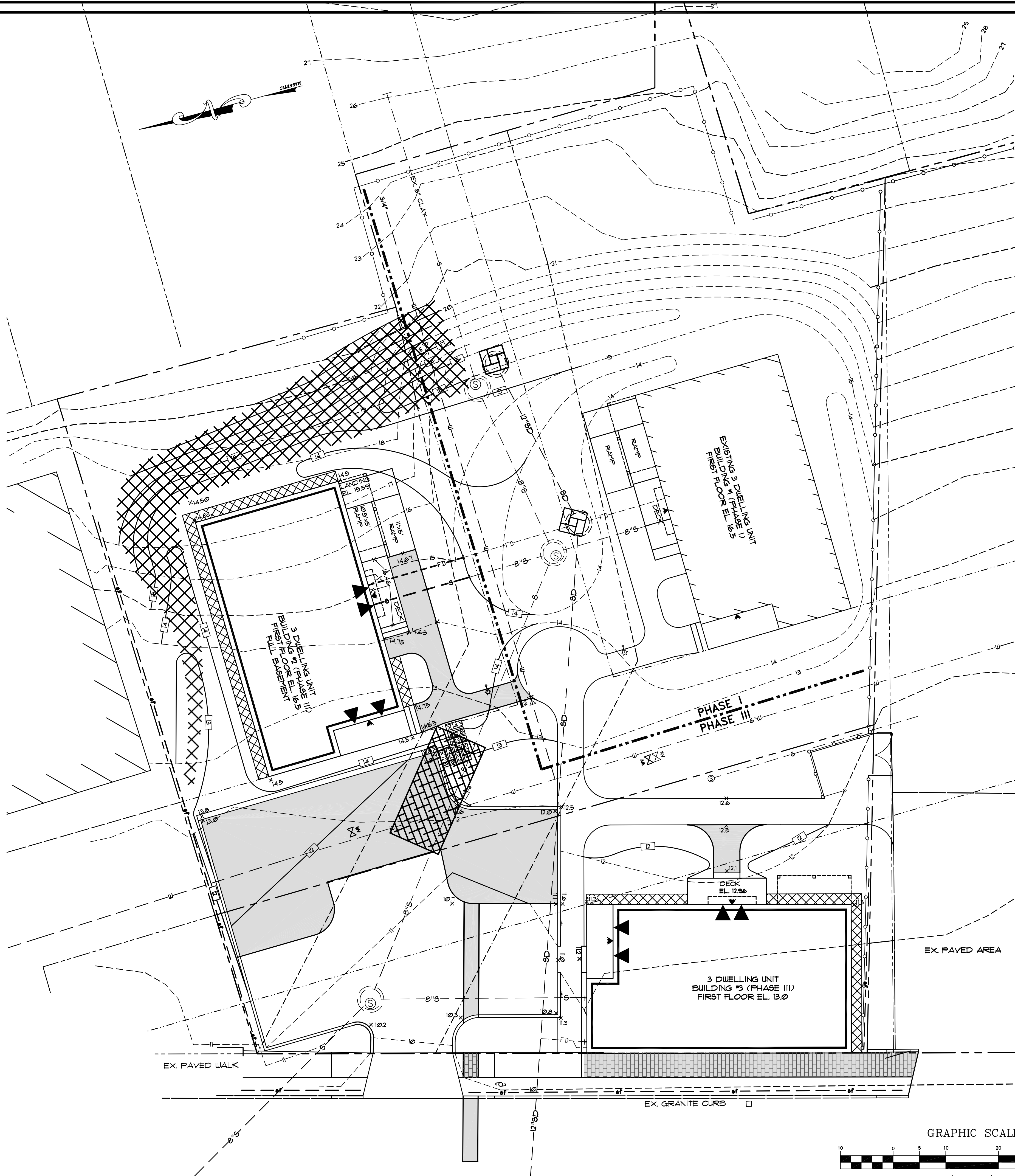

LEGEND

EXISTING	PROPOSED
--- PROPERTY LINE	▭ BUILDING
- - - ABUTTER'S PROPERTY	① PARKING DESIGNATION
- - - WATER DISTRICT EASEMENT	— EDGE OF PAVEMENT
- - - SEWER EASEMENT	— SLOPED BITUMINOUS CURB
▨ BUILDING	--- CONTOURS
- - - ZONING DISTRICT	--- G GAS LINE
● IRON PIN W/ PLASTIC CAP PLS #1/2, INSTALLED W/ PHASE I	--- S SANITARY SEWER
--- EDGE OF PAVEMENT	--- UGE UNDERGROUND ELECTRIC
--- CONTOURS	--- W WATER LINE
--- CURB	--- FD FOUNDATION DRAIN
--- G GAS LINE	⊗ GAS METER
--- OHE 4T OVERHEAD ELEC. 4 TEL.	⊗ SPOT GRADE
--- S SANITARY SEWER	⊗ SURFACE DRAINAGE
--- SD STORM DRAIN	⊗ POLE MOUNTED LIGHT
--- UGE UNDERGROUND ELECTRIC	⊗ WALL MOUNTED LIGHT
--- W WATER LINE	⊗ WATER SHUT OFF
⊗ SEWER MANHOLE	⊗ DRIPSTRIP
⊗ DRAIN MANHOLE	▨ BITUMINOUS PAVEMENT
⊗ CATCH BASIN	▨ BARK/MULCH BED
⊗ UTILITY POLE	▨ BRICK SIDEWALK
⊗ TREE	
⊗ FICKET FENCE	
⊗ CHAINLINK FENCE LINE	
⊗ CHAINLINK FENCE LINE INSTALLED W/ PHASE I	
⊗ GAS VALVE	
⊗ HYDRANT	
⊗ GATE VALVE	
⊗ POLE MOUNTED LIGHT INSTALLED W/ PHASE I	
⊗ PHASE I PARKING DESIGNATION	
⊗ HANDICAP PARKING	

EROSION CONTROL LEGEND

▨	CATCH BASIN PROTECTION WITH HAYBALES
▨	EROSION CONTROL MESH
▨	STABILIZED ENTRANCE
---	SILT FENCE

GENERAL NOTES FOR PHASING

1. EROSION CONTROL MEASURES ARE SHOWN FOR PHASE III.
2. ALL CATCHBASINS REQUIRE PROTECTION AFTER INSTALLATION DURING BOTH PHASES.
3. A STABILIZED CONSTRUCTION ENTRANCE IS REQUIRED DURING BOTH PHASES.
4. INSTALL EROSION CONTROL MESH AS REAR SLOPE IS FORMED.
5. SILTFENCE ALONG THE NORTH AND SOUTH PROPERTY LINES IS REQUIRED DURING BOTH PHASES.

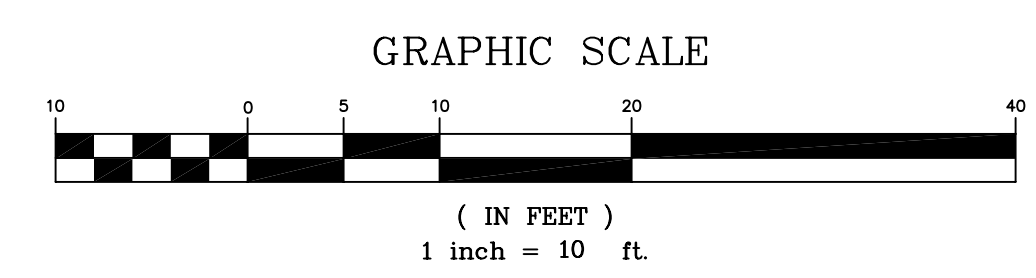

REV.	DATE	DESCRIPTION
7	1/14/05	ISSUED FOR BID
6	12/03/04	TFH 50% REVISIONS
5	5/19/03	ADJUSTED BUILDING LOCATION PER ON-SITE REVIEW
4	4/9/03	REV'D: PHASES, UPPER SIDEWALK & BUILDING RAMP ADJUSTED UTILITY INVERTS & SIZES, APPROVAL BLOCK
3	1/4/02	REV'D PER MSHA REVIEW
2	9/5/02	REV'D PER CITY REVIEW
1	8/9/02	REV'D PER CITY REVIEW

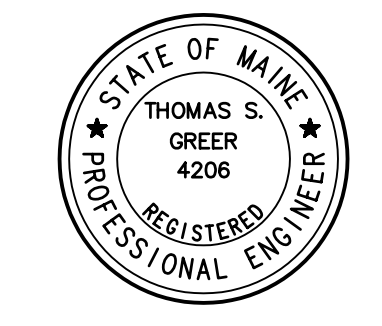

PINKHAM & GREER

CONSULTING ENGINEERS, INC.
FALMOUTH, MAINE

PH I: PENINSULA COMMUNITY LP
PH II: PENINSULA COMMUNITY LP II
510 CUMBERLAND AVE., PORTLAND ME

**ANDERSON STREET
PORTLAND, MAINE
PROP HOUSING PHASE III
EROSION CONTROL PLAN**

SCALE: AS SHOWN	DRN BY: JDC/TFH
DATE: JULY 29, 2002	DESG BY: TSG
PROJECT: 01417	CHK BY: TSG

C4