

12 DETAIL ROOF / WALL TRANSITION  
A5.1 1-1/2" = 1'-0"

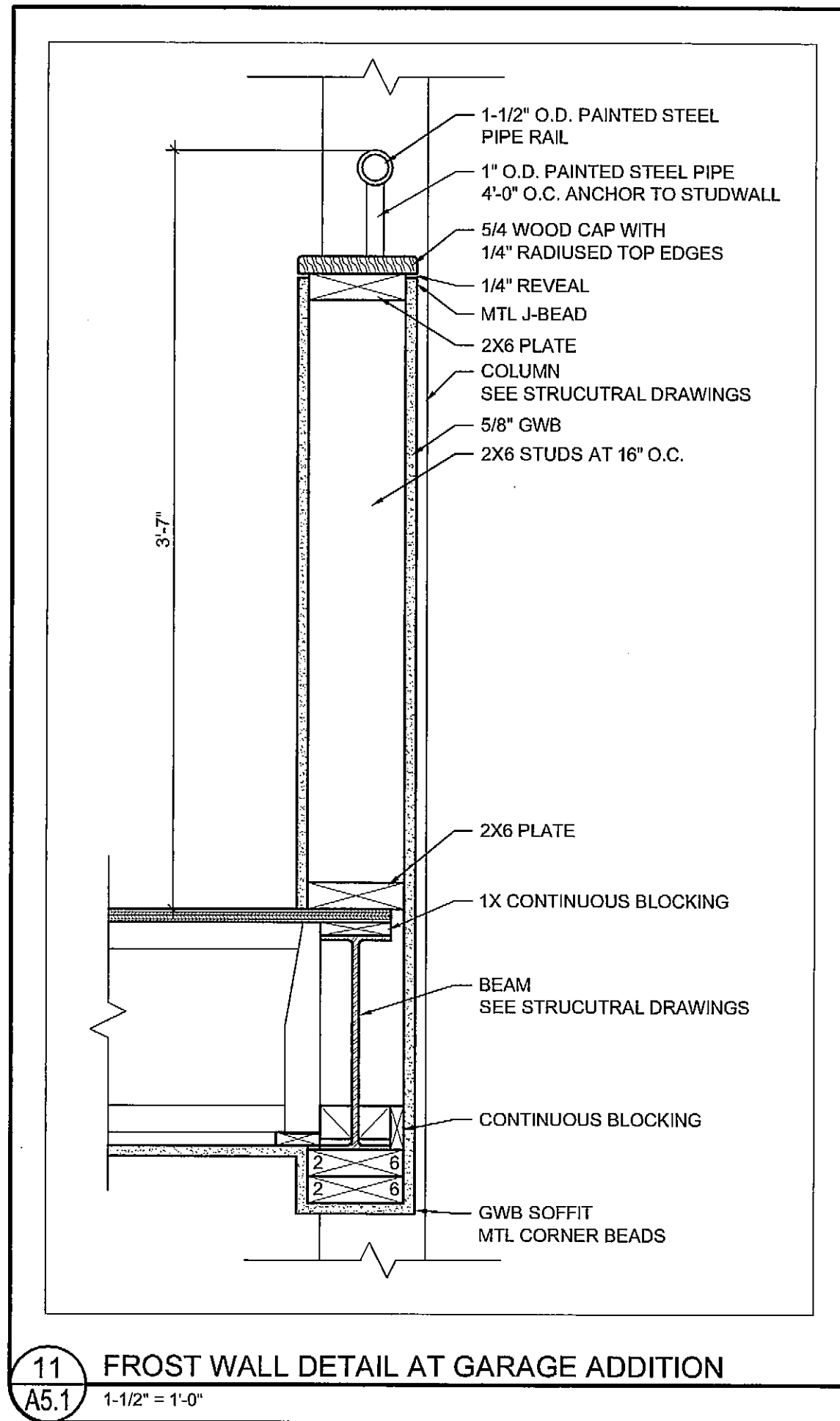

11 FROST WALL DETAIL AT GARAGE ADDITION  
A5.1 1-1/2" = 1'-0"

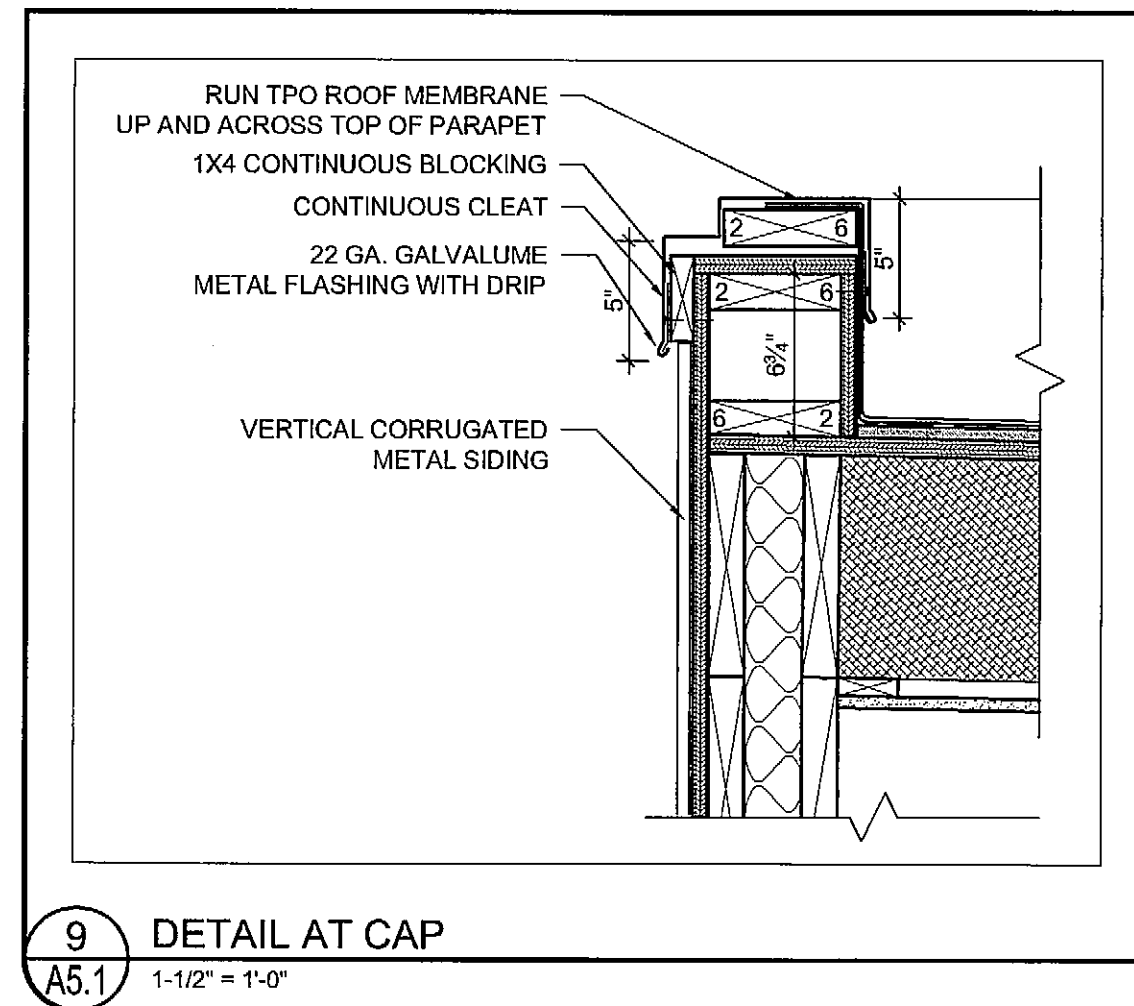

9 DETAIL AT CAP  
A5.1 1-1/2" = 1'-0"

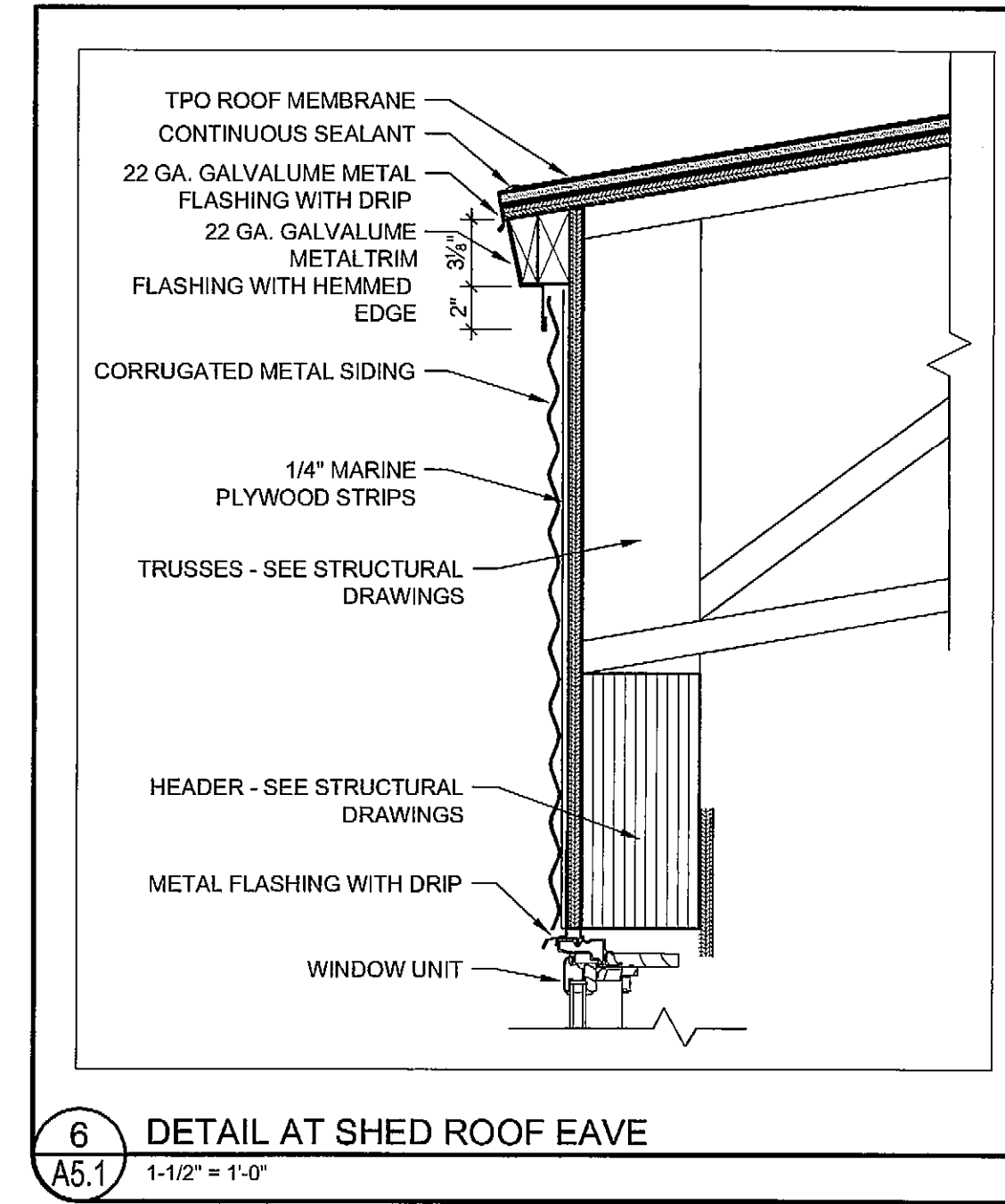

6 DETAIL AT SHED ROOF EAVE  
A5.1 1-1/2" = 1'-0"

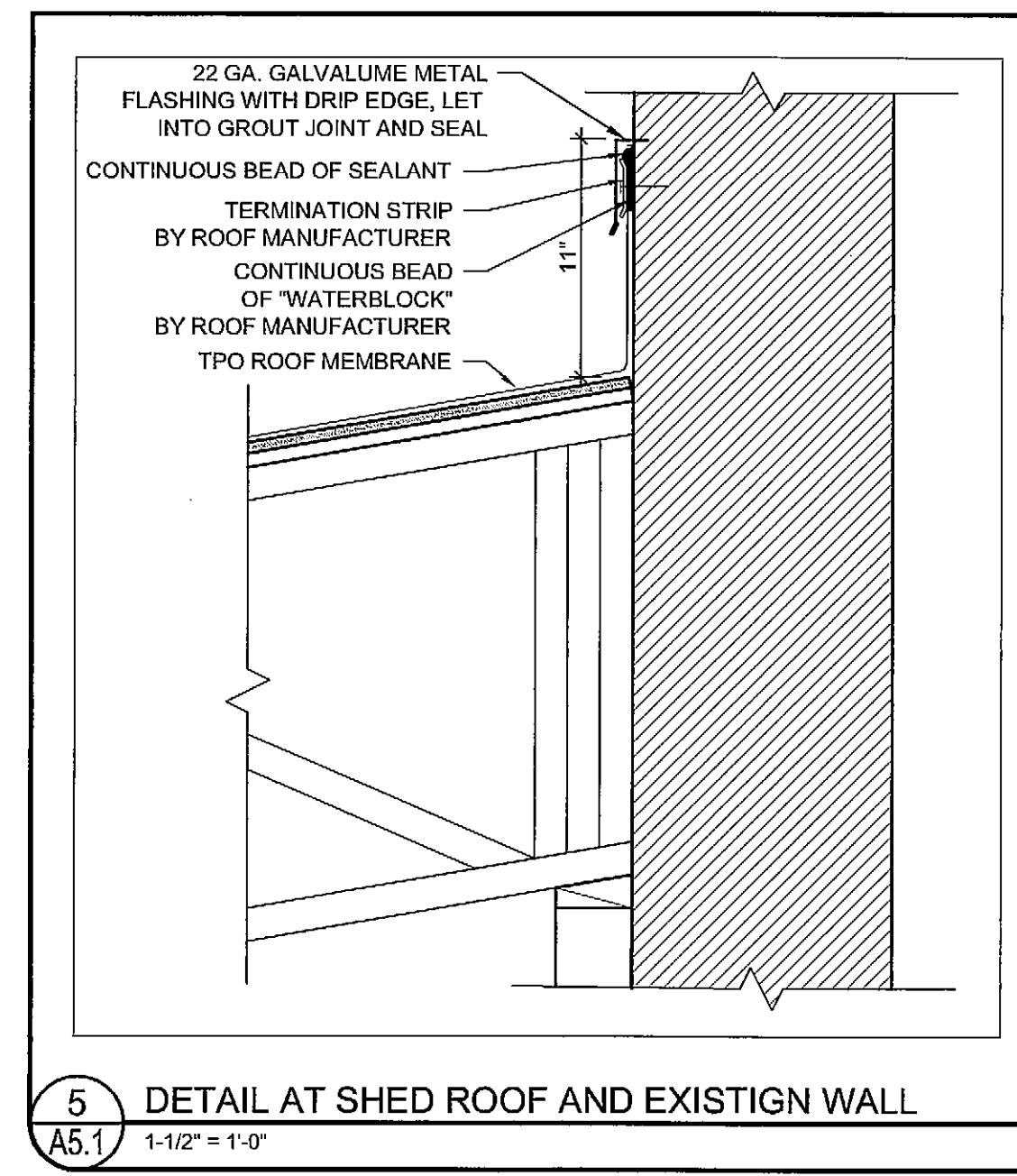

5 DETAIL AT SHED ROOF AND EXISTING WALL  
A5.1 1-1/2" = 1'-0"

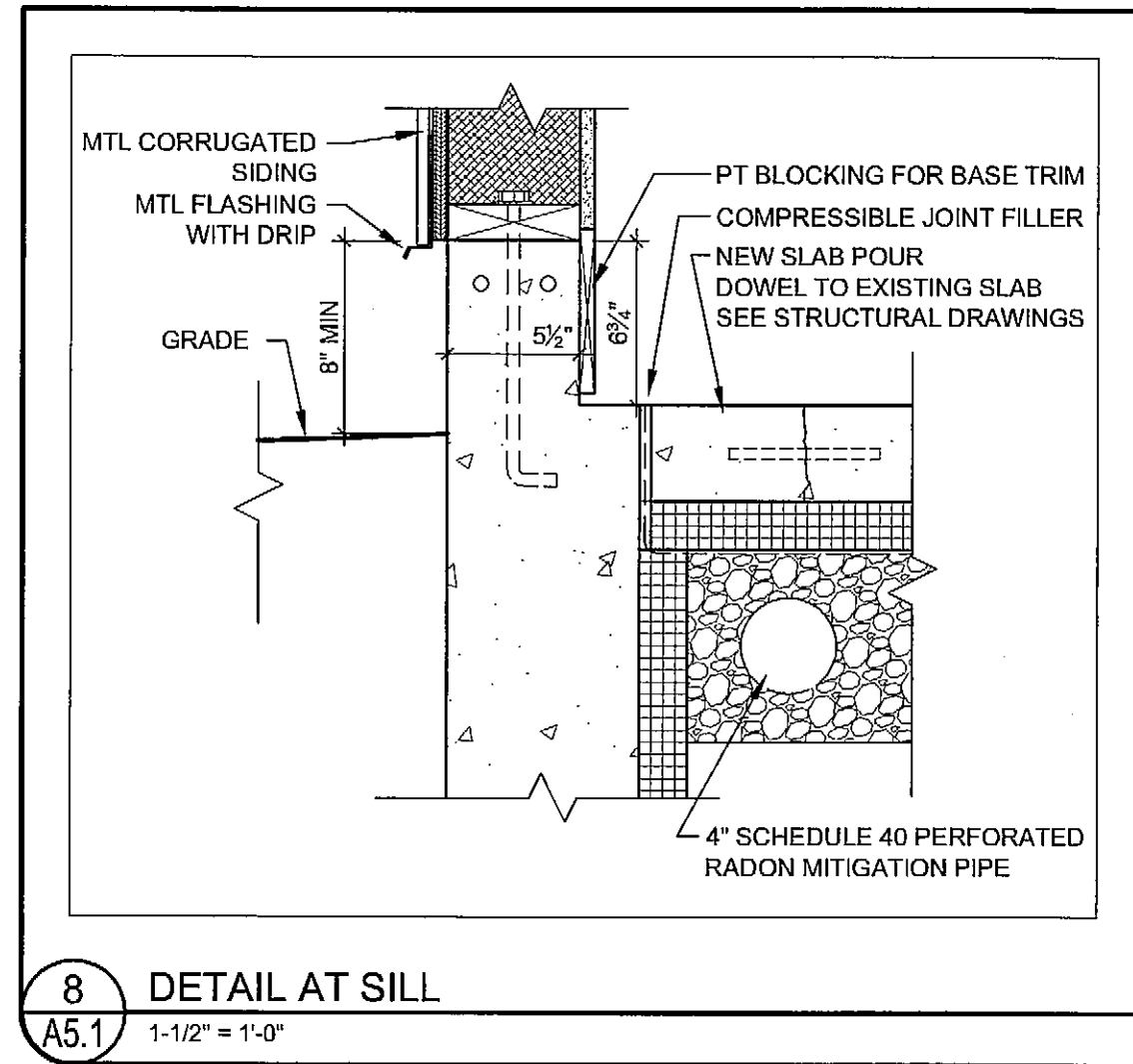

8 DETAIL AT SILL  
A5.1 1-1/2" = 1'-0"

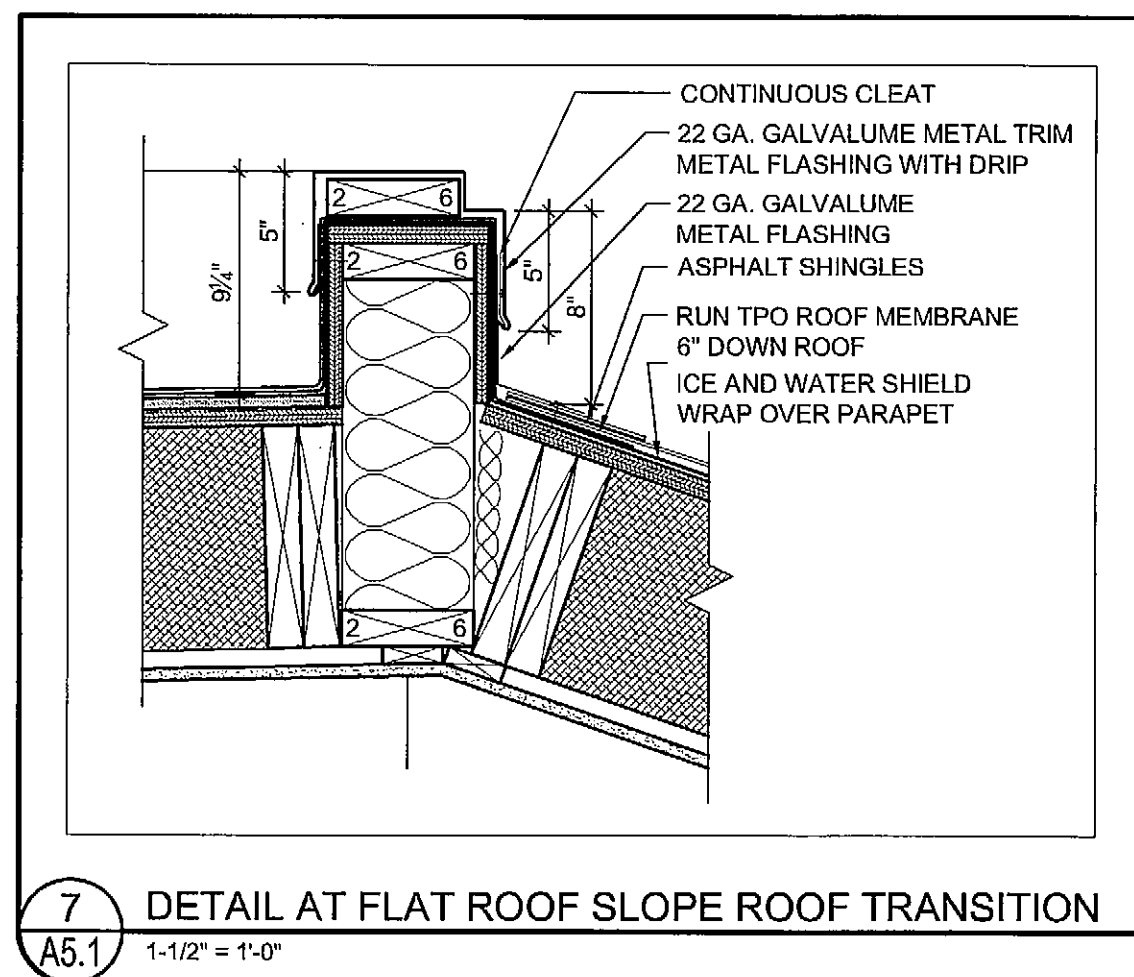

7 DETAIL AT FLAT ROOF SLOPE ROOF TRANSITION  
A5.1 1-1/2" = 1'-0"

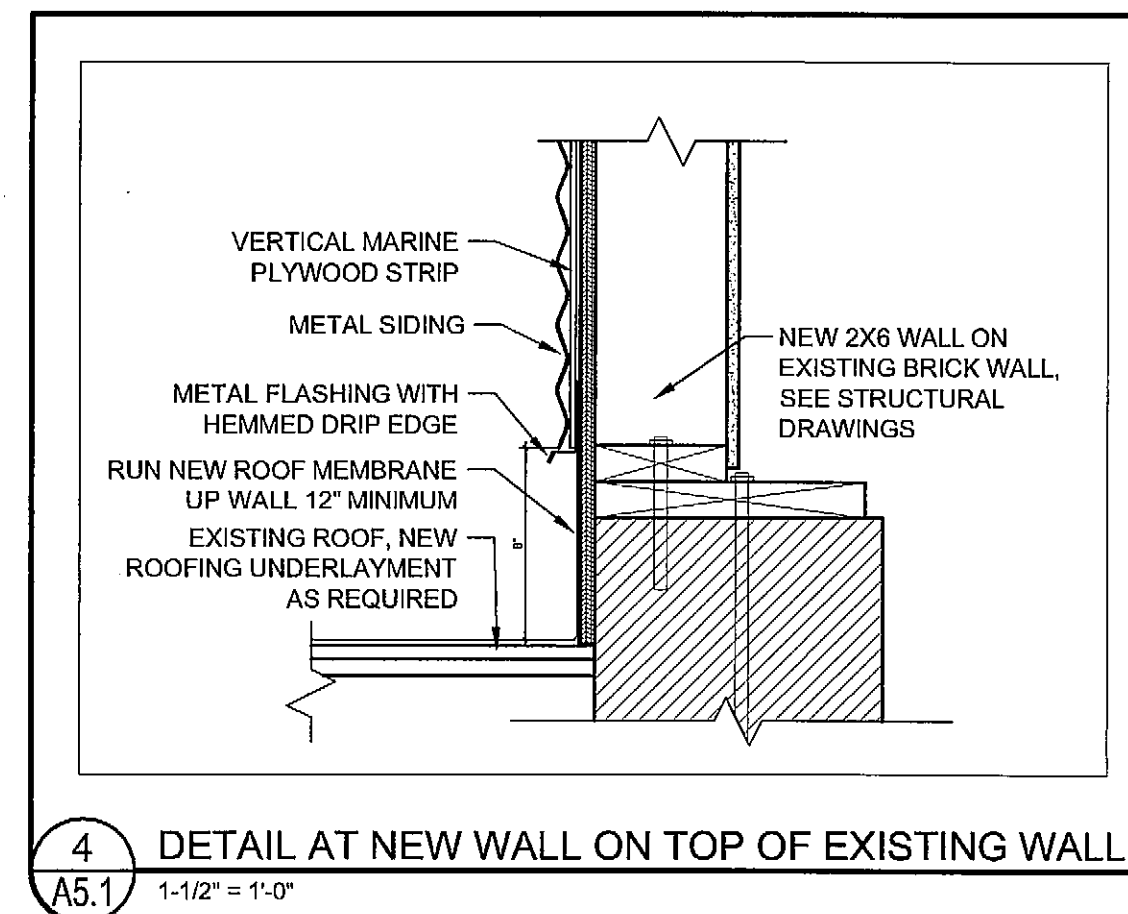

4 DETAIL AT NEW WALL ON TOP OF EXISTING WALL  
A5.1 1-1/2" = 1'-0"

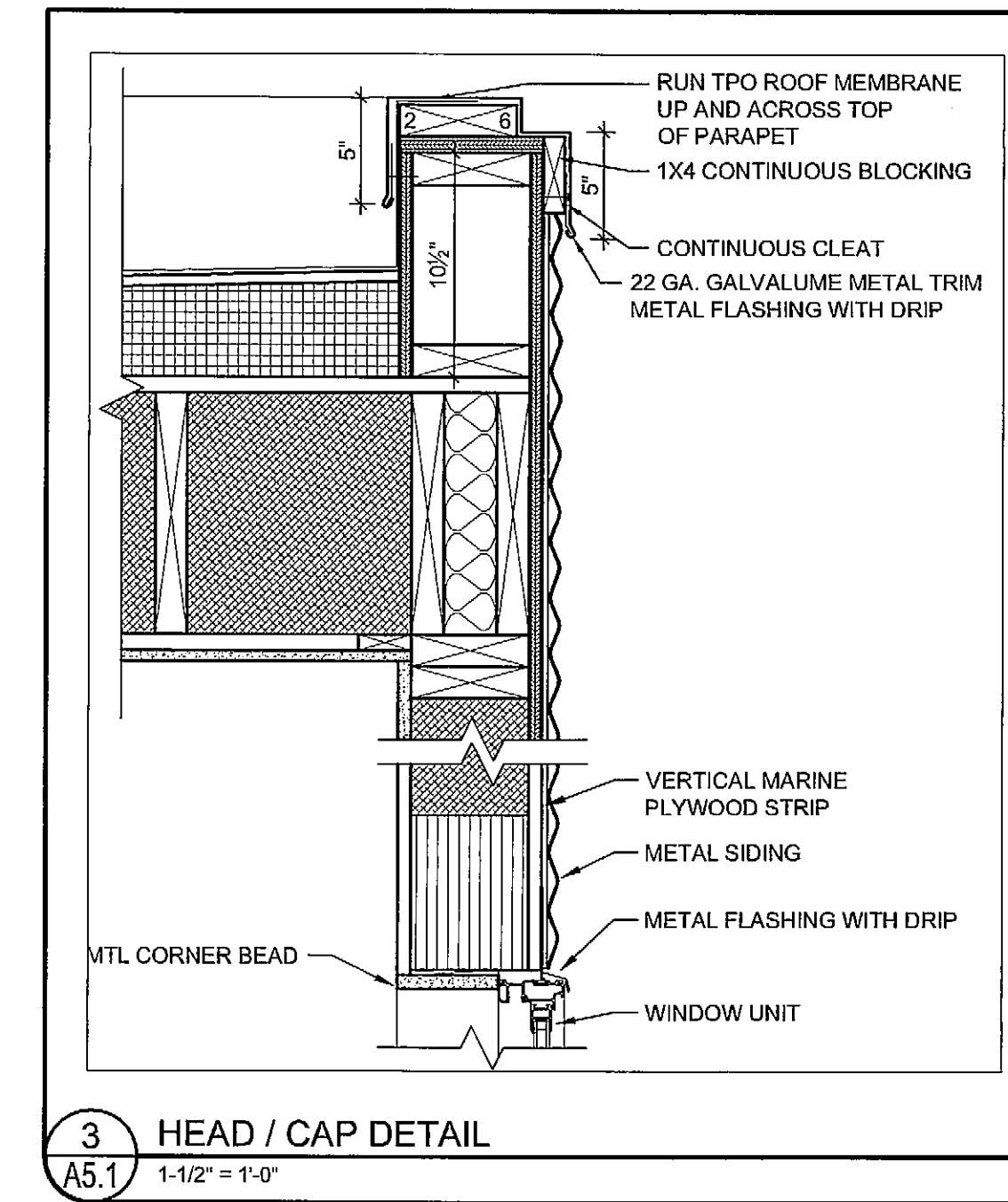

3 HEAD / CAP DETAIL  
A5.1 1-1/2" = 1'-0"

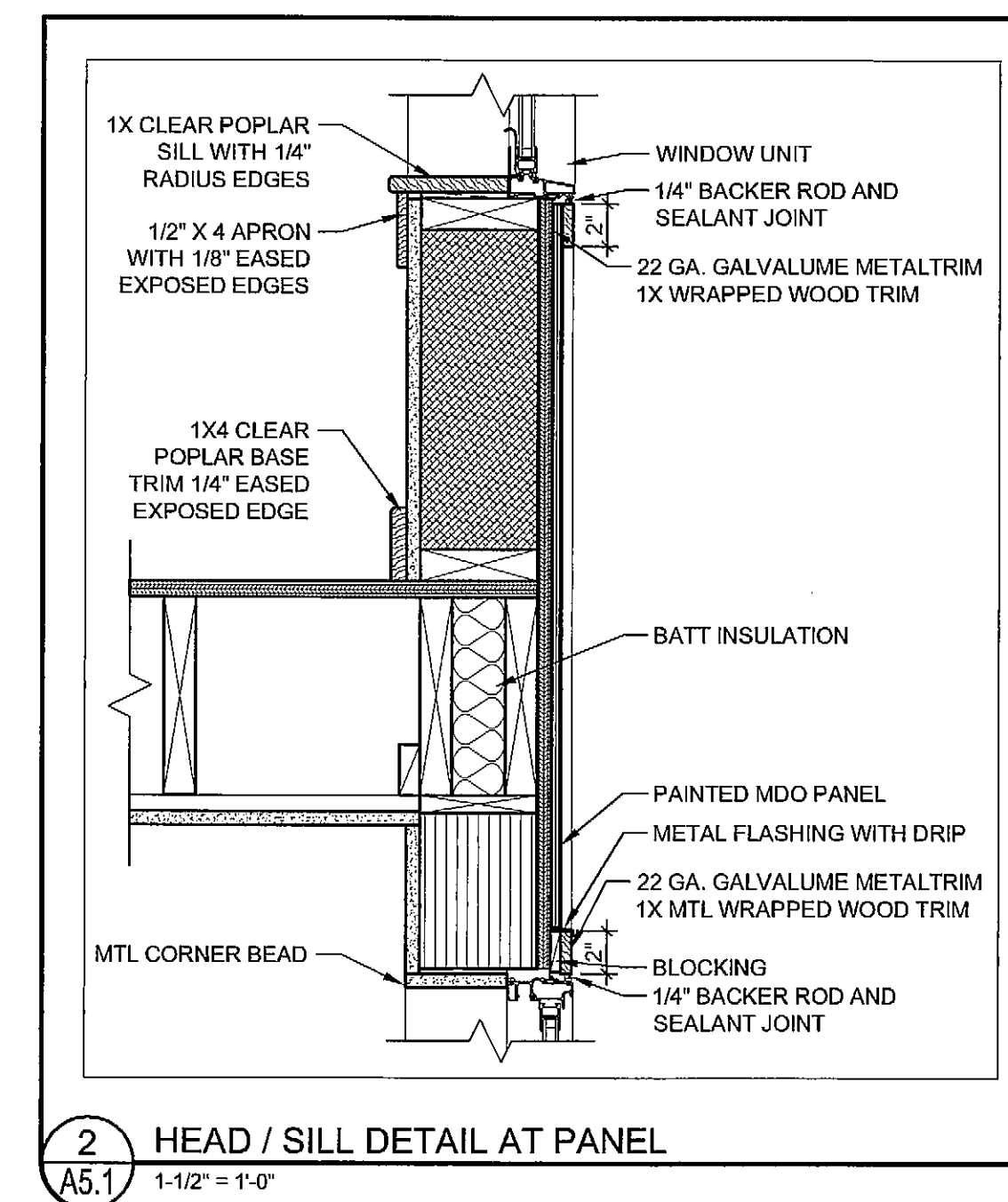

2 HEAD / SILL DETAIL AT PANEL  
A5.1 1-1/2" = 1'-0"

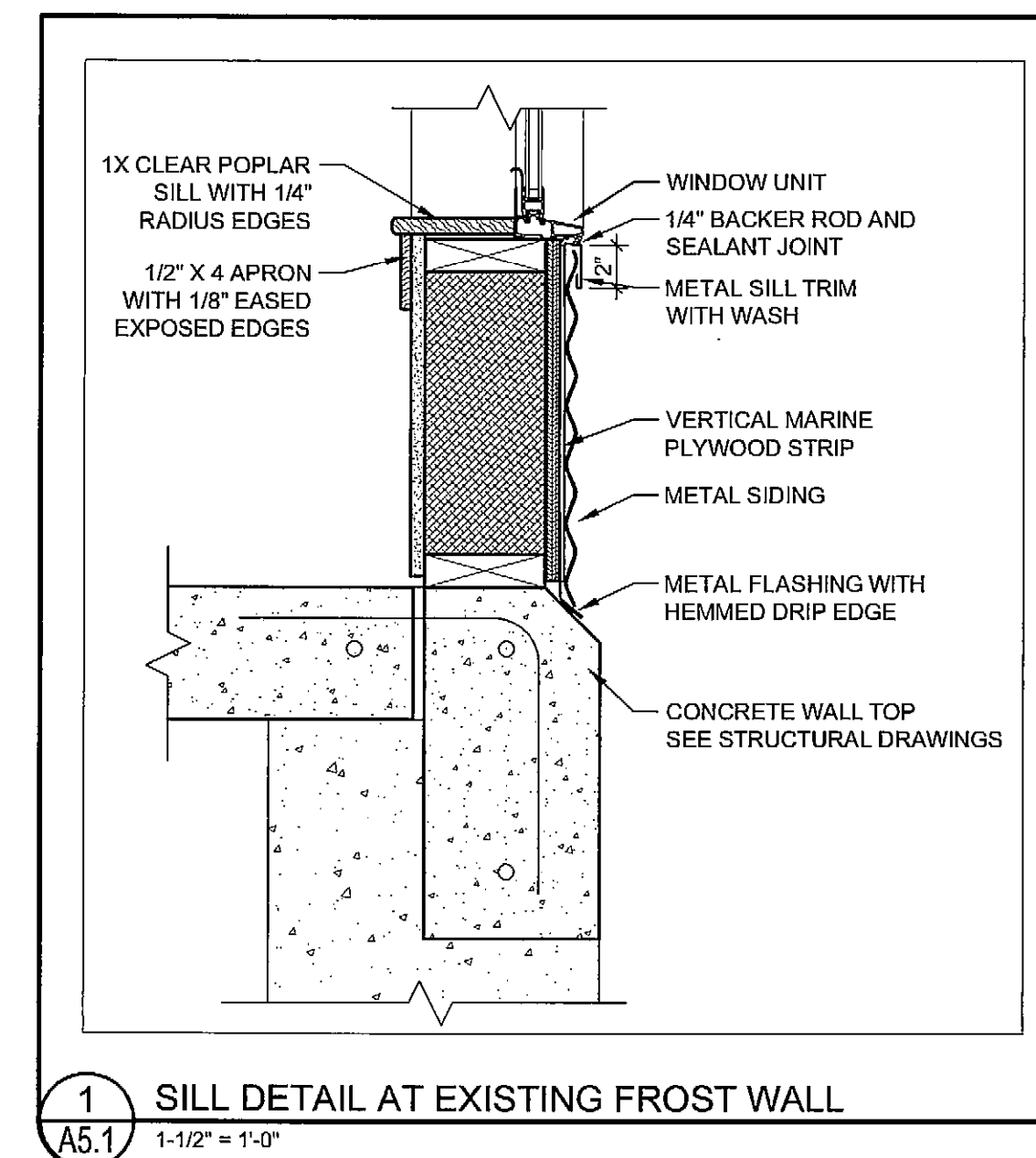

1 SILL DETAIL AT EXISTING FROST WALL  
A5.1 1-1/2" = 1'-0"

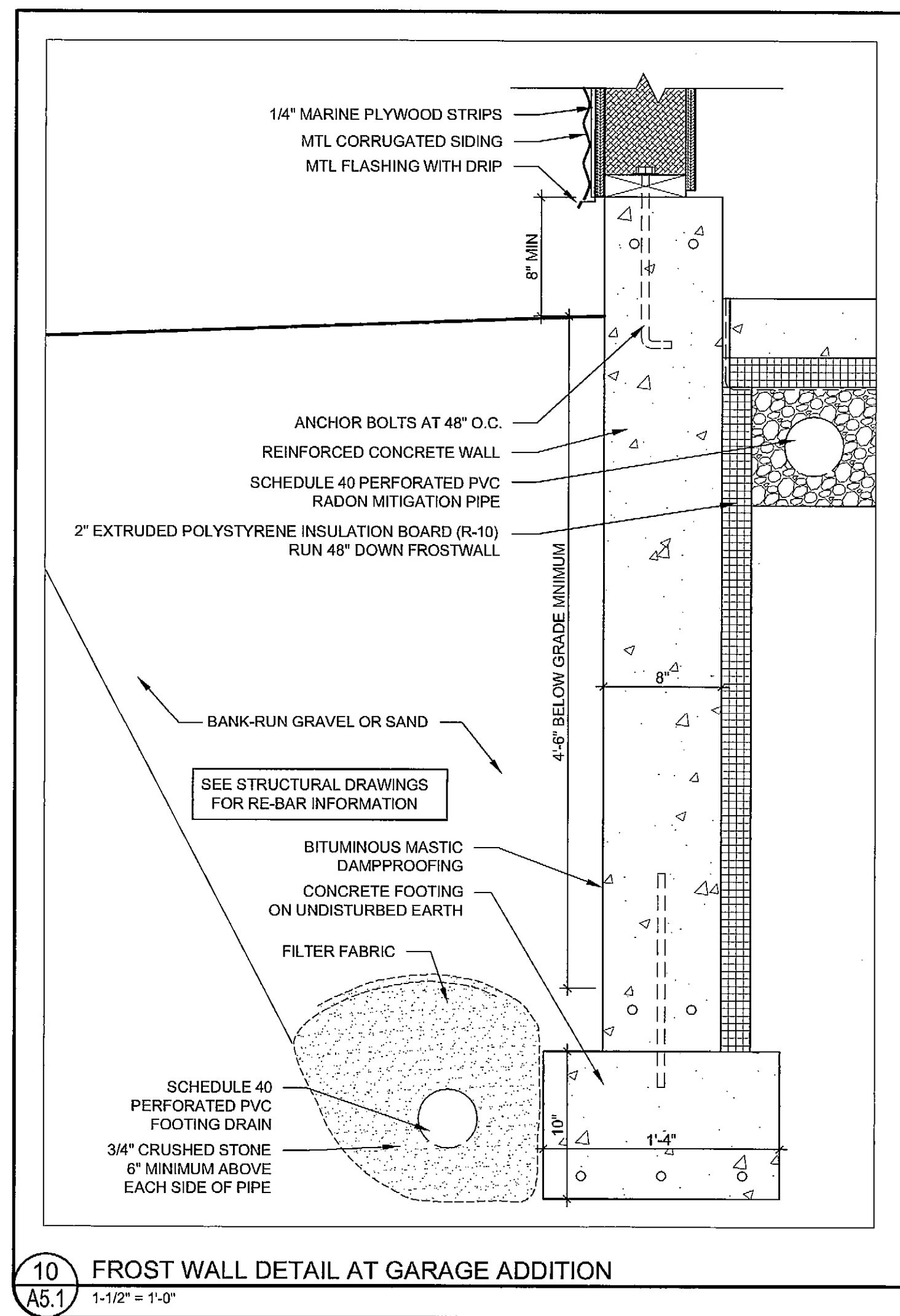

10 FROST WALL DETAIL AT GARAGE ADDITION  
A5.1 1-1/2" = 1'-0"

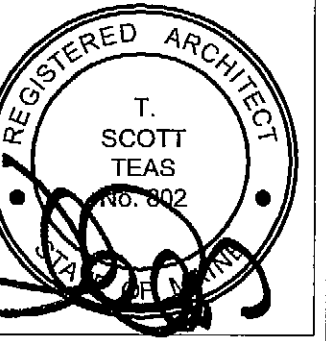

© 2006 TFH ARCHITECTS

ANDERSON STREET INDUSTRIAL CONDOMINIUM

FOR  
WILLIAM P. SIMPSON

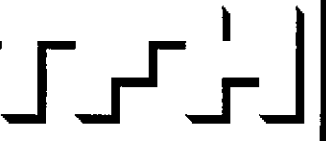

TFH ARCHITECTS  
100 COMMERCIAL STREET  
PORTLAND MAINE 04101  
TELEPHONE 207 775 6141  
ARCHITECTURE PLANNING

CONSULTANTS:

REVISIONS:

DATE: 08/30/06

PROJECT No. 0504

DRAWN BY: RJS

CHECKED BY: TST

SCALE: AS NOTED

SHEET TITLE:  
DETAILS

A5.1