

GENERAL NOTES

- 1. DRAWING NOTES: CONTRACTOR TO FURNISH AND INSTALL ALL NOTED LABOR AND MATERIALS UNLESS OTHERWISE NOTED.
2. CODE COMPLIANCE: ALL WORK SHALL CONFORM TO THE LATEST EDITION OF STATE, LOCAL AND OTHER CODES WHICH APPLY TO THIS PROJECT OR HAVE JURISDICTION.
3. COORDINATION: IT IS THE RESPONSIBILITY OF THE CONTRACTOR TO COORDINATE ALL DISCIPLINES AND TRADES SO THAT ALL BUILDING SYSTEMS AND COMPONENTS CAN BE ASSEMBLED WITHOUT CONFLICTS.
4. DISCREPANCIES & CLARIFICATIONS: THIS PROJECT INVOLVES THE FIT-UP OF AN EXISTING BUILDING. EXISTING DIMENSIONS SHOWN ON THE DRAWINGS ARE BELIEVED TO BE ACCURATE, BUT CANNOT BE GUARANTEED.
5. LAYOUT: UNLESS INDICATED OTHERWISE, CENTER WALL FRAMING AND PARTITION FRAMING ON COLUMN LINES.
6. CENTERING: UNLESS INDICATED OTHERWISE, CENTER BUILDING ELEMENTS WITHIN OR BETWEEN OTHER BUILDING ELEMENTS WHEN CONDITIONS OF THE DRAWINGS INDICATE OR IMPLY THAT SUCH IS THE INTENT.
7. SYMMETRY: WHERE CONDITIONS OR THE DRAWINGS INDICATE OR IMPLY THAT SYMMETRY IS INTENDED, INFORMATION PROVIDED AT ONE SIDE APPLIES EQUALLY TO BOTH SIDES, UNLESS CONDITIONS CLEARLY PRECLUDE SUCH APPLICATION.
8. ACCESSIBILITY: ALL HANDICAPPED ACCESSIBLE BATHROOMS, GRAB BARS, AND DOOR OPENINGS SHALL MEET THE REQUIREMENTS OF TITLE 04-348, CHAPTER 5 OF THE MAINE HUMAN RIGHTS COMMISSION TITLE LATEST EDITION AND THE DEPARTMENT OF JUSTICE ADA STANDARDS FOR ACCESSIBLE DESIGN.
9. DRAWING SCALES: WORK FROM THE GIVEN DIMENSIONS ONLY. SCALE IS INDICATED ON THE DRAWINGS FOR CONVENIENCE ONLY.
10. WATER-RESISTANT GWB: INSTALL WATER-RESISTANT GYPSUM WALL BOARD IN ALL REST ROOMS & TOILET ROOMS OR AT ANY WALL WITH PLUMBING FIXTURES.
10A. HIGH IMPACT GWB: INSTALL HIGH IMPACT GYPSUM WALL BOARD IN ALL STAIRWELLS
11. INTERIOR ELEVATIONS: INTERIOR ELEVATIONS MAY BE REVERSED FROM AND/OR SIMILAR TO ACTUAL CONDITIONS.
12. BUILDING INSULATION: PROVIDE AS INDICATED IN WALL SECTIONS AND IN ACCORDANCE WITH PARTITION TYPES, WHETHER OR NOT SHOWN IN DETAILS AND OTHER DRAWINGS.
13. BLOCKING: INSTALL BLOCKING BEHIND ALL SURFACE APPLIED FIXTURES TRIM, CASEWORK, SHELVES, BRACKETS, TOILET ACCESSORIES, CHAIR RAILS, PICTURE RAILS, GRAB BARS, BASE MOLDINGS, AND AS OTHERWISE REQUIRED.
14. PENETRATIONS AT STRUCTURAL MEMBERS: BEFORE PENETRATING JOISTS, BEAMS OR OTHER STRUCTURAL MEMBERS, CONSULT WITH THE ARCHITECT.
15. DAMAGED WORK: BUILDING OR SITE COMPONENTS WHICH ARE AFFECTED BY NEW WORK, DEMOLITION, OR WHICH MAY BE DAMAGED BY THE GENERAL CONTRACTOR OR ANY SUB-CONTRACTOR SHALL BE REPLACED OR RESTORED TO ORIGINAL CONDITION AND COLOR TO MEET THE APPROVAL OF THE ARCHITECT.
16. UTILITIES: VERIFY THE SIZE AND LOCATION OF ALL UNDERGROUND UTILITIES AND REPORT ANY DISCREPANCIES TO THE ARCHITECT IN WRITING.
17. RATED CONSTRUCTION: PROVIDE RATED CONSTRUCTION AS REQUIRED BY CODE, AS SPECIFIED, AND AS INDICATED ON DRAWINGS.
18. SHOP DRAWINGS: SUBMIT SHOP DRAWINGS TO THE ARCHITECT FOR REVIEW PRIOR TO FABRICATIONS.
19. PERMITS: THE GENERAL CONTRACTOR SHALL OBTAIN AND PAY FOR ANY BUILDING PERMITS REQUIRED AND CARRY ANY INSURANCE COVERAGES REQUIRED.
20. INTERIOR FINISHES: ALL INTERIOR FINISHES AND FURNISHINGS ARE TO BE CLASS 'A' FIRE-RATED AND ARE TO COMPLY WITH SECTION 600.0 BOCA (INTERIOR FLAME SPREAD).
21. ELECTRICAL DESIGN: THE GENERAL CONTRACTOR MUST COORDINATE WITH THE BUILDING OWNER ALL ACTIVITIES INCLUDING BUT NOT LIMITED TO WORK WHICH WILL GENERATE EXCESSIVE NOISE AND MODIFICATION TO UTILITIES.
22. WASTE REMOVAL: THE GENERAL CONTRACTOR SHALL DISPOSE OF ALL WASTE AND DEBRIS OFF THE PREMISES.
23. LANDLORD COORDINATION: THE GENERAL CONTRACTOR MUST COORDINATE WITH THE BUILDING OWNER ALL ACTIVITIES INCLUDING BUT NOT LIMITED TO WORK WHICH WILL GENERATE EXCESSIVE NOISE AND MODIFICATION TO UTILITIES.
24. TEMPORARY FACILITIES: PROVIDE ALL TEMPORARY FACILITIES AND SERVICES, CONSTRUCTION AND SUPPORT FACILITIES, AND SECURITY AND PROTECTION AS NEEDED TO PROTECT NEW AND EXISTING CONSTRUCTION FOR THE DURATION OF A COMPLETE INSTALLATION.
25. FINAL CLEANING: EMPLOY EXPERIENCED WORKERS FOR FINAL CLEANING. CLEAN EACH SURFACE TO THE CONDITION EXPECTED IN A COMMERCIAL BUILDING CLEANING PROGRAM.
26. MANUFACTURER INSTRUCTIONS: ALL MATERIALS & EQUIPMENT SHALL BE INSTALLED ACCORDING TO MANUFACTURER'S SPECIFICATIONS.
27. GUARANTEE: ALL MATERIALS AND WORKMANSHIP SHALL BE GUARANTEED FOR A PERIOD OF ONE YEAR FROM THE DATE OF FINAL ACCEPTANCE UNLESS OTHERWISE SPECIFIED FOR A LONGER PERIOD OF TIME ON A CERTAIN ITEM.
28. ASBESTOS: ALL MATERIAL USED FOR THE CONSTRUCTION OF THIS PROJECT, WHETHER BUILDING MATERIALS OR APPURTENANCES, SHALL BE NON-ASBESTOS CONTAINING MATERIAL.
29. HAZARDOUS FUMES: THE GENERAL CONTRACTOR SHALL CONFIRM THAT ALL MATERIAL AND FINISHES SPECIFIED AND THEIR FABRICATION OR INSTALLATION WILL NOT RELEASE FUMES OR AROMAS DURING CONSTRUCTION WHICH MAY BE A HAZARD OR NUISANCE TO PERSONNEL.
30. PEST CONTROL: SEAL AND CAULK AROUND ALL PENETRATIONS, CRACKS AND CREVICES AND ANY OPENINGS CAPABLE OF HARBORING INSECTS/RODENTS.
31. EXPOSED UTILITIES: ALL EXPOSED UTILITY WIRES AND PIPES (ELECTRICAL, PLUMBING, ETC.) SHALL BE INSTALLED IN A WAY THAT DOES NOT OBSTRUCT OR PREVENT THE CLEANING OF FLOORS, WALLS, AND CEILING AREAS.
32. OWNER SUPPLIED EQUIPMENT: EQUIPMENT SUPPLIED BY THE OWNER AND INSTALLED BY THE GENERAL CONTRACTOR SHALL MAKE ALL FINAL CONNECTIONS AS NOTED ON THE DRAWINGS.
33. FIRE PROTECTION NOTE: EXISTING SPRINKLERHEADS, ALARM SYSTEM AND DETECTORS ARE TO BE MODIFIED TO CONFORM WITH THE PROPOSED PLAN.
34. SOILS AT FOOTINGS: REPORT THE LOCATION OF ALL UNSUITABLE SOILS AND MATERIALS BELOW ANTICIPATED LEVEL OF FOOTING TO THE ARCHITECT PRIOR TO THE SETTING OF FORMS.
35. ACCESS PANELS: CONTRACTOR IS RESPONSIBLE FOR COORDINATING QUANTITY AND LOCATION OF ALL REQUIRED ACCESS PANELS FOR ALL MEP CONTROLS, CLEANOUTS, DAMPERS, PULL BOXES, ETC.
36. EXISTING HAZARDOUS MATERIALS: ALL HAZARDOUS MATERIALS INCLUDING BUT NOT LIMITED TO ASBESTOS AND LEAD PAINT ARE TO BE HANDLED, ENCAPSULATED, ABATED AND DISPOSED OF IN ACCORDANCE WITH ANY AND ALL FEDERAL, STATE AND LOCAL REQUIREMENTS AND REGULATIONS.
37. INDUSTRY STANDARDS: ALL WORK SHALL BE PERFORMED IN ACCORDANCE WITH INDUSTRY STANDARDS.
AAMA ASSOCIATION OF AMERICAN ARCHITECTURAL MANUFACTURERS
ACI AMERICAN CONCRETE INSTITUTE
ANSI AMERICAN NATIONAL STANDARDS INSTITUTE
ASTM AMERICAN SOCIETY FOR TESTING AND MATERIALS
AWI ARCHITECTURAL WOODWORK INSTITUTE
AWS AMERICAN WELDING SOCIETY
IGMA INSULATING GLASS MANUFACTURERS ALLIANCE
NAAMM NATIONAL ASSOCIATION OF ARCHITECTURAL METAL MANUFACTURERS
NRCA NATIONAL ROOFING CONTRACTORS ASSOCIATION
NTCA NATIONAL TILE CONTRACTORS ASSOCIATION
SMACNA SHEET METAL AND AIR CONDITIONING NATIONAL ASSOCIATION
WDMA WINDOW AND DOOR MANUFACTURERS ASSOCIATION

ABBREVIATIONS

Table listing abbreviations and their corresponding full names, such as AC: AIR CONDITIONING, AD: ACQUISITION, ADAG: AMERICANS WITH DISABILITIES ACT, ADD: ADDENDUM, AFF: ABOVE FINISHED FLOOR, etc.

FIRESTOPPING DETAILS

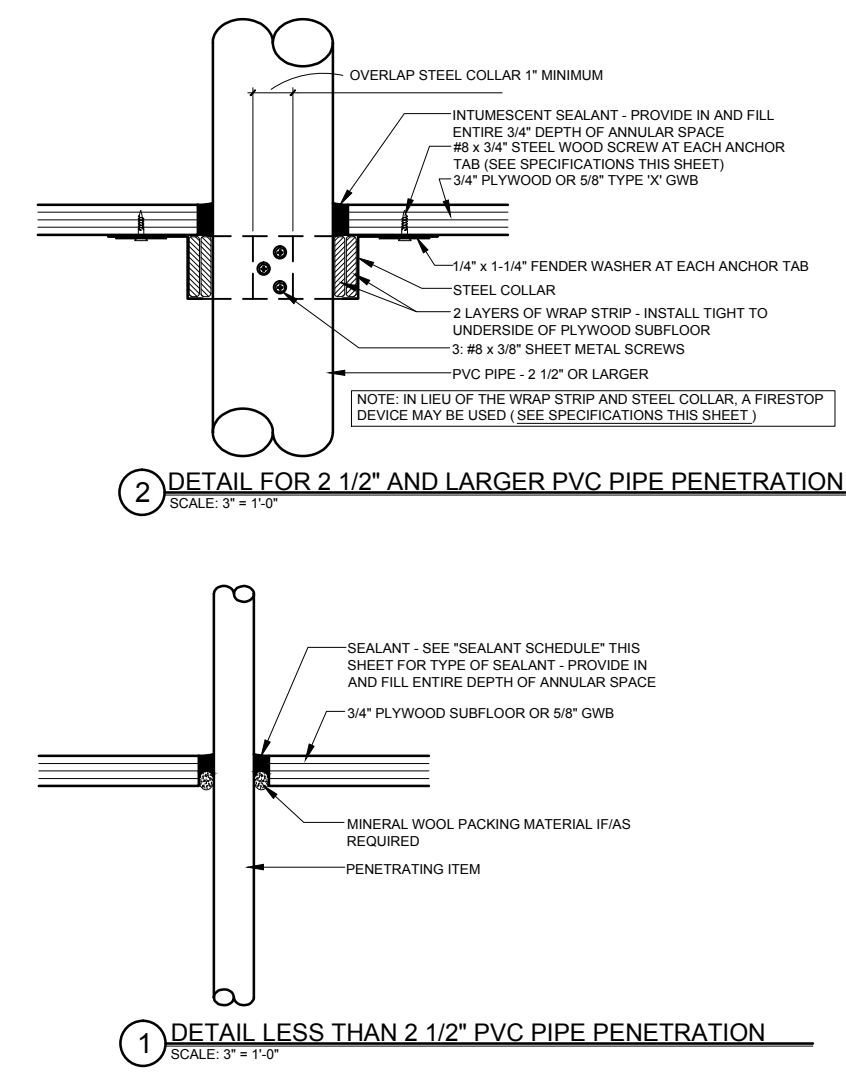

SPECIFICATIONS

WRAP STRIP: 1/4\" STEEL COLLAR: WRAP STRIP MANUFACTURER'S STEEL COLLAR, FABRICATED FROM .016 INCH THICK GALVANIZED SHEET STEEL. WIDTH TO MATCH WRAP STRIP (1 1/2\" FIRESTOP SEALANT: SINGLE COMPONENT NONCOMBUSTIBLE FIRE RATED SEALANT TESTED TO ASTM E 814. TESTED TO 3000\"F. F008S 150 FIRESTOP/GRABT SEALANT MANUFACTURED BY ACCUMETRIC, LLC. OR EQUAL.

WALL TYPES

- GENERAL PARTITION NOTES:
1.) AT ALL FIRE WALLS, GENERAL CONTRACTOR TO CONFIRM THAT ALL WALLS ARE TIGHT TO ROOF AND/OR FLOOR DECK ABOVE.
2.) G.C. TO PROVIDE FIRE CAULKING AND BLOCKING AS REQUIRED AT ALL TOP OF WALLS AT CORRUGATED DECK FLUTES AND VOIDS.
3.) REFER TO STRUCTURAL DRAWINGS FOR STUD SIZE AND SPACING
4.) INSTALL WATER-RESISTANT GYPSUM WALL BOARD IN ALL RESTROOMS AND TOILET ROOMS WALLS AND CEILINGS.
5.) ALL PARTITION TYPES WITH AN INSULATION COMPONENT TO BE ACOUSTICALLY SEALED.
6.) COORDINATE FINISHES WITH ROOM FINISH SCHEDULE.
7.) PENETRATIONS THROUGH RATED WALLS AND CEILING ASSEMBLIES SHALL HAVE SEALANTS CONFORMING TO RATING REQUIREMENTS.
8.) CONTRACTOR TO VERIFY WALL LOCATIONS IN FIELD AND COORDINATE WITH EXISTING PIPE LOCATIONS.
9.) ALL PARTITIONS TYPE NA-B, UNLESS OTHERWISE NOTED.
10.) HOLD BOTTOM EDGE OF GWB UP FROM CONCRETE TYPICAL
11.) PROVIDE MID SPAN METAL BLOCKING AT ALL WALLS OVER 9\"
12.) PROVIDE SOLID BLOCKING IN WALLS AND PARTITIONS FOR ALL WALL MOUNTED ITEMS (GRAB BARS, CABINETS, COUNTERS, SHELVES, ETC.)

Table for one-hour fire-rated partition types. Columns: KEY, UL / GA RATING, DESCRIPTION. Rows: NA, NB, NC.

ONE HOUR FIRE RATED PARTITION TYPES

Table for one-hour fire-rated partition types with descriptions. Columns: KEY, UL / GA RATING, DESCRIPTION. Rows: 1A, 1B, 1C.

CEILING ASSEMBLIES

Table for ceiling assemblies. Columns: KEY, UL / GA RATING, DESCRIPTION. Row: C1.

DRAWING LEGEND

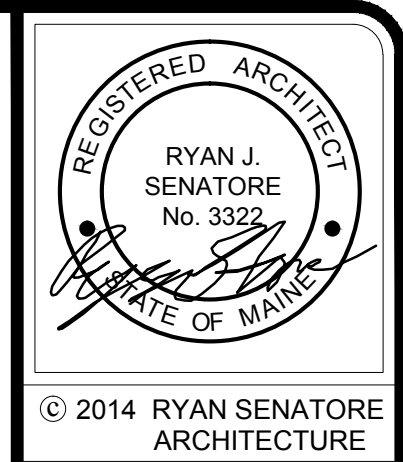
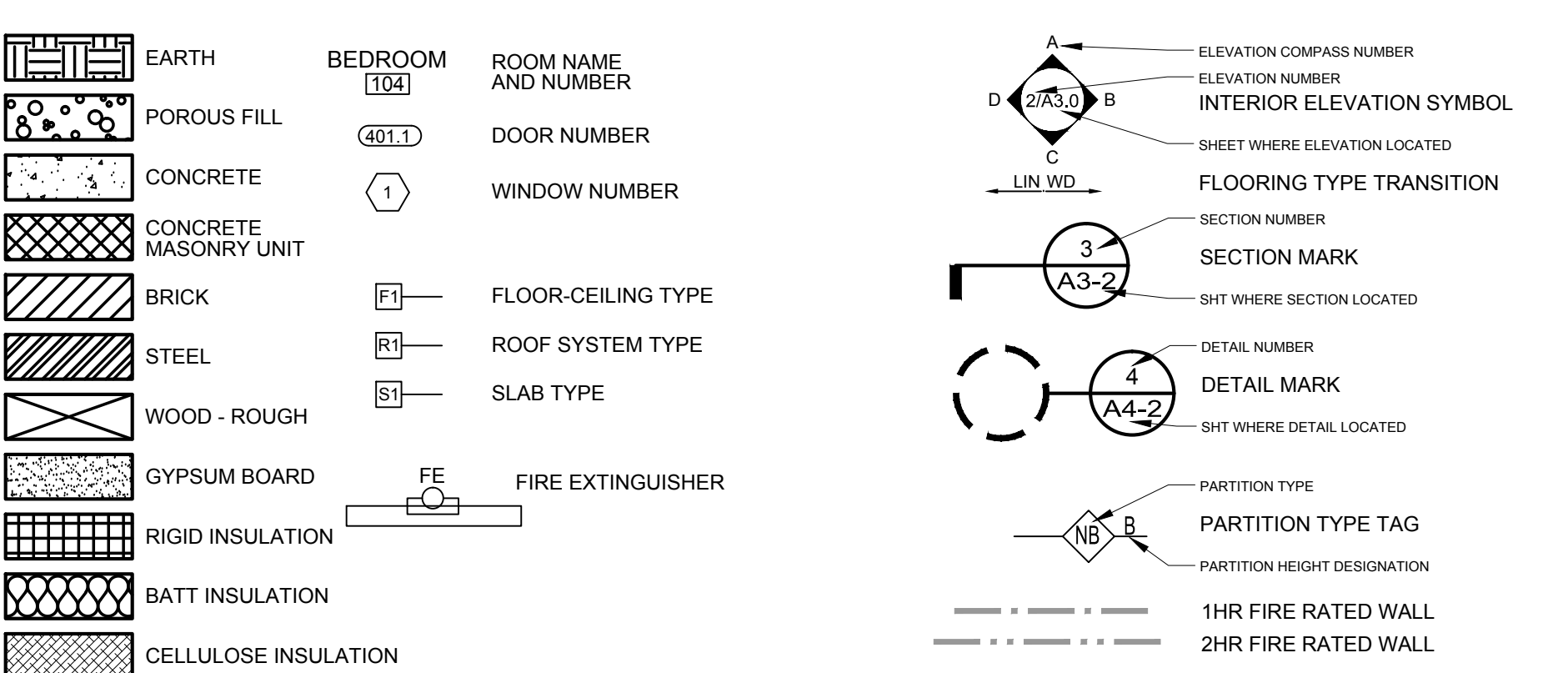

© 2014 RYAN SENATORE ARCHITECTURE

RENOVATIONS TO
170 ANDERSON STREET
PORTLAND, MAINE



RYAN SENATORE ARCHITECTURE
506 CONGRESS STREET SUITE 304
PORTLAND, MAINE 04101
707-650-6414
senatorearchitecture.com

CONSULTANTS:
STRUCTURAL: Structural Integrity
MECHANICAL: RJS
ELECTRICAL: RJS
PLUMBING: RJS
PORTLAND, ME 04101
207-754-0814

Table with project information: REVISIONS, DATE: MAY 09, 2014, PROJECT No.: 1416, DRAWN BY: RJS / RRT, CHECKED BY: RJS, SCALE: AS NOTED.

SHEET TITLE: GENERAL NOTES ABBREVIATIONS LEGEND AND WALL TYPES

G1-0