

THIS PLAN HAS BEEN DEVELOPED AS A STRATEGY TO CONTROL SOIL EROSION AND SEDIMENTATION DURING AND AFTER CONSTRUCTION. THE PLAN IS BASED ON THE STANDARDS AND SPECIFICATIONS FOR EROSION PREVENTION IN CONSTRUCTION AND MAINTENANCE OF ROADWAYS, MAINTENANCE OF AIRPORTS, AND THE STANDARDS AND SPECIFICATIONS FOR ENVIRONMENTAL PROTECTION DATED MARCH 2002. FOR ADDITIONAL DETAILS AND SPECIFICATIONS, SEE THE PLAN'S MANUAL.

1. ALL SLOPES AND EROSION CONTROL MEASURES SHALL BE INSTALLED IN ACCORDANCE WITH THE MAINE EROSION AND SEDIMENT CONTROL BEST MANAGEMENT PRACTICES, DEPARTMENT OF ENVIRONMENTAL PROTECTION, DATED MARCH 2002.
2. THESE AREAS UNDERGOING ACTUAL CONSTRUCTION WILL BE LEFT IN AN UNIMPAIRED OR UNDISTURBED CONDITION FOR A MINIMUM. THESE AREAS SHALL BE PERMANENTLY STABILIZED WITHIN 7 DAYS OF FINAL COMPLETION AND REMAIN STABILIZED THROUGHOUT THE LIFE OF THE PROJECT. STABILIZATION SHALL BE COMPLETED 48 HOURS PRIOR TO ANY STORM EVENT (THIS WOULD INCLUDE WETLANDS).
3. SEDIMENT BARRIERS (EROSION CONTROL MAT, STONE CHECK DAMS, STABILIZED CONSTRUCTION ENTRANCE, ETC.) SHOULD BE INSTALLED FROM TOP TO BOTTOM OF ANY DISTURBED OR UNSTABILIZED AREAS PRIOR TO ANY WORK.
4. INSTALL EROSION CONTROL MAT WILL BEADON TO PROTECT FROM PLANT ROOT DAMAGE. SEE E.C.M. DETAIL FOR PROPER INSTALLATION. EROSION CONTROL MAT WILL BEADON TO PROTECT FROM PLANT ROOT DAMAGE.
5. ALL EROSION CONTROL STRUCTURES SHALL BE UNDISTURBED FOR A PERIOD OF 30 DAYS AND SHALL BE MAINTAINED AND REPAIRED AS NECESSARY. SEDIMENT DEPOSITS SHALL BE REMOVED AFTER THE BARRIERS ARE REMOVED. EROSION CONTROL MAT SHALL BEADON TO PROTECT FROM PLANT ROOT DAMAGE. EROSION CONTROL MAT SHALL BEADON TO PROTECT FROM PLANT ROOT DAMAGE.
6. NO SLOPES SHALL BE LEFT UNPROTECTED FOR A PERIOD OF 30 DAYS.
7. IF FINAL SEEDING OF A DISTURBED AREA IS NOT COMPLETED 48 HOURS PRIOR TO THE FIRST KILLING FROST, SEEDING UNTIL THE NEXT RECOMMENDED SEEDING PERIOD.
8. TEMPORARY SEEDING OF DISTURBED AREAS THAT HAVE NOT BEEN FINAL GRADED SHALL BE COMPLETED BY AUG. 15 OR 45 DAYS PRIOR TO THE FIRST KILLING FROST (OCT. 1) TO PROTECT FROM SPRING RUNOFF PROBLEMS.
9. DURING THE CONSTRUCTION PHASE, UNEXPECTED SEDIMENT WILL BE RETURNED TO THE SITE AND RECYCLED INTO OPEN AREAS. POST SEEDING SEDIMENT, IF ANY, WILL BE DISPOSED OF IN AN ACCEPTABLE MANNER.
10. REGENERATION MEASURES NOT OTHERWISE STABILIZED WILL BE GRASSED, SMOOTHED, AND PREPARED FOR FINAL SEEDING AS FOLLOWS:
11. ALL TEMPORARY EROSION CONTROL MEASURES SHALL BE REMOVED WITHIN 30 DAYS OF THE DATE THE SITE IS STABILIZED. MATS SHALL BE REMOVED WITHIN 72 HOURS OF THE DATE OF THE WETLAND OR BOUNDARY OF WETLAND DISTURBANCE.

1. APPLY LIMESTONE AND FERTILIZER ACCORDING TO SOIL TEST. IF SOIL TESTING IS NOT FEASIBLE, ON-SITE OR AVAILABLE TESTS OR WETWEIGHT TESTS OR OTHER TESTS MAY BE USED. (SEE THE PLAN FOR EQUIVALENTS) APPLY GROUND LIMESTONE (EQUVALENT TO 20% CALCIUM PLUS MAGNESIUM OXIDE) AT A RATE OF 3 TONS PER ACRE (138 LB PER 1,000 SQ. FT.).
2. ALL DISTURBED AREAS SHALL BE SEEDED WITHIN 72 HOURS OF THE DATE THE SITE IS STABILIZED. SEED SHALL BE BROADCAST OR PLANTED AT A RATE OF 1/2 BUSHEL PER ACRE (15 LB PER 1,000 SQ. FT.) FOR SOY BEANS, 1/4 BUSHEL PER ACRE (15 LB PER 1,000 SQ. FT.) FOR CORN, AND 1/4 BUSHEL PER ACRE (15 LB PER 1,000 SQ. FT.) FOR WHEAT. SEED SHALL BE COVERED WITHIN 72 HOURS OF THE DATE THE SITE IS STABILIZED. SEED SHALL BE COVERED WITHIN 72 HOURS OF THE DATE THE SITE IS STABILIZED. SEED SHALL BE COVERED WITHIN 72 HOURS OF THE DATE THE SITE IS STABILIZED.
3. MAINTENANCE MEASURES SHALL BE APPLIED AS REQUIRED DURING THE ENTIRE CONSTRUCTION SEASON. AFTER EACH RAINFALL, SNOW STORM OR PERIOD OF DRYING AND WINDING, THE SITE CONTRACTOR SHALL PERFORM A VISUAL INSPECTION OF ALL EROSION CONTROL MEASURES. FOLLOWING THE VISUAL INSPECTION, THE CONTRACTOR SHALL TAKE THE NECESSARY ACTION TO MAINTAIN AND REPAIR THE MEASURES. THE CONTRACTOR SHALL MAINTAIN A MINIMUM OF 50 TO 75% OF AREAS COVERED WITH VEGETATION GROWTH.
4. DURING WINTER CONSTRUCTION PERIOD, ALL SNOW SHALL BE REMOVED FROM AREAS OF SEEDING AND MULCHING PRIOR TO PLACEMENT.
5. AREAS WITHIN 100 FEET OF STREAMS THAT ARE NOT STABILIZED WITH VEGETATION BY DEC. 1 SHALL BE MULCHED WITH STRAW OR BARK. AREAS WITHIN 100 FEET OF STREAMS THAT ARE NOT STABILIZED WITH VEGETATION BY DEC. 1 SHALL BE MULCHED WITH STRAW OR BARK.

LOCATION	MULCH	RATE (TYPICAL)
PROTECTED AREA	STRAW OR HAY	100 POUNDS
WOOD AREAS	SPRINKLED OR CHIPPED	185-215 POUNDS

MULCH SHALL BE APPLIED AS FOLLOWS:
 • MEDIUM-GRADE MULCH OR EQUIVALENT SHALL BE APPLIED FOLLOWING SEEDING. A SUITABLE BINDER SUCH AS CORKFLOR OR RUB MULCH SHALL BE USED ON HAY MULCH FOR WIND CONTROL.
 • HYPER-APPLICATION OF ASPHALT, WOOD, OR PAPER FIBER MAY BE APPLIED FOLLOWING SEEDING. A SUITABLE BINDER SUCH AS CORKFLOR OR RUB MULCH SHALL BE USED ON HAY MULCH FOR WIND CONTROL.
 • ADDITIONAL TEMPORARY MULCH (FOR PERIODS LESS THAN 12 MONTHS):
 Season: Seed Rate
 Summer (5/15 - 8/15): 60 lb/acre
 Fall (8/15 - 11/1): 80 lb/acre
 Spring (3/1 - 7/1): 40 lb/acre

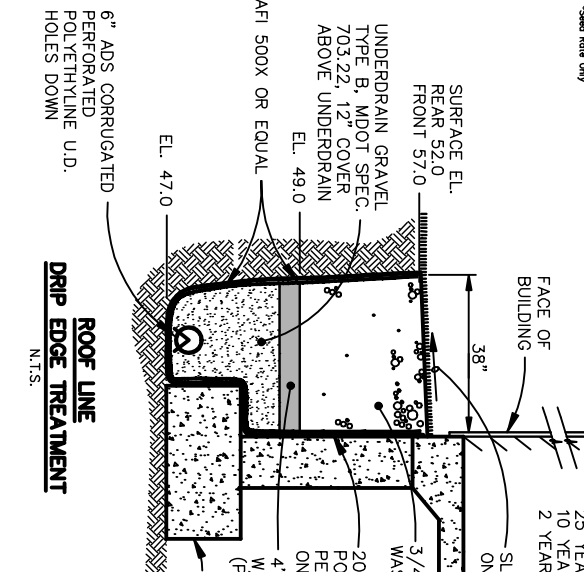

1. WINTER CONSTRUCTION PERIOD: OCTOBER 1 THROUGH APRIL 15.
2. WITHOUT STABILIZATION AT ANY ONE TIME.
3. EXPOSED AREA SHOULD BE LIMITED TO THAT WHICH CAN BE MULCHED IN ONE DAY PRIOR TO ANY SNOW EVENT.
4. CONSTRUCTION OF DRAINAGE OPERATIONS ON DISTURBED AREAS SHALL NOT BEGIN UNTIL THE EXPOSED SOIL IS WITHOUT EROSION CONTROL PROTECTION. STABILIZED AREAS SHALL NOT BE RE-EXPOSED TO THE ELEMENTS OF WEATHER UNTIL THE SOIL IS PROTECTED BY AN EROSION CONTROL MEASURE.
5. DISTURBED AREAS SHALL BE MULCHED WITHIN 72 HOURS OF THE DATE THE SOIL IS EXPOSED. MULCH SHALL BE APPLIED TO THE ENTIRE EXPOSED AREA, INCLUDING THE AREAS OF THE SOIL THAT ARE NOT STABILIZED WITH VEGETATION.
6. MULCH SHALL BE APPLIED TO THE ENTIRE EXPOSED AREA, INCLUDING THE AREAS OF THE SOIL THAT ARE NOT STABILIZED WITH VEGETATION.

1. MULCH SHALL BE APPLIED TO THE ENTIRE EXPOSED AREA, INCLUDING THE AREAS OF THE SOIL THAT ARE NOT STABILIZED WITH VEGETATION.
2. MULCH SHALL BE APPLIED TO THE ENTIRE EXPOSED AREA, INCLUDING THE AREAS OF THE SOIL THAT ARE NOT STABILIZED WITH VEGETATION.
3. MULCH SHALL BE APPLIED TO THE ENTIRE EXPOSED AREA, INCLUDING THE AREAS OF THE SOIL THAT ARE NOT STABILIZED WITH VEGETATION.
4. MULCH SHALL BE APPLIED TO THE ENTIRE EXPOSED AREA, INCLUDING THE AREAS OF THE SOIL THAT ARE NOT STABILIZED WITH VEGETATION.
5. MULCH SHALL BE APPLIED TO THE ENTIRE EXPOSED AREA, INCLUDING THE AREAS OF THE SOIL THAT ARE NOT STABILIZED WITH VEGETATION.
6. MULCH SHALL BE APPLIED TO THE ENTIRE EXPOSED AREA, INCLUDING THE AREAS OF THE SOIL THAT ARE NOT STABILIZED WITH VEGETATION.

1. MULCH SHALL BE APPLIED TO THE ENTIRE EXPOSED AREA, INCLUDING THE AREAS OF THE SOIL THAT ARE NOT STABILIZED WITH VEGETATION.
2. MULCH SHALL BE APPLIED TO THE ENTIRE EXPOSED AREA, INCLUDING THE AREAS OF THE SOIL THAT ARE NOT STABILIZED WITH VEGETATION.
3. MULCH SHALL BE APPLIED TO THE ENTIRE EXPOSED AREA, INCLUDING THE AREAS OF THE SOIL THAT ARE NOT STABILIZED WITH VEGETATION.
4. MULCH SHALL BE APPLIED TO THE ENTIRE EXPOSED AREA, INCLUDING THE AREAS OF THE SOIL THAT ARE NOT STABILIZED WITH VEGETATION.
5. MULCH SHALL BE APPLIED TO THE ENTIRE EXPOSED AREA, INCLUDING THE AREAS OF THE SOIL THAT ARE NOT STABILIZED WITH VEGETATION.
6. MULCH SHALL BE APPLIED TO THE ENTIRE EXPOSED AREA, INCLUDING THE AREAS OF THE SOIL THAT ARE NOT STABILIZED WITH VEGETATION.

1. MULCH SHALL BE APPLIED TO THE ENTIRE EXPOSED AREA, INCLUDING THE AREAS OF THE SOIL THAT ARE NOT STABILIZED WITH VEGETATION.
2. MULCH SHALL BE APPLIED TO THE ENTIRE EXPOSED AREA, INCLUDING THE AREAS OF THE SOIL THAT ARE NOT STABILIZED WITH VEGETATION.
3. MULCH SHALL BE APPLIED TO THE ENTIRE EXPOSED AREA, INCLUDING THE AREAS OF THE SOIL THAT ARE NOT STABILIZED WITH VEGETATION.
4. MULCH SHALL BE APPLIED TO THE ENTIRE EXPOSED AREA, INCLUDING THE AREAS OF THE SOIL THAT ARE NOT STABILIZED WITH VEGETATION.
5. MULCH SHALL BE APPLIED TO THE ENTIRE EXPOSED AREA, INCLUDING THE AREAS OF THE SOIL THAT ARE NOT STABILIZED WITH VEGETATION.
6. MULCH SHALL BE APPLIED TO THE ENTIRE EXPOSED AREA, INCLUDING THE AREAS OF THE SOIL THAT ARE NOT STABILIZED WITH VEGETATION.

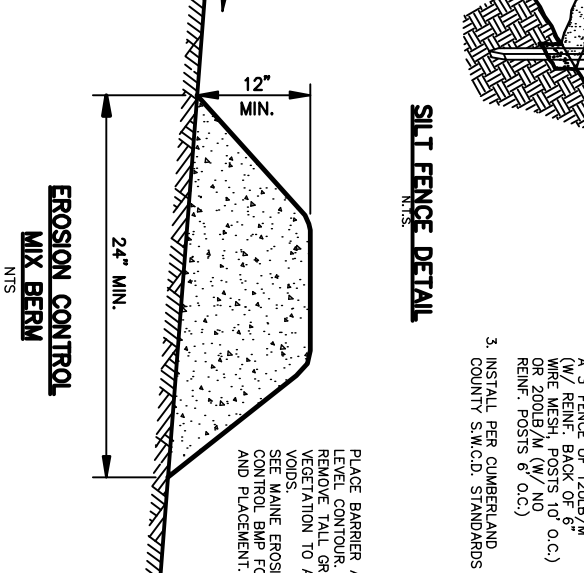
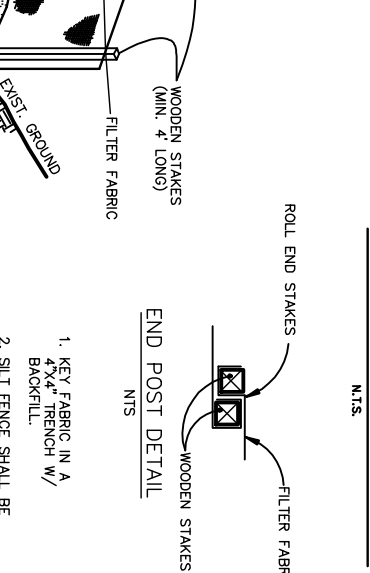
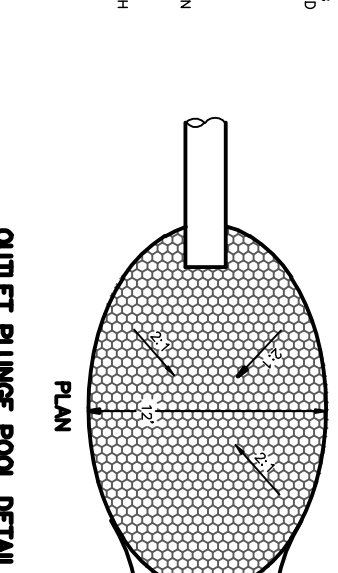
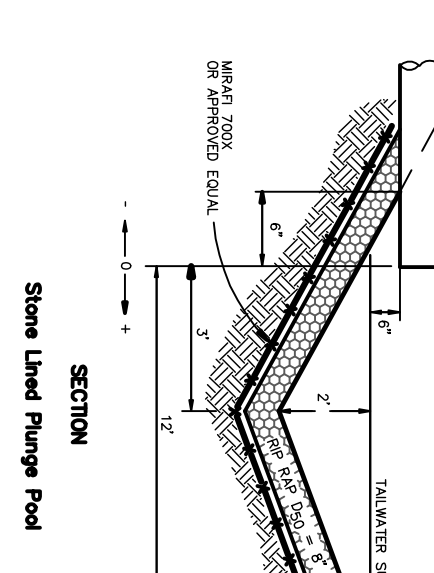
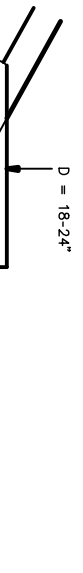
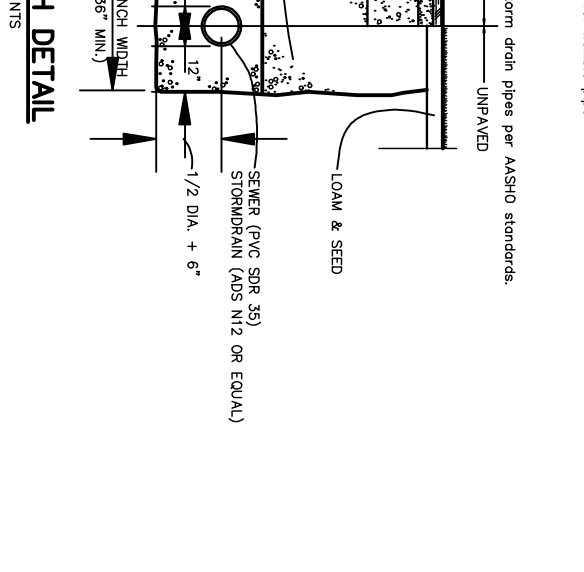
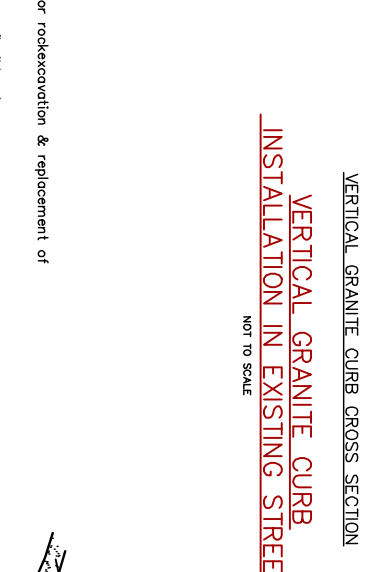
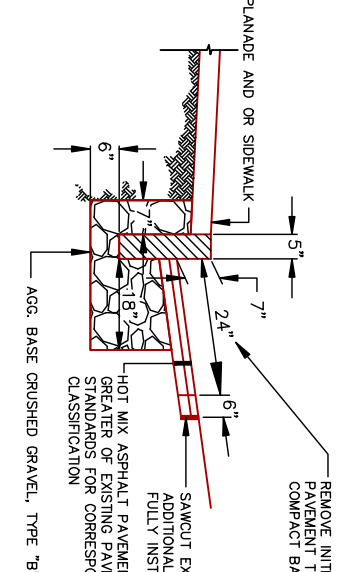
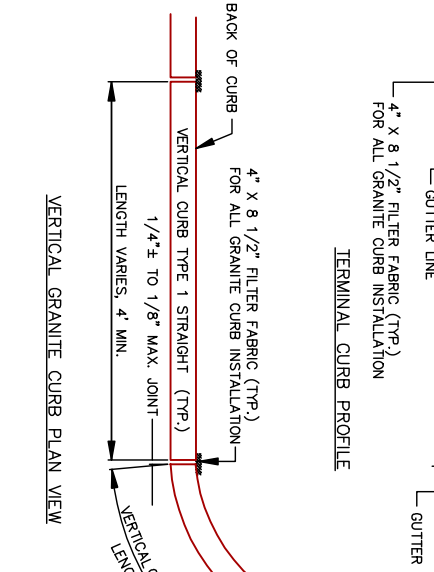
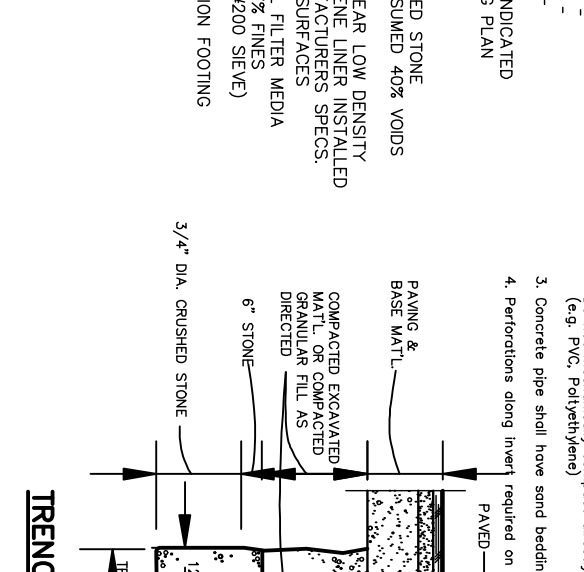

1. TRENCH WIDTH SHOWN IS POLYMER WIDTH FOR ROCKEXCAVATION & REPLACEMENT OF UNSUITABLE MATERIAL.
2. DO NOT MECHANICALLY COMPACT DIRECTLY OVER FLEXIBLE PIPE.
3. CONCRETE PIPE SHALL HAVE SAND BEDDING.
4. PERFORATIONS ALONG INVERT REQUIRED ON STORM DRAIN PIPES PER AASHTO STANDARDS.

1. TRENCH WIDTH SHOWN IS POLYMER WIDTH FOR ROCKEXCAVATION & REPLACEMENT OF UNSUITABLE MATERIAL.
2. DO NOT MECHANICALLY COMPACT DIRECTLY OVER FLEXIBLE PIPE.
3. CONCRETE PIPE SHALL HAVE SAND BEDDING.
4. PERFORATIONS ALONG INVERT REQUIRED ON STORM DRAIN PIPES PER AASHTO STANDARDS.

1. TRENCH WIDTH SHOWN IS POLYMER WIDTH FOR ROCKEXCAVATION & REPLACEMENT OF UNSUITABLE MATERIAL.
2. DO NOT MECHANICALLY COMPACT DIRECTLY OVER FLEXIBLE PIPE.
3. CONCRETE PIPE SHALL HAVE SAND BEDDING.
4. PERFORATIONS ALONG INVERT REQUIRED ON STORM DRAIN PIPES PER AASHTO STANDARDS.

1. TRENCH WIDTH SHOWN IS POLYMER WIDTH FOR ROCKEXCAVATION & REPLACEMENT OF UNSUITABLE MATERIAL.
2. DO NOT MECHANICALLY COMPACT DIRECTLY OVER FLEXIBLE PIPE.
3. CONCRETE PIPE SHALL HAVE SAND BEDDING.
4. PERFORATIONS ALONG INVERT REQUIRED ON STORM DRAIN PIPES PER AASHTO STANDARDS.

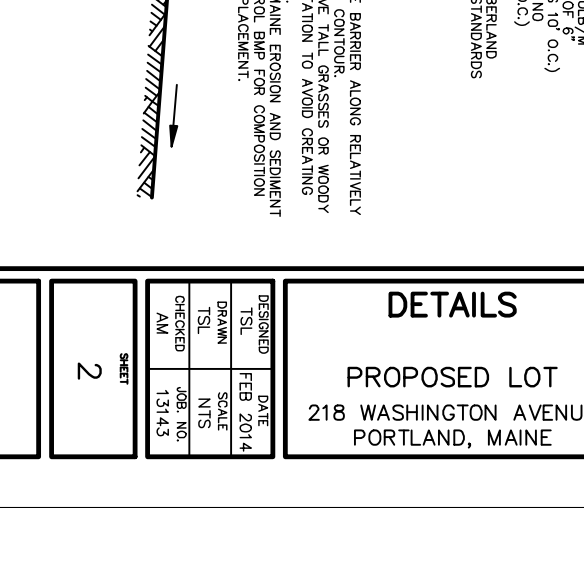

NO.	DATE	REVISION	DESCRIPTION
1	3/7/14	Revised	Per City of Portland Comments

STATE OF MAINE
 ANDREW S. BROWN
 No. 12285
 Professional Engineer

BH2M
 Berry, Huff, McDonald, Milligan Inc.
 Engineers, Surveyors

FOR:
 Melinda Schott
 3 Red Mill Way
 Cumberland, Maine 04021

DETAILS	
DESIGNED	TSL
DRAWN	FEB 2014
CHECKED	JOB NO.
	AM
SHEET	2

PROPOSED LOT
 218 WASHINGTON AVENUE
 PORTLAND, MAINE