

REVISIONS
▲ 20 JULY '17
▲ 18 AUGUST '17

DRAWING NAME

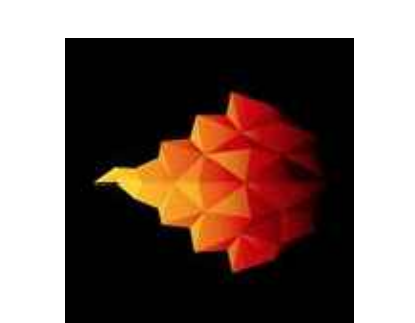

**GOODFIRE
BREWING COMPANY**
219 ANDERSON TREET
PORTLAND, MAINE 04102

SHEET

**BREWERY
EQUIPMENT
PLAN**

DATE
30 MAY 2017
SCALE
1/4"=1'-0"
DRAWN
MFH/mgk
JOB NO.
161001
SHEET

A-7

COPYRIGHT
REPRODUCTION OR RELY OF THIS
DOCUMENT WITHOUT WRITTEN
PERMISSION FROM GRANT HAYS/
ASSOCIATES IS PROHIBITED.

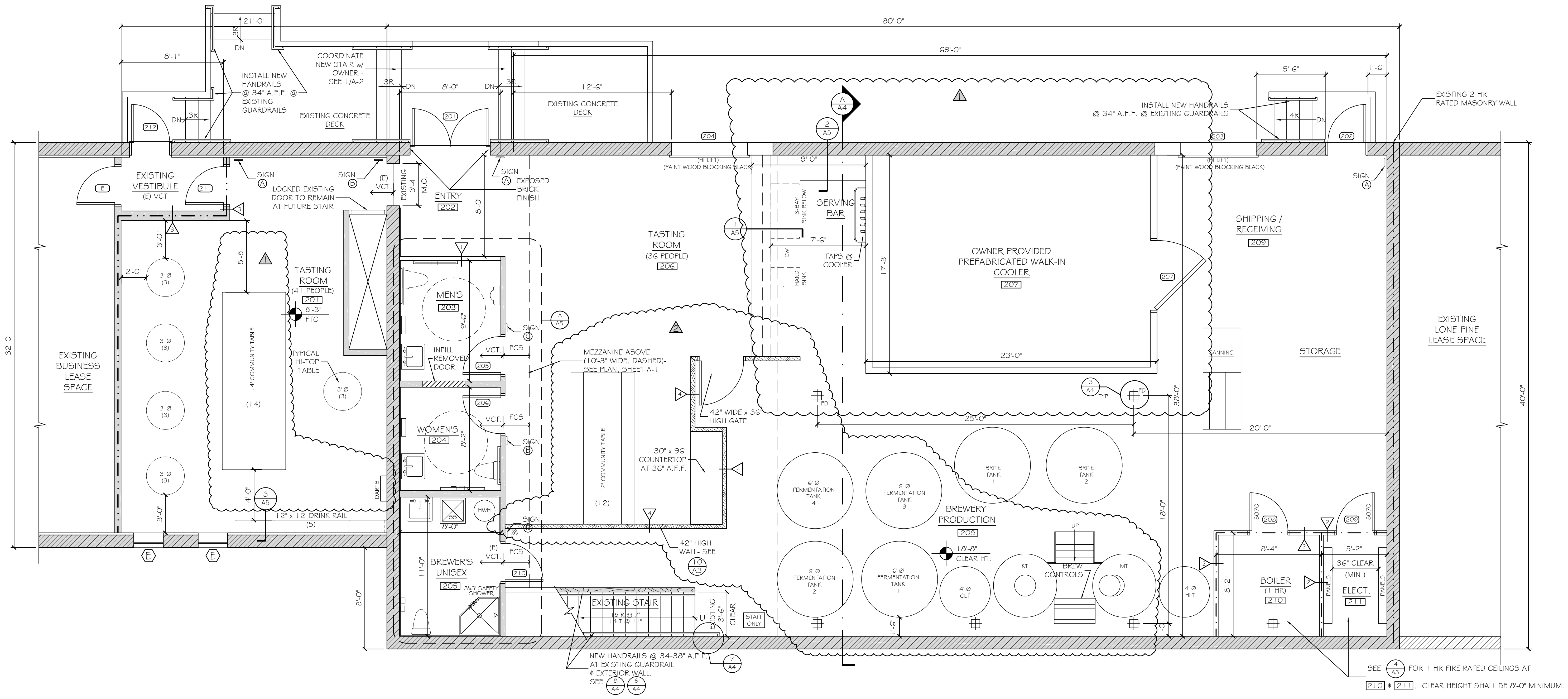

BREWERY EQUIPMENT PLAN
SCALE: 1/4" = 1'-0"



- GENERAL NOTES**
- REFER TO STRUCTURAL DRAWINGS BY ASSOCIATED DESIGN PARTNERS, INC. FOR ADDITIONAL INFORMATION REGARDING FLOOR STRUCTURE.
 - REFER TO TIGRO DRAWINGS AND SPECIFICATION FOR BREWERY EQUIPMENT.
 - G.C. SHALL COORDINATE ALL DESIGN-BUILD MEP, LIFE SAFETY AND OTHER TRADES INTO THE WORK.
 - FIELD VERIFY LOCATION OF ALL FLOOR DRAINS WITH PRECAST CONCRETE TEE LAYOUT PRIOR TO CORE DRILLING. DRAINS SHALL BE LOCATED BETWEEN DEEP TS @ CENTER OF EACH SECTION. SEE [3] [A4]

WALL TYPES	
	EXISTING MASONRY
	EXISTING PARTITION
	EXISTING LOW WALL
	NEW PARTITION
	ONE HOUR FIRE RATING

PARTITION LEGEND	
TAG	DETAIL
	[1] [A3]
	[2] [A3]
	[3] [A3]
	[10] [A3]

SIGN LEGEND	
TAG	DETAIL
(A)	ADA SIGNAGE-SHEET AG
(B)	ADA SIGNAGE-SHEET AG
(C)	ADA SIGNAGE-SHEET AG

SEE [1] [A3] FOR 1 HR FIRE RATED CEILINGS AT [210] & [211]. CLEAR HEIGHT SHALL BE 8'-0" MINIMUM.