

GRANT HAYS
ASSOCIATES

ARCHITECTURE & INTERIOR DESIGN
P.O. BOX 6179 FALMOUTH MAINE 04105
207.871.5900 www.granthays.com

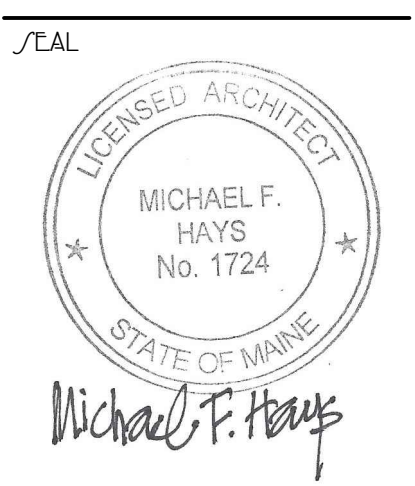

REVISIONS

DRAWING NAME



GOODFIRE
BREWING COMPANY
219 ANDERSON STREET
PORTLAND, MAINE 04102

SHEET

DEMOLITION
PLAN

DATE
13 FEB 2017
SCALE
1/4"=1'-0"
DRAWN
MFH/mgk
JOB NO.
161001

SHEET
AD-1

COPYRIGHT
REPRODUCTION OR RELIANCE OF THIS DOCUMENT WITHOUT WRITTEN PERMISSION FROM GRANT HAYS ASSOCIATES IS PROHIBITED.

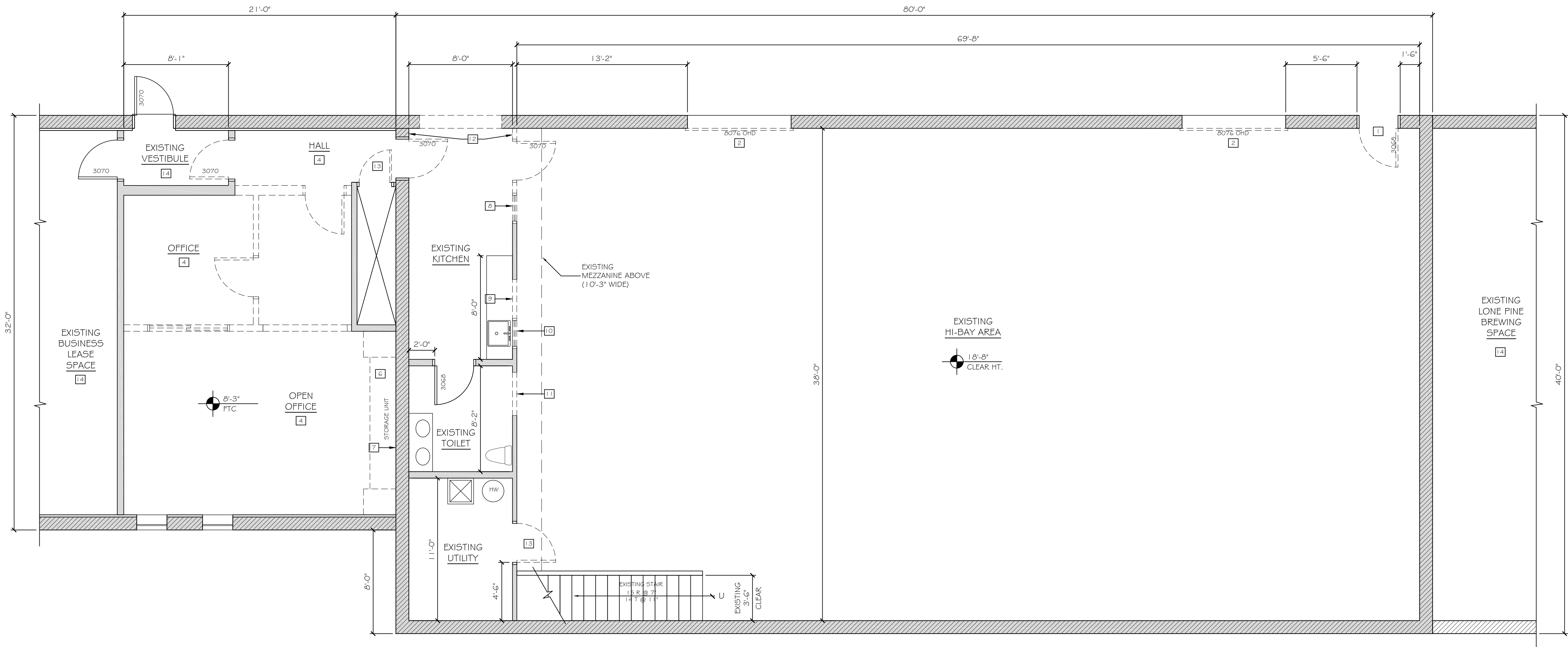

EXISTING CONDITIONS / DEMOLITION FLOOR PLAN
SCALE: 1/4" = 1'-0"



DEMOLITION NOTES LEGEND

- | | |
|---|--|
| 1 REMOVE EXTERIOR DOOR AND FRAME. PREP MASONRY OPENING FOR NEW DOOR AND FRAME. | 7 REMOVE ALL FRAMING AND FINISHES BACK TO EXISTING MASONRY WALL SURFACE. |
| 2 REMOVE EXTERIOR OVERHEAD DOOR. PREP MASONRY OPENING FOR NEW OVERHEAD DOOR. | 8 REMOVE EXISTING DOOR, FRAME, WINDOW, AND PARTITION FOR NEW OPENING. |
| 3 REMOVE EXTERIOR CMU INFILL AT EXISTING MASONRY OPENING. PREP MASONRY OPENING FOR NEW DOORS AND FRAME. | 9 REMOVE EXISTING WALL FOR NEW 36" X 36" PASS-THRU. |
| 4 REMOVE ALL INTERIOR PARTITIONS, DOORS, FRAMES, SUSPENDED CEILINGS/LIGHTING, AND FLOOR FINISHES IN THIS AREA. PREP SURFACES FOR NEW FINISHES AND LIGHTING. | 10 REMOVE EXISTING WINDOW AND INFILL TO MATCH ADJACENT PARTITION. |
| 5 INFILL EXISTING FLOOR OPENING. SEE STRUCTURAL DRAWINGS. | 11 REMOVE EXISTING WALL FOR NEW 3'-0" X 6'-8" DOOR. |
| 6 REMOVE BUILT-IN STORAGE CABINETS & SHELVING AND ASSOCIATED FRAMING BACK TO MASONRY WALL SURFACE. | 12 REMOVE EXISTING GWB/FURRING TO EXISTING BRICK (TO BE EXPOSED FINISH). |
| | 13 REMOVE EXISTING DOOR & FRAME. |
| | 14 NO WORK (NIC). |