

City of Portland, Maine - Building or Use Permit Application

389 Congress Street, 04101 Tel: (207) 874-8703, Fax: (207) 874-8716

Permit No: 02-1113	Issue Date:	CBL: 009 A015001
-----------------------	-------------	---------------------

Location of Construction: 250 Anderson St	Owner Name: Lido Realty Inc	Owner Address: 183 Middle St	Phone:
Business Name: n/a	Contractor Name: The Pochebit Co, Inc.	Contractor Address: 171 Warren Ave. Portland	Phone 2077973369
Lessee/Buyer's Name n/a	Phone: n/a	Permit Type: Alterations - Commercial	Zone: ILB

Past Use: Commercial / Office space vacant <i>was AAA offices</i>	Proposed Use: Office Space / Adding four non-load bearing walls	Permit Fee: \$51.00	Cost of Work: \$4,000.00	CEO District: 1
Proposed Project Description: Adding four non load bearing walls		FIRE DEPT: <input checked="" type="checkbox"/> Approved <input type="checkbox"/> Denied	INSPECTION: Use Group: <i>B</i> Type: <i>NA</i> <i>10/10/02</i>	
		Signature: <i>[Signature]</i>		Signature: <i>[Signature]</i>
PEDESTRIAN ACTIVITIES DISTRICT (P.A.D.)				
Action: <input type="checkbox"/> Approved <input type="checkbox"/> Approved w/Conditions <input type="checkbox"/> Denied				
Signature: _____ Date: _____				

Permit Taken By: gg	Date Applied For: 09/30/2002	Zoning Approval		
------------------------	---------------------------------	------------------------	--	--

<p>1. This permit application does not preclude the Applicant(s) from meeting applicable State and Federal Rules.</p> <p>2. Building permits do not include plumbing, septic or electrical work.</p> <p>3. Building permits are void if work is not started within six (6) months of the date of issuance. False information may invalidate a building permit and stop all work..</p>	<p>Special Zone or Reviews</p> <p><input type="checkbox"/> Shoreland</p> <p><input type="checkbox"/> Wetland <i>Separate permits required for any new signage</i></p> <p><input type="checkbox"/> Flood Zone</p> <p><input type="checkbox"/> Subdivision</p> <p><input type="checkbox"/> Site Plan</p> <p>Maj <input type="checkbox"/> Minor <input type="checkbox"/> MM <input type="checkbox"/></p> <p>Date: <i>OK 10/8/02</i></p>	<p>Zoning Appeal</p> <p><input type="checkbox"/> Variance</p> <p><input type="checkbox"/> Miscellaneous</p> <p><input type="checkbox"/> Conditional Use</p> <p><input type="checkbox"/> Interpretation</p> <p><input type="checkbox"/> Approved</p> <p><input type="checkbox"/> Denied</p> <p>Date: _____</p>	<p>Historic Preservation</p> <p><input checked="" type="checkbox"/> Not in District or Landmark</p> <p><input type="checkbox"/> Does Not Require Review</p> <p><input type="checkbox"/> Requires Review</p> <p><input type="checkbox"/> Approved</p> <p><input type="checkbox"/> Approved w/Conditions</p> <p><input type="checkbox"/> Denied</p> <p>Date: <i>[Signature]</i></p>
---	---	--	--

CERTIFICATION

I hereby certify that I am the owner of record of the named property, or that the proposed work is authorized by the owner of record and that I have been authorized by the owner to make this application as his authorized agent and I agree to conform to all applicable laws of this jurisdiction. In addition, if a permit for work described in the application is issued, I certify that the code official's authorized representative shall have the authority to enter all areas covered by such permit at any reasonable hour to enforce the provision of the code(s) applicable to such permit.

SIGNATURE OF APPLICANT	ADDRESS	DATE	PHONE
RESPONSIBLE PERSON IN CHARGE OF WORK, TITLE		DATE	PHONE

All Purpose Building Permit Application

If you or the property owner owes real estate or personal property taxes or user charges on any property within the City, payment arrangements must be made before permits of any kind are accepted.

Location/Address of Construction: <u>250 ANDERSEN ST.</u>		
Total Square Footage of Proposed Structure <u>Existing Building 1300±</u>	Square Footage of Lot	
Tax Assessor's Chart, Block & Lot Chart# <u>009</u> Block# <u>A</u> Lot# <u>015</u>	Owner:	Telephone:
Lessee/Buyer's Name (If Applicable) <u>CATHOLIC CHARITIES OF MAINE</u>	Applicant name, address & telephone: <u>THE POMSBIT CO INC 171 WARREN AVE PORTLAND 797 3369</u>	Cost Of Work: \$ <u>4,000±</u> Fee: \$ <u>51-</u>
Current use: <u>Office space vacant</u>	" 11x17 needed at time of permit pickup	
If the location is currently vacant, what was prior use: <u>AAA</u>	Approximately how long has it been vacant: <u>1± yr.</u>	
Proposed use: <u>office space</u>	Project description: <u>REMOVE 4 Non-load bearing walls</u>	
Contractor's name, address & telephone: <u>THE POMSBIT CO INC. 171 WARREN AVE, PORTLAND, ME 04103</u>		
Who should we contact when the permit is ready: <u>MIKE WHITE 776-1463</u>		
Mailing address:		
We will contact you by phone when the permit is ready. You must come in and pick up the permit and review the requirements before starting any work, with a Plan Reviewer. A stop work order will be issued and a \$100.00 fee if any work starts before the permit is picked up. PHONE: <u>776-1463</u>		

IF THE REQUIRED INFORMATION IS NOT INCLUDED IN THE SUBMISSIONS THE PERMIT WILL BE AUTOMATICALLY DENIED AT THE DISCRETION OF THE BUILDING/PLANNING DEPARTMENT, WE MAY REQUIRE ADDITIONAL INFORMATION IN ORDER TO APPROVE THIS PERMIT.

I hereby certify that I am the Owner of record of the named property, or that the owner of record authorizes the proposed work and that I have been authorized by the owner to make this application as his/her authorized agent. I agree to conform to all applicable laws of this jurisdiction. In addition, if a permit for work described in this application is issued, I certify that the Code Official's authorized representative shall have the authority to enter all areas covered by this permit at any reasonable hour to enforce the provisions of the codes applicable to this permit.

Signature of applicant: <u>[Signature]</u>	Date: <u>9/30/02</u>
--	----------------------

This is NOT a permit, you may not commence ANY work until the permit is issued.
If you are in a Historic District you may be subject to additional permitting and fees with the Planning Department on the 4th floor of City Hall

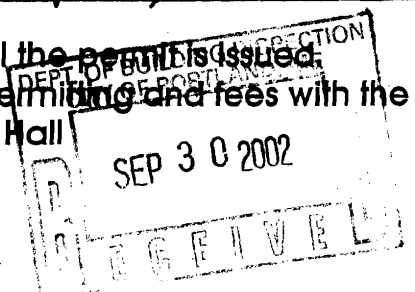

BUILDING PERMIT INSPECTION PROCEDURES

Please call 874-8703 or 874-8693 to schedule your inspections as agreed upon

Permits expire in 6 months, if the project is not started or ceases for 6 months.

The Owner or their designee is required to notify the inspections office for the following inspections and provide adequate notice. Notice must be called in 48-72 hours in advance in order to schedule an inspection:

By initializing at each inspection time, you are agreeing that you understand the inspection procedure and additional fees from a "Stop Work Order" and "Stop Work Order Release" will be incurred if the procedure is not followed as stated below.

Pre-construction Meeting: Must be scheduled with your inspection team upon receipt of this permit. Jay Reynolds, Development Review Coordinator at 874-8632 must also be contacted at this time, before **any** site work begins on any project other than single family additions or alterations.

Footing/Building Location Inspection: Prior to pouring concrete

Re-Bar Schedule Inspection: Prior to pouring concrete

Foundation Inspection: Prior to placing ANY backfill

Framing/Rough Plumbing/Electrical: Prior to any insulating or drywalling

Final/Certificate of Occupancy: Prior to any occupancy of the structure or use. NOTE: There is a \$75.00 fee per inspection at this point.

Certificate of Occupancy is not required for certain projects. Your inspector can advise you if your project requires a Certificate of Occupancy. All projects DO require a final inspection

If any of the inspections do not occur, the project cannot go on to the next phase, REGARDLESS OF THE NOTICE OR CIRCUMSTANCES.

CERIFICATE OF OCCUPANICES MUST BE ISSUED AND PAID FOR, BEFORE THE SPACE MAY BE OCCUPIED

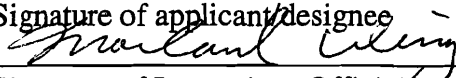
 10-16-02
Signature of applicant/designee Date
 10-16-02
Signature of Inspections Official Date

CBL: 009 A012 Building Permit #: 02113

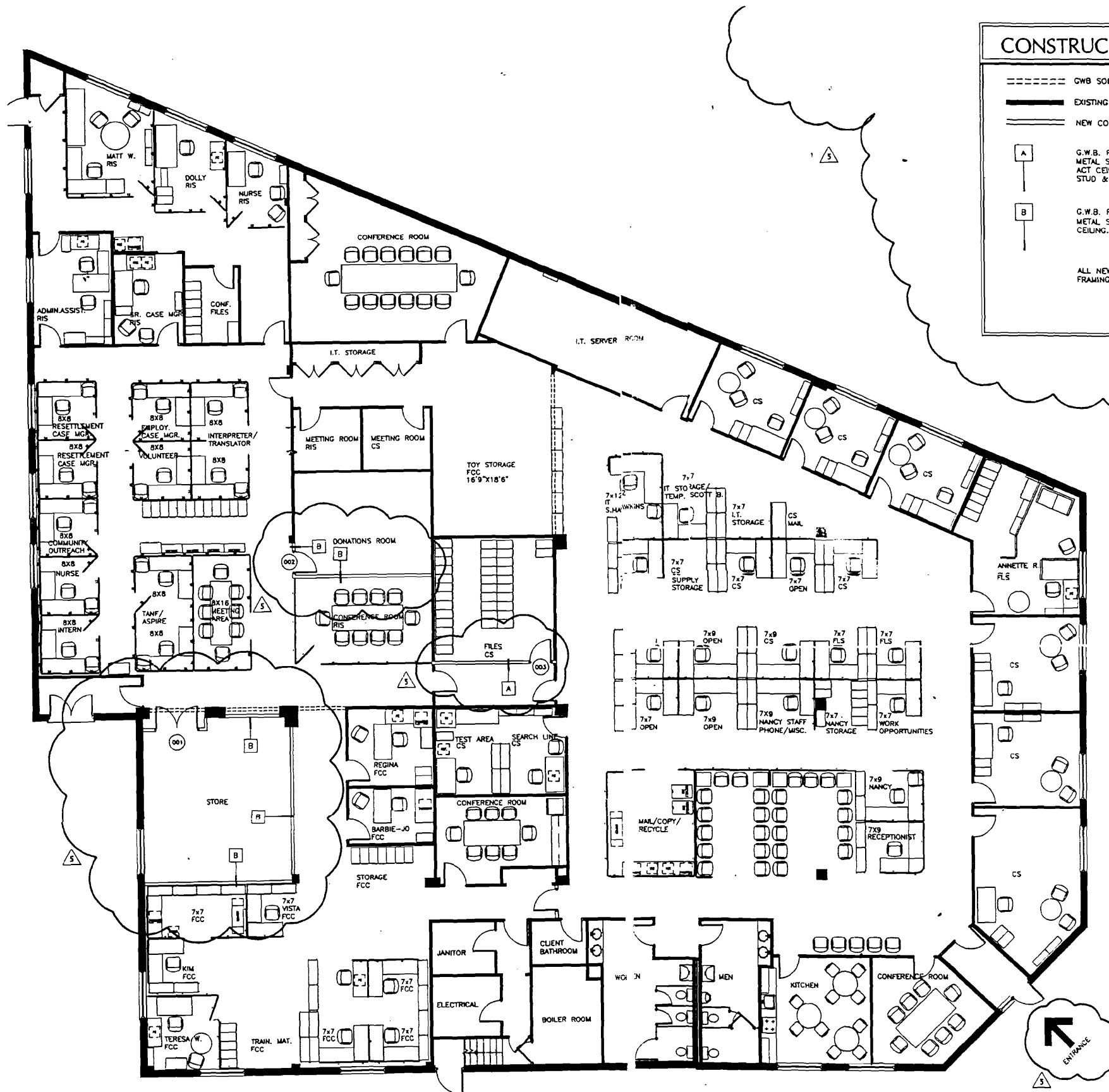

CONSTRUCTION LEGEND

- G.W.B. SOFFIT
- EXISTING CONSTRUCTION TO REMAIN
- NEW CONSTRUCTION

A
G.W.B. PARTITION WITH (1) LAYER G.W.B. ON EACH SIDE OF A 3 5/8" METAL STUD. FRAME FROM FINISH FLOOR TO UNDERSIDE OF EXISTING ACT CEILING ABOVE ACT CEILING SYSTEM. CONTRACTOR TO VERIFY METAL STUD & G.W.B. WIDTH IN FIELD.

B
G.W.B. PARTITION WITH (1) LAYER G.W.B. ON EACH SIDE OF A 3 5/8" METAL STUD. FRAME FROM FINISH FLOOR TO 18" BELOW EXISTING ACT CEILING. CONTRACTOR TO VERIFY METAL STUD & G.W.B. WIDTH IN FIELD.

ALL NEW DOORS (001, 002 AND 003) TO MATCH THE STYLE AND FRAMING OF EXISTING DOORS.

NO	DATE	REVISIONS
01	8/5/02	INITIAL BLOCK PLAN
02	8/15/02	REVISIONS + SOFTIC. CALC.
03	8/27/02	REVISIONS TO BLOCK PLAN
04	9/10/02	REVISION TO RLS
05	9/22/02	REVISION TO FINAL PLAN

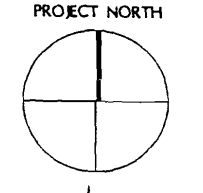

CATHOLIC CHARITIES
 250 ANDERSON STREET
 PORTLAND, ME 049 A015

OWNER

TITLE: BLOCK PLAN
 SCALE:

Cubellis Associates Inc.
 Architects Interior Engineering
 138 Elm Street, 3rd Fl.
 Portland, ME 04101
 Tel: 207-874-2777
 Fax: 207-874-2775
 www.cubellis.com

DRAWN BY: _____
 CHECKED BY: _____

1 SKETCH
 1/8" = 1'-0"

SK-1