

U-HAUL
 RETAIL STORE
 MODIFICATIONS

411 MARGINAL WAY
 Portland, Maine

Project Title

LEGEND

- EMERGENCY LIGHT WITH BATTERY PACK
- DOOR NUMBER
- ROOM NAME AND NUMBER
- SURFACE AND FIRE EXTINGUISHERS
- EMERGENCY LED EXIT SIGN

GENERAL NOTES

- ALL DIMENSIONS ARE EITHER TO FACE OF STUDS OR CENTER LINE OF STUDS UNLESS OTHERWISE NOTED.
- REMOVE STUDS BEHIND JT WALLS TO SUPPORT ALL REQUIRED ITEMS: WALL DISPLAYS, SHELVING, CABINETS, ETC....
- REPAIR ALL WALLS AND CEILINGS DAMAGED DURING DEMOLITION TO MATCH SURROUNDING FINISHES.

Mark	Date	Description
	03-05-18	PERMIT DRAWINGS
Issue Dates		

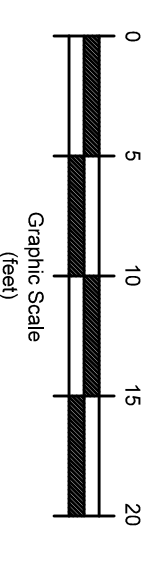

FLOOR
 PLAN

Drawing Title

Drawing Number

A10.1

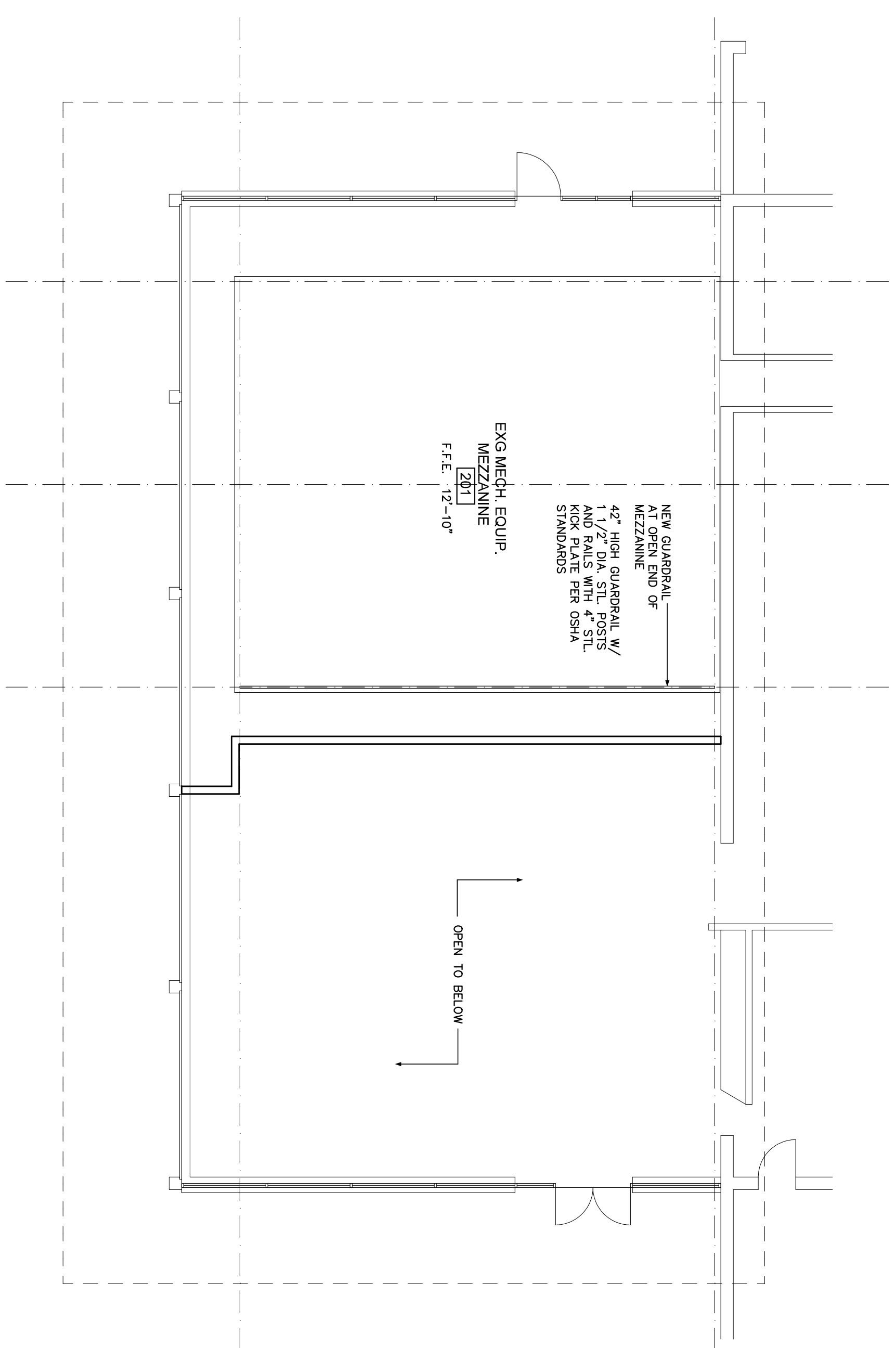

MEZZANINE FLOOR PLAN

1/8" = 1'-0"

B1

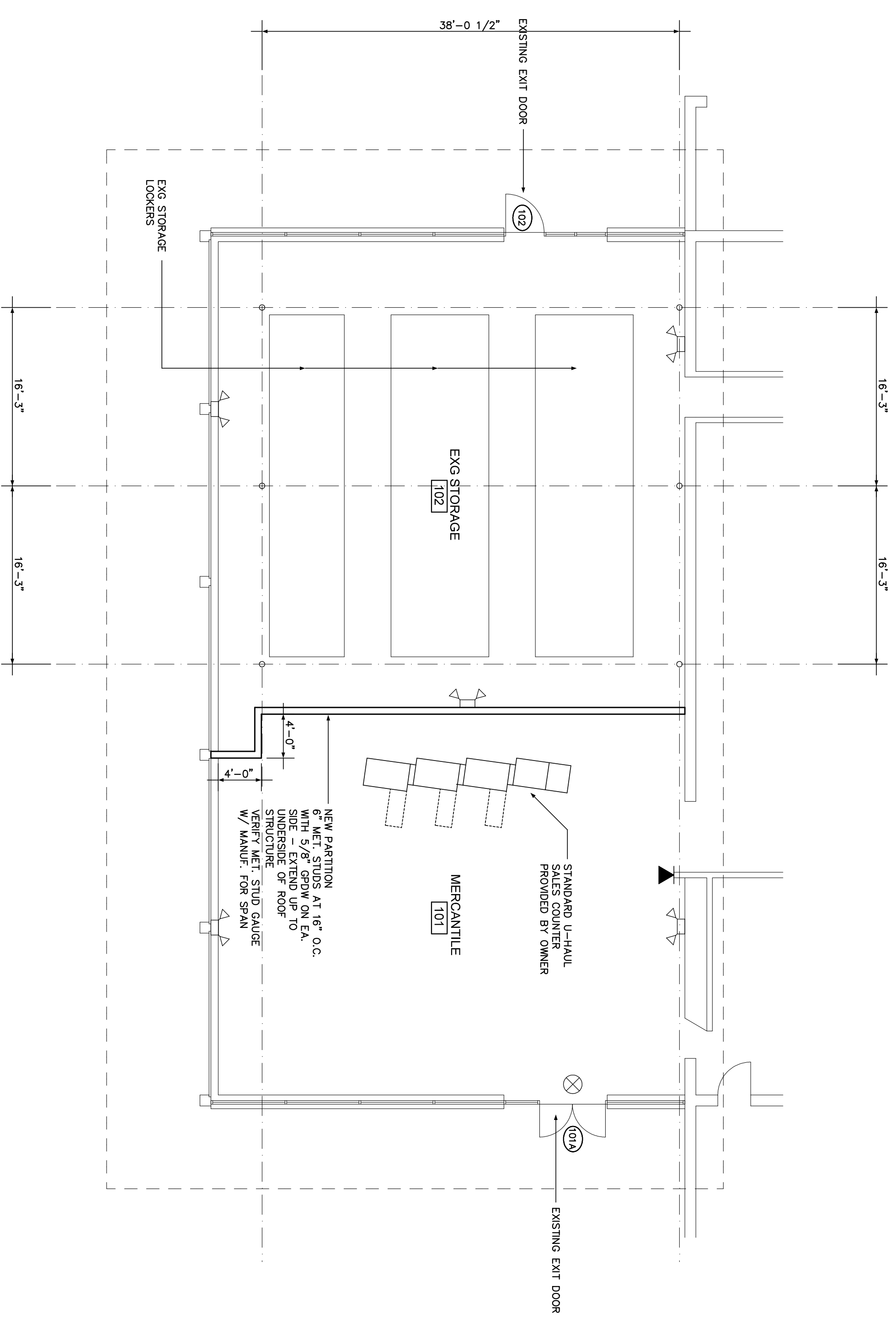

GROUND FLOOR PLAN

1/8" = 1'-0"

A1