

Project Title
**U-HAUL
 RETAIL STORE
 MODIFICATIONS**
 411 MARGINAL WAY
 Portland, Maine

Mark	Date	Description
03-05-18		PERMIT DRAWINGS

Issue Dates

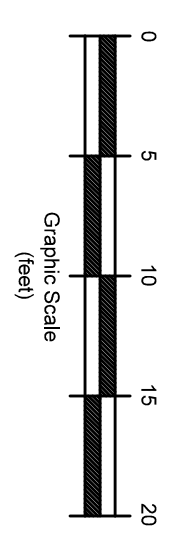

Drawing Title
LIFE SAFETY PLAN

Drawing Number
A00.1

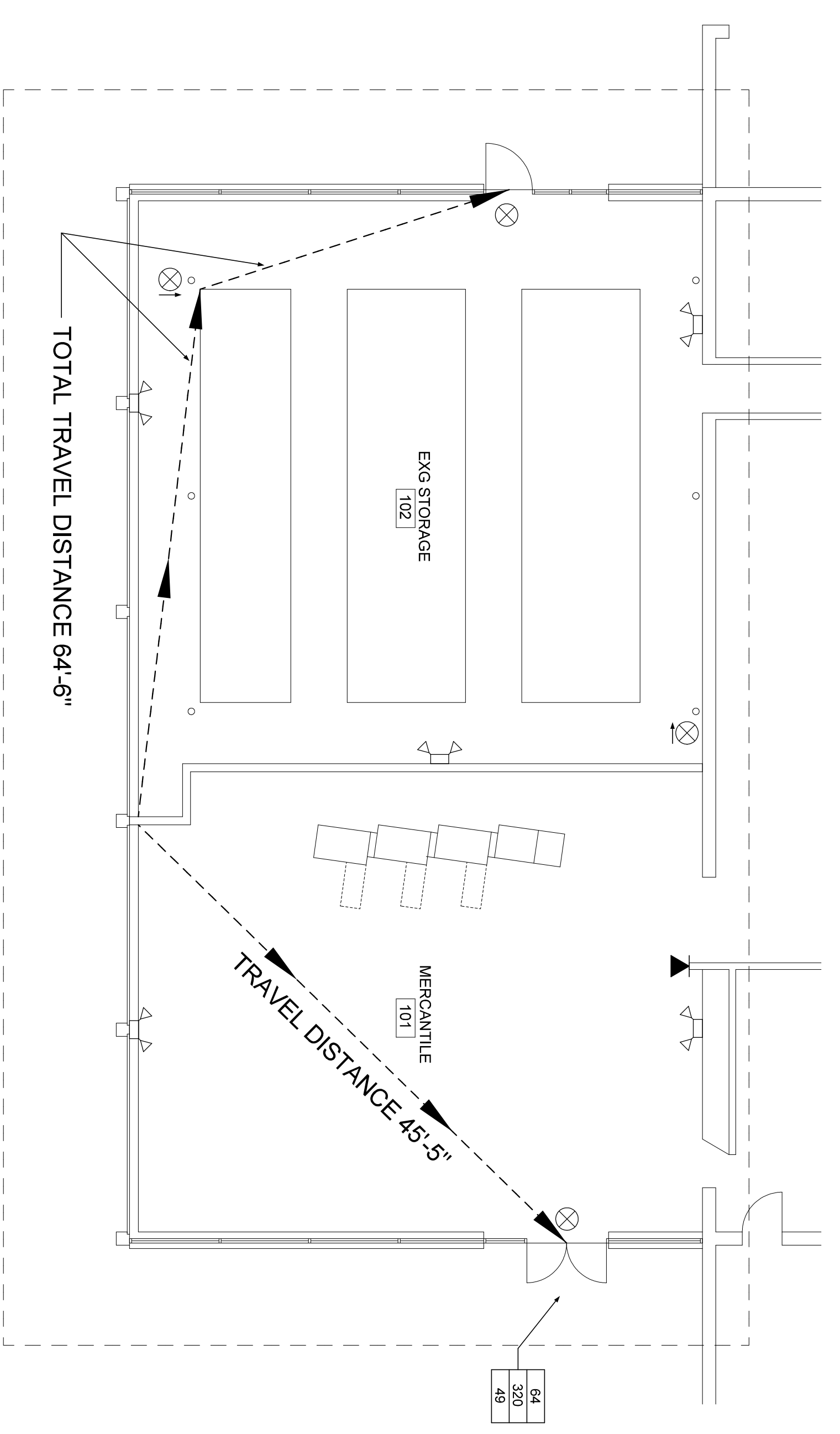

LIFE SAFETY PLAN
 1/8" = 1'-0"
 B1

BUILDING DESIGN CODES:	MEANS OF EGRESS REQUIREMENTS: (2009 IBC & NFPA 101)
AMERICAN WITH DISABILITIES ACT (ADA)	NO. OF MEANS OF EGRESS 1
UNAS - ACCESSIBLE STANDARDS	MAX. TRAVEL DISTANCES 150 FT.
2009 IBC - EXISTING BLDG	MAX. DEAD END CORRIDOR 20 FT.
2009 IBC	MAX. COMMON PATH OF TRAVEL 75 FT.
2009 MAINE STATE PLUMBING CODE	MIN. CORRIDOR/STAIR WIDTH 44 INCHES
2007 NEC	
WORK CLASSIFICATION PER 2009 IBC	
LEVEL "1" ALTERATION	
BUILDING AREA BEING ALTERED:	FIRE RESISTANCE ASSEMBLY RATINGS: (2009 IBC)
AREA BEING ALTERED 1,480 SF	ELEVATOR SHAFTS 1 HOUR
OCCUPANCY CLASSIFICATIONS: (Mixed Use):	STAIR SHAFTS 1 HOUR
IBC - MERCANTILE (GROUP M)	EXIT ACCESS CORRIDORS 1 HOUR
IBC - MODERATE HAZARD STORAGE (GROUP S-1)	FIRE BARRIERS 2 HOUR
NFPA - EXISTING CLASS 'C' MERCANTILE (CHAPTER 97)	FIRE WALLS 3 HOUR
NFPA - STORAGE (CHAPTER 42)	
CONSTRUCTION CLASSIFICATION:	FIRE ALARM & DETECTION SYSTEMS
IBC - TYPE 2B (NONCOMBUSTIBLE/UNPROTECTED)	NOT REQUIRED
NFPA - TYPE II (000)	ILLUMINATION OF MEAN OF EGRESS
OCCUPANT LOAD (Based on usable Area - 6,798 sf)	REQUIRED PER NFPA
MERCANTILE 1,480 SF 1/30 SF 49 PERSONS	EMERGENCY LIGHTING
TOTAL CALC. OCCUPANCY 49 PERSONS	REQUIRED PER NFPA
FIRE SUPPRESSION:	EXIT SIGNS
NO SPRINKLERS	REQUIRED PER NFPA
SEPARATION REQUIREMENTS	PORTABLE FIRE EXTINGUISHERS
N.A.	REQUIRED PER NFPA
	EXIT PLACEMENT (IBC & NFPA)
	SINGLE MEAN OF EGRESS
	OCCUPANCY LESS THAN 50 PERSONS &
	TRAVEL DISTANCE LESS THAN 75 FT.

CODE INFORMATION
 NTS A3

SYMBOL LEGEND	UN-USED
▼ FIRE EXTINGUISHER	(H) HEAT DETECTOR
⊗ EMERGENCY LED EXIT SIGN	(SD) SMOKE DETECTOR
⊗ COMBO EMERG. LIGHT & EXIT SIGN	(SD) DUOT SMOKE DETECTOR
⊗ EMERG. LIGHT W/ BATTERY PACK	▲ PATH OF EGRESS
△ EMERG. LIGHT REMOTE FIXTURE	--- 1 HOUR FIRE RATED BARRIER
⬆ FIRE ALARM PULL STATION	(5) TACTILE EXIT SIGN LOCATION
⬆ FIRE ALARM KNOX BOX	CLEAR WIDTH
⬆ FIRE ALARM HORN & STROBE	MAXIMUM EXIT CAPACITY
⬆ FIRE ALARM STROBE	ACTUAL EXIT CAPACITY

SYMBOL LEGEND
 NTS A2

UN-USED
 NTS A1