

PLUMBING ROUGH-IN PLAN

1/4" = 1' - 0"

- LEGEND — PLUMBING CONNECTIONS**
- HW—HOT WATER, OR CW—COLD WATER
 - GAS
 - WASTE, DIRECT—CONNECTED UNLESS NOTED
 - OPEN HUB
 - ☐ FLOOR DRAIN
 - ☐ FLOOR DRAIN W/ ATTACHED FUNNEL
 - ☐ FLOOR SINK WITH HALF GRATE UNLESS NOTED OTHERWISE
 - FIELD CONNECTIONS

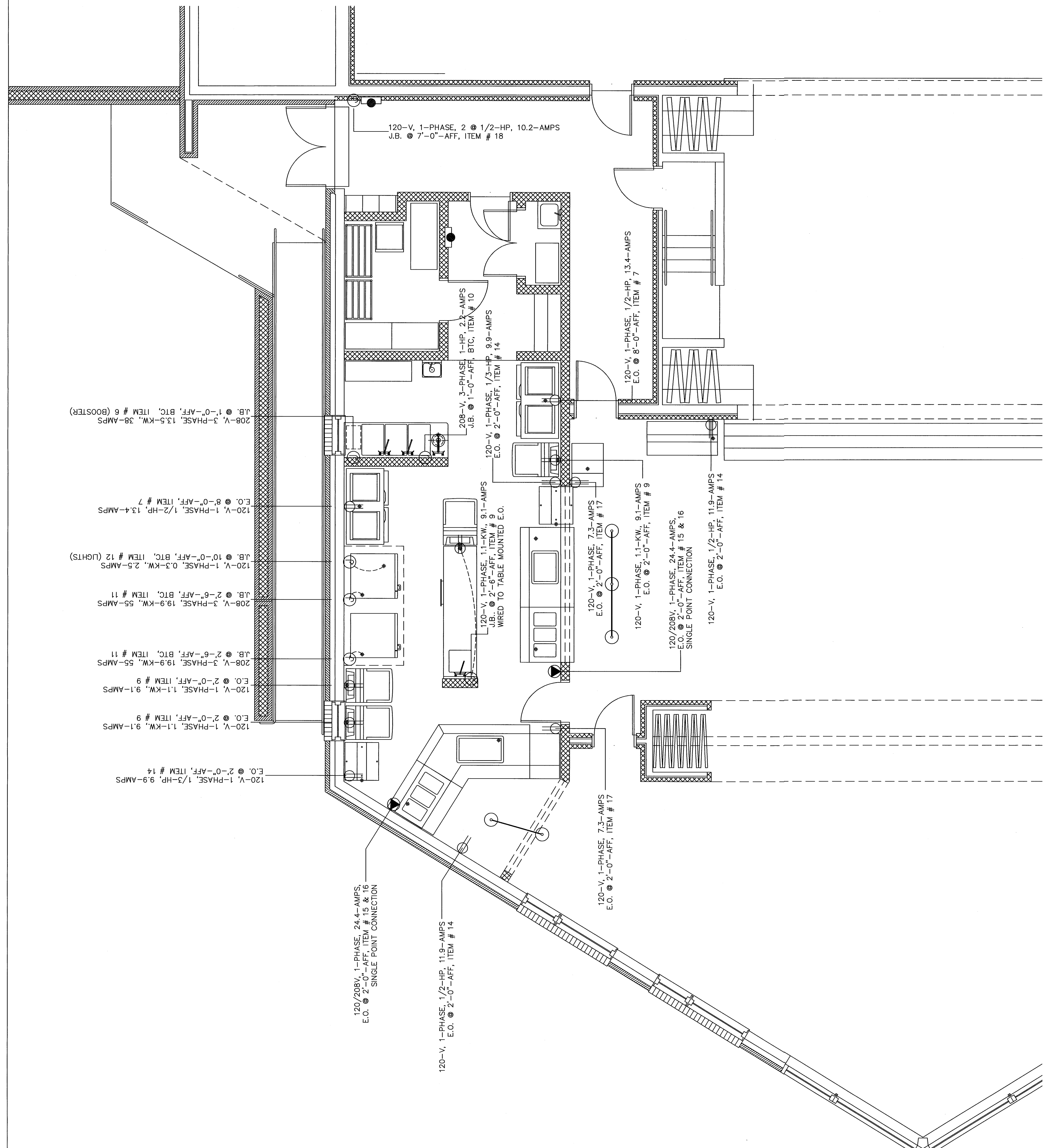

ELECTRICAL ROUGH-IN PLAN

1/4" = 1' - 0"

- LEGEND — ELECTRICAL CONNECTIONS**
- ☐ DUPLEX RECEPT., 20-AMP, 120-VOLT, GROUND TYPE, HORIZONTAL MOUNT
 - SIMPLEX RECEPT., 20-AMP, 120-VOLT, GROUND TYPE, HORIZONTAL MOUNT
 - ◉ SPECIAL PURPOSE OUTLET, 120-VOLT, GROUND TYPE, HORIZONTAL MOUNT
 - ◐ SPECIAL PURPOSE OUTLET, 208/240-VOLT HORIZONTAL MOUNT
 - ⊕ JUNCTION BOX
 - ⊖ ELECTRICAL CONDUIT, STUB AS INDICATED FOR DIRECT CONNECTION
 - ⦿ FLOOR/CEILING RECEPTACLE AS INDICATED
 - FIELD WIRING, EXPOSED RIGID
 - WATER TIGHT CONDUIT
 - FIELD WIRING, CONCEALED IN WALL, FLOOR, OR CEILING

<p>East End Elementary School Portland Public Schools Portland, Maine</p>	<p>AP# No: 0385 Date: 03/28/2024 Scale: 1/4" = 1'-0" Drawn by: TM Checked by: TM</p>	<p>Drawing Title: Equipment Rough-in Plans</p>	<p>A8.2</p>
	<p>Consultants Civil Engineer Daluch-Hoffman Associates Landscape Architect Carroll Associates Structural Engineer Pinkham & Greer Mechanical Engineer Bennett Engineering Electrical Engineer Barlett Design Interior Designer TM Consulting Construction Administrator Fore Solutions</p>	<p>10 Jordan Street Portland, ME 04103 Tel: (603) 233-0889 Fax: (603) 233-0899 Web: www.fore-solutions.com Email: info@fore-solutions.com</p>	