

LEGEND	
	4'-0" x 4'-0" SQUARES ADDITIONAL PANEL CEILING
	4'-0" x 4'-0" SQUARES ADDITIONAL PANEL CEILING
	OPTIMA WALL BOARD
	LIGHTS - SEE ELECTRICAL PLANS FOR SIZE AND TYPE
	4'-0" x 4'-0" SQUARES REFLECTORIAL DRAWINGS
	HEAT DETECTOR (SEE ELECTRICAL UNITS)
	SMOKE DETECTOR (SEE ELECTRICAL UNITS)
	CENTRAL MOUNTED SPRINKLER HEAD
	2'-4" x 4" FIRE WATER ACCESS PANEL
	2'-4" x 4" x 4" MOUNT BEHIND SURFACED CEILING PANEL WITH UPS

GENERAL NOTES

1. THIS DRAWING INDICATES LOCATIONS OF LIGHT FIXTURES AND THE NUMBER OF LIGHTS PER ROOM. THE FINISH SCHEDULES FOR CEILING PANELS, WALLS, AND OTHERS NOT SHOWN HEREIN. REFER TO ROOM FINISH SCHEDULES FOR CEILING PANELS, WALLS, AND OTHERS NOT SHOWN HEREIN.
2. REFER TO ROOM FINISH SCHEDULES FOR CEILING PANELS, WALLS, AND OTHERS NOT SHOWN HEREIN.
3. SEE SECTIONS FOR CEILING HEIGHTS AND WALLS.

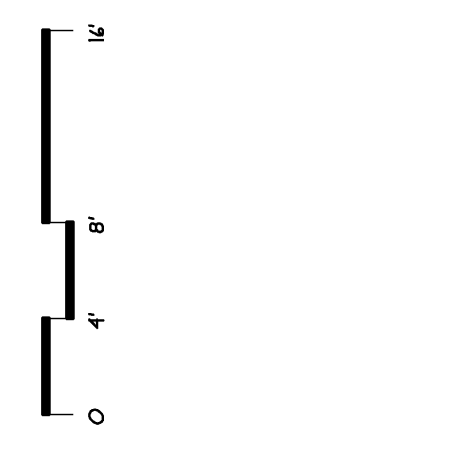
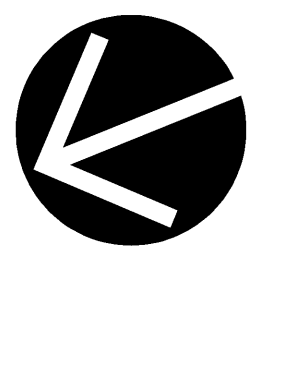
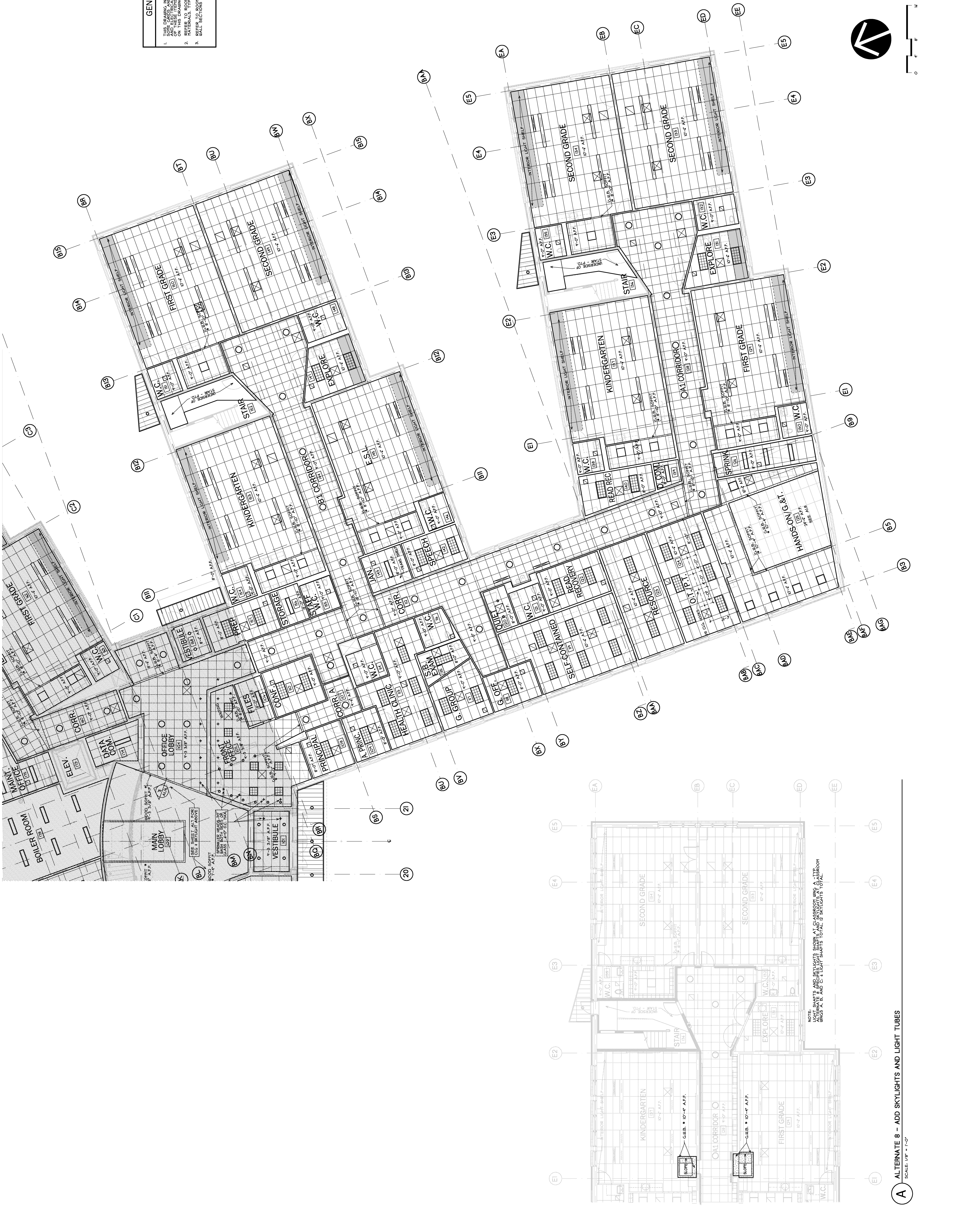

East End Elementary School Portland Public Schools Portland, Maine	Job No.: 0332 Date: 04/15/2004 Scale: 1/8" = 1'-0" Drawn by: jph Checked by: jph	Reflected Ceiling Plan Ground Floor South	A1.6
	Consultants: Civil Engineer: DuLuca-Hoffman Associates Landscape Architect: Carroll Associates Structural Engineer: Plinkham & Groot Mechanical Engineer: Bennett Engineering Electrical Engineer: Bartlett Design Architect: T. J. G. Architects Green Consulting: Fore Solutions		
10 Oakland Street Portland, ME 04103 Phone: 603.763.1111 Fax: 603.763.1105 Email: info@tjgarchitects.com	Revision:		

A ALTERNATE 8 - ADD SKYLIGHTS AND LIGHT TUBES
SCALE: 1/8" = 1'-0"

NOTE: SKYLIGHTS AND SKYLIGHTS SHOWN AT CLASSROOM AND A.T.P. CLASSROOMS. SEE ELECTRICAL UNITS FOR SKYLIGHTS AND LIGHT TUBES.