

BRACING ELEVATION @ A.5-LINE
1/8" = 1'-0"

GTYI WING

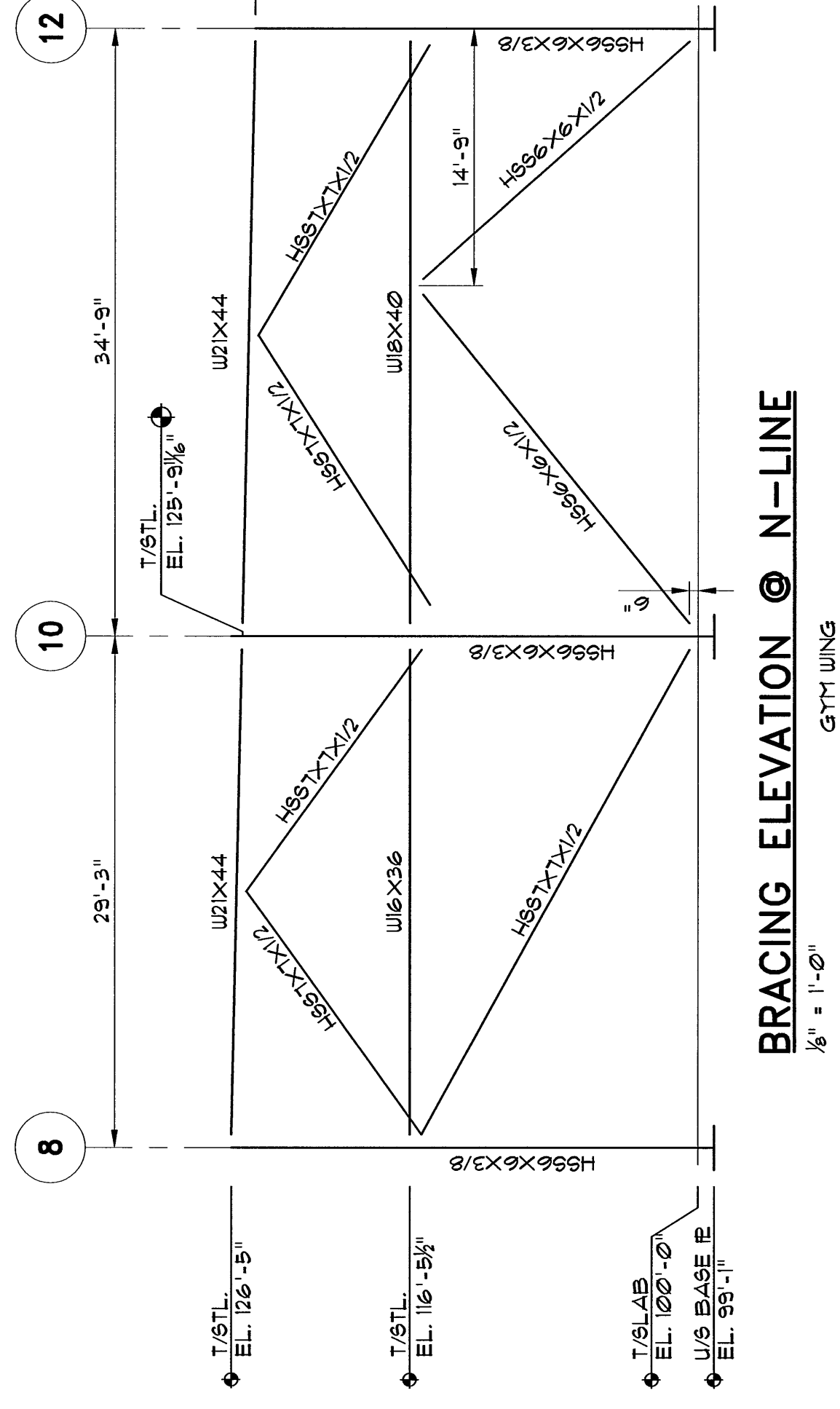

BRACING ELEVATION @ N-LINE
1/8" = 1'-0"

GTYI WING

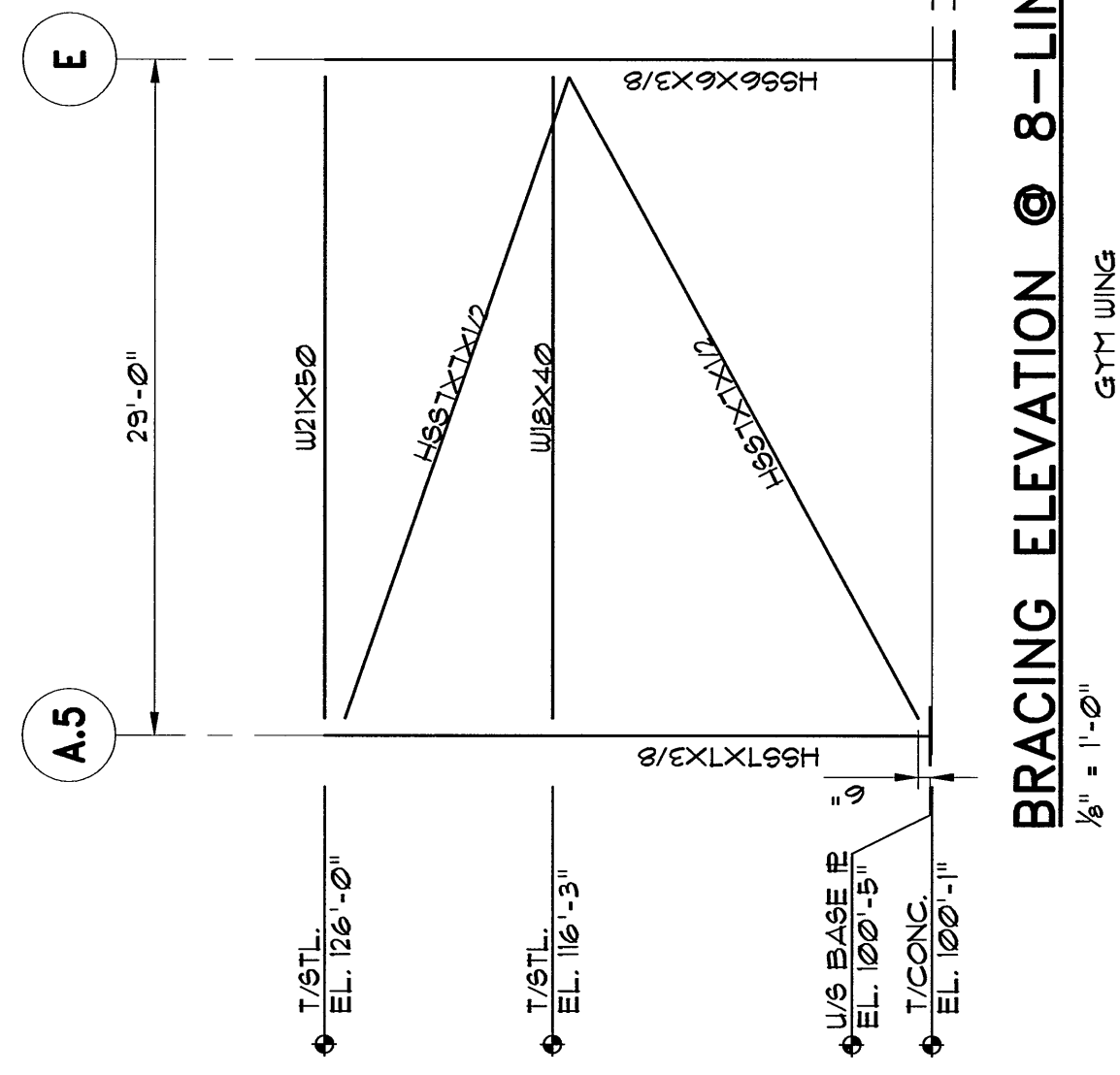

BRACING ELEVATION @ 8-LINE
1/8" = 1'-0"

GTYI WING

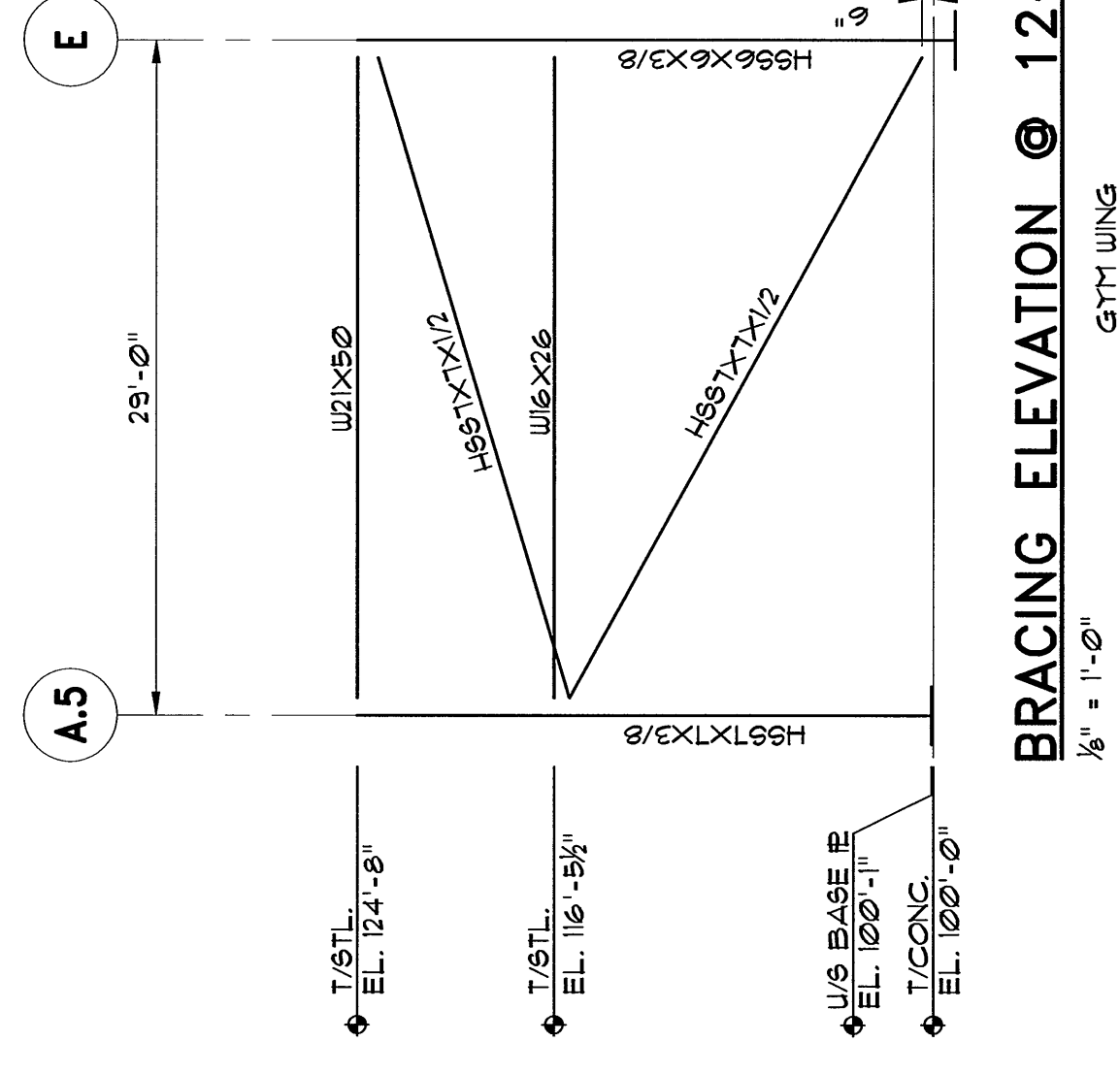

BRACING ELEVATION @ 12-LINE
1/8" = 1'-0"

GTYI WING

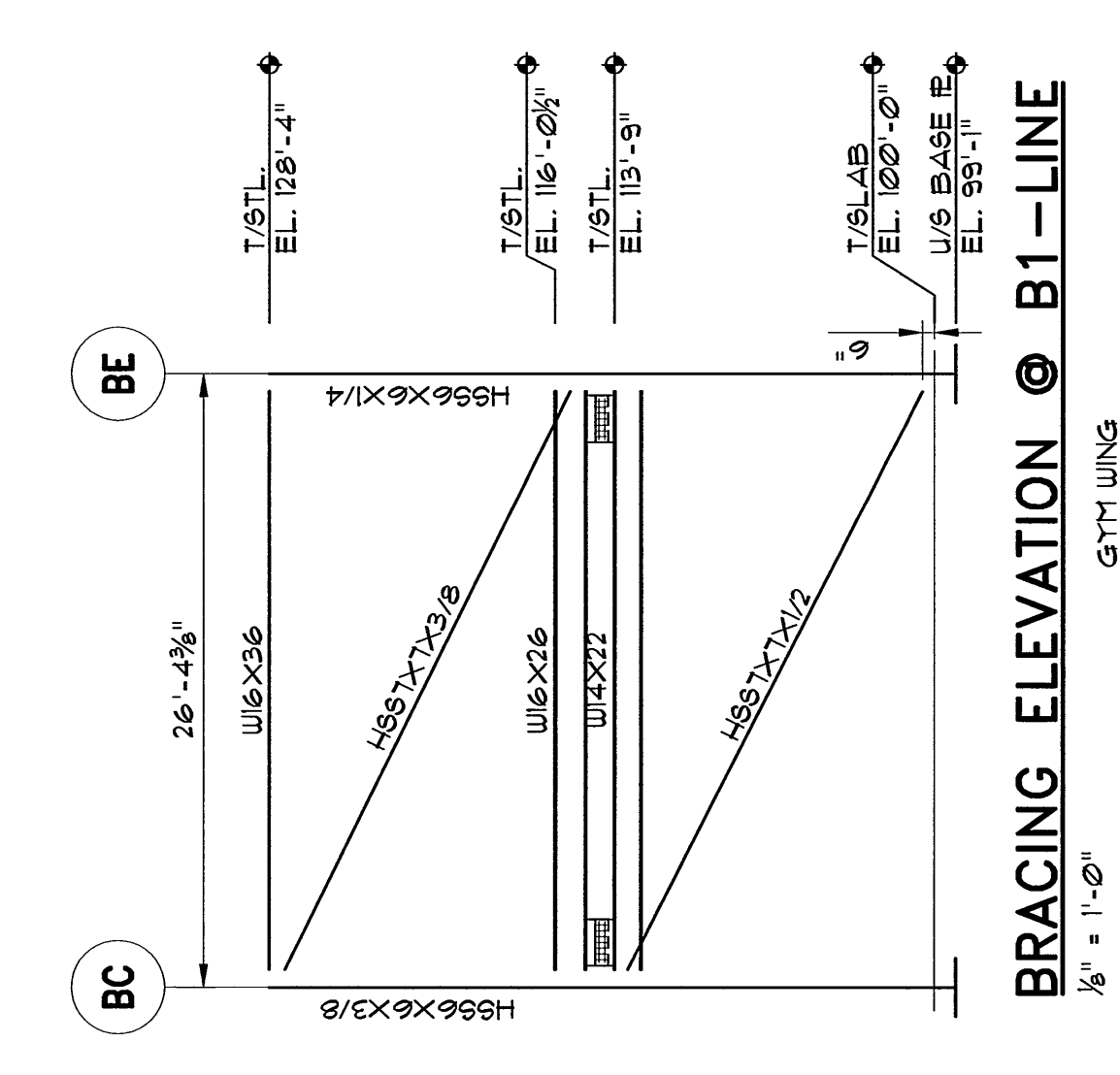

BRACING ELEVATION @ B1-LINE
1/8" = 1'-0"

GTYI WING

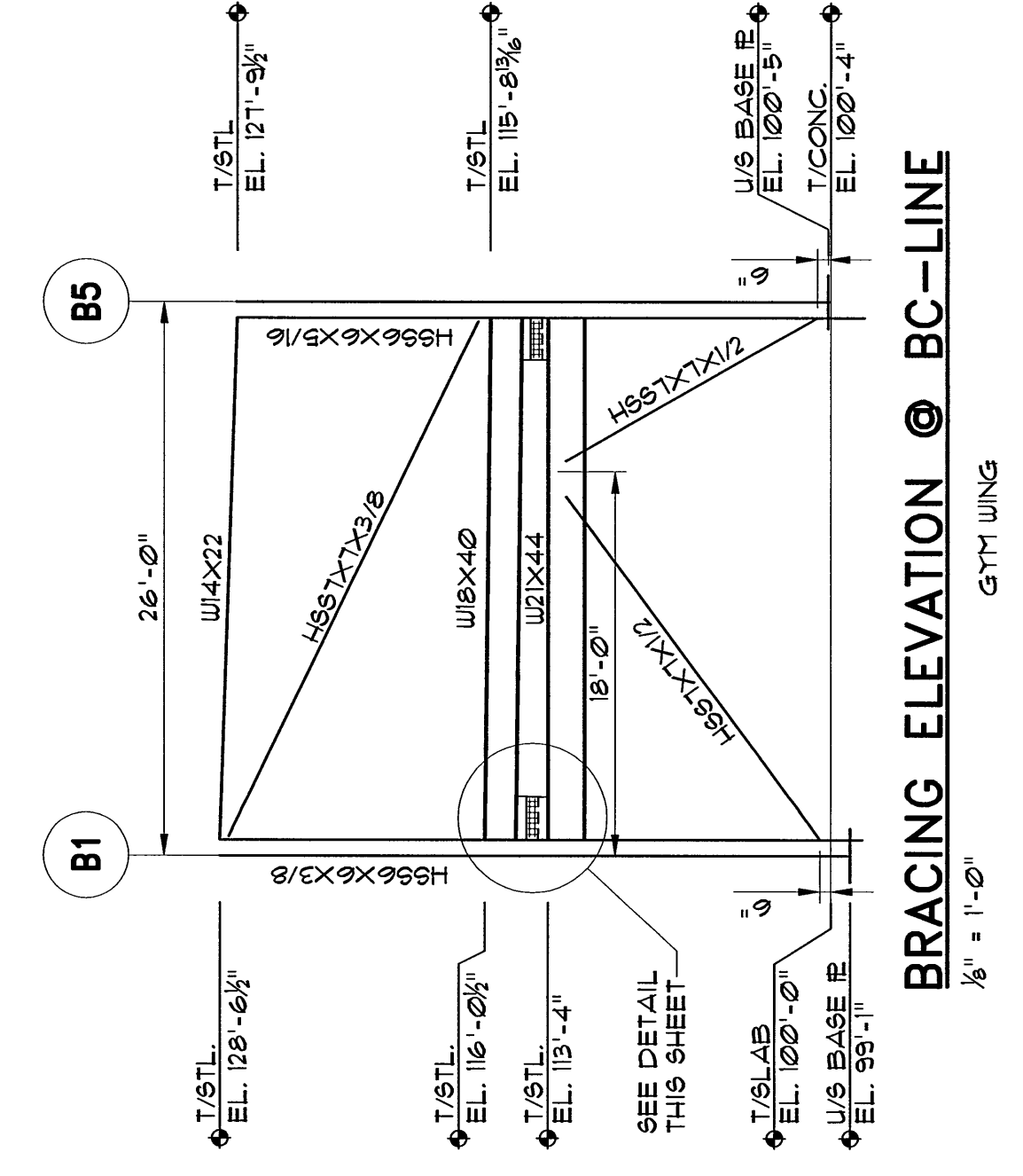

BRACING ELEVATION @ BC-LINE
1/8" = 1'-0"

GTYI WING

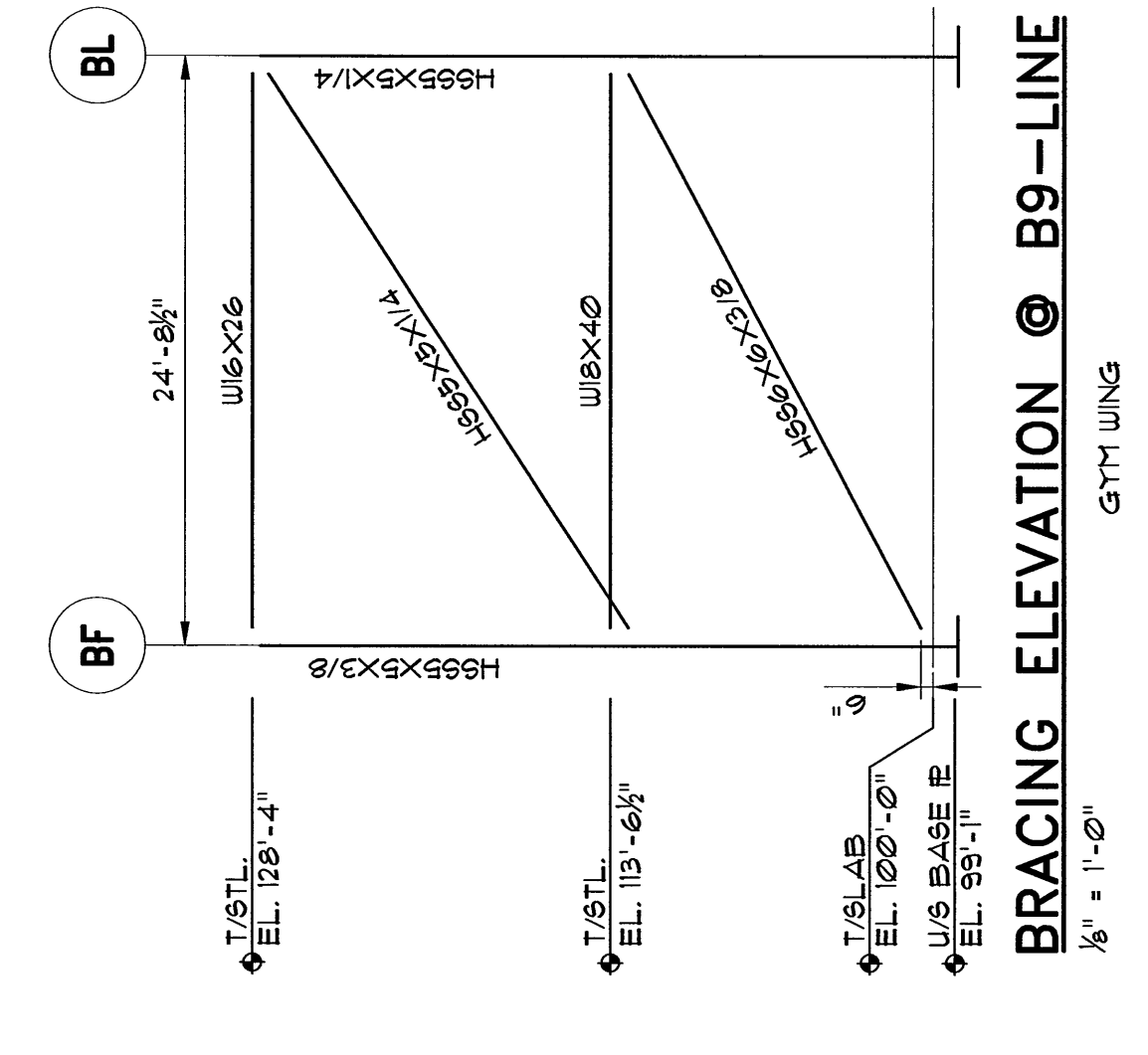

BRACING ELEVATION @ B9-LINE
1/8" = 1'-0"

GTYI WING

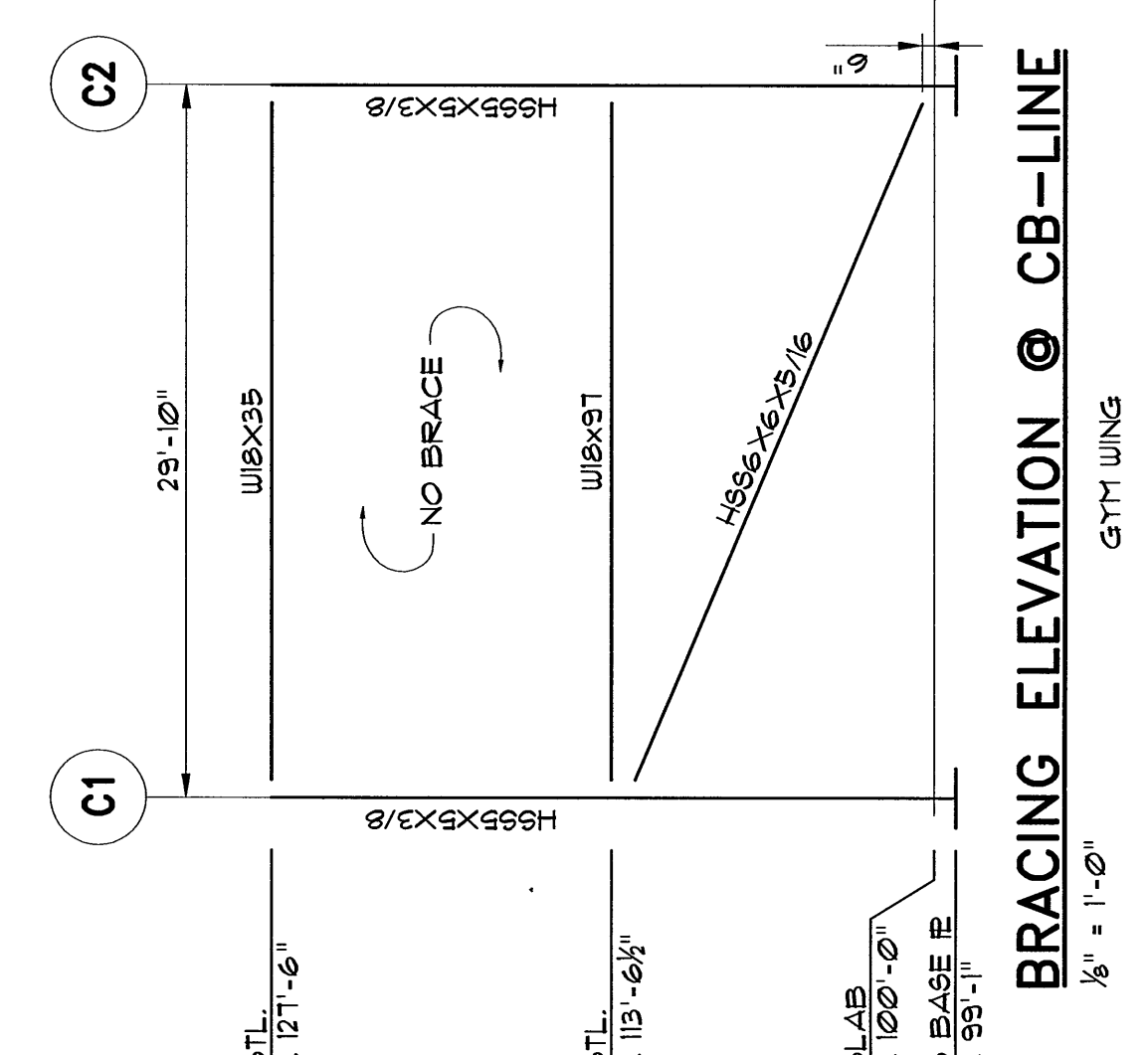

BRACING ELEVATION @ CB-LINE
1/8" = 1'-0"

GTYI WING

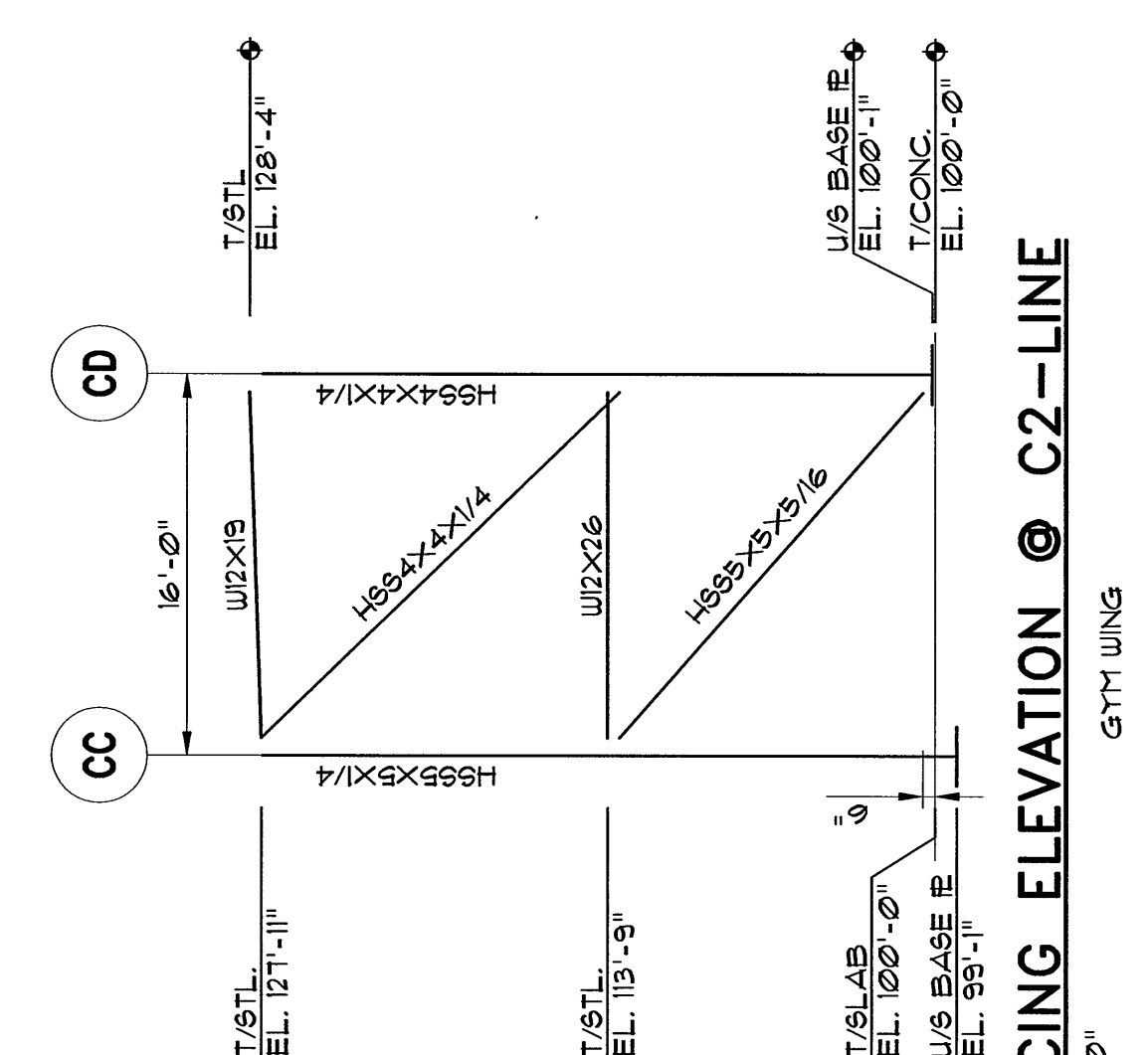

BRACING ELEVATION @ C2-LINE
1/8" = 1'-0"

GTYI WING

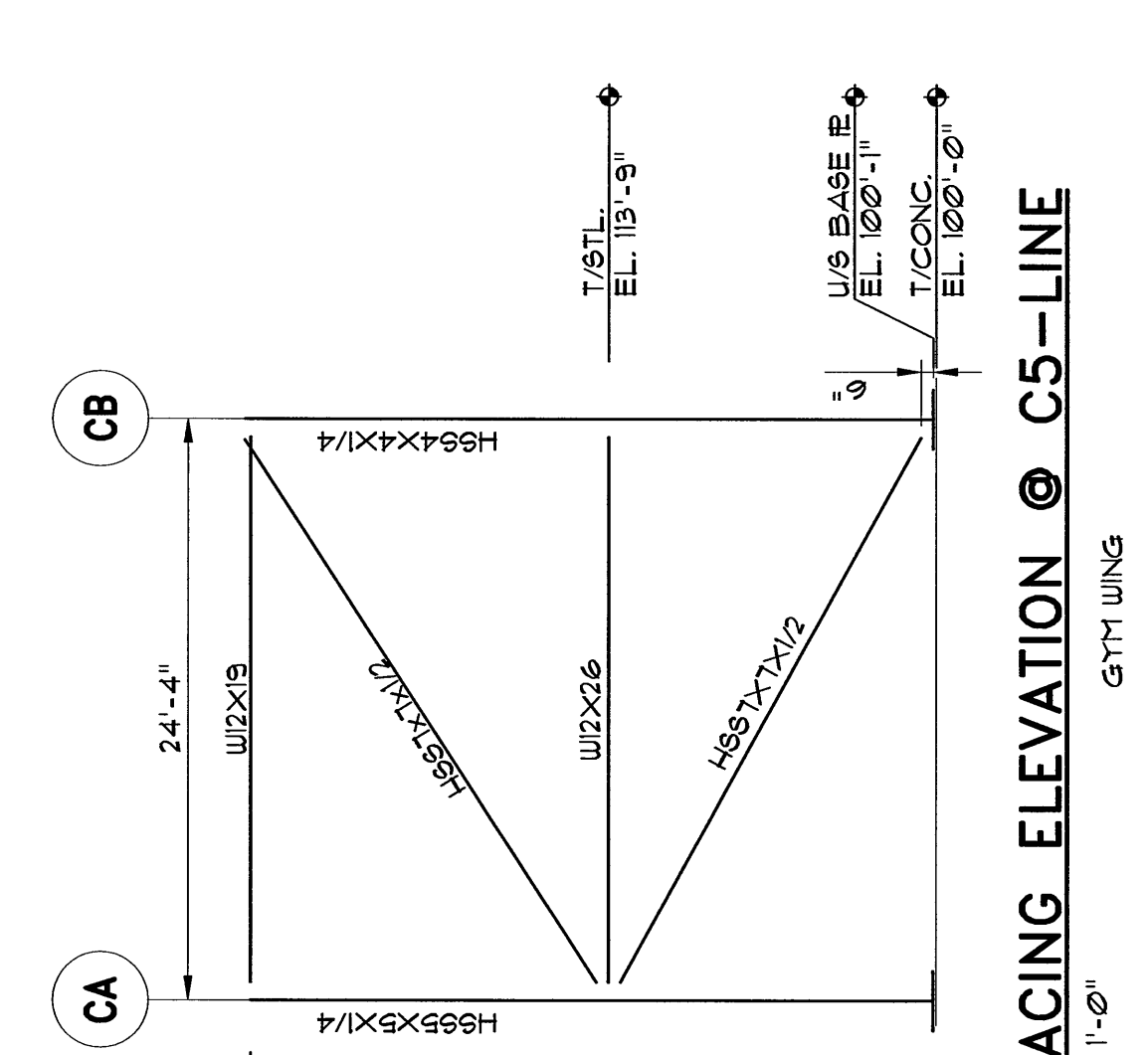

BRACING ELEVATION @ C5-LINE
1/8" = 1'-0"

GTYI WING

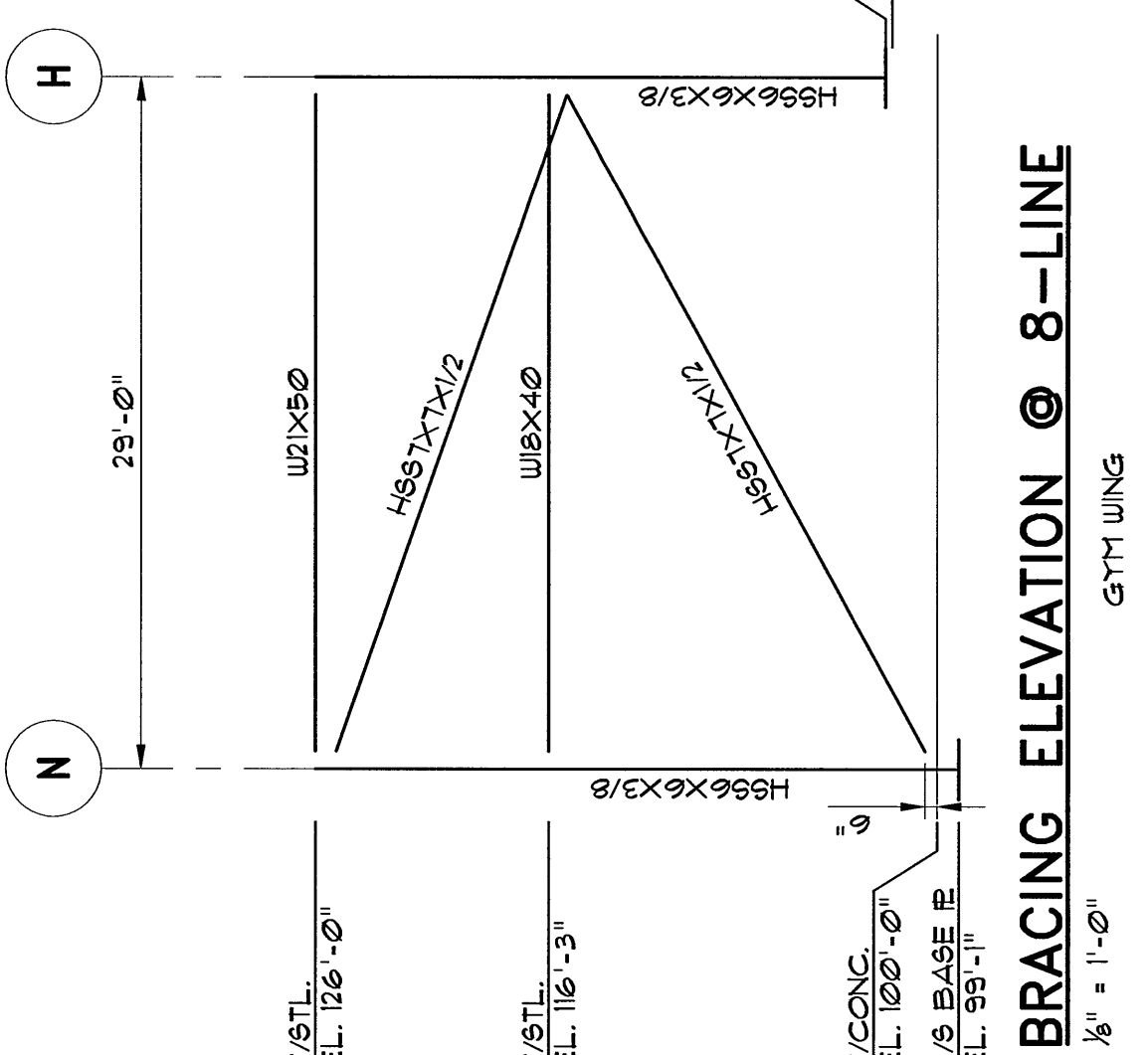

BRACING ELEVATION @ 8-LINE
1/8" = 1'-0"

GTYI WING

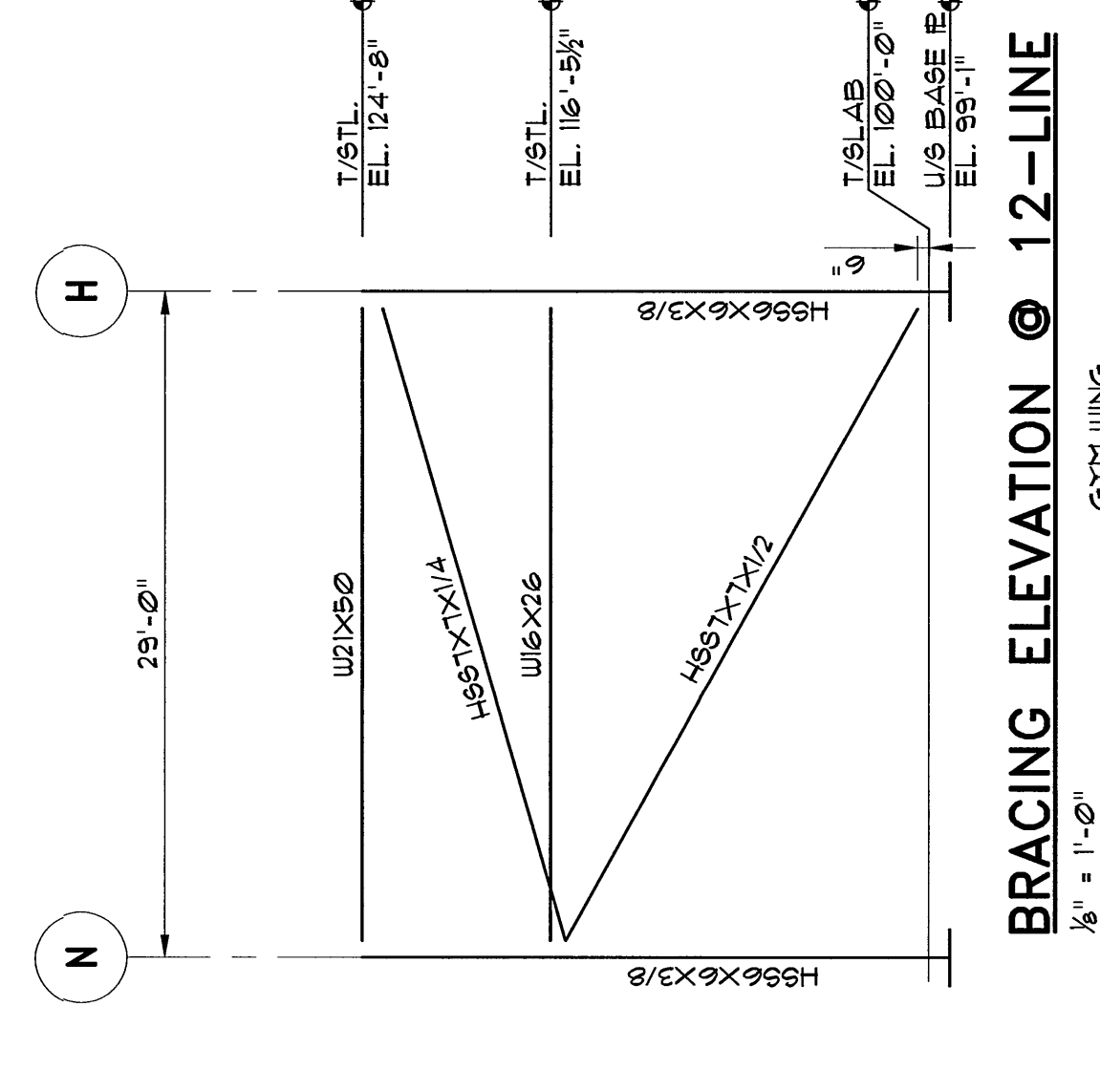

BRACING ELEVATION @ 12-LINE
1/8" = 1'-0"

GTYI WING

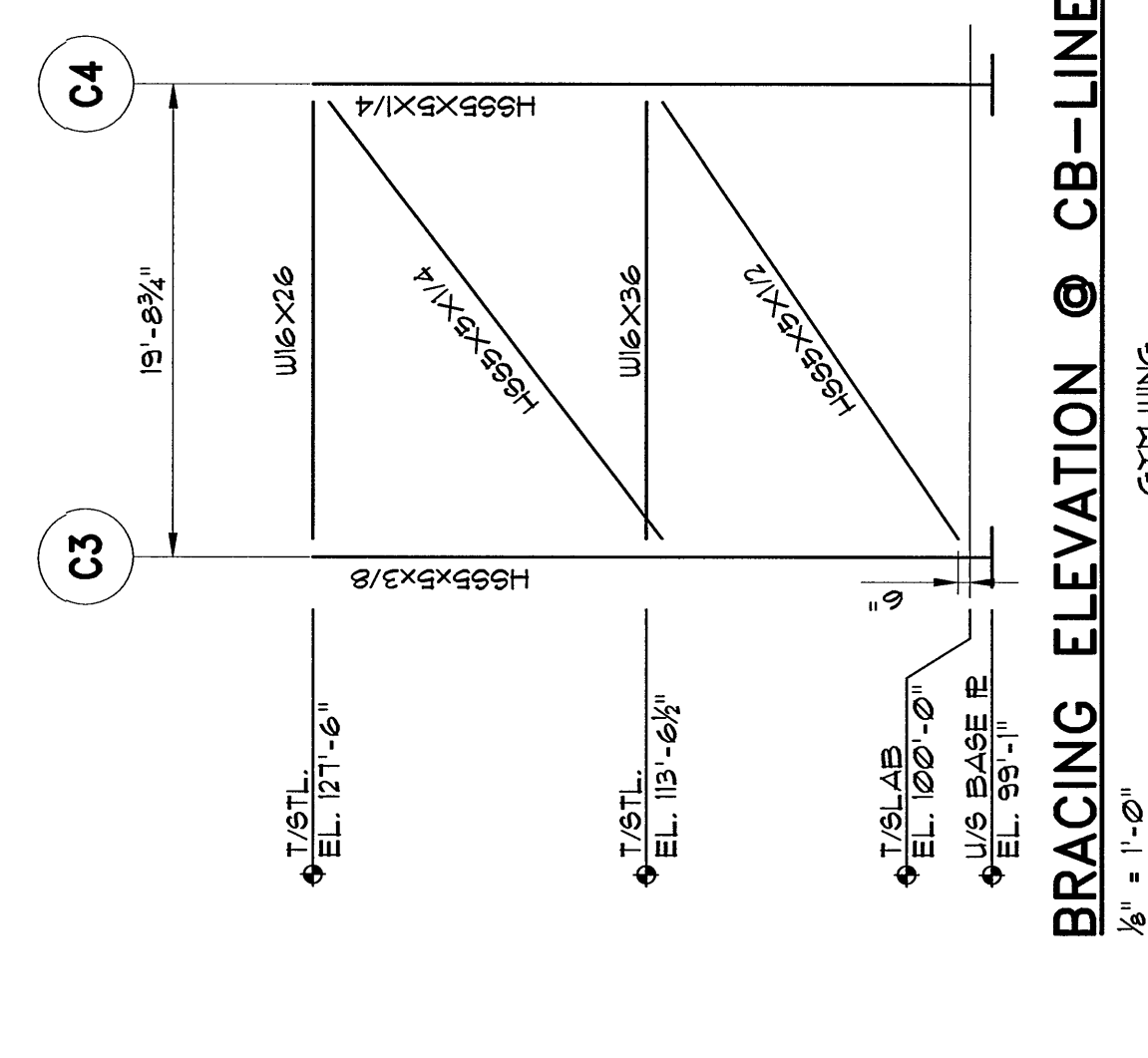

BRACING ELEVATION @ CB-LINE
1/8" = 1'-0"

GTYI WING

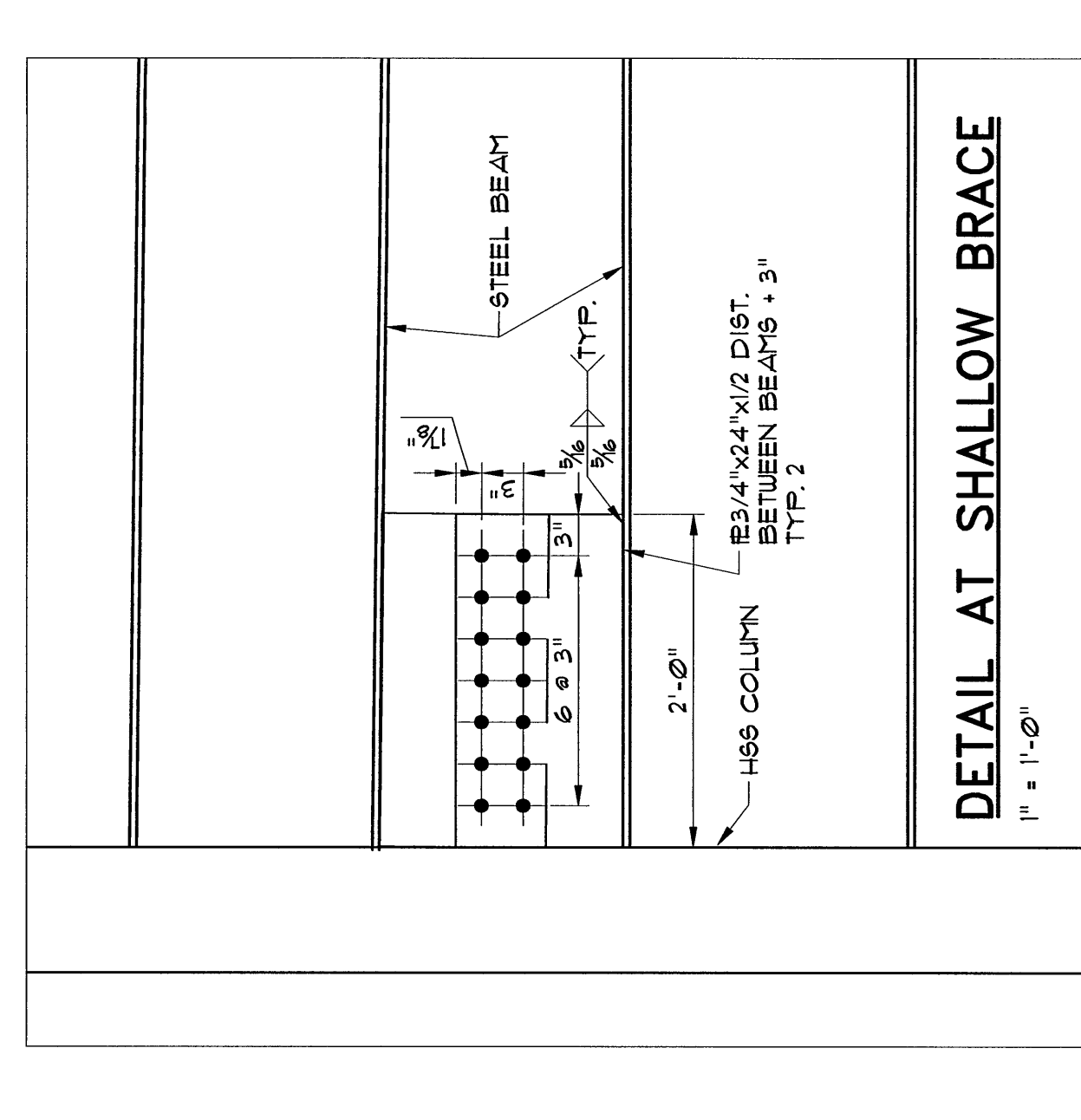

DETAIL AT SHALLOW BRACE
1" = 1'-0"

	East End Elementary School Portland, Maine	Job No.: 0309 Date: July 15, 2004 Scale: AS NOTED Checked by: [Signature] Drawing Title: Bracing Elevations	<h1 style="text-align: center;">S.13</h1>
	Consultants: Civil Engineer: [Signature] Landscape Architect: [Signature] Structural Architect: [Signature] Structural Engineer: [Signature] Mechanical Engineer: [Signature] Electrical Engineer: [Signature] Architectural Designer: [Signature] Planner: [Signature] T/M Consulting Green Consultant: [Signature] Fore Solutions: [Signature]	Deluca-Hoffman Associates Civil Engineer Landscape Architect Structural Architect Structural Engineer Mechanical Engineer Electrical Engineer Architectural Designer Planner T/M Consulting Green Consultant Fore Solutions	
10 DuPont Street Portland, Maine 04103-0888 207.762.3911 207.762.3105 email: [Email]			