

East End Elementary School Portland Public Schools Portland, Maine		Date: 07/15/2004 Scale: 1"=40' Drawn by: [Signature] Checked by: [Signature]	Drawn by: [Signature] Checked by: [Signature]
Project: 2003-01 Date: 07/15/2004 Scale: 1"=40' Drawn by: [Signature] Checked by: [Signature]		Predevelopment Watershed Plan	
Consultants DuLuca-Hoffman Associates 11 DuLuca Street Portland, ME 04103 Phone: 603.875.4400 Fax: 603.875.4401 Email: duluca@duluca-hoffman.com			
Engineers William M. Hoffman Professional Engineer License No. 04172 State of Maine L.C. #1405			

C-28

DH DuLuca-Hoffman Associates, Inc. 11 DuLuca Street Portland, ME 04103 Phone: 603.875.4400 Fax: 603.875.4401 Email: duluca@duluca-hoffman.com

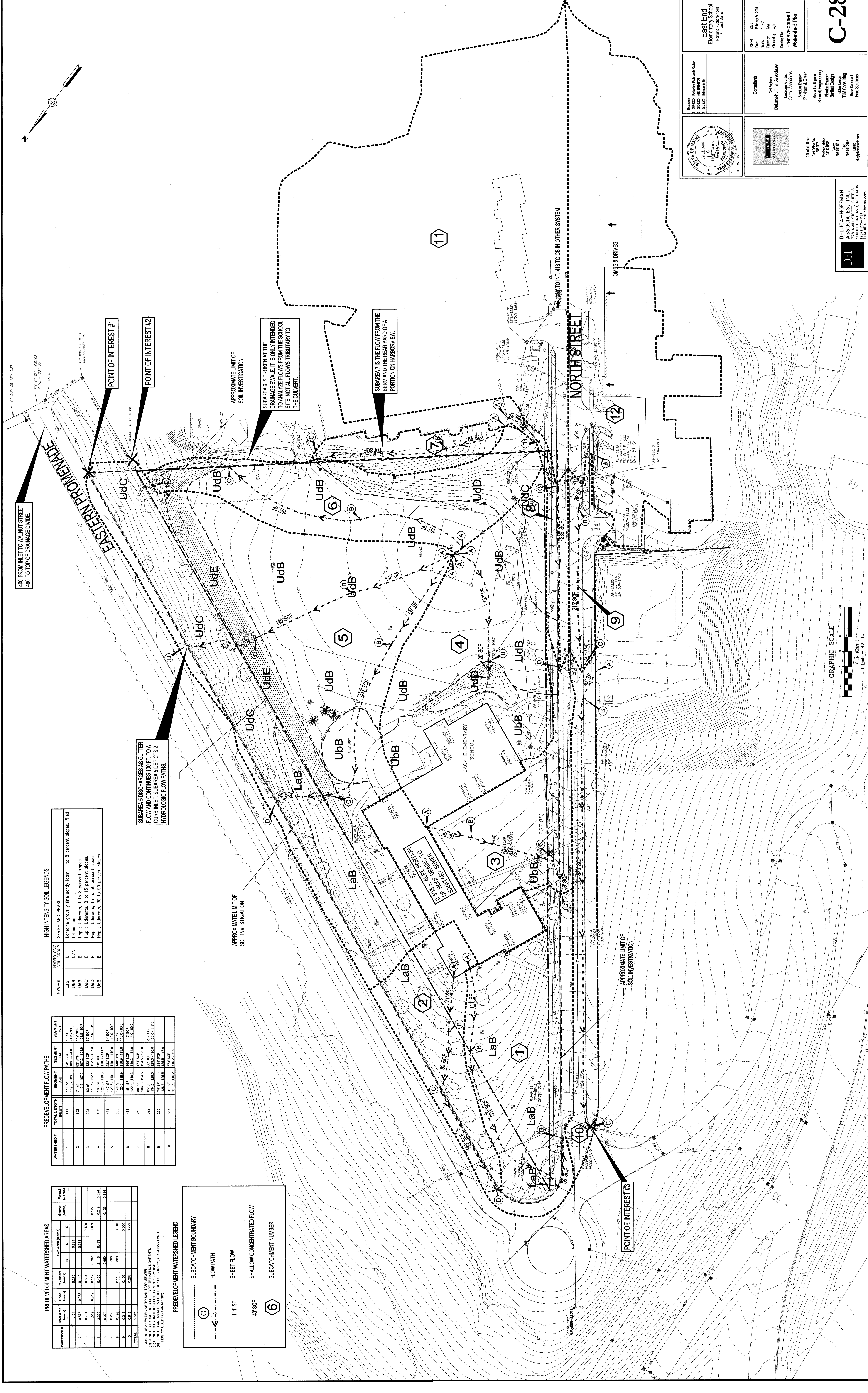

HIGH INTENSITY SOIL LEGENDS

SYMBOL	HYDROLOGIC SOIL GROUP	SERIES AND PHASE
LaB	D	Lemoine gravelly fine sandy loam, 1 to 8 percent slopes, (flat)
UdB	N/A	Urban Land
UdB	B	Hopkinton, 1 to 8 percent slopes
UdB	B	Hopkinton, 8 to 15 percent slopes
UdC	B	Hopkinton, 15 to 30 percent slopes
UdD	B	Hopkinton, 30 to 50 percent slopes
UdE	B	Hopkinton, 30 to 50 percent slopes

SUBAREA 5 DISCHARGES AS GUTTER FLOW AND CONTINUES 100 FT. TO A CURB INLET. SUBAREA 5 DEJECTS 2 HYDROLOGIC FLOW PATHS.

SUBAREA 6 IS BROKEN AT THE DRAINAGE SWALE. IT IS ONLY INTENDED TO ANALYZE FLOWS FROM THE SCHOOL SITE. NOT ALL FLOWS TRIBUTARY TO THE CULVERT.

SUBAREA 7 IS THE FLOW FROM THE BERM AND THE REAR YARD OF A PORTION ON HARBORVIEW.

PREDEVELOPMENT FLOW PATHS

WATERSHED #	TOTAL LENGTH (FEET)	RESIDENT A/B	RESIDENT B/C	RESIDENT C/D
1	411	111' F	231' SCF	89' SCF
2	362	112.2-108.3	105.2-94.9	84.0-59.9
3	220	112.2-107.2	107.2-101.5	101.5-96.7
4	183	62'-4"	102' SCF	89' SCF
5	434	129.2-119.2	119.2-111.2	111.2-106.0
6	448	129.2-119.2	119.2-114.0	114.0-90.0
7	259	89' SP	149' SCF	114' SCF
8	362	129.2-129.0	129.0-126.0	126.0-117.0
9	290	129.2-125.5	125.5-117.0	117.0-117.0
10	614	117.2-109.2	109.2-90.0	

PREDEVELOPMENT WATERSHED AREAS

Watershed #	Total Area (Acres)	Roof (Acres)	Pavement (Acres)	Lean Area (Acres)	B	D	X	Forest (Acres)
1	1.154	0.270	0.884	0.834				
2	0.979	0.035	0.142	0.381	0.120			
3	0.704	0.334	0.128	0.101	0.127			
4	1.979	0.334	0.295	0.479	0.124			
5	0.872	0.000	0.000	0.000	0.129	0.184		
6	0.892	0.000	0.000	0.000	0.000	0.000		
7	0.219	0.115	0.000	0.000	0.000	0.000		
8	0.219	0.115	0.000	0.000	0.000	0.000		
9	0.517	0.288	0.000	0.000	0.000	0.000		
10	2.987	0.000	0.000	0.000	0.000	0.000		

