

East End Elementary School Portland Public Schools Portland, Maine	Job No: 2370 Date: 10/20/2014 Scale: As noted	C-26
	Drawn by: HW Checked by: WH Drawing Title: Storm Drain Profiles	
Revisions: 1. 10/20/14: SUBMITTAL BY PLANNING DEPARTMENT 2. 10/20/14: SUBMITTAL BY PLANNING DEPARTMENT 3. 10/20/14: SUBMITTAL BY PLANNING DEPARTMENT	Consultants: Civil Engineer Landscape Architect Carroll Associates Structural Engineer Plakaban & Oger Mechanical Engineer Bennett Engineering Electrical Engineer Bartlett Design Interior Design T.M. Consulting Fire Solutions	P.E. WILLIAM G. HOFFMAN L.I.C. #41605
		60 DeLach Street Portland, ME 04103 Phone: 207.751.5911 Fax: 207.751.5915 Email: eah@carrollme.com

DeLUCA-HOFFMAN ASSOCIATES, INC.
 1000 DELOACH STREET
 PORTLAND, ME 04103
 207.751.5911
 207.751.5915
 info@delucahoffman.com

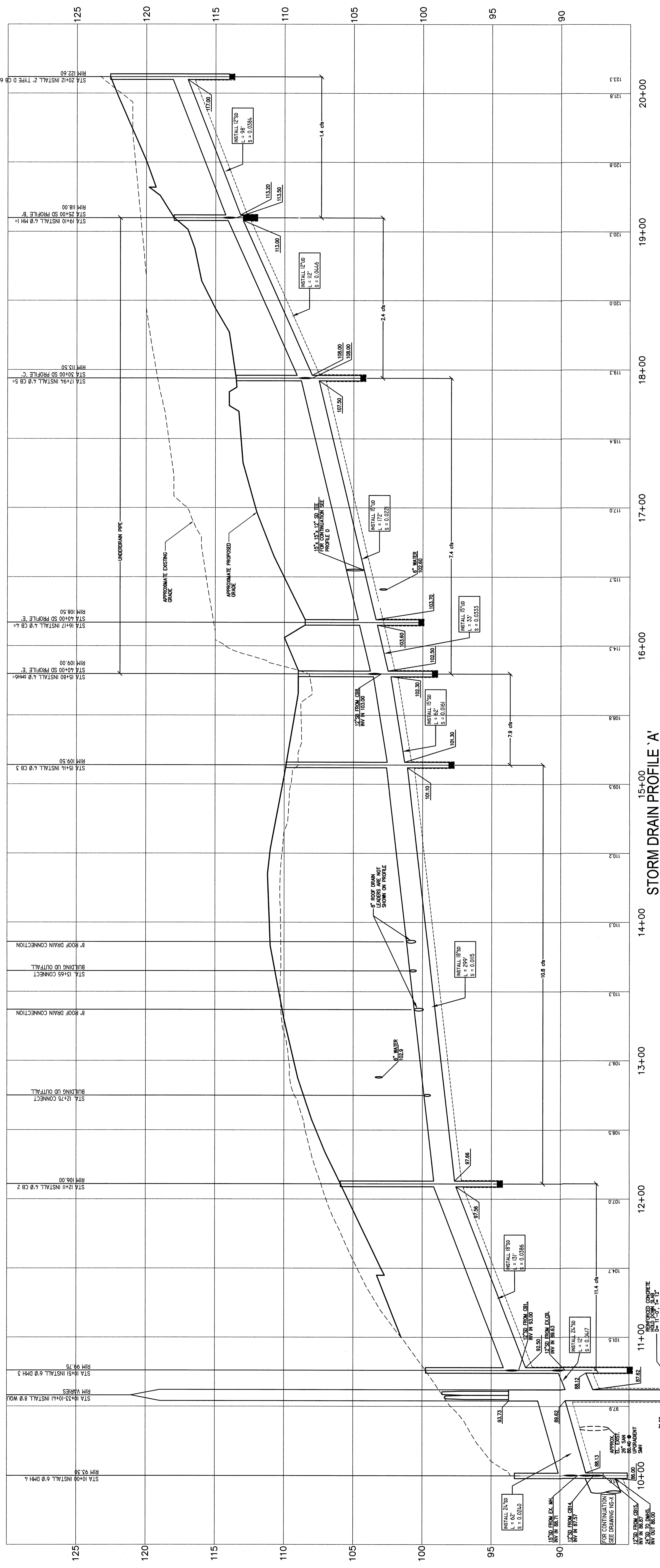

NOTE:
 CERTAIN CATCH BASINS ARE
 4'-0\"/>

BUILDING UNDERDRAIN, BALLFIELD
 UNDERDRAIN (BD ALTERNATE),
 AND ROOF DRAIN LEADERS ARE
 NOT PROFILED. SEE DRAWING

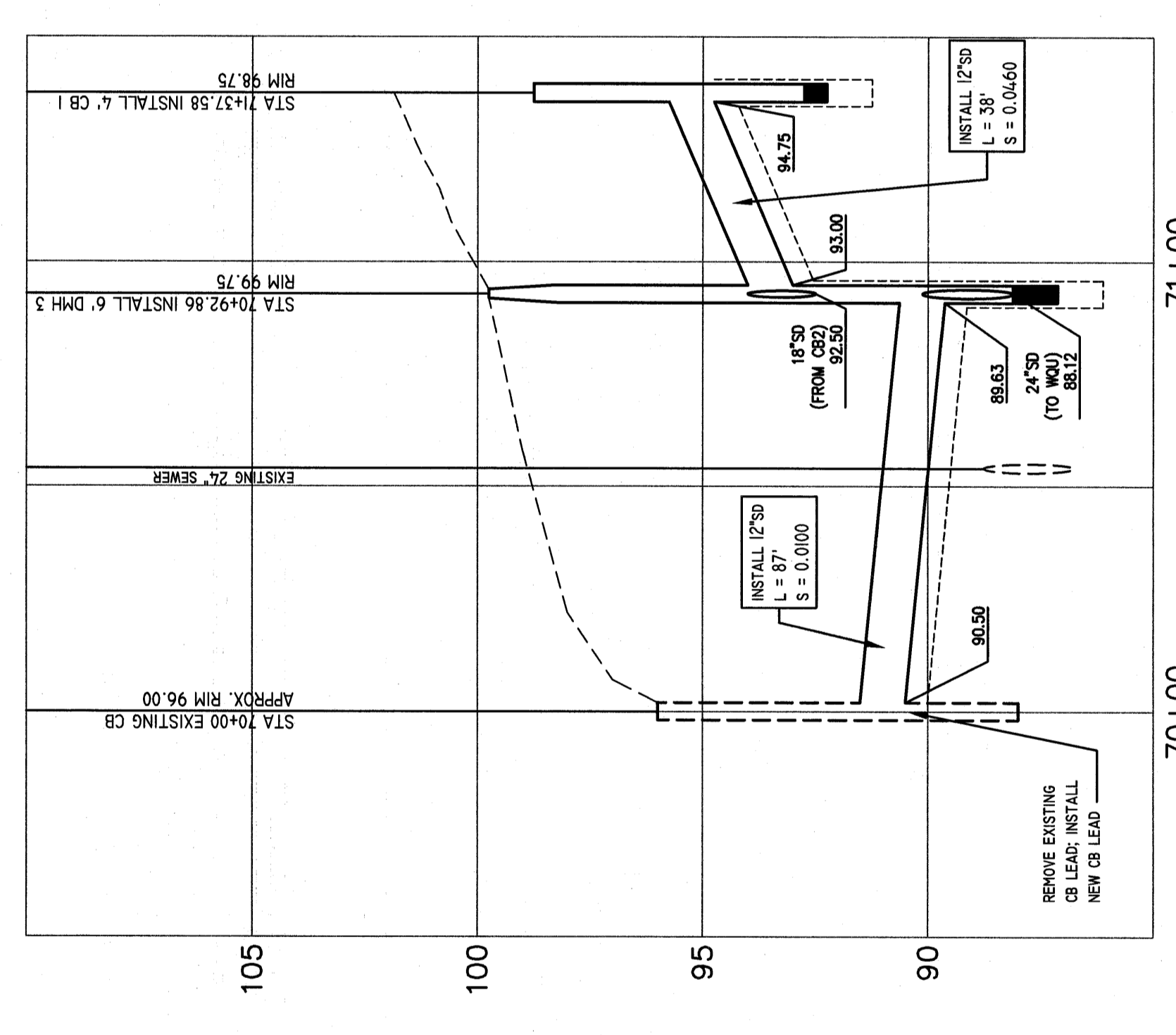

STORM DRAIN PROFILE 'A-A'
 SCALE: 1"=30' HORIZ., 1"=3' VERT.

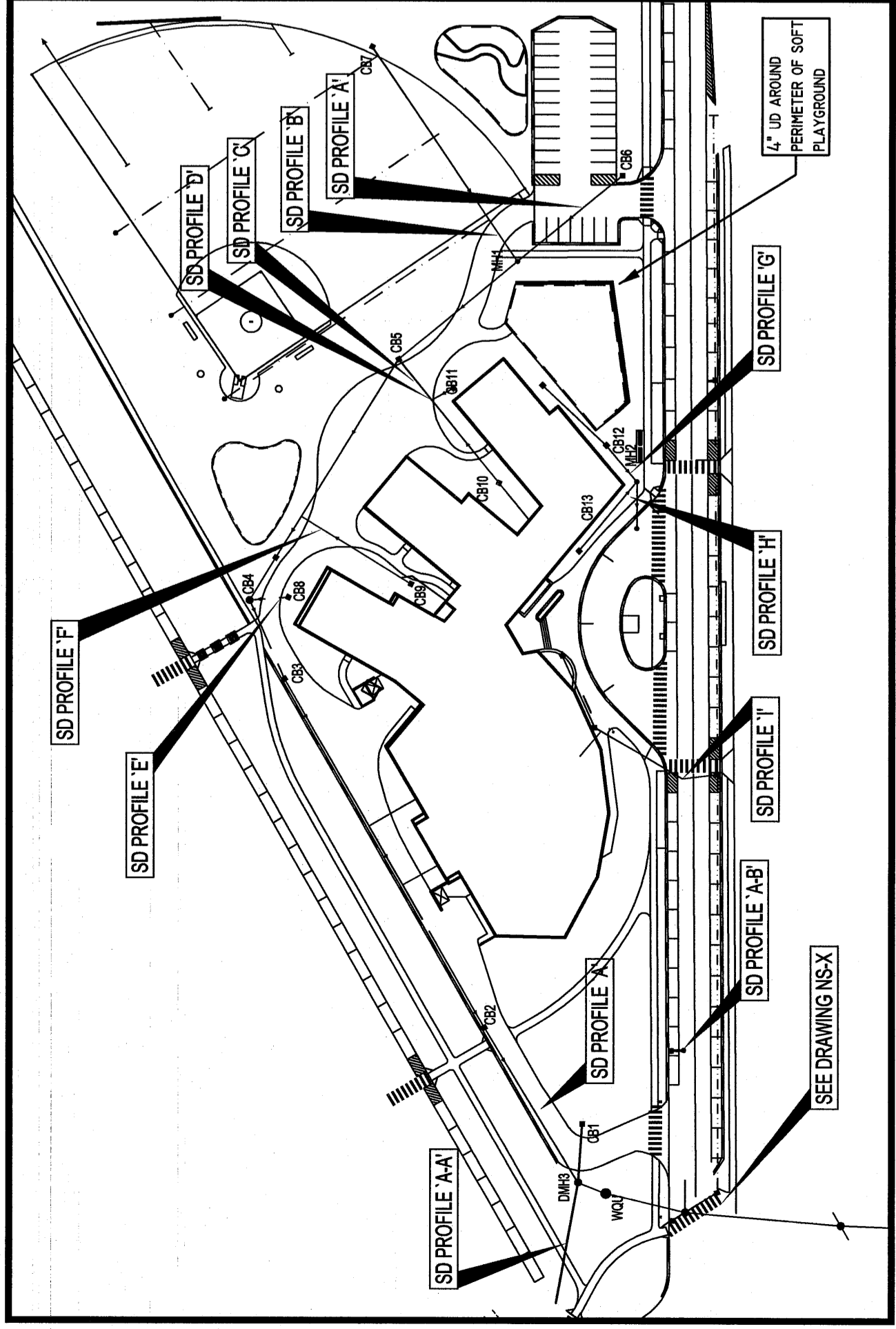

ORIENTATION PLAN
 N.T.S.

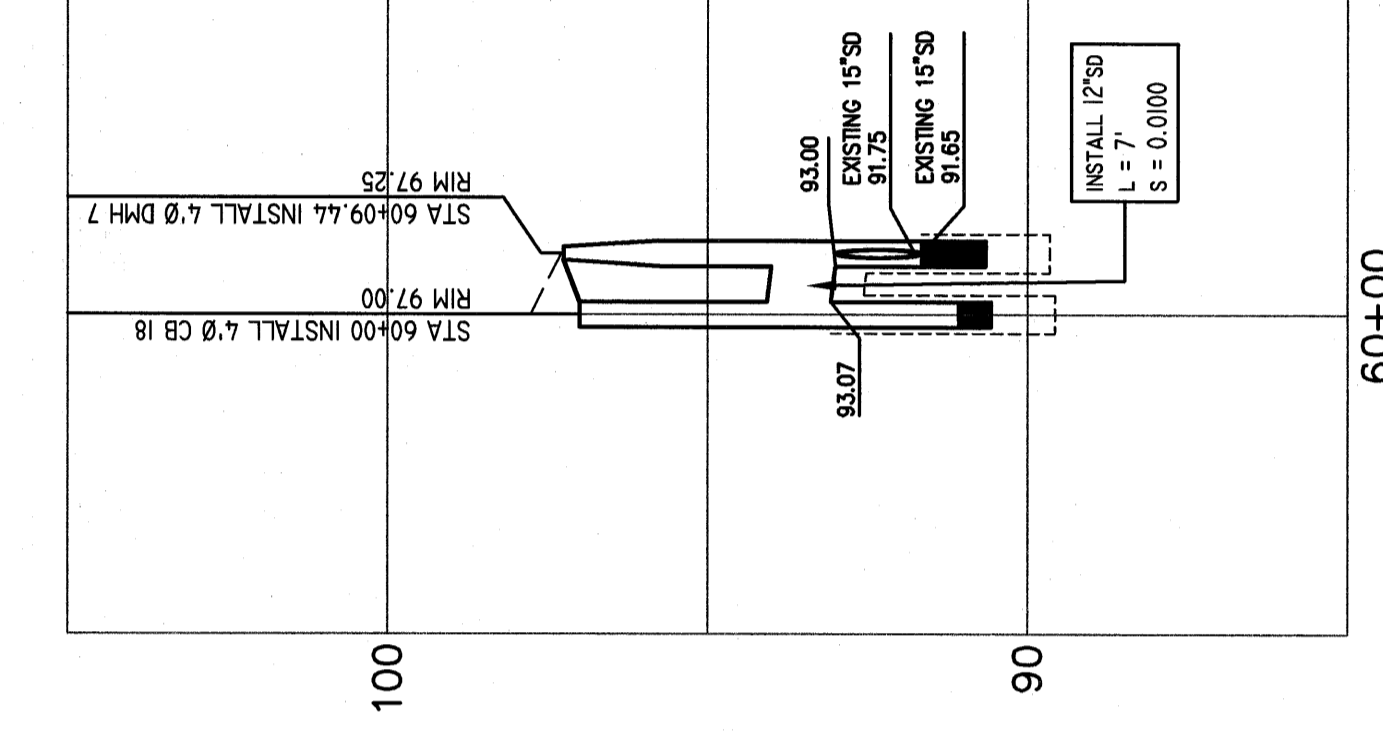

STORM DRAIN PROFILE 'A-B'
 SCALE: 1"=30' HORIZ., 1"=3' VERT.