

GENERAL NOTES:

- * INDICATES DIMENSIONS AND/OR ELEVATIONS TAKEN FROM THE FOLLOWING RECORD DRAWINGS:
 - A. POLLUTION ABATEMENT FACILITIES - CONTRACT NO. 6 WASTEWATER TREATMENT PLANT, PORTLAND WATER DISTRICT, BY CAMP DRESSER & MCKEE INC., DATED FEBRUARY 1973.
 - B. GRIT REMOVAL AND FLOW SPLITTING FACILITIES UPGRADE, PORTLAND WATER DISTRICT, PORTLAND, MAINE BY WRIGHT-PIERCE DATED MARCH 2000.
- GENERAL CONTRACTOR SHALL FIELD VERIFY ALL DIMENSIONS AND ELEVATIONS AND NOTIFY THE ENGINEER OF ANY DISCREPANCIES.
- ** THE INTERIOR DIMENSIONS OF THE TANKS VARY AS INDICATED AND ARE BASED ON A LIMITED FIELD SURVEY OF THE TANKS. GENERAL CONTRACTOR SHALL FIELD VERIFY THE TANK DIMENSIONS PRIOR TO THE NEW CONSTRUCTION.
- SEE CIVIL AND PROCESS DRAWINGS FOR ADDITIONAL SITE AND EQUIPMENT DEMOLITION.
- FOR GENERAL STRUCTURAL NOTES AND STANDARD DETAILS SEE DRAWINGS 5-17, 6-18 AND 8-10.

DEMOLITION NOTES:

- GENERAL CONTRACTOR SHALL BE RESPONSIBLE FOR REMOVING AND DISPOSING OF ALL DEMOLISHED CONCRETE, EQUIPMENT AND MATERIALS.
- DETAILS AND SECTIONS SHOWN FOR REMOVING OR MODIFYING CONCRETE AND OTHER STRUCTURAL ITEMS ARE BASED ON EXISTING CONTRACT DRAWINGS. IF CONDITIONS DIFFER FROM THOSE AS SHOWN ON THE PREVIOUS CONTRACT DRAWINGS, GENERAL CONTRACTOR SHALL NOTIFY ENGINEER.
- USE OF HEAVY DUTY PNEUMATIC HAMMERS ARE NOT PERMITTED TO REMOVE THE EXISTING CONCRETE. UNLESS OTHERWISE PERMITTED, LINE DRILLING OR SAW CUTTING WILL BE REQUIRED IN CUTTING EXISTING CONCRETE. GENERAL CONTRACTOR SHALL USE CAUTION NOT TO DAMAGE EXISTING CONCRETE WALLS AND SLABS TO REMAIN.
- GENERAL CONTRACTOR SHALL REPAIR ANY DAMAGE TO EXISTING STRUCTURES AS A RESULT OF CONTRACTOR'S ACTIVITIES AT NO ADDITIONAL COST TO THE OWNER.
- GENERAL CONTRACTOR SHALL THOROUGHLY CLEAN EXISTING CONCRETE TO BE MODIFIED PRIOR TO STARTING WORK.
- ALL WALL AND/OR FLOOR PENETRATIONS REMAINING AFTER THE REMOVAL OF PIPING, CONDUIT OR ANCHOR BOLTS ARE TO BE PATCHED AND FINISHED FLUSH TO MATCH EXISTING SURFACES.
- CONTRACTOR SHALL BRACE EXISTING STRUCTURES WHILE EXCAVATING ADJACENT TO THEM TO PREVENT UNDERMINING.
- ALL ITEMS SHOWN WITH SHADING SHALL BE REMOVED AND DISPOSED OF UNLESS OTHERWISE INDICATED.
- MAINTAIN ALL REINFORCING STEEL IN DEMOLISHED CONCRETE AND INCORPORATE INTO THE NEW CONCRETE, UNLESS OTHERWISE INDICATED.

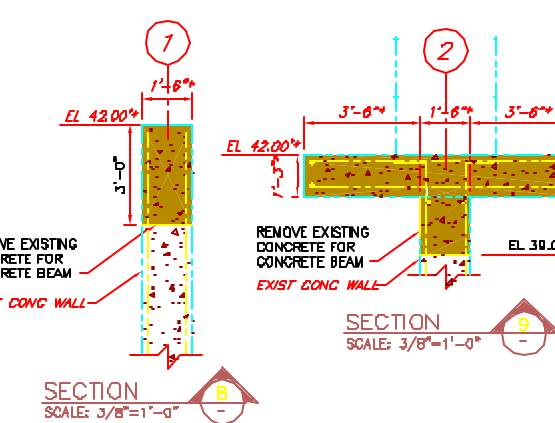
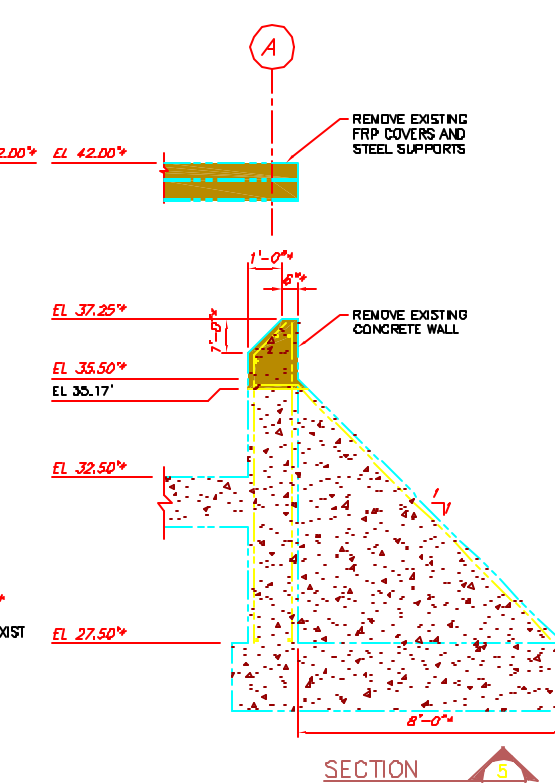
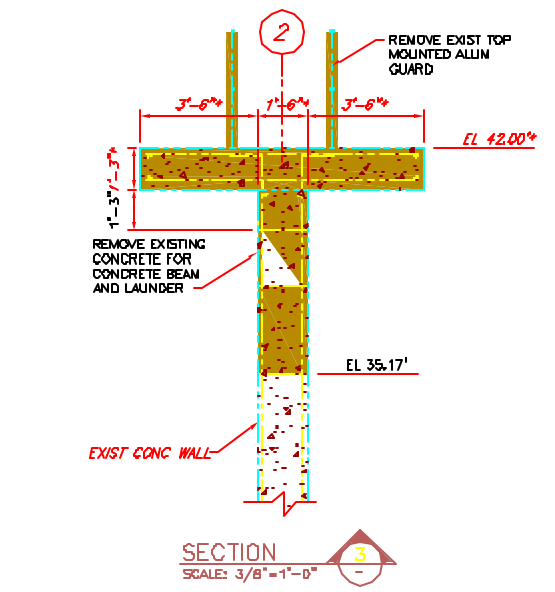
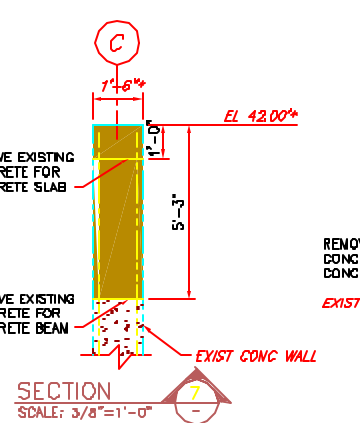
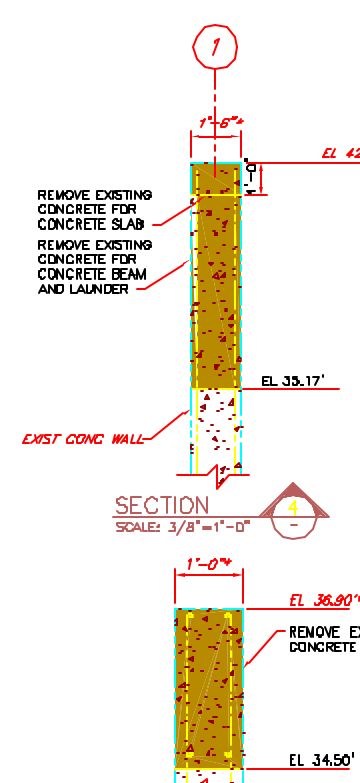
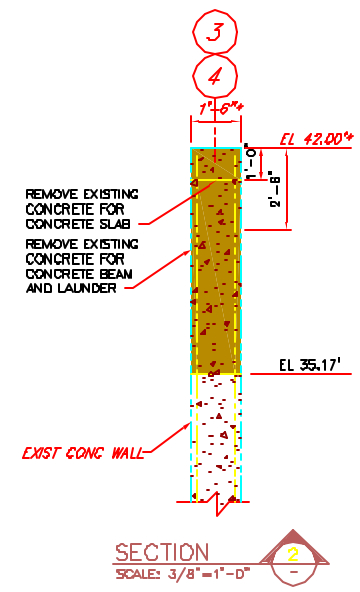
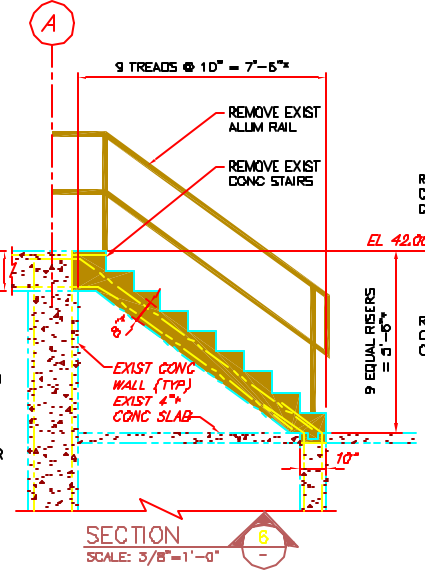
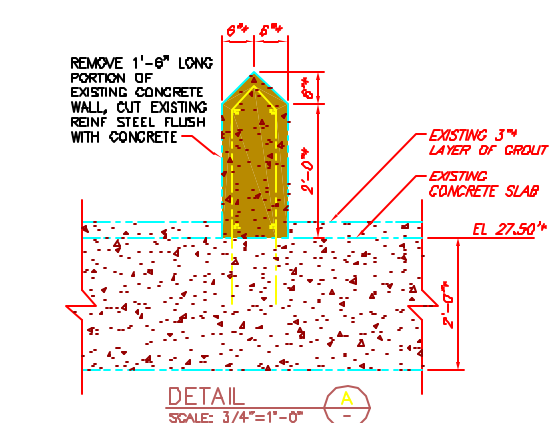
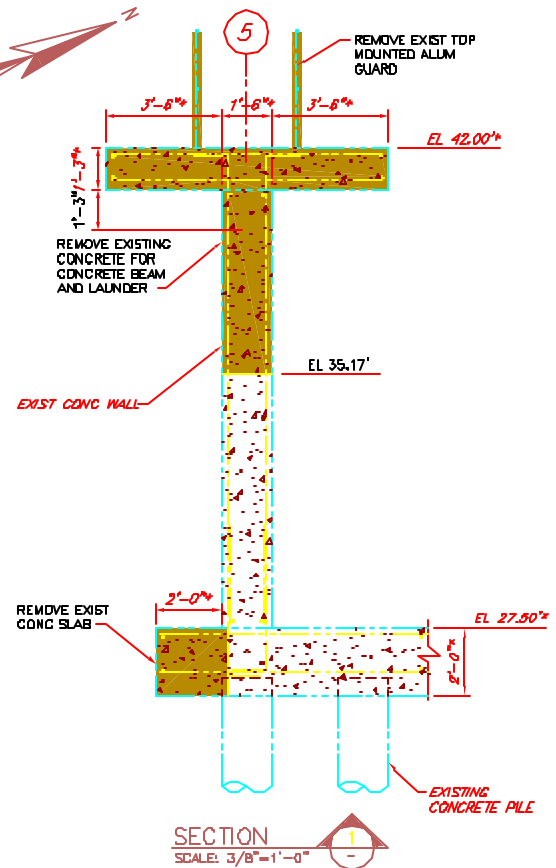

PROJECT PRINTS	4-4-07
ISSUED FOR BIDDING	3-4-07
DATE	
APPROVED	
REVISIONS	
NO	DESCRIPTION
1	
2	
3	
4	
5	
6	
7	
8	
9	
10	
11	
12	
13	
14	
15	
16	
17	
18	
19	
20	
21	
22	
23	
24	
25	
26	
27	
28	
29	
30	
31	
32	
33	
34	
35	
36	
37	
38	
39	
40	
41	
42	
43	
44	
45	
46	
47	
48	
49	
50	
51	
52	
53	
54	
55	
56	
57	
58	
59	
60	
61	
62	
63	
64	
65	
66	
67	
68	
69	
70	
71	
72	
73	
74	
75	
76	
77	
78	
79	
80	
81	
82	
83	
84	
85	
86	
87	
88	
89	
90	
91	
92	
93	
94	
95	
96	
97	
98	
99	
100	
101	
102	
103	
104	
105	
106	
107	
108	
109	
110	
111	
112	
113	
114	
115	
116	
117	
118	
119	
120	
121	
122	
123	
124	
125	
126	
127	
128	
129	
130	
131	
132	
133	
134	
135	
136	
137	
138	
139	
140	
141	
142	
143	
144	
145	
146	
147	
148	
149	
150	
151	
152	
153	
154	
155	
156	
157	
158	
159	
160	
161	
162	
163	
164	
165	
166	
167	
168	
169	
170	
171	
172	
173	
174	
175	
176	
177	
178	
179	
180	
181	
182	
183	
184	
185	
186	
187	
188	
189	
190	
191	
192	
193	
194	
195	
196	
197	
198	
199	
200	

Wright-Pierce
 99 Main Street, Topsham, Maine USA 04086
 TEL (207) 725-8721 FAX (207) 725-8444