

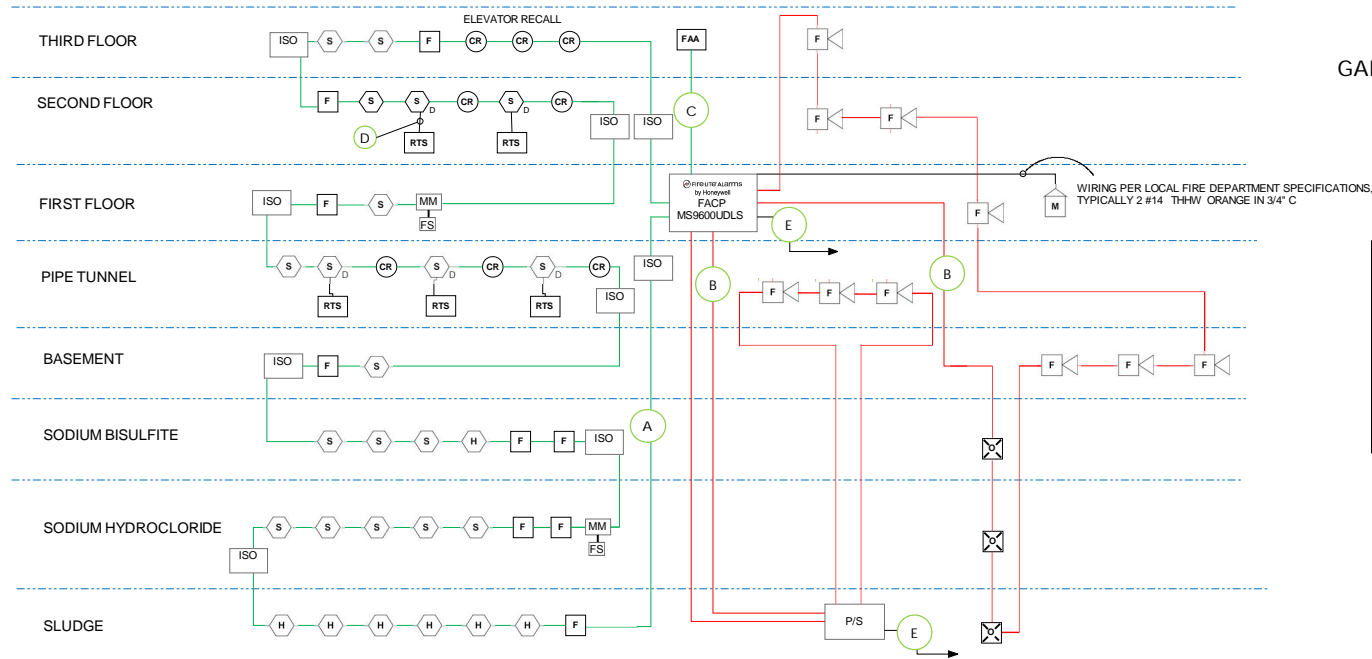

1 ACE STREET
 FALL RIVER, MA 02720
 SYSTEM DESIGNER
 EQUIPMENT SUPPLIER
 GARYE@FIRETECHNOLOGIESLLC.COM



Fire Alarm Scope of Work

Existing System

12 zone conventional Notifier fire alarm control panel that is monitored by the city of Portland using a site master box. Building is partially sprinklered with water flow switches reporting to the alarm control panel. Selected areas have spot detection in the form of smoke, heat, duct smoke and manual pull stations as indicated on the plan. Additionally there are smoke detectors installed for elevator recall.

Reason For Fire Alarm Upgrade

Customer is adding a Blower Room and Electrical Control Room within the existing tunnel and the fire alarm control panel does not have expansion capabilities. Additionally, the main CPU is damaged, not properly supervising a tripped master box. We are proposing to upgrade existing conventional fire alarm control panel and detection to addressable equipment then add new equipment for the 2 new rooms as shown on the fire alarm drawings.

New Proposed Fire Alarm System

We propose installing a new Firelite addressable fire alarm control panel with additional NAC power supply to power the existing and new horn / strobe devices. The existing wiring, manual pull stations, audio visual devices, duct smoke detectors and water flow switches would remain unchanged however new monitor modules would be installed to convert the detection devices to addressable. The existing smoke detectors and relay modules would be replaced with new addressable devices. A new annunciator would be installed at the main entrance to the building.

WIRING LEGEND		
(A)	FA16/2 FPLR	SLC LOOP
(B)	FA14/2 FPLR	NAC AND/OR POWER CIRCUIT
(C)	FA16/4 FPLR	SBUS COMMUNICATIONS LOOP
(D)	FA16/4 FPLR	MODULE CLASS A INTERCONNECT
(E)	3/4" C WITH 3 #12 THHN	120VAC 20A DEDICATED CIRCUIT
(F)	1 - CAT5E CABLE	COMMUNICATIONS INTERCONNECT

CONTRACTOR:

DEAN & ALLYN, INC.
 FIRE PROTECTION · SPECIAL HAZARD
 GRAY, MAINE



PROJECT:

EAST END WASTEWATER
 TREATMENT FACILITY
 PORTLAND, ME

DATE: 06/03/2016

DRAWN BY: GJE

**ANALOG ADDRESSABLE
 FIRE ALARM SYSTEM
 RISER DIAGRAM**