

2 SECOND FLOOR ELECTRICAL PLAN
SCALE: 1/4" = 1'-0"

- LIFE SAFETY SYMBOLS**
- S SMOKE DETECTOR
 - CO CARBON MONOXIDE DETECTOR
- ELECTRICAL SYMBOLS- "E" BESIDE SYMBOL DENOTES EXISTING ROUGH ELECTRICAL WORK**
- ⊕ DUPLEX OUTLET 18" A.F.F. UNLESS NOTED OTHERWISE
"WP" INDICATES WATERPROOF OUTLET
PROVIDE GFI WHERE NOTED
 - ⊕⊕ DOUBLE DUPLEX OUTLET 18" A.F.F. UNLESS NOTED OTHERWISE
"WP" INDICATES WATERPROOF OUTLET
PROVIDE GFI WHERE NOTED
 - ⊕⊕ SPECIAL PURPOSE POWER OUTLET - CONSULT OWNER - RE
STOVE, MICROWAVE, DISPOSAL
 - ▽ WALL PHONE JACK 18" A.F.F. UNLESS NOTED OTHERWISE
 - CTV CABLE TV IF REQ'D - ASK OWNER
 - SW SWITCH
 - 3W THREE-WAY SWITCH
 - COMPUTER - CONSULT OWNER - RE INTERNET CONNECTION
 - ⊕ DUPLEX FLOOR OUTLET
 - ⊕ CEILING FAN
 - ⊕ LIGHT & EXHAUST FAN
 - DB DOOR BELL
- LIGHTING SYMBOLS**
- ⊕ RECESSED CAN FIXTURE- LED WARM LIGHT TYPICAL
 - 2 WALL SCONCE
 - 3 EXTERIOR WALL SCONCE
 - 4 UTILITY LIGHT
 - ⊕ SURFACE MOUNTED FIXTURE
 - ⊕ PENDANT
 - MOTION MOTION ACTIVATED STRIP LIGHT- CLOSET OR UNDERCOUNTER

1 GROUND FLOOR ELECTRICAL PLAN
SCALE: 1/4" = 1'-0"

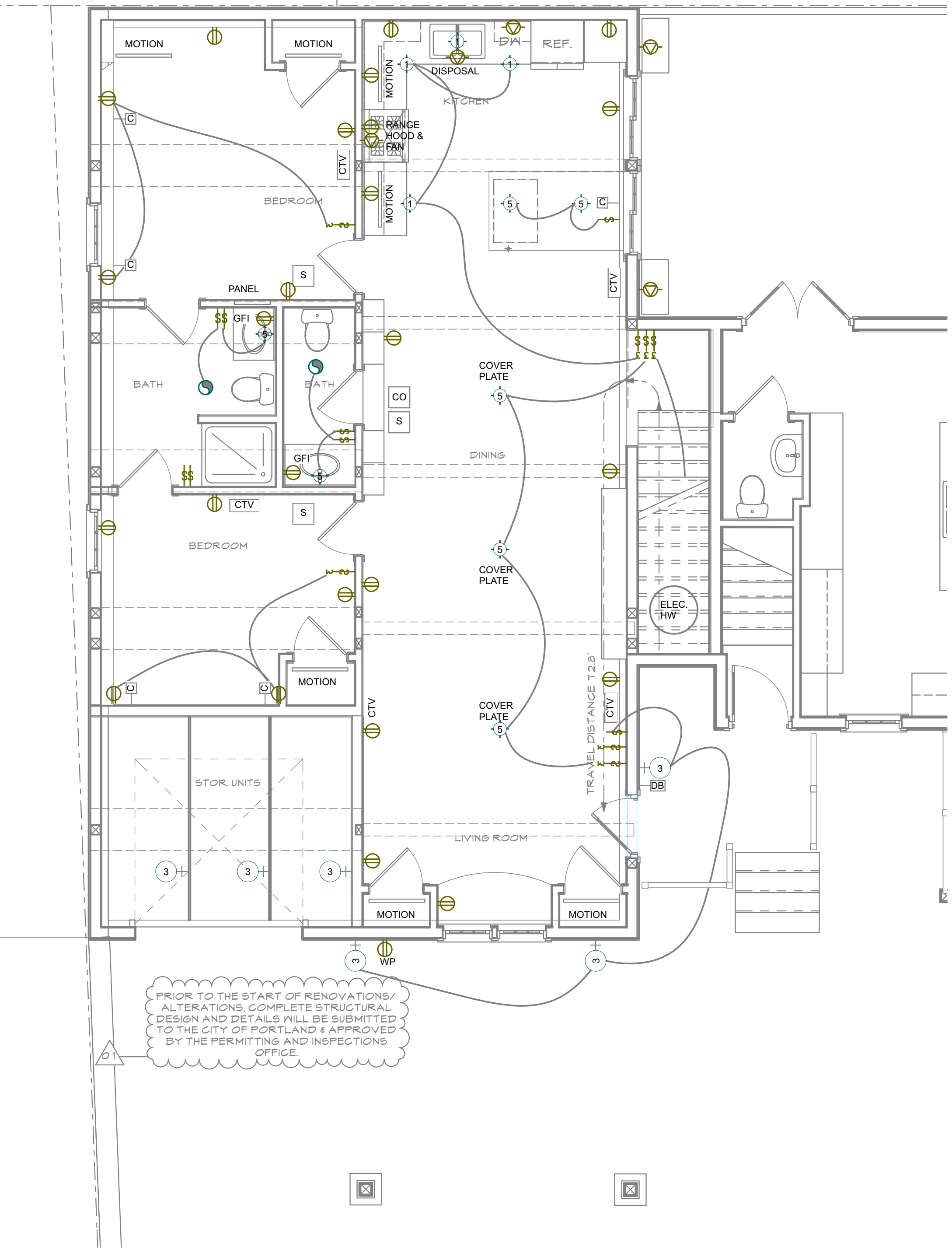

PRIOR TO THE START OF RENOVATIONS/
ALTERATIONS, COMPLETE STRUCTURAL
DESIGN AND DETAILS WILL BE SUBMITTED
TO THE CITY OF PORTLAND & APPROVED
BY THE PERMITTING AND INSPECTIONS
OFFICE.

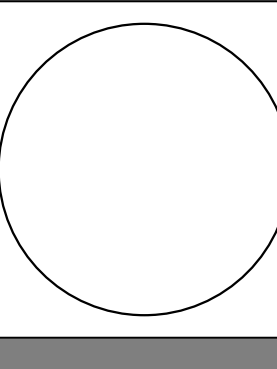

WHIPPLE
CALLENDER
ARCHITECTS

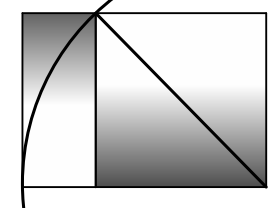

136 PLEASANT AVE.
PORTLAND, ME 04103
P 207.775.2696
F 207.775.3631
www.whipplecallender.com

| MARK | DATE | DESCRIPTION |
|------|----------|---------------------------|
| 1 | 11.13.17 | REVISION #1 - PERMIT REV. |

DATE: 11/14/17
CHECKED BY: JAD
DRAWN BY: CLBC
JOB: EAP 2017
SHEET TITLE:

ELECTRICAL
PLANS

CITY OF PORTLAND PERMIT REVIEW
SET- (REVISED 11/13/17)

THIS DRAWING IS AN INSTRUMENT OF SERVICE AND SHALL REMAIN THE PROPERTY OF WHIPPLE CALLENDER ARCHITECTS.
IT SHALL NOT BE USED FOR ANY OTHER PURPOSE THAT FOR WHICH IT IS SPECIFICALLY FURNISHED.