

**PARTITION TYPES**

- 1A 2x4 w/ One layer 5/8" FIRE RATED  
GWB EA. SIDE (NON-RATED)
- 1B 2x4 w/ One layer 5/8" FIRE RATED  
GWB EA. SIDE (1 HOUR RATED)  
*UL Des U305*
- 1C 2x4 w/ Two layers 5/8" FIRE RATED  
GWB EA. SIDE (2 HOUR RATED)  
*UL Des U301*
- 1D 2x4 w/ One layer 5/8" FIRE RATED  
GWB ONE SIDE, MR GWB OTHER  
SIDE
- 1E 2x4 w/ One layer 5/8" FIRE RATED  
GWB ONE SIDE, CEMENT BD.  
OTHER SIDE
- 2A 2x6 w/ One layer 5/8" FIRE RATED  
GWB EA. SIDE (NON-RATED)
- 2B 2x6 w/ One layer 5/8" FIRE RATED  
GWB EA. SIDE (1 HOUR RATED)
- 2C 2x6 w/ Two layers 5/8" FIRE RATED  
GWB EA. SIDE (2 HOUR RATED)  
*UL Des U334*
- 2D 2x6 w/ One layer 5/8" FIRE RATED  
GWB ONE SIDE, MR GWB OTHER  
SIDE
- 2E 2x6 w/ One layer 5/8" FIRE RATED  
GWB ONE SIDE, CEMENT BD.  
OTHER SIDE
- 3A 7 5/8" CMU Block, (2 HOUR RATED)
- 3B 7 5/8" CMU Block, 2x4 furring one  
side w/ 5/8" GWB (2 HOUR RATED)

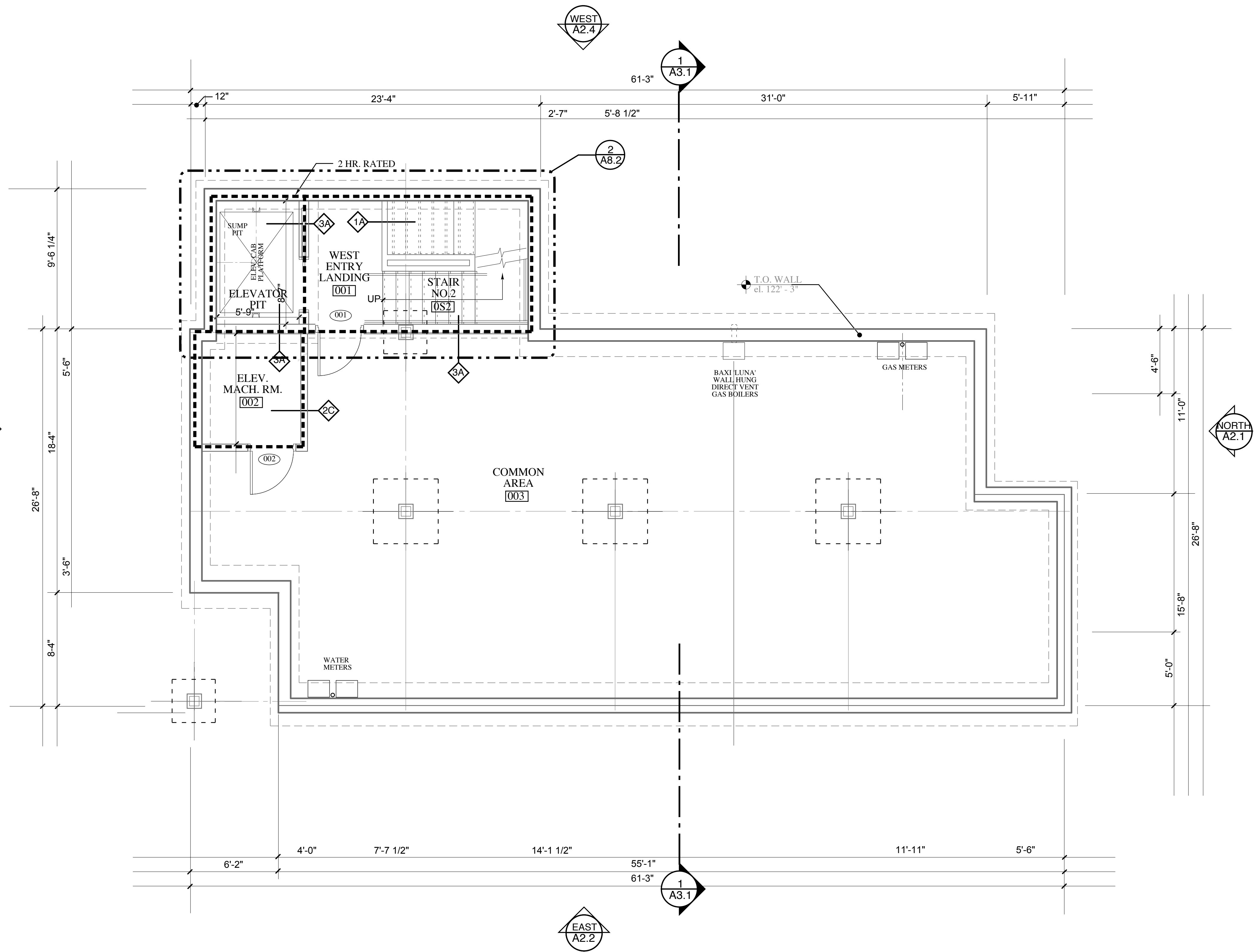

**1 BASEMENT PLAN**  
SCALE: 1/4" = 1'-0"

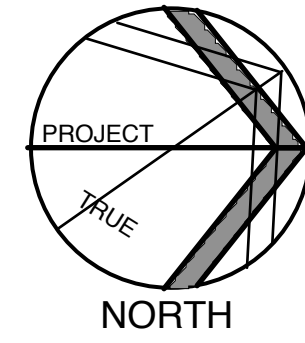

DAVID HEMBRE - ARCHITECT, INC.  
45 CASCO STREET  
PORTLAND, MAINE 04101  
(207) 699-2688

ISSUED FOR:	DATE
FOR RECORD	12/18/05
PERMIT	8/08/05
PERMIT	6/10/05
PUBLIC HEARING	1/18/05
SITE PLAN APPLICATION	8/5/04

**WILSON HEIGHTS  
CONDOMINIUMS**  
WILSON STREET  
PORTLAND MAINE  
DHA PROJ. # 20489

**BASEMENT PLAN**  
SCALE: 1/4" = 1'-0"

**A1.0**  
DRAWING NO.