

EXTERIOR DOOR TYPES											
STORY	1ST FLR				OHD-1		OHD-2		4TH FLR		
ID	101A	102A	103	105	OHD-1		OHD-2		401A	403A	404B
ELEVATION (NOMINAL DIMS)											
DESCRIPTION	ENTRY DOOR	TENANT ENTRY	DOOR TO BACK YARD	MECHANICAL ROOM	MAIN GARAGE DOOR		SECONDARY GARAGE DOOR		EXTERIOR LIVING DOOR AND SIDELIGHT	EXTERIOR LIVING TWO PANEL SLIDER	OFFICE DECK

INTERIOR DOOR TYPES														
STORY	1ST FLR													2ND FLR
ID	101B	101C	102B	104	201	203A	204A	204B	204B	206A	206B	207	207A	
ELEVATION (NOMINAL DIMS)														
DESCRIPTION	MUDROOM FROM GARAGE	ELEVATOR DOOR	TENANT MUDROOM FROM GARAGE	SPRINKLER ROOM	ENTRY CLOSET DOUBLE DOOR	BROOM CLOSET	MASTER BEDROOM ENTRY	MASTER BATHROOM	MASTER CLOSET	BEDROOM 2 ENTRY	BEDROOM 2 CLOSET	GUEST BATHROOM	LAUNDRY ROOM	

STORY						
ID	302	302A	302B	302C	302D	302E
ELEVATION (NOMINAL DIMS)						
DESCRIPTION	MASTER SUITE ENTRY	MASTER BEDROOM	MASTER BATHROOM	MASTER BATHROOM WC	MASTER DRESSING DOUBLE POCKET DOOR	EXERCISE

STORY						
ID	302E	303	303A	304	304A	305
ELEVATION (NOMINAL DIMS)						
DESCRIPTION	EXERCISE	BEDROOM 2 ENTRY	BATHROOM 2	BEDROOM 3 ENTRY	BATHROOM 3	LAUNDRY ROOM

STORY						
ID	3RD FLR		4TH FLR			
ID	305B	401B	404A	405	406	406A
ELEVATION (NOMINAL DIMS)						
DESCRIPTION	HALL DOOR TO BEDROOM 3	ELEVATOR DOOR	OFFICE	PANTRY	POWDER ROOM	MECH ROOM

DOOR SCHEDULE																
STORY	ID	DESCRIPTION	POSITION	MANUFACTURER	WIDTH	HEIGHT	FIRE RATING	DOOR MATERIAL	DOOR FINISH	FRAME MAT'L	FRAME FINISH	SILL DETAIL	JAMB DETAIL	HARDWARE SET	NOTES	
1ST FLR	101A	ENTRY DOOR	Exterior	SIMPSON, MOHAWK OR EQUAL	3'-0"	8'-0"	-	WOOD, MAHOAGANY		METAL					SEE HARDWARE SET TYPICAL	
	101B	MUDROOM FROM GARAGE	Interior	SEE NOTE FOR ALL INTERIOR DOORS, TYP	3'-0"	8'-6 1/2"	20 MIN	SCWD	SEE NOTE FOR ALL INTERIOR DOORS, TYP	WOOD					SEE HARDWARE SET TYPICAL	
	101C	ELEVATOR DOOR	Interior		3'-0"	8'-0"	-	SCWD		WOOD					SEE HARDWARE SET TYPICAL	
	102A	TENANT ENTRY	Exterior	SIMPSON, MOHAWK OR EQUAL	3'-0"	7'-3"	-	WOOD/GLASS MAHOAGANY		METAL					NOTE FOR INTERIOR DOORS	
	102B	TENANT MUDROOM FROM GARAGE	Interior		3'-0"	8'-6 1/2"	20 MIN	WOOD/GLASS		WOOD						
	103	DOOR TO BACK YARD	Exterior		3'-0"	7'-10 1/2"	-	METAL/GLASS		METAL						
	104	SPRINKLER ROOM	Interior		2'-0"	6'-0"	-	SCWD		WOOD						
	105	MECHANICAL ROOM	Exterior		2'-10"	7'-0"	-	HOLLOW METAL PTD	PID TO MATCH BRICK COLOR	METAL						
	OHD-1	MAIN GARAGE DOOR	Exterior	OVERHEAD DOOR COMPANY	10'-11 1/2"	8'-0"	-	METAL/ GLASS		METAL					GLASS TO BE TRANSLUCENT	
	OHD-2	SECONDARY GARAGE DOOR	Exterior	OVERHEAD DOOR COMPANY	14'-6"	7'-10 1/2"	-	METAL/ GLASS		METAL						
2ND FLR	201	ENTRY CLOSET DOUBLE DOOR	Interior	SEE NOTE FOR ALL INTERIOR DOORS, TYP	4'-0"	8'-0"	-	SCWD		WOOD					7/A-603	
	203A	BROOM CLOSET	Interior		2'-10"	8'-0"	-	SCWD		WOOD					6/A-603	
	204A	MASTER BEDROOM ENTRY	Interior		2'-10"	8'-0"	-	SCWD		WOOD					6/A-603	
	204B	MASTER BATHROOM	Interior		2'-10"	8'-0"	-	SCWD		WOOD		3/A-702			9/A-603	
	204B	MASTER CLOSET	Interior		2'-10"	8'-0"	-	SCWD		WOOD					9/A-603	
	206A	BEDROOM 2 ENTRY	Interior		2'-10"	8'-0"	-	SCWD		WOOD					6/A-603	
	206B	BEDROOM 2 CLOSET	Interior		2'-10"	8'-0"	-	SCWD		WOOD					9/A-603	
	207	GUEST BATHROOM	Interior		2'-10"	8'-0"	-	SCWD		WOOD		3/A-702			6/A-603	
	207A	LAUNDRY ROOM	Interior		2'-10"	8'-0"	-	SCWD		WOOD					6/A-603	
	3RD FLR	302	MASTER SUITE ENTRY	Interior	SEE NOTE FOR ALL INTERIOR DOORS, TYP	2'-10"	8'-0"	-	SCWD		WOOD					
302A		MASTER BEDROOM	Interior		2'-10"	8'-0"	-	SCWD		WOOD		3/A-702			9/A-603	
302B		MASTER BATHROOM	Interior		2'-8"	8'-0"	-	SCWD		WOOD						
302C		MASTER BATHROOM WC	Interior		2'-4"	8'-0"	-	SCWD		WOOD						
302C		MASTER BATHROOM WC	Undefined		2'-4"	7'-8"	-	SCWD		WOOD						
302D		MASTER DRESSING DOUBLE POCKET DOOR	Interior		4'-0"	8'-0"	-	SCWD		WOOD						
302E		EXERCISE	Interior		2'-10"	8'-0"	-	SCWD		WOOD					9/A-603	
303		BEDROOM 2 ENTRY	Interior		2'-10"	8'-0"	-	SCWD		WOOD					9/A-603	
303A		BATHROOM 2	Interior		2'-10"	8'-0"	-	SCWD		WOOD		3/A-702			6/A-603	
304		BEDROOM 3 ENTRY	Interior		2'-10"	8'-0"	-	SCWD		WOOD					6/A-603	
4TH FLR	401A	EXTERIOR LIVING DOOR AND SIDELIGHT	Exterior	LOEWEN	3'-0"	9'-7 1/2"	-	METAL/ GLASS	TO MATCH WINDOWS	METAL						
	401B	ELEVATOR DOOR	Interior		3'-0"	8'-0"	-	SCWD		WOOD						
	403A	EXTERIOR LIVING TWO PANEL SLIDER	Exterior	LA CANTINA OR EQUAL	8'-0"	9'-6"	-	METAL/ GLASS	TO MATCH WINDOWS	METAL						
	404A	OFFICE	Interior		2'-10"	9'-1 1/2"	-	SCWD		WOOD					9/A-603	
	404B	OFFICE DECK	Exterior	LOEWEN	2'-10"	9'-7 1/2"	-	METAL/ GLASS	TO MATCH WINDOWS	WOOD						
	405	PANTRY	Interior		2'-6"	8'-0"	-	SCWD		WOOD					9/A-603	
	406	POWDER ROOM	Interior		2'-6"	8'-0"	-	SCWD		WOOD					6/A-603	
	406A	MECH ROOM	Interior	MDF PANEL TOUCH, WITH TOUCH LATCH	2'-6"	8'-0"	-	MDF		WOOD						
																PROVIDE SOS INVISIBLE HINGE

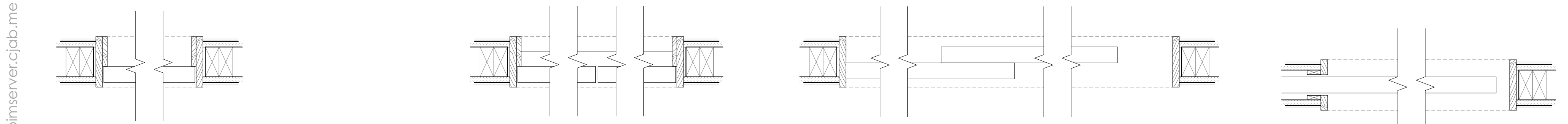

5 SINGLE HINGED DOOR PLAN DETAIL SCALE: 1 1/2" = 1'-0"
 6 DOUBLE SWING DOOR PLAN DETAIL SCALE: 1 1/2" = 1'-0"
 7 DOUBLE SLIDING DOOR PLAN DETAIL SCALE: 1 1/2" = 1'-0"
 8 POCKET DOOR PLAN DETAIL SCALE: 1 1/2" = 1'-0"

DOOR GENERAL NOTES:
 1. Interior doors to be provided in sizes and configurations as shown on the schedule. All interior doors are to be flush/slab type and solid core wood with 1 3/4" leafs unless noted otherwise. Typical finish to be white oak, rift sawn.
 All Interior Swinging Doors:
 Hinges: Min (4) Squared corner hinges on all interior doors greater than 7'-0" tall, by Ives or equal
 Color: Satin Nickel for all components
Function: Contractor to provide locking and keying functions to Owner and Architect for review before procurement
 Pocket Doors: Use soft-close pocket frames. Basis of Design is 1500SC by Johnson Door Frames
 Pocket Door Hardware: Pocket Door mortise Modern style by Emtek with mortise, satin nickel finish. Provide privacy type in bathrooms <http://emtek.com/door-accessories/>
 pocket-door-mortise-modern-rectangular
 2. Exterior Door Basis of Design is Loewen Wood Clad Triple Glazed in sizes and configurations as shown in the exterior door schedule schedule. Basis of Design exterior color is "Clear Anodized" and interior finish to be wood, douglas fir. Loewen exterior doors hardware to be also satin nickel and contemporary "Dallas" type. Preferred supplier: Pinnacle Window Solutions. Contact: Chris Bailey chrisbaileywindow.com 207-588-6590 x12. See Project Specifications for additional information.
At the time of this submission, the Owner is also interested in other triple glazed options in similar quality and color. Contractor to provide options and samples for Owner and Architect review as requested.
 3. Safety Glazing to be provided in windows and doors at hazardous locations in accordance with IBC 2009 Section 2406.4. It appears all doors with lites requires safety glazing. Door manufacturer to verify.
 4. **Submit requirements:** Contractor to provide door veneer sample by manufacturer for verification from Architect and Owner. Afterwards, but before procurement, Contractor to provide shop drawings for Architect's review.

BIM Server: bimservers.cjabb.me - BIM Server: 21/9 Moody Street/9 Moody Street_02152018

CALEB JOHNSON
STUDIO
110 EXCHANGE ST. 2ND FLOOR, PORTLAND, ME 04101
1-207-263-9777

ISSUE NUMBER: 001
 DATE: 12/01/2017
 DESCRIPTION: CITY REVIEW
 SUBMISSIONS: 001
 DATE: 03/12/2018
 DESCRIPTION: REVISOR CITY REVIEW COMMENTS

ARCHITECT: DRATSFERSON
 DATE: 08/11/14
 PROJECT STATUS: 90% CD'S

Brady Residence
 Jim and Julia Brady
 9 Moody Street Portland ME 04101

PRELIMINARY
NOT FOR CONSTRUCTION

DOOR AND HARDWARE
SCHEDULE
A-603