

**1**  
A1.1 **FIRST FLOOR PLAN**  
SCALE: 1/4" = 1'-0"

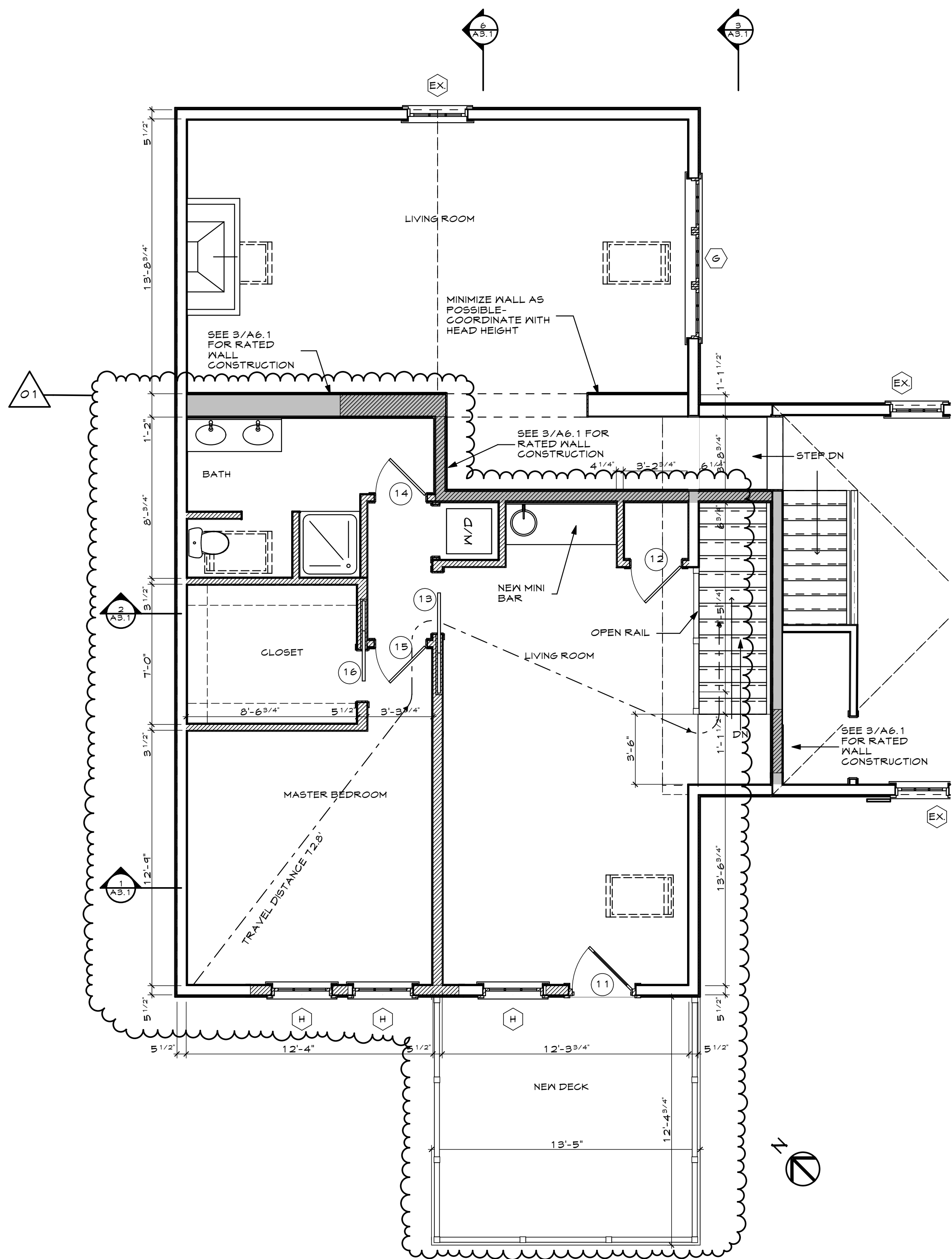

**2**  
A1.1 **SECOND FLOOR PLAN**  
SCALE: 1/4" = 1'-0"

NOTE: ENTIRE STRUCTURE WILL BE PROTECTED WITH CODE COMPLIANT NFFA 13R SPRINKLER SYSTEM

PRIOR TO THE START OF RENOVATIONS/ALTERATIONS, COMPLETE STRUCTURAL DESIGN AND DETAILS WILL BE SUBMITTED TO THE CITY OF PORTLAND & APPROVED BY THE PERMITTING AND INSPECTIONS OFFICE.

- #5 - NOT MORE THAN 2 STORIES WHERE NOT MORE THAN 4 UNITS PER FLOOR AND EXIT ACCESS DISTANCE DOES NOT EXCEED 50'
- #6.1 - THE TRAVEL DISTANCE WITHIN THE DWELLING UNIT DOES NOT EXCEED 75'