

1st floor existing and demolition plan
1/4"=1'-0"

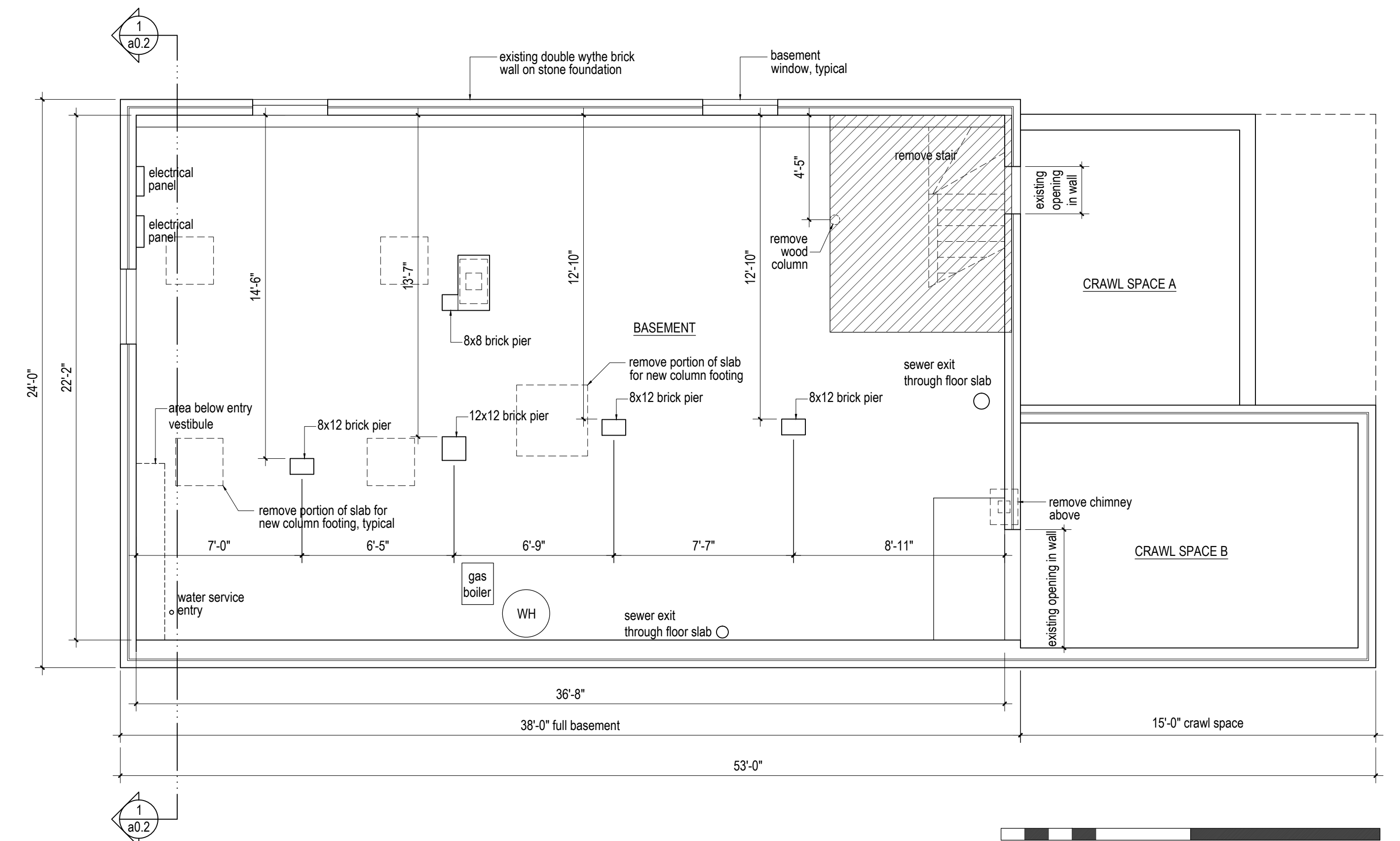

Basement existing and demolition plan
1/4"=1'-0"

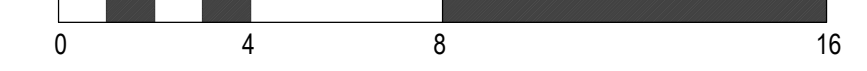

Demolition General Notes

Quality

1. Comply with applicable EPA notification regulation before starting selective demolition. Comply with ANSI A10.6 Safety Requirements for Demolition Operations, and NFPA 241: Standard for Safeguarding Construction, Alteration, and Demolition Operations.

Project Conditions and Requirement

1. The contractor shall keep and maintain a set of full size 24 x 36 prints of these sheets on the job site at all times.
2. The demolition plan is intended to be a schematic guide for removing existing assemblies, structures and materials as required for the new work to be installed. It is not intended to be exhaustive in detail. The contractor shall be familiar with the work of the project and remove all items as required by the work.
3. Remove all construction assemblies, materials, finishes, mechanical and electrical items necessary for the completion of the work as depicted on the drawings, specifications, and supplementary instructions.
4. The removal, disposal, and associated fees of all demolished items shall be the responsibility of the General Contractor.
5. All removed items, debris and salvage shall be the property of the General contractor unless noted otherwise in the drawings or by the tenant.
6. Demolition may uncover existing conditions, structures or assemblies that were not foreseen by the Architect or owner. The contractor shall bring to the attention of the Architect any existing conditions that are discovered that will affect the scope or design of the project.
7. The Contractor shall restore any fire rated assemblies damaged by the demolition process to their required rating.
8. The Contractor shall protect finishes, assemblies and structures not required to be demolished or that are outside the area of work.
9. The contractor shall control dust, noise and vibration, to protect the adjacent areas.
10. The contractor shall provide shoring and temporary support of existing structural members that the work requires.
11. Materials to be removed and reused, such as light fixtures and other electrical equipment, doors, and plumbing fixtures, shall be stored and protected from damage by ongoing construction activities.
12. The General Contractor shall maintain and ensure safe passage of building occupants around and through areas of demolition.
13. Partition walls shown to be demolished shall be demolished in their entirety, for their full height.

Hazardous Materials

14. If the Contractor suspects that hazardous materials such as asbestos containing materials (ACM), lead based paint, polychlorinated biphenyl (PCB) and petroleum products are present he shall not disturb the material and notify the tenant's representative.
15. Fluorescent lights shall be handled and disposed of properly to prevent the release of mercury vapor.

Conditions Specific to this Project

1. Contractor shall review with owner items to be retained by the owner, including doors, light fixtures, equipment and other items
2. The Contractor shall be aware of the fact that the demolition plans have been submitted to the City of Portland before completion of the construction documents. The completed construction documents may indicate additional demolition to be done

O B R I O N S T R E E T

24'-0"

24'-0"

24'-0"

24'-0"

24'-0"

1
a0.2

1
a0.2

1
a0.2