

Legend

- door width x height in feet and inches
- indicates number of door panels
- bifold door
- door with schedule designation
- 2068 P Pocket Door
- 2068 BP Bypass doors
- 2068 FR French Door
- wall section
- building cross section
- detail
- detail plan
- building elevation
- interior elevation
- detail section
- wall type
- interior elevation key
- built-in millwork: see millwork sheet or provide as design-build
- wall to be demolished
- existing wall
- new wall
- new wall with insulation
- roof slope: vertical rise per horizontal run

ABBREVIATIONS:

- a.f.f. above finished floor
- u.n.o. unless noted otherwise
- v.i.f. verify in field
- ex. existing

Minimum Live Loads per IRC 2009:

- Dwelling Units 40 psf
- Sleeping Areas 30 psf
- Exterior Balconies 60 psf
- Decks 40 psf
- Attic, no storage 10 psf
- Attic, with storage 20 psf

- Smoke alarms per City of Portland:
  1. new smoke alarms shall be photoelectric
  2. All new and replacement smoke and CO alarms shall be hardwired with battery backup
  3. Refer to City of Portland documents for required and acceptable detector locations and requirements for wiring and interconnection

GENERAL DIMENSION NOTES

1. Metal framing dimensions are to face of Gypsum Wall Board
2. Wood Framing: dimensions are to face of stud
3. CMU or Brick: Dimensions are to face of masonry unit
4. the contractor shall obtain rough opening dimensions from manufacturer. These drawings do not provide rough openings

- 2'-9" dimension to be constructed
- 2'-9" dimension to be constructed, not drawn to scale exactly
- 2'-9" +/- dimension within a string that can be adjusted as required
- 2'-9" min. minimum dimension required
- 2'-9" max. maximum dimension allowed
- 2'-9" req'd exact dimension required
- 2'-9" R.O. rough opening
- 2'-9" M.O. masonry opening
- 2'-9" F.O. finished opening



3 Existing Building



2 Existing Building



1 Existing Building

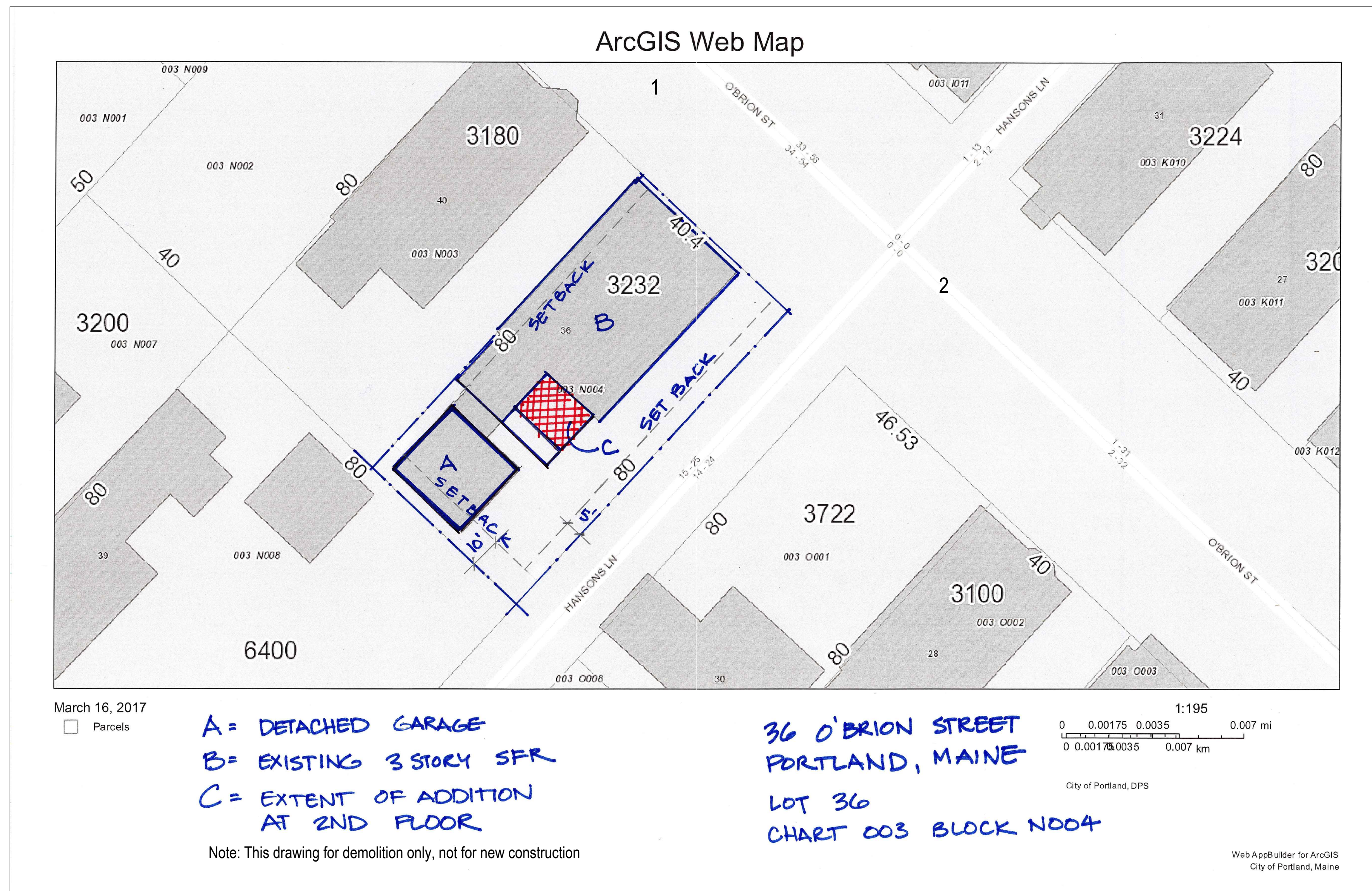

Location and Plot Plan from City Map

Demolition Plans

- a0.0 Site, photos
- a0.1 Basement, 1st floor demolition plans
- a0.2 2nd & 3rd floor Cross Section demolition plans

Architectural Plans to be submitted separately