

NOTES

1. THE CITY OF PORTLAND REQUIRES A PRE-CONSTRUCTION MEETING BEFORE SITE WORK CAN BEGIN.
2. INSTALL EROSION AND SEDIMENTATION CONTROL IN COMPLIANCE WITH THE MAINE DEPARTMENT OF ENVIRONMENTAL PROTECTION'S BEST MANAGEMENT PRACTICES AND GOOD HOUSEKEEPING PRACTICES IN ACCORDANCE WITH APPENDICES A, B AND C OF MAINE DEP CHAPTER 500. CONTRACTOR SHALL UTILIZE VARYING BMPs TO MINIMIZE THE MIGRATION OF EXPOSED SOILS FROM THE SITE. THESE INCLUDE BUT ARE NOT LIMITED TO THE FOLLOWING:
 - 2.1. GRADE SITE TO DRAIN INTERNALLY
 - 2.2. INSTALL LOCALIZED SEGMENTS OF MULCH BERM, SILT SOCK, HAY BALES AND/OR CRUSHED STONE CHECK DAMS TO FILTER RUNOFF BEFORE IT LEAVES THE SITE.
 - 2.3. INSTALL SILT SACKS (OR APPROVED EQUAL) IN DOWNGRADE CATCH BASINS INCLUDING:
 - 2.3.1. CB ON NORTH CORNER OF MUNJOY AND WILSON
 - 2.3.2. CB ON SOUTH CORNER OF MOODY AND VESPER
 - 2.3.3. FIELD INLET NORTHWEST OF PLAYGROUND AND ADJACENT TO MULTI-USE TRAIL.
 - 2.4. INSTALL TEMPORARY CONSTRUCTION ENTRANCE TO MINIMIZE TRACKING OF SOILS ONTO MUNJOY STREET.
 - 2.5. SWEEP MUNJOY STREET FREQUENTLY. WATER AND/OR VACUUMING SHALL BE USED TO CONTROL DUST WHEN SWEEPING.
3. CONTRACTOR SHALL INSPECT ALL EROSION AND SEDIMENTATION CONTROL MEASURES ON A WEEKLY BASIS AND AFTER RAIN/STORM EVENTS AND SHALL KEEP A LOG OF THESE INSPECTIONS. ANY ISSUES IDENTIFIED SHALL BE ADDRESSED AS SOON AS POSSIBLE AND BEFORE ADDITIONAL PRECIPITATION.
4. ALL WORK IN THE RIGHT OF WAY SHALL MEET THE CITY OF PORTLAND TECHNICAL MANUAL STANDARDS
5. ELEVATIONS ARE BASED ON CITY OF PORTLAND DATUM.
6. CONTRACTOR SHALL VERIFY ALL DIMENSIONS AND GRADES IN THE FIELD AND NOTIFY THE ENGINEER IMMEDIATELY OF ANY DISCREPANCIES.
7. UTILITY LOCATIONS ARE APPROXIMATE AND SHALL BE VERIFIED PRIOR TO CONSTRUCTION. ANY DISCREPANCIES OR CONFLICTS SHALL BE IMMEDIATELY REPORTED TO THE ARCHITECT/ENGINEER.
8. ALL UTILITY INSTALLATIONS SHALL MEET THE REQUIREMENTS OF THE CITY OF PORTLAND, AS WELL AS ANY OTHER LOCAL, STATE, UTILITY OWNER, AND FEDERAL REQUIREMENTS.
9. SITE CONTRACTOR SHALL REPAIR ALL DISTURBED AREAS IN ACCORDANCE WITH THE EROSION CONTROL PLAN AND DETAILS.
10. ALL TEMPORARY AND PERMANENT EROSION CONTROL MEASURES SHALL BE INSTALLED IN ACCORDANCE WITH THE GUIDELINES ESTABLISHED IN THE MAINE DEPARTMENT OF ENVIRONMENTAL PROTECTION'S BEST MANAGEMENT PRACTICES (LATEST ADDITION) AND MAINTAINED THROUGHOUT CONSTRUCTION OF THIS PROJECT.
11. ALL AREAS DISTURBED BY CONSTRUCTION NOT TO BE PAVED OR OTHERWISE TREATED SHALL BE LOAMED AND SEEDED ACCORDING TO THE PROJECT SPECIFICATIONS.

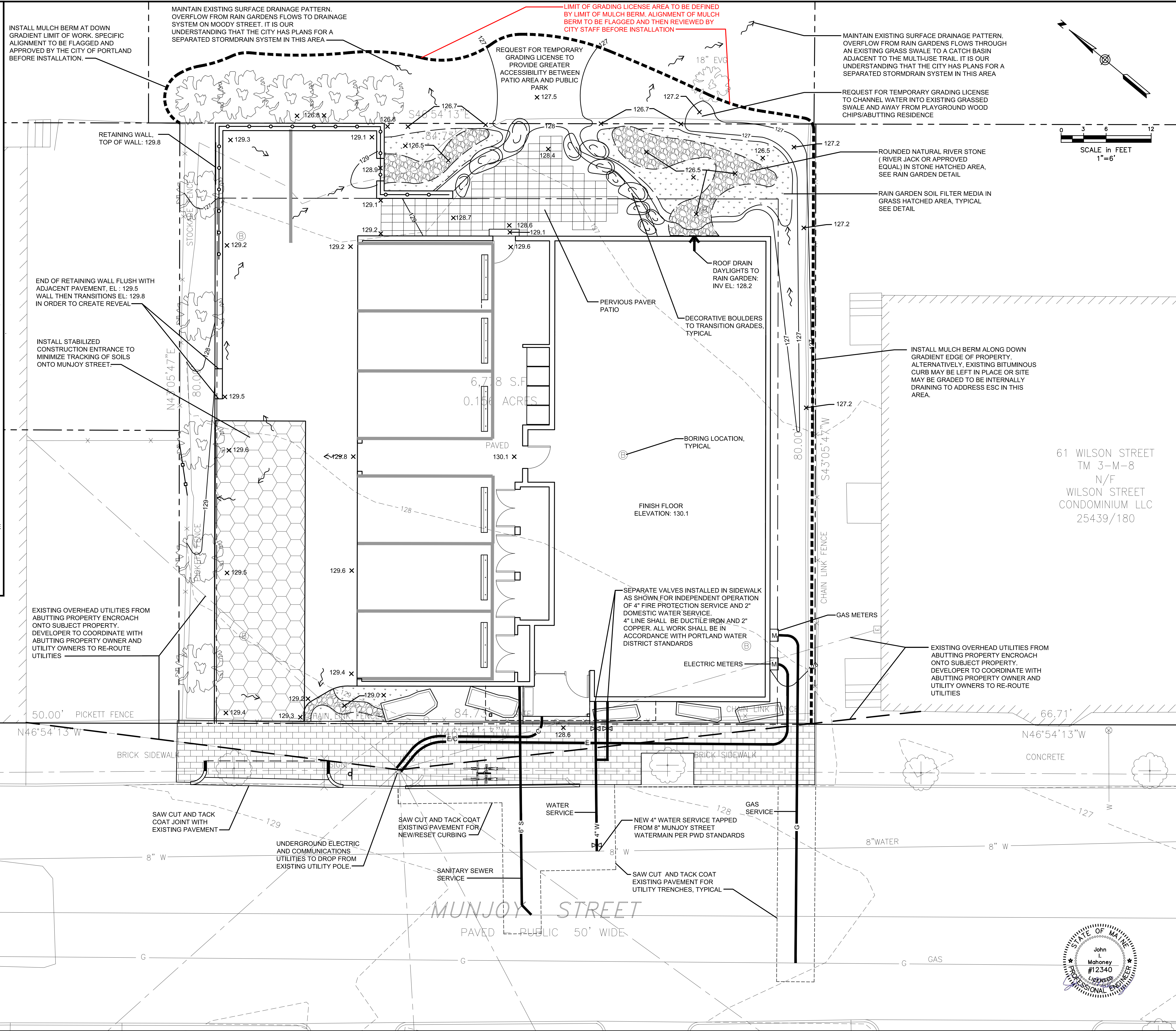

Project
65 Munjoy Street
 65 MUNJOY STREET
 PORTLAND, MAINE

Owner / Developer:
 Adams Apple, LLC
 30 Danforth Street, Suite 213
 Portland, Maine 04101
 207-272-8550

Random Orbit, Inc.
 30 Danforth Street, Suite 213
 Portland, Maine 04101
 207-712-0954

Consultants:

bild
 ARCHITECTURE
 Architect
 Bild Architecture
 30 Danforth Street, Suite 213
 Portland, Maine 04101
 207-408-0168

RANSOM
 Consulting, Inc.
 Civil Engineer
 Ransom Consulting, Inc.
 400 Commercial Street, Suite 404
 Portland, Maine 04101
 207-772-2891

pbla
 peter burke landscape architecture
 Landscape Architect
 Peter Burke Landscape Architecture
 34 Brown Street
 Westbrook, Maine 04092
 207-632-7372

Surveyor
 Owen Haskell, Inc.
 390 Route One
 Falmouth, Maine 04105
 207-774-0424

Structural Engineer
 SEI Shelley Engineering, Inc.
 Structural Consultants
 P.O. Box 1333
 Gray, Maine 04039
 Phone (207) 657-8031
 www.ShelleyEngineering.com

Geotechnical Engineer
 140 LEBRON ST. - SUITE 609 173 PLEASANT STREET
 LEWISTON, ME 04240 ROCKLAND, ME 04841
 Tel: (207) 936-3330 Tel: (207) 936-1161

SUMMIT
 GEOENGINEERING SERVICES
 www.summitgeosang.com

Construction Manager
 Wright-Ryan Construction
 10 Danforth Street
 Portland, Maine 04101
 207-773-3625

WR
 Wright-Ryan

GRADING, DRAINAGE AND UTILITIES PLAN

C	CITY COMMENT RESPONSE	1/27/16
B	SITE PLAN PERMITTING	12/11/15
A	PRE-APPLICATION MEETING	11/18/15
No.	Revision/Issue	Date
Design by:	JIM	Checked by: SJB
Drawn by:	JIM	Approved by: SJB
Project:	141.06157	
Sheet No:	C2	

PERMITTING SET

John L. Mahoney #12340
 LICENSED PROFESSIONAL ENGINEER
 STATE OF MAINE