

© 2017 RYAN SENATORE ARCHITECTURE

THIRD FLOOR UNIT
INTERIOR RENOVATIONS
 42 VESPER STREET
 PORTLAND, MAINE



RYAN SENATORE ARCHITECTURE
 666 CONGRESS STREET
 PORTLAND, MAINE 04101
 207-650-6414
 senatorearchitecture.com

CONSULTANTS:

REVISIONS:

DATE: 09/25/17

PROJECT No. 1703

DRAWN BY: RRT

CHECKED BY: RJS

SCALE: AS NOTED

SHEET TITLE:
FLOOR PLAN

A1-0

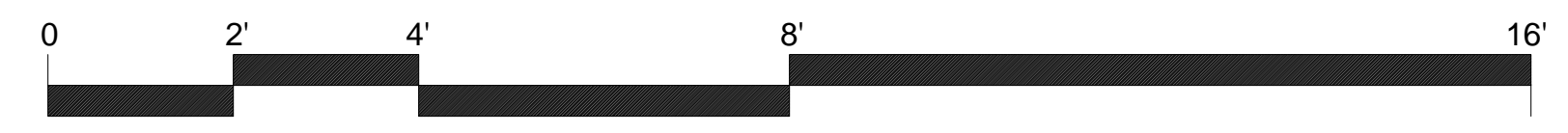
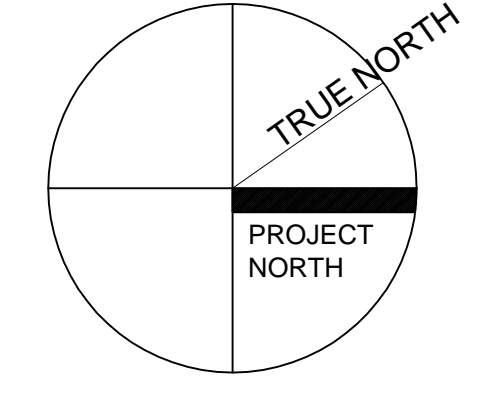
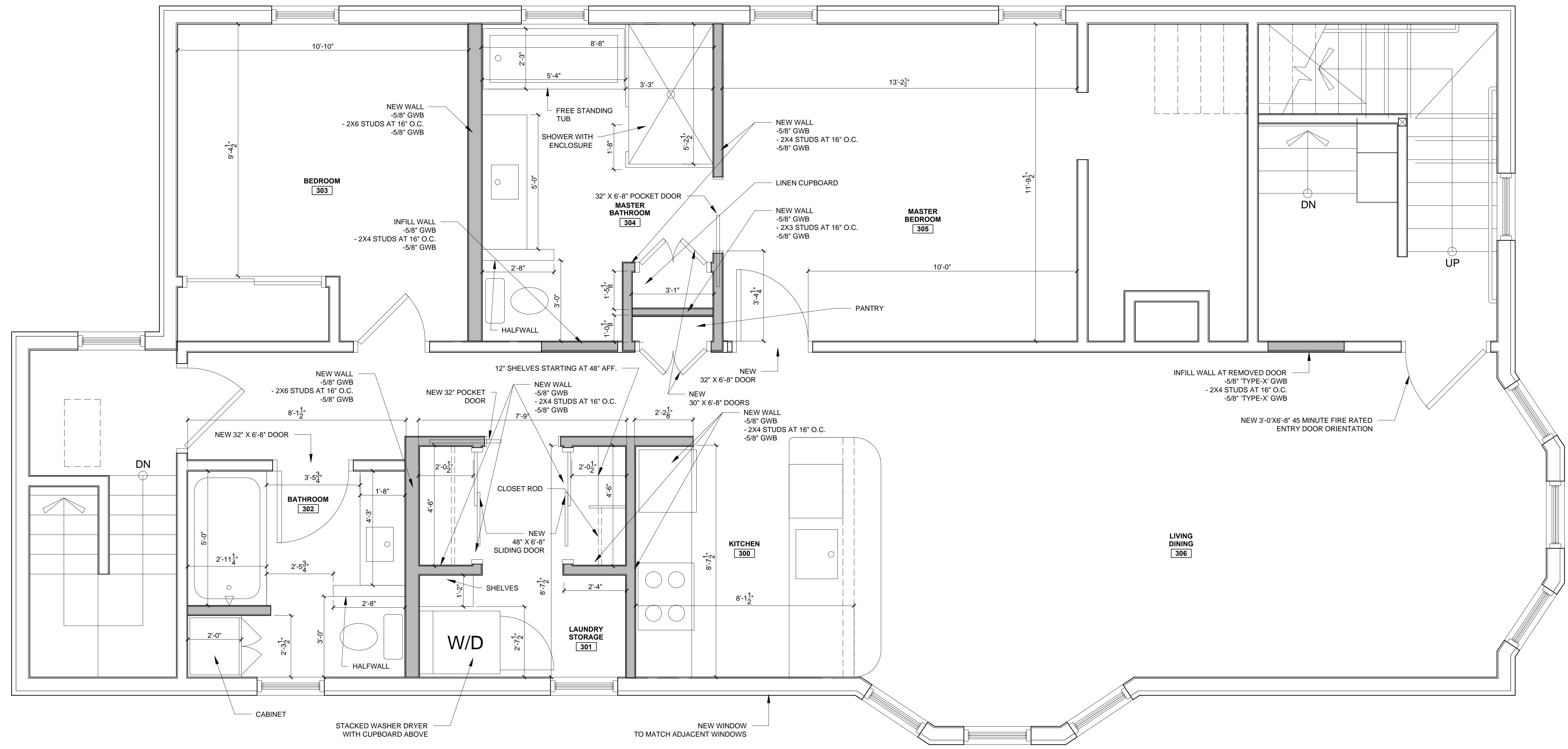

1 THIRD FLOOR PLAN
 1/2" = 1'-0"

WALL LEGEND	
	EXISTING WALL
	WALL TO BE REMOVED
	NEW WALL