

© 2017 RYAN SENATORE ARCHITECTURE

ROOF DECK ADDITION
42 VESPER STREET
PORTLAND, MAINE



RYAN SENATORE ARCHITECTURE
565 CONGRESS STREET
PORTLAND, MAINE 04101
207-650-6414
senatorearchitecture.com

CONSULTANTS:
STRUCTURAL:
Structural Integrity
77 Oak Street
Portland, ME 04101
207-774-4614

REVISIONS:

DATE: 10 APRIL 2017

PROJECT No. 1703

DRAWN BY: RRT

CHECKED BY: RJS

SCALE: AS NOTED

SHEET TITLE:
**ROOF DECK
DEMO PLAN**

AD-02

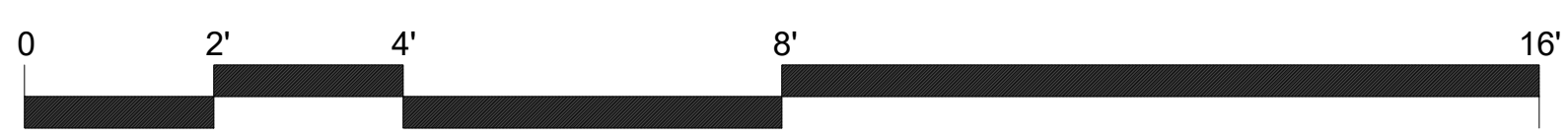
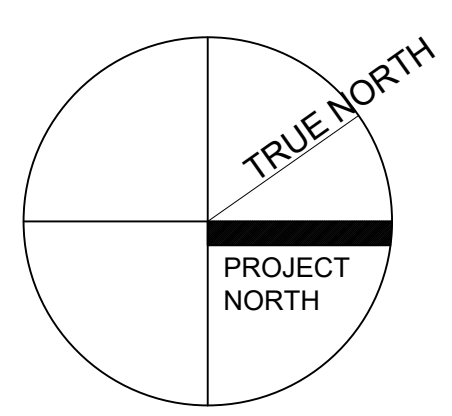
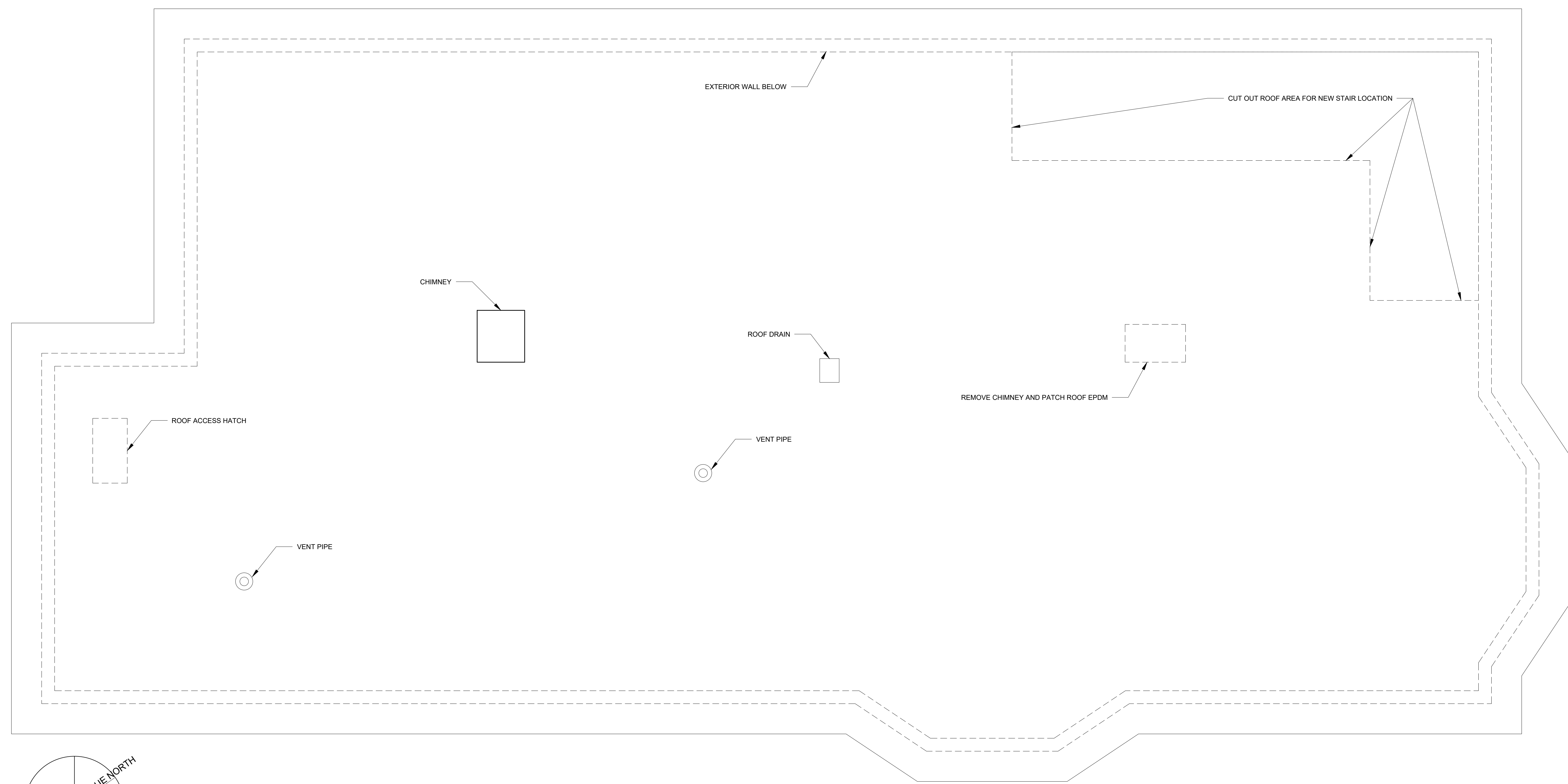

1 ROOF DEMO PLAN
1/2" = 1'-0"