

3 SECTION DETAIL AT NEW STAIR LANDING AND EXISTING ROOF AT EXTERIOR WALL
1/12" = 1'-0"

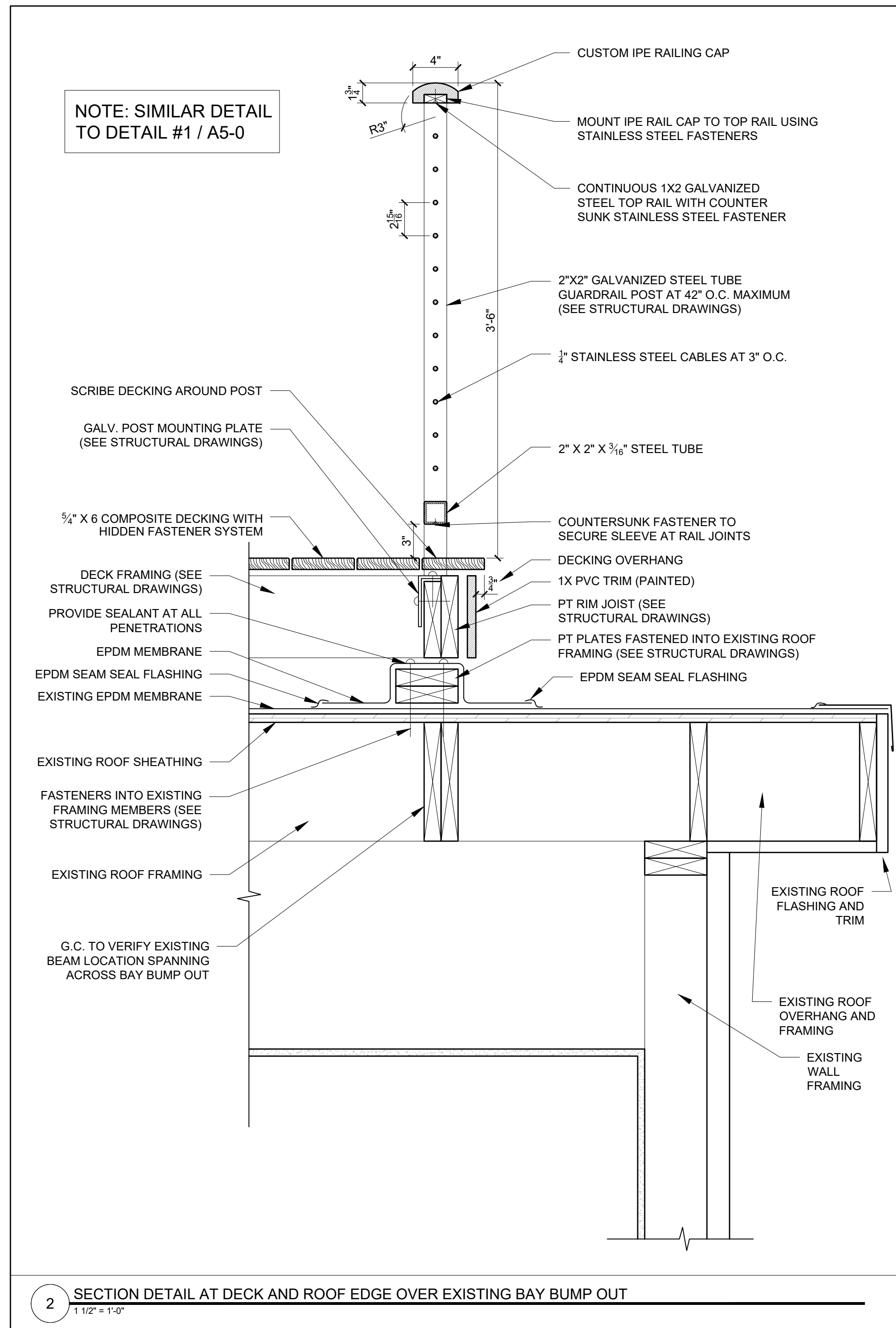

2 SECTION DETAIL AT DECK AND ROOF EDGE OVER EXISTING BAY BUMP OUT
1/12" = 1'-0"

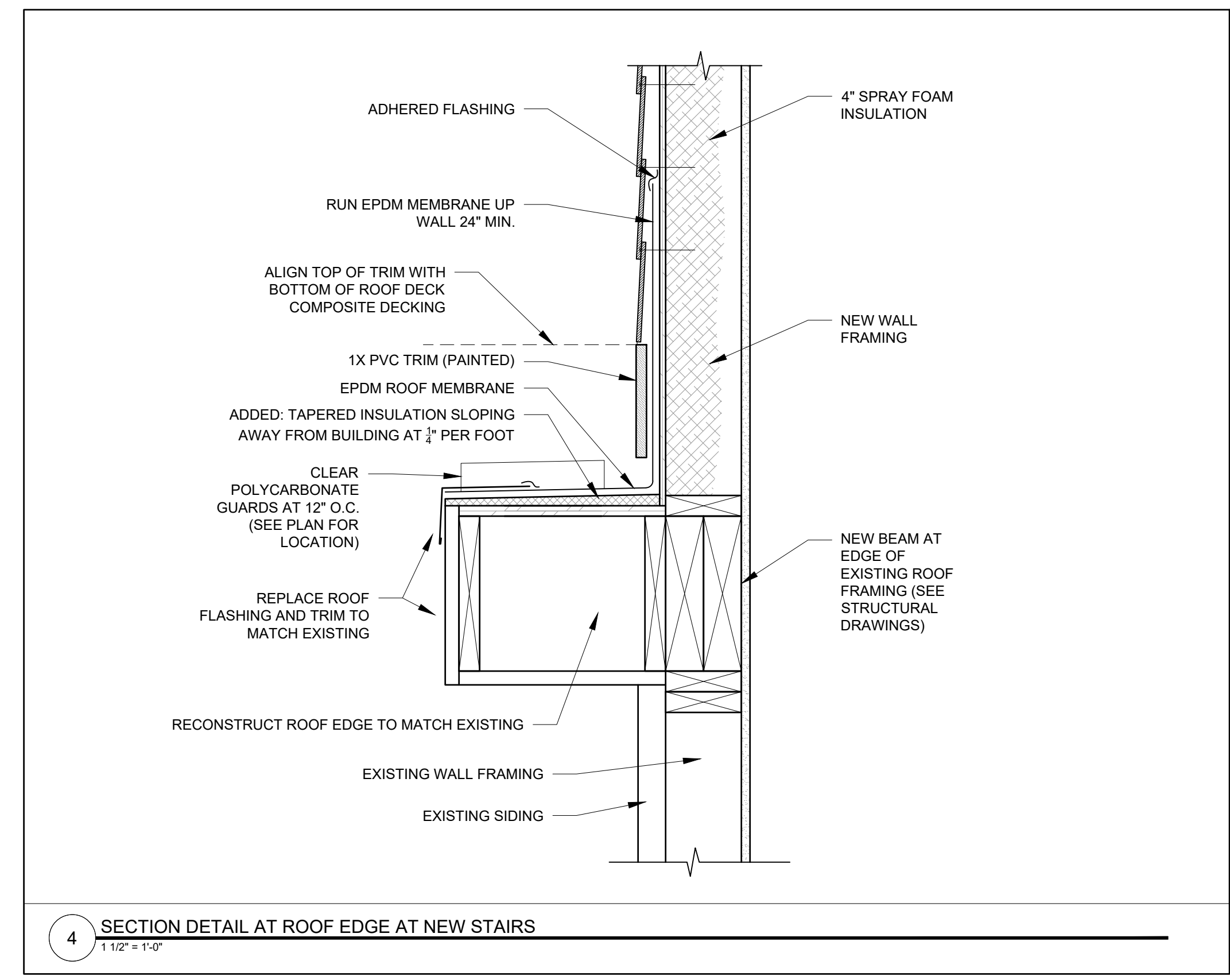

4 SECTION DETAIL AT ROOF EDGE AT NEW STAIRS
1/12" = 1'-0"

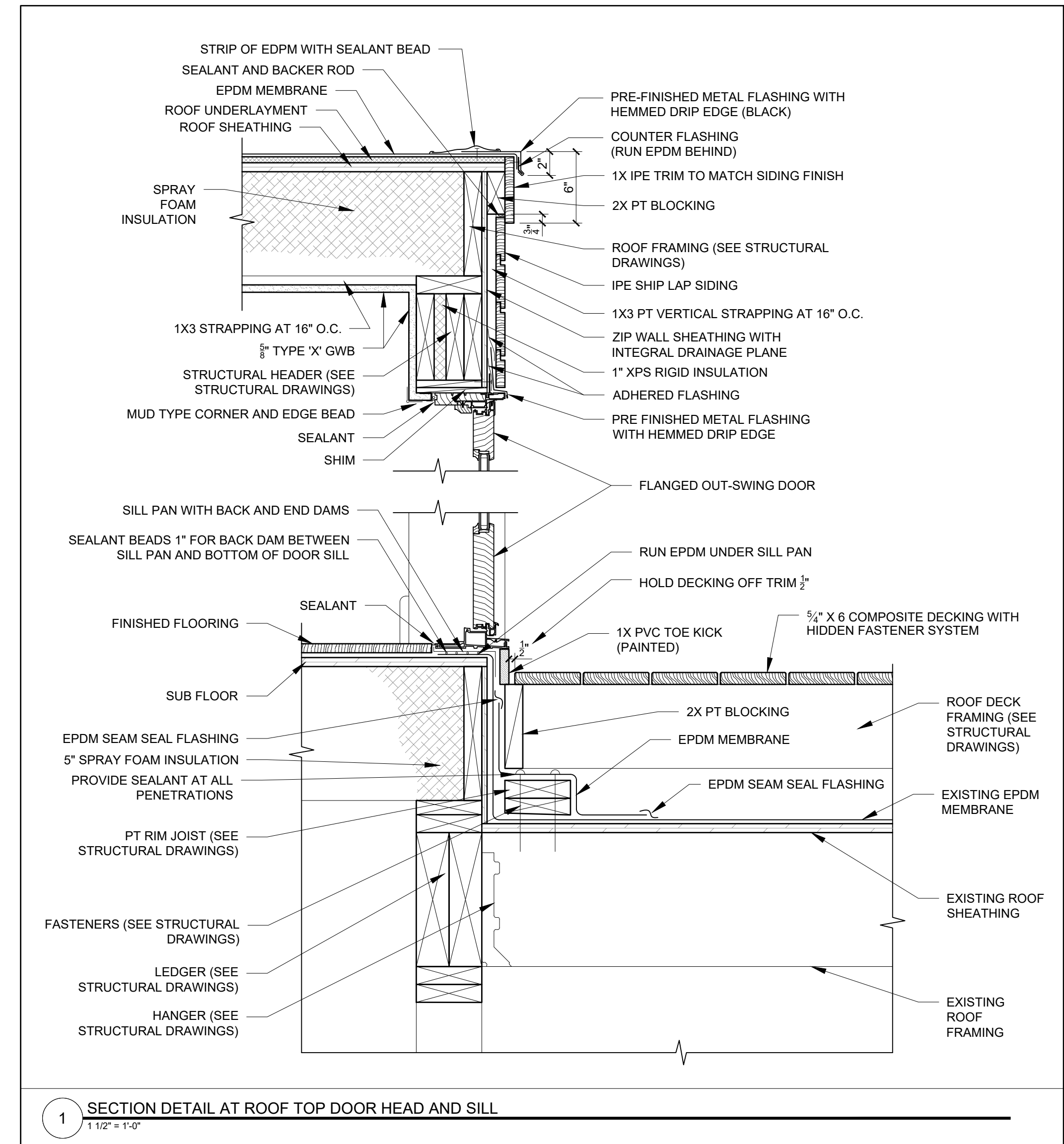

1 SECTION DETAIL AT ROOF TOP DOOR HEAD AND SILL
1/12" = 1'-0"

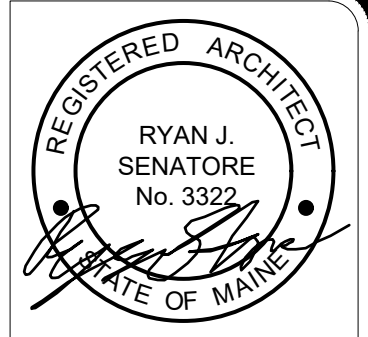

© 2017 RYAN SENATORE ARCHITECTURE

ROOF DECK ADDITION
42 VESPER STREET
PORTLAND, MAINE



RYAN SENATORE ARCHITECTURE
555 CONGRESS STREET
PORTLAND, MAINE 04101
207-650-6414
senatorearchitecture.com

CONSULTANTS:

STRUCTURAL:
Structural Integrity
77 Oak Street
Portland, ME 04101
207-774-4614

REVISIONS:

DATE: 10 APRIL 2017

PROJECT No. 1703

DRAWN BY: RRT

CHECKED BY: RJS

SCALE: AS NOTED

SHEET TITLE:

DETAILS

A5-2