

© 2017 RYAN SENATORE ARCHITECTURE

**ROOF DECK ADDITION**  
42 VESPER STREET  
PORTLAND, MAINE



**RYAN SENATORE ARCHITECTURE**  
555 CONGRESS STREET  
PORTLAND, MAINE 04101  
207-650-6114  
senatorearchitecture.com

CONSULTANTS:  
**STRUCTURAL:**  
*Structural Integrity*  
77 Oak Street  
Portland, ME 04101  
207-774-4614

REVISIONS:

DATE: 10 APRIL 2017

PROJECT No. 1703

DRAWN BY: RRT

CHECKED BY: RJS

SCALE: AS NOTED

SHEET TITLE:  
**BASEMENT FRAMING - DEMO AND NEW PLAN**

**A1-3**

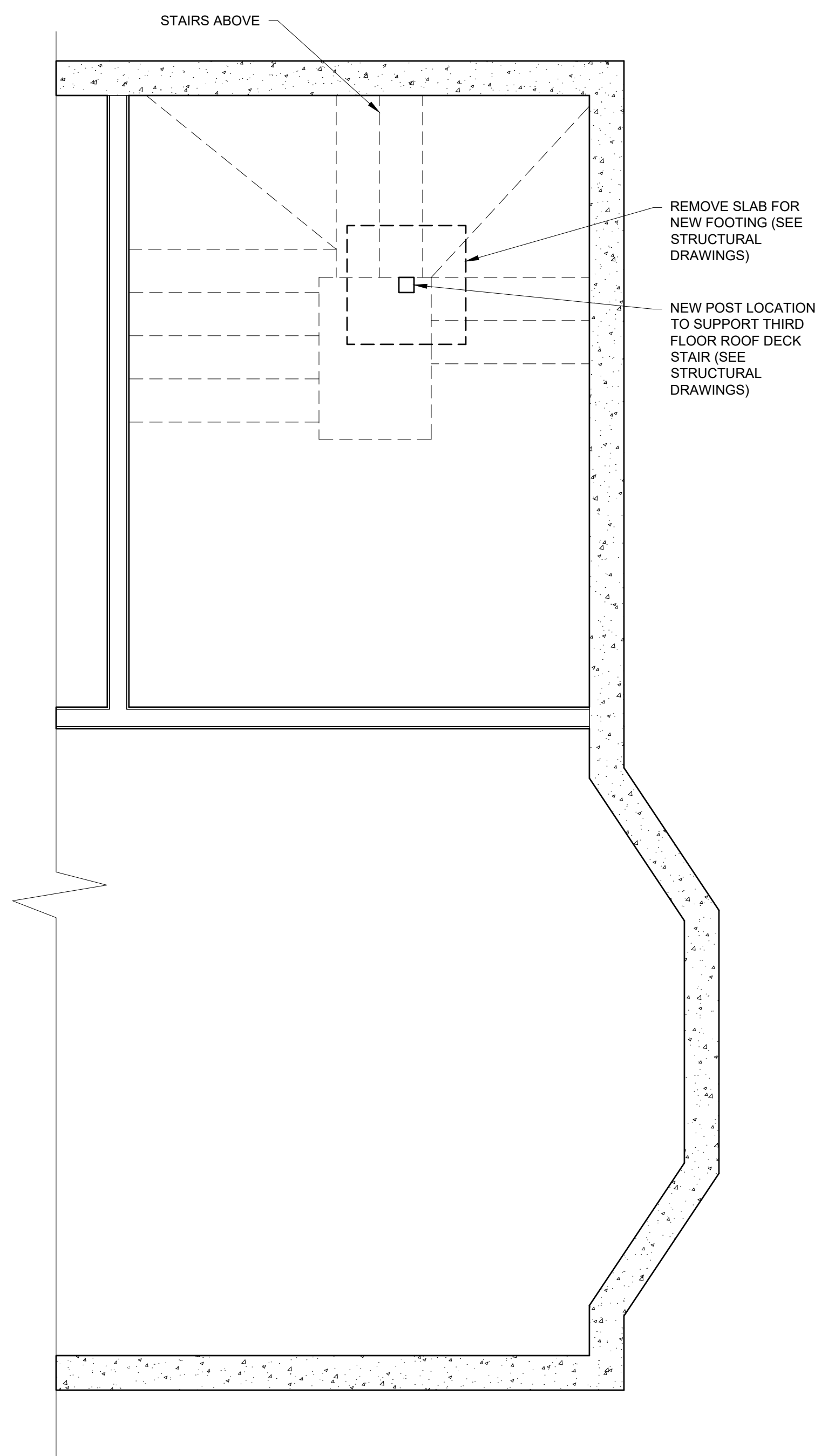

2 BASEMENT DEMO PLAN  
1/2" = 1'-0"

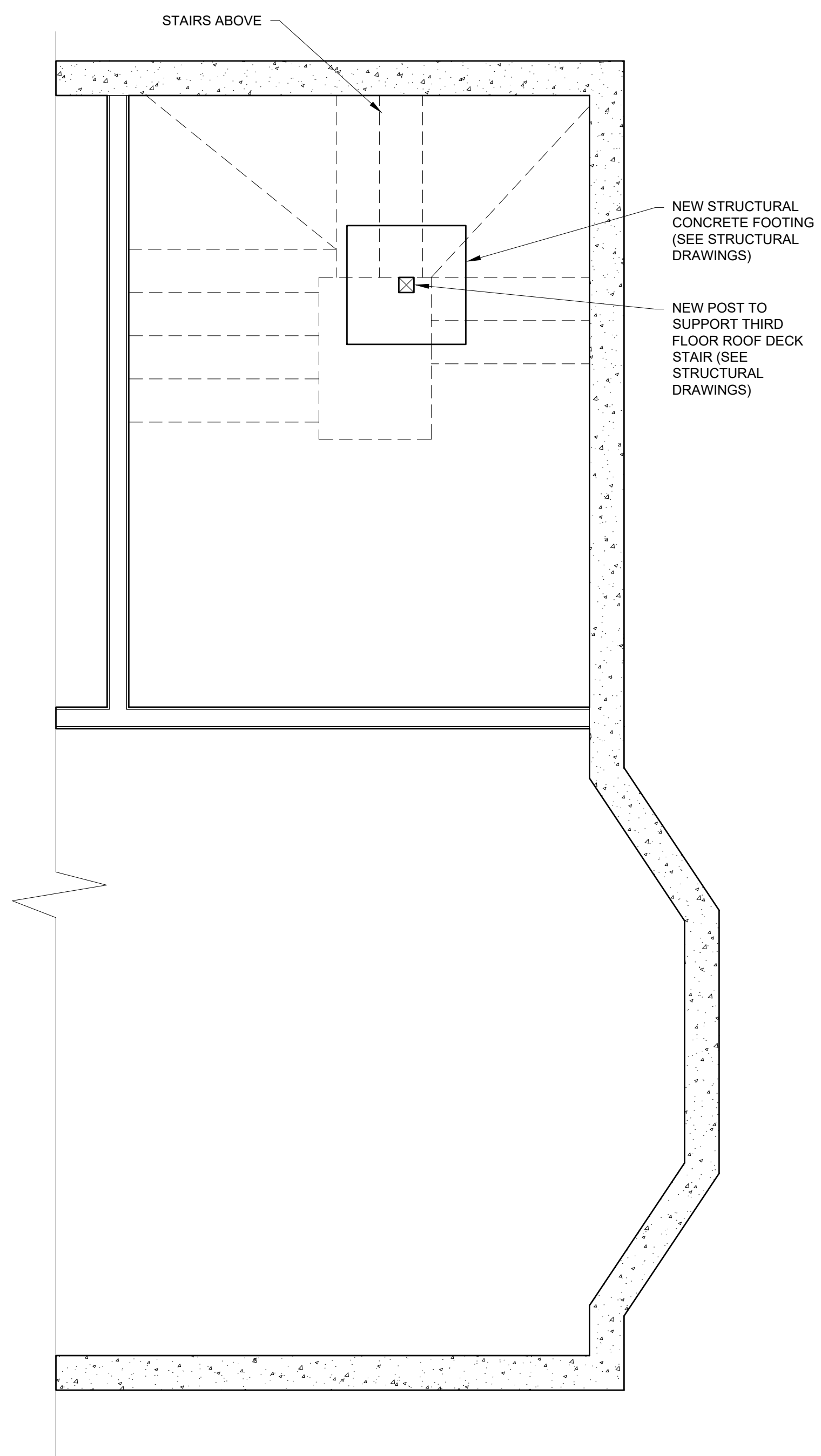

1 BASEMENT PLAN  
1/2" = 1'-0"