



ARCHITECTS
49 DARTMOUTH STREET
PORTLAND, MAINE 04101
207-775-1059
www.pdtarchs.com

COPYRIGHT 2010
PDT Architects
Reuse or reproduction of the contents of this document is not permitted without written permission of PDT Architects.

Adams School Redevelopment
PORTLAND, MAINE

Regina S. Leonard
landscape architecture & design
29 Bridge Street
Topsham, Me 04086
Tel: 207-450-9700
Regina@rslsdesign.com

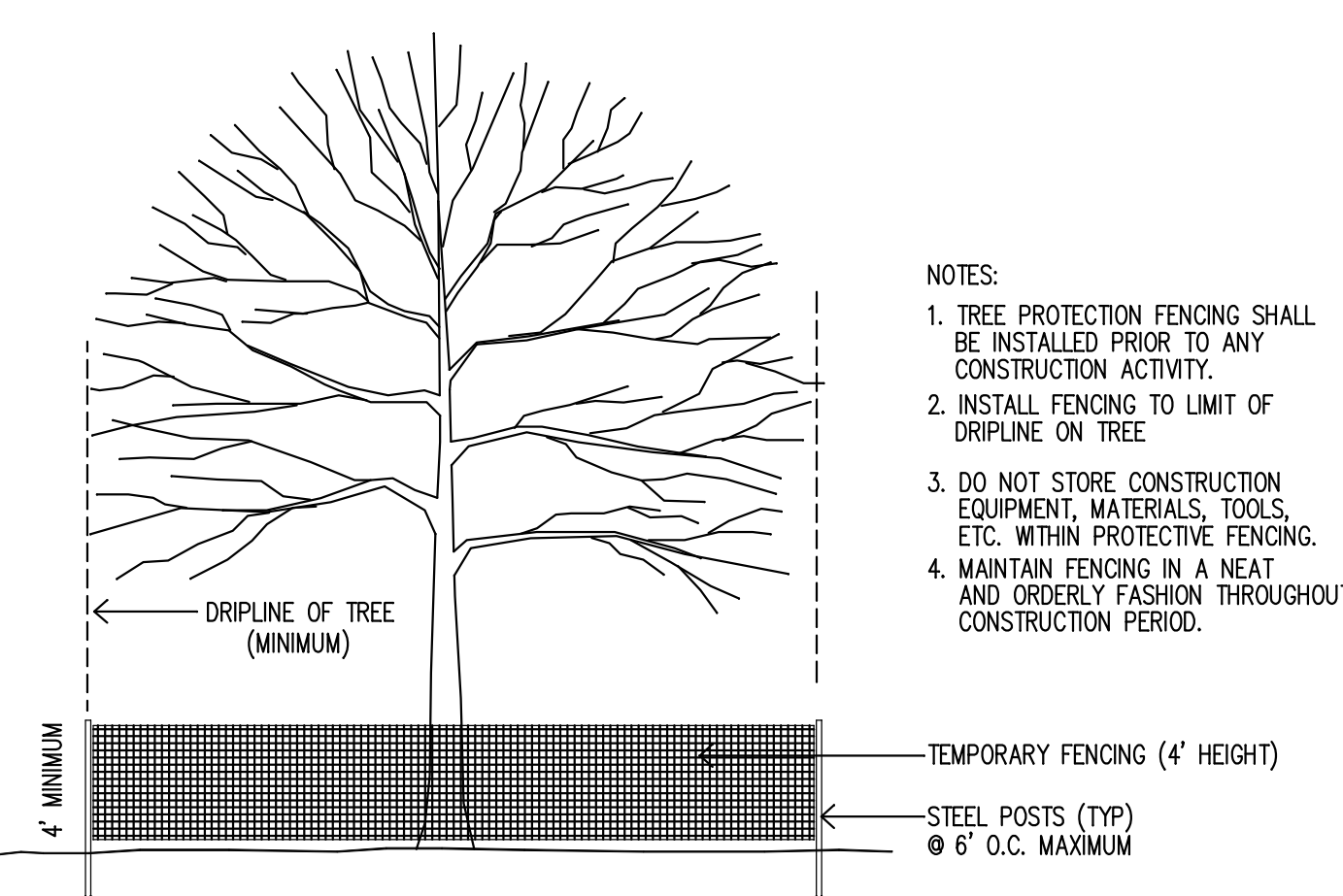
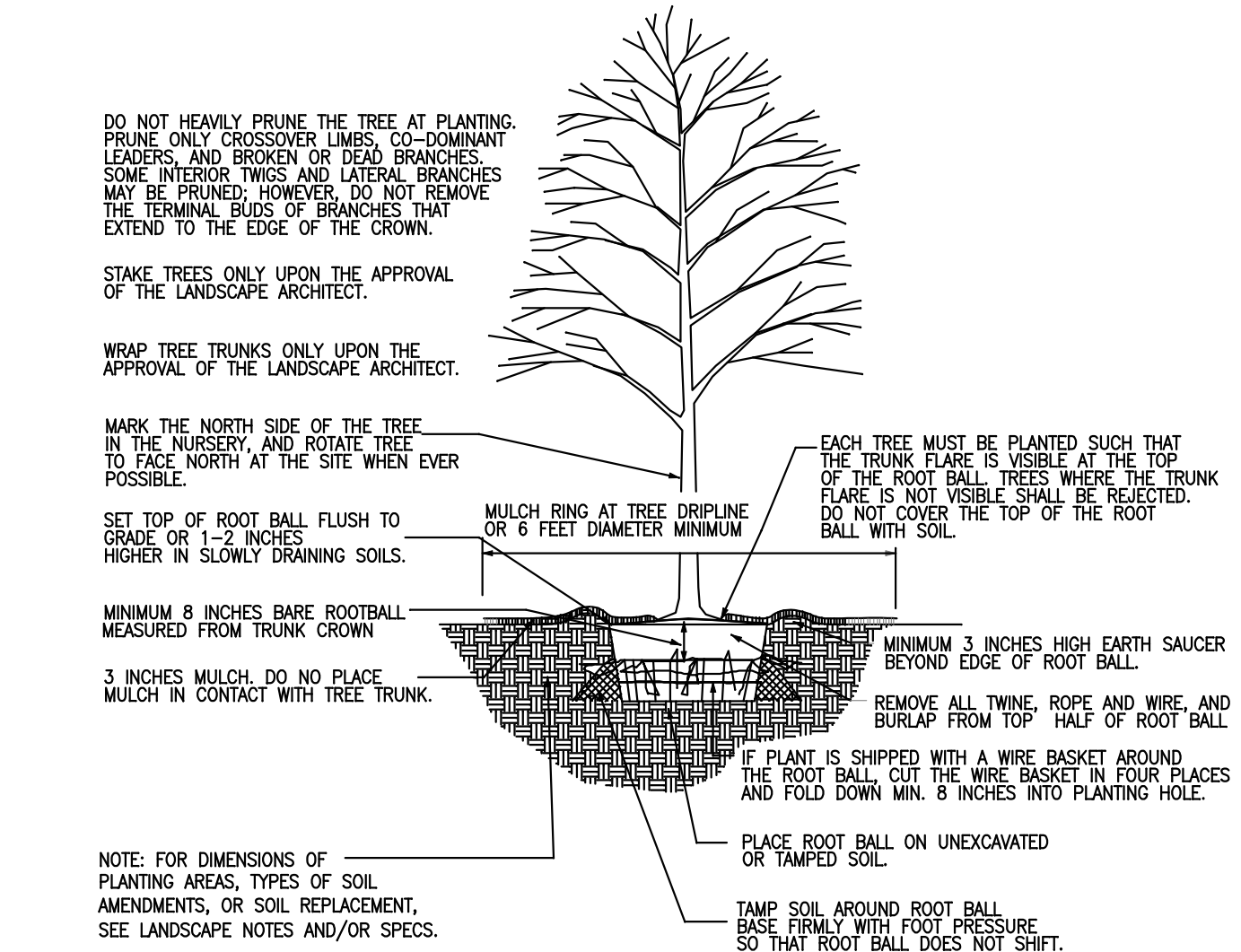
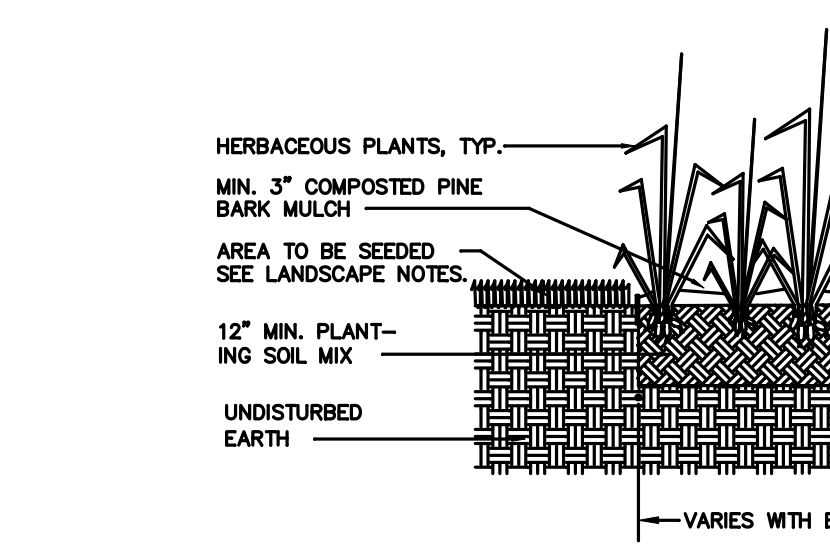
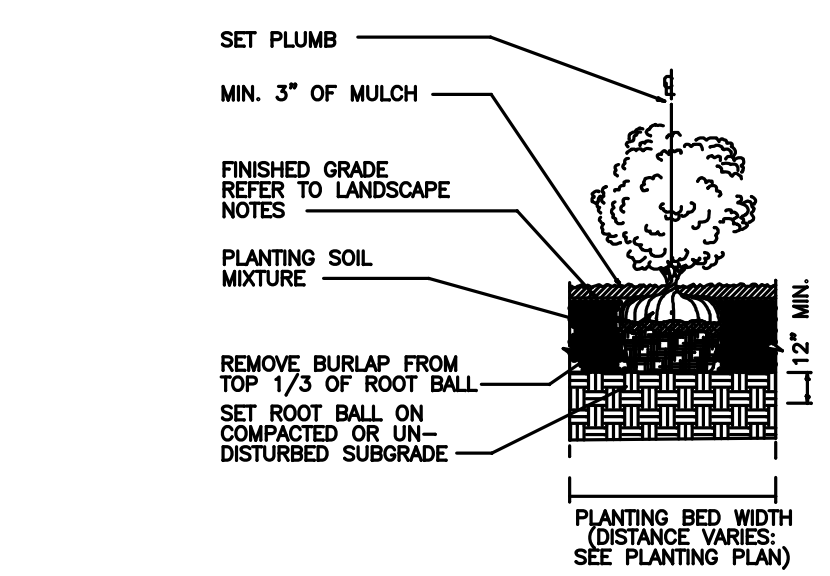
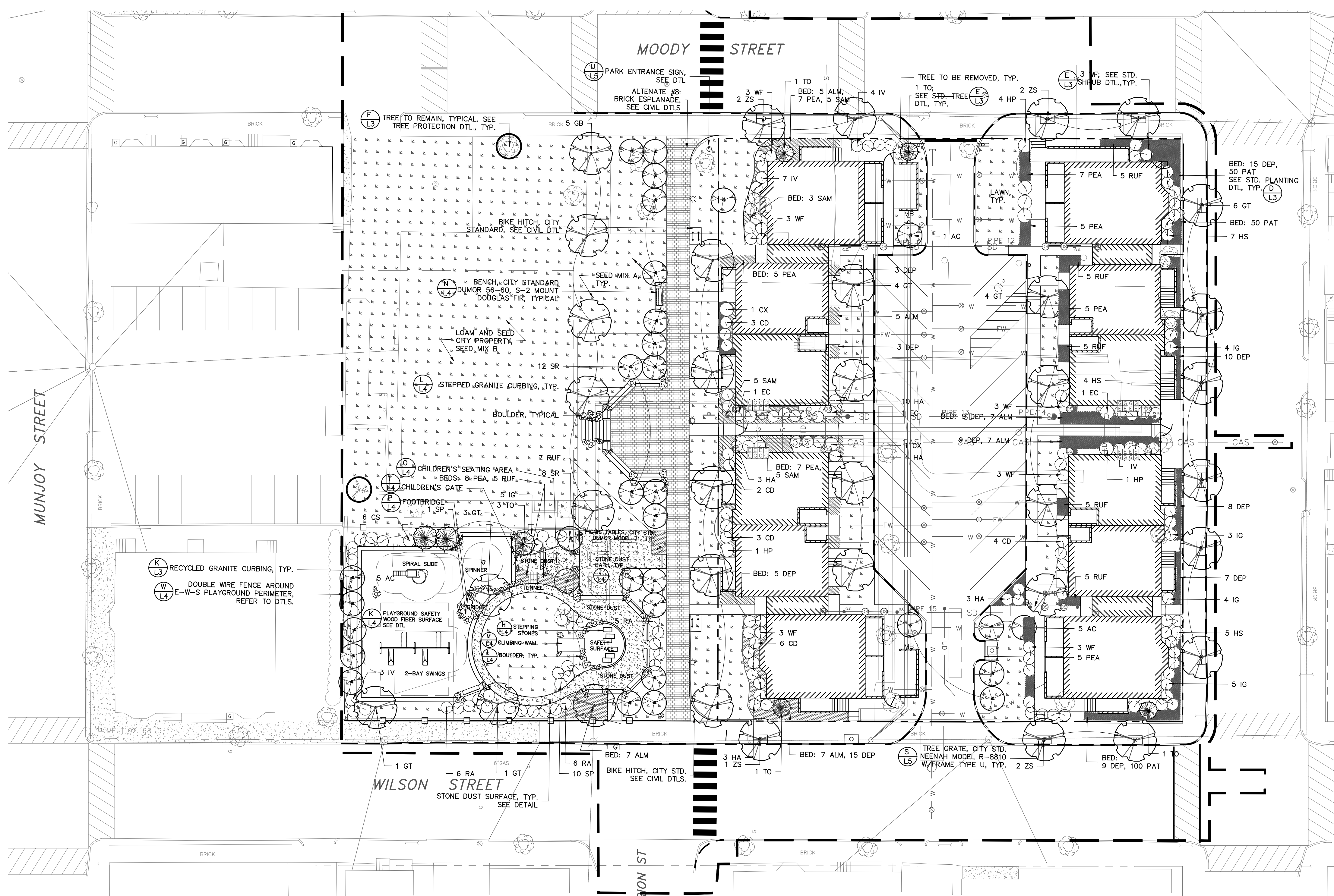

SITE PLANTINGS

SYM. QTY.	BOTANICAL NAME	COMMON NAME	SIZE/COND.
TREES			
AC 3	Amelanchier canadensis	Serviceberry	6'-8' clump
CB 8	Carpinus betulus 'Fastigiata'	European Hornbeam	2.5" cal.
CX 2	Cotinus x. 'Grace'	Grace Smokebush	#7 pot
GT 20	Gleditsia t. var. inermis	Thornless Honey Locust	2.5" cal.
GB 5	Ginkgo b. 'Magyar'	Magyar Ginkgo	2.5" cal.
SR 12	Syringa reticulata 'Ivory Silk'	Japanese Lilac	6'-8' clump
TO 6	Thuja o. 'Douglasii'	Douglas Arborvitae	6'-8' ht.
ZS 7	Zelkova s. 'Wireless'	Wireless Zelkova	2.5" cal.
SHRUBS			
CD 21	Caryopteris 'Dark Knight'	Blue Mist Spirea	#3 pot
CS 6	Cornus sericea 'Farrow'	Red-twig Dogwood	#3 pot
EC 3	Erkianthus campanulatus	Redvein Erkianthus	2.5'-3' ht.
HP 6	Hydrangea 'White Moth'	White Moth Hydrangea	#3 pot
HA 20	Hydrangea arborescens	Smooth Hydrangea	#3 pot
HS 18	Hydrangea a. 'Samantha'	Samantha Hydrangea	#3 pot
IV 14	Itea virginica 'Little Henry'	Sweetspire	#3 pot
IG 16	Ilex glabra 'Compacta'	Dwarf Inkberry	#3 pot
RA 17	Rhus a. 'Gro-Low'	Fragrant Sumac	#3 pot
SP 11	Salix p. 'Nana'	Dwarf Arctic Willow	#3 pot
WF 12	Weigela fl. 'Variegata Nana'	Dwarf Var. Weigela	#3 pot
HERBACEOUS PLANTS			
ALM 38	Alchemilla mollis	Lady's Mantle	2 qt.
DEP 84	Dennstaedtia punctiloba	Hayscented Fern	2 qt.
PAT 200	Pachysandra t. 'Green Sheen'	Pachysandra	100/flat
PEA 44	Pennisetum al. 'Hameln'	Dwarf Fountain Grass	2 qt.
RUF 32	Rudbeckia f. 'Goldsturm'	Black-eyed Susan	2 qt.
SAM 18	Salvia v. 'May Night'	May Night Salvia	2 qt.

SEED MIXES

A Yardscaping Mix : Supplier: Allen, Sterling & Lothrop, Falmouth, ME Tel. 207-781-4142
Application Rate: 1 lb/200 sq. ft.

B New England Wildlife/Conservation Mix:
Supplier: NE Wetland Plants, Inc.; Amherst, MA Tel. 413-548-8000
Application Rate: 1 lb/1750 sq.ft. (spring)

- Planting Notes**
- All materials shall conform to the guidelines established by the American Association of Nurserymen.
 - In the case of any discrepancies between species and quantities called out in the planting key and those shown on the plan, quantities and species shown on the plan shall over-ride.
 - All planting shall be done in accordance with acceptable horticultural practices.
 - All plants subject to approval by landscape architect. All substitutions must be submitted for approval by landscape architect prior to ordering or delivery of plant material on site. Landscape architect reserves the right to reject any plantings that do not conform to the drawings or specifications outlined herein.
 - Landscape Architect shall approve final placement of all plant materials and reserves the right to make field adjustments to plantings as necessary.
 - Existing trees to remain shall be protected at the drip-line and as shown in the Tree Protection Detail to prevent damage and compaction of the root system. No grading, soil disturbance, or storage of materials or equipment shall occur within the drip-line unless otherwise shown on plans. Any excavation within such areas shall be performed with special care to avoid damage of the root system, trunk or branches. In case of consequential damage to any trees designated to remain, the contractor shall assume full responsibility for replacement in-kind or payment of financial restitution, as determined most appropriate by the City's representative.
 - Planting pits shall consist of 3 parts fertile, friable loam amended with 1 part organic compost: Earthlife by New England Organics, Falmouth, ME, tel. 207-781-5011, or approved equal.
 - Finish grade of plantings shall match adjacent finish grades unless otherwise noted on drawings or directed and/or approved by the landscape architect.
 - No plant shall be put into the ground before rough grading has been finished and approved by the landscape architect or owner's representative.
 - All plants shall be set plumb unless otherwise specified.
 - All plantings shall be topped with a minimum of 3" of surface mulch. See written specifications.
 - All disturbed areas not otherwise planted shall be seeded as follows: Areas to remain lawn, as noted on the plan, shall receive "Seed Mix A" as noted in the Site Plantings Key.
 - Contractor shall water all plants thoroughly twice during the first 24-hour period after planting. All plants and newly grassed areas shall be watered as required thereafter to ensure survival and growth through the first growing season.
 - Plant material shall be guaranteed by the contractor for a period of one year from the date of installation. During the one year guarantee, the contractor shall replace, in kind, any dead, diseased, or substandard plant material at no cost to the owner. The contractor shall receive final acceptance from the owner following the one year guarantee, provided the provisions of the plant guarantee have been satisfactorily met.
 - The Contractor shall assume responsibility to ensure that all work is performed in compliance with all State and Local requirements.

FOR BIDDING - NOT FOR CONSTRUCTION

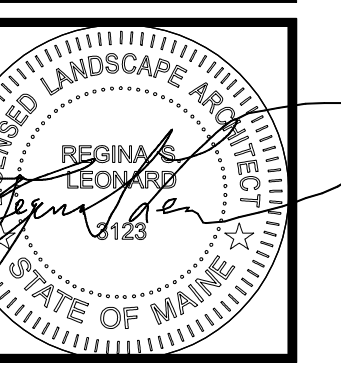

JOB NO. 08-056

DRWN. CHK RSL PDT

SCALE: 1"=20'

ISSUE 3/05/12

TITLE LANDSCAPE PLAN

SHEET

L3