



ARCHITECTS

49 DARTMOUTH STREET
PORTLAND, MAINE 04101
207-775-1059
www.pdtarchts.com

COPYRIGHT 2011
PDT Architects

Reuse or reproduction of the
contents of this document is not
permitted without written
permission of PDT Architects.



**BENNETT
ENGINEERING**
MECHANICAL • ELECTRICAL
(207) 865-9475

NOTE:
Buildings B, C & D are similar to Building A, refer
to Architectural drawings for more information.

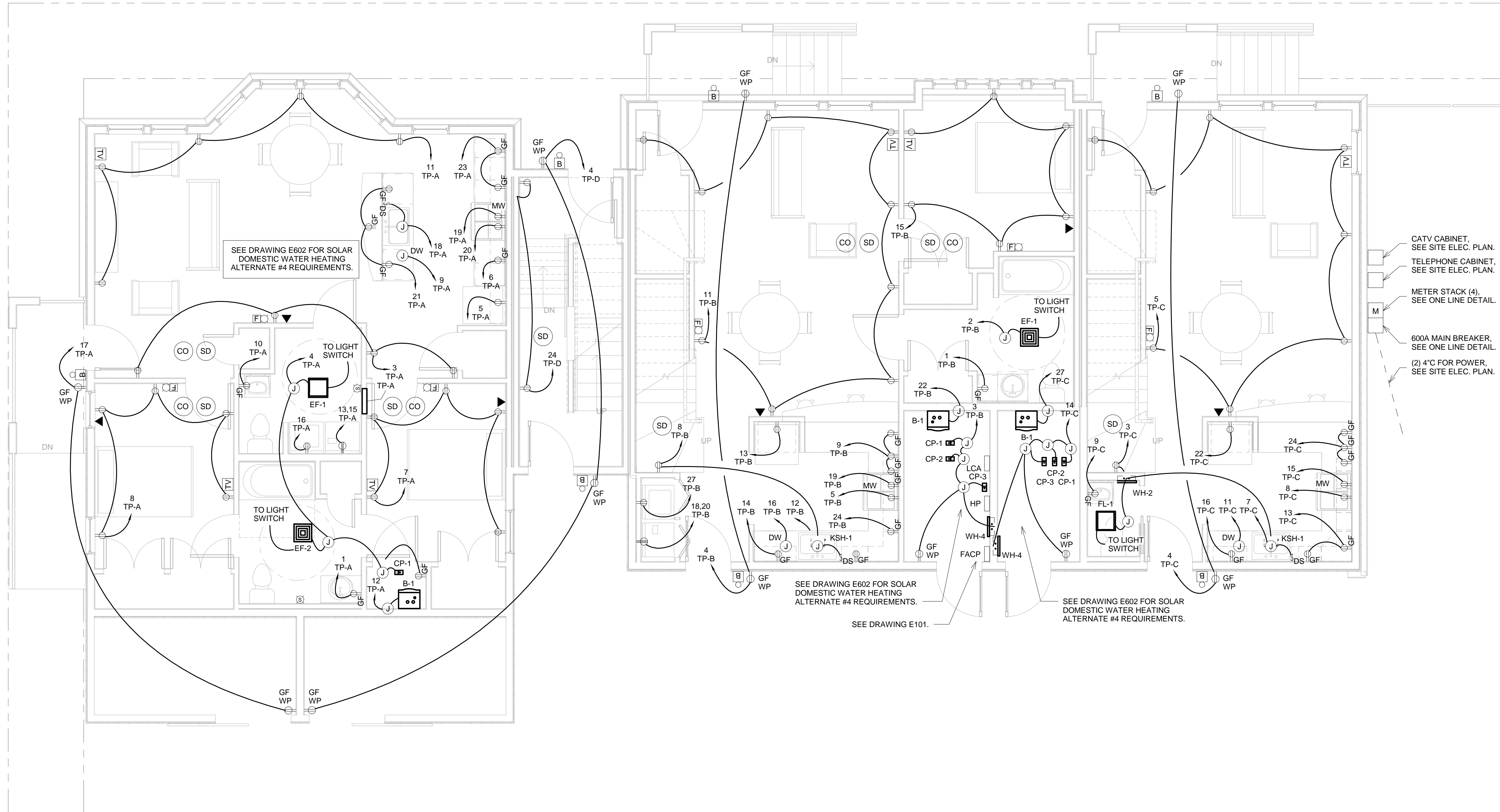

- CATV CABINET, SEE SITE ELEC. PLAN.
- TELEPHONE CABINET, SEE SITE ELEC. PLAN.
- METER STACK (4), SEE ONE LINE DETAIL.
- 600A MAIN BREAKER, SEE ONE LINE DETAIL.
- (2) 4" FOR POWER, SEE SITE ELEC. PLAN.

1 Bldg A 1st Flr Power Plan
1/4" = 1'-0"

ADAMS SCHOOL REDEVELOPMENT
Portland, ME

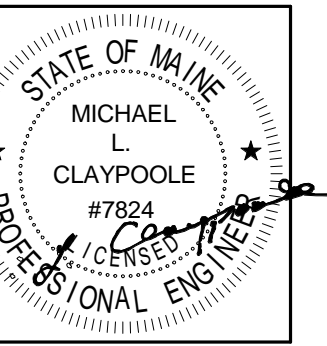

JOB NO.
08-056

DRWN. CHK
SMR WSBJR

SCALE:
1/4" = 1'-0"

ISSUE
5 MARCH 2012

TITLE
Bldg A First Floor
Power Plan

SHEET
E301