

5

4

3

2

1

D

C

B

A



49 DARTMOUTH STREET  
PORTLAND, MAINE 04101  
207-775-1059  
www.pdtarch.com

COPYRIGHT 2012  
PDT Architects  
Reuse or reproduction of  
the contents of this document is not  
permitted without written  
permission of PDT Architects.

ADAMS SCHOOL REDEVELOPMENT  
Portland, Maine

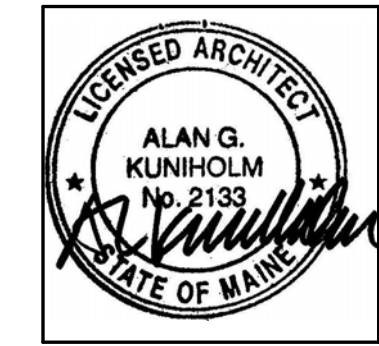

JOB NO.  
08-056

DRWN. CHK  
Checker

SCALE:  
As indicated

ISSUE  
5 MARCH 2012

TITLE  
STAIR DETAILS

SHEET

A504

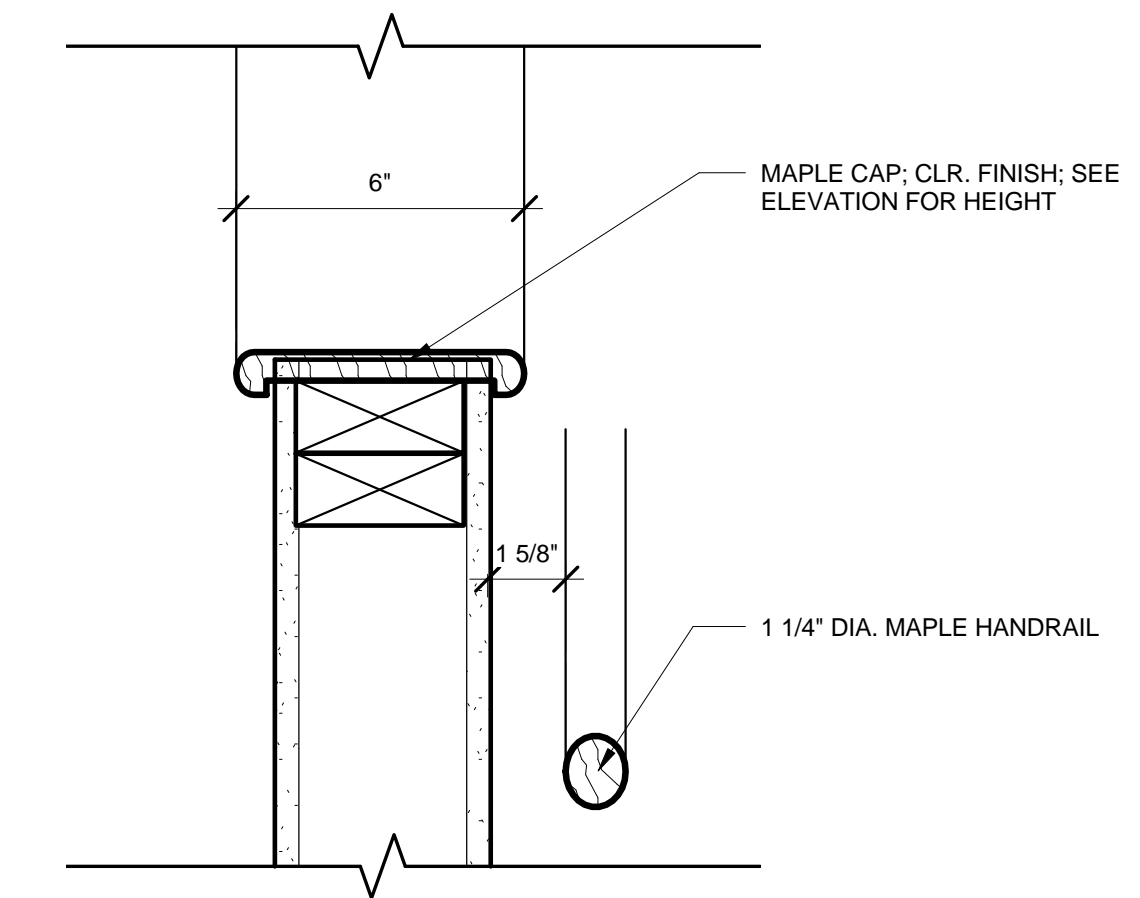

D2 PARTIAL HEIGHT WALL CAP  
3" = 1'-0"

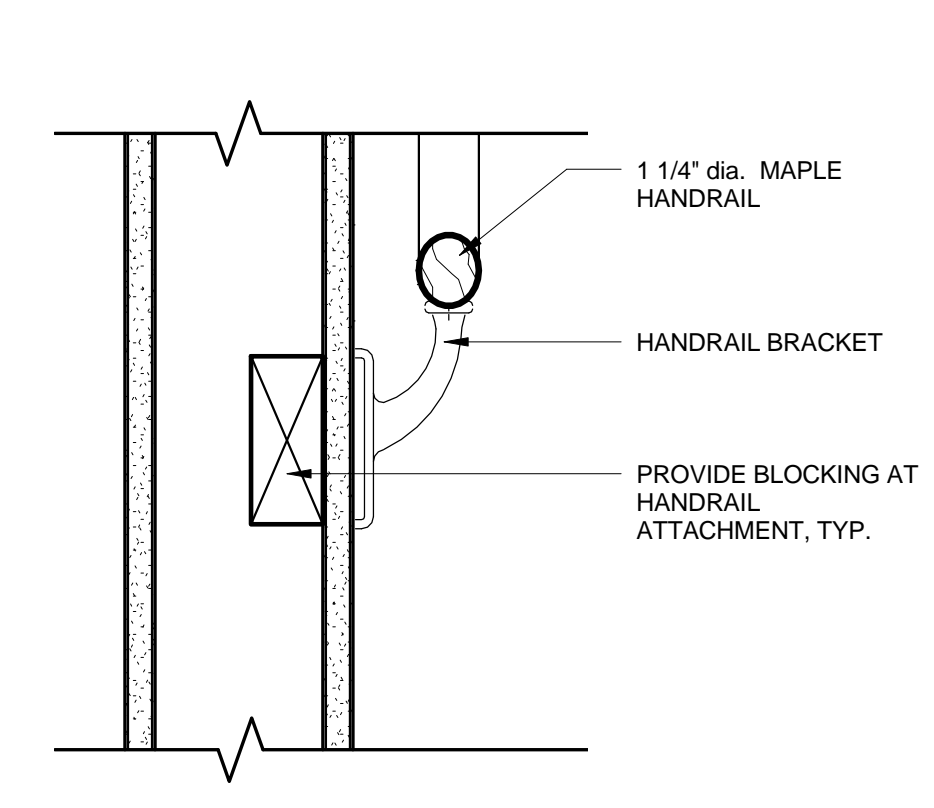

D1 WOOD HANDRAIL DETAIL  
3" = 1'-0"

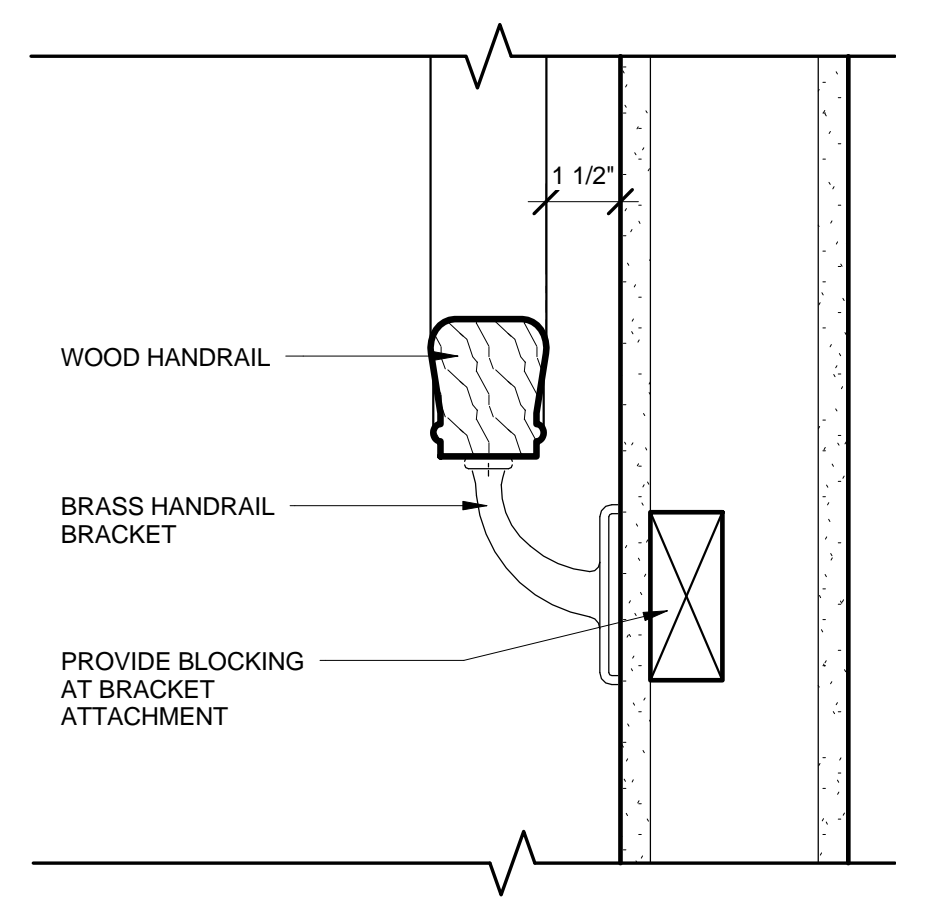

C2 HANDRAIL @ WALL DETAIL  
3" = 1'-0"

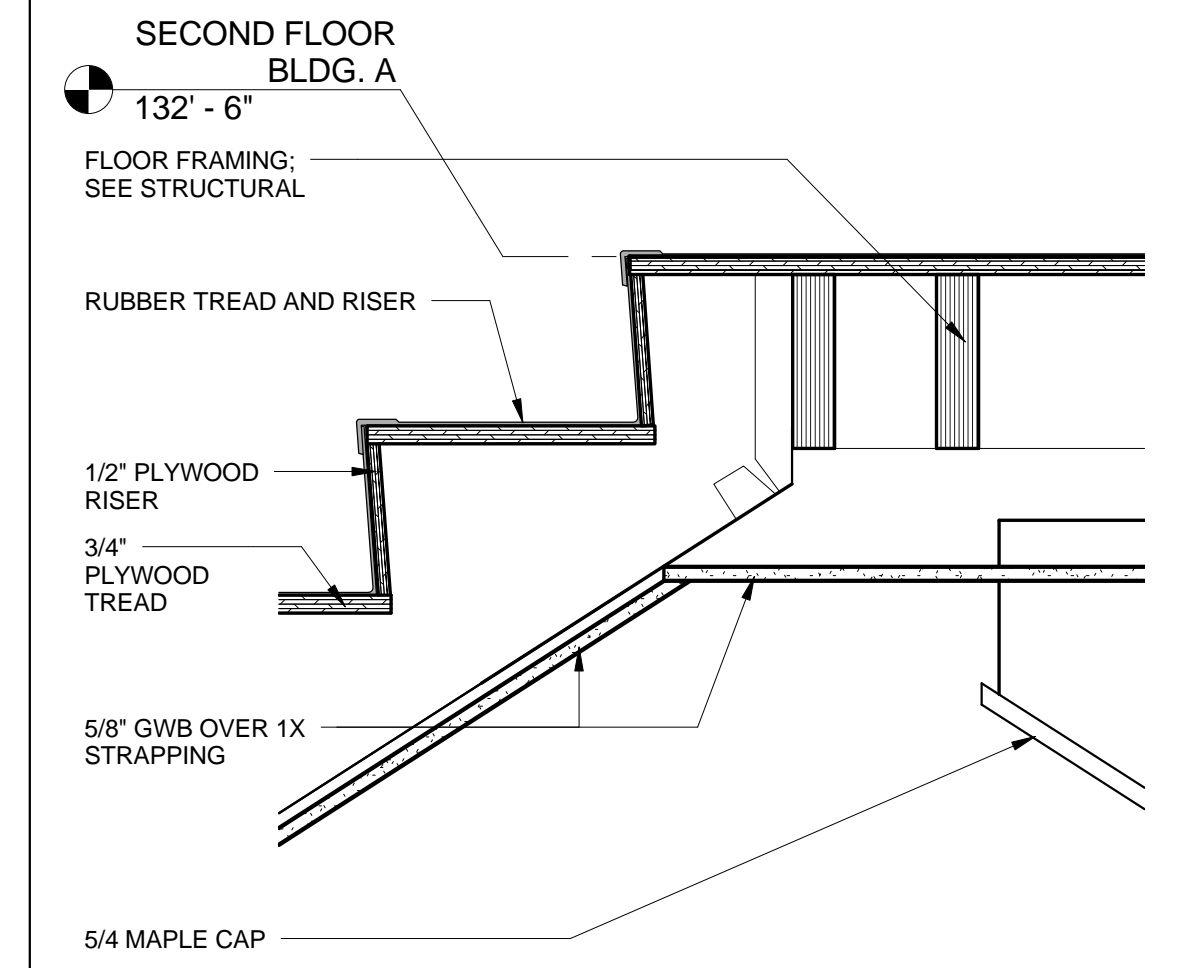

C1 TOP OF STAIR DETAIL  
1 1/2" = 1'-0"

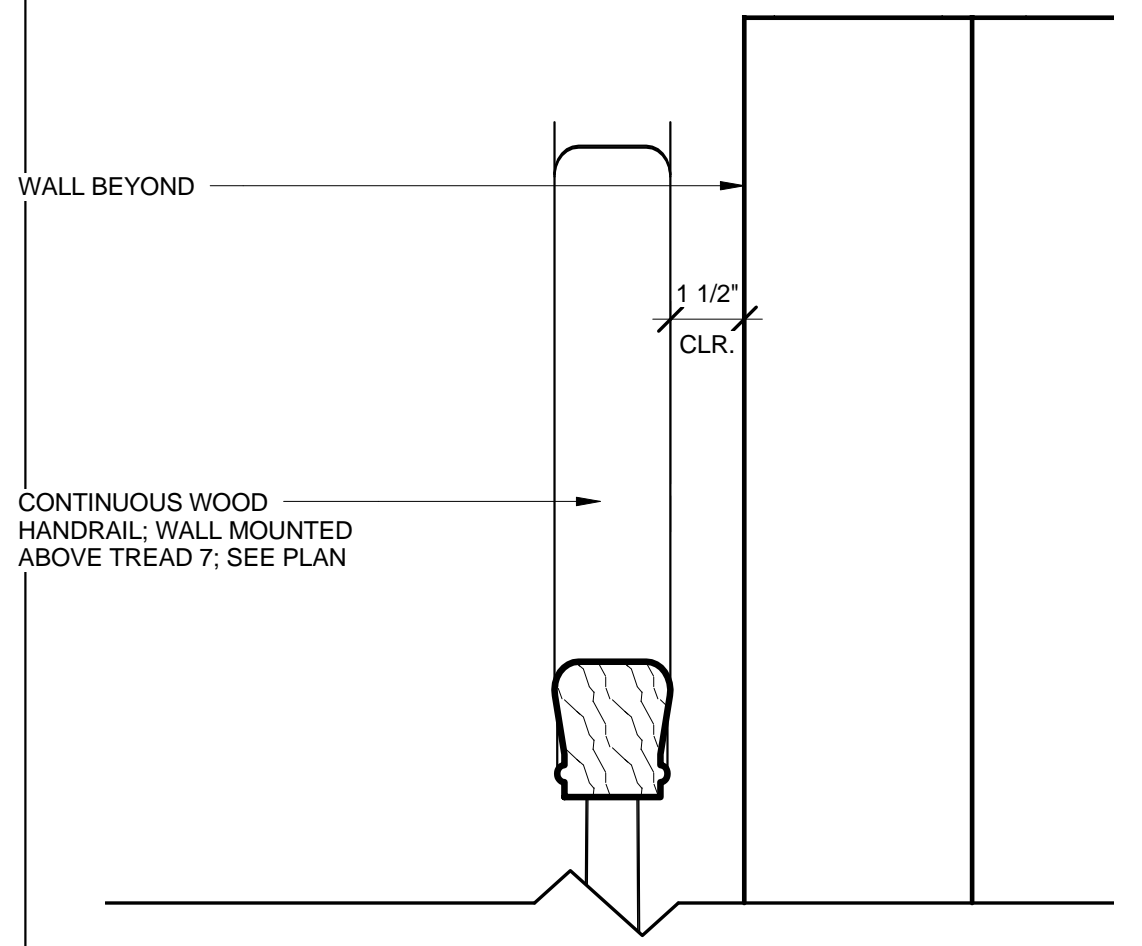

B2 WOOD TREAD DETAIL  
3" = 1'-0"

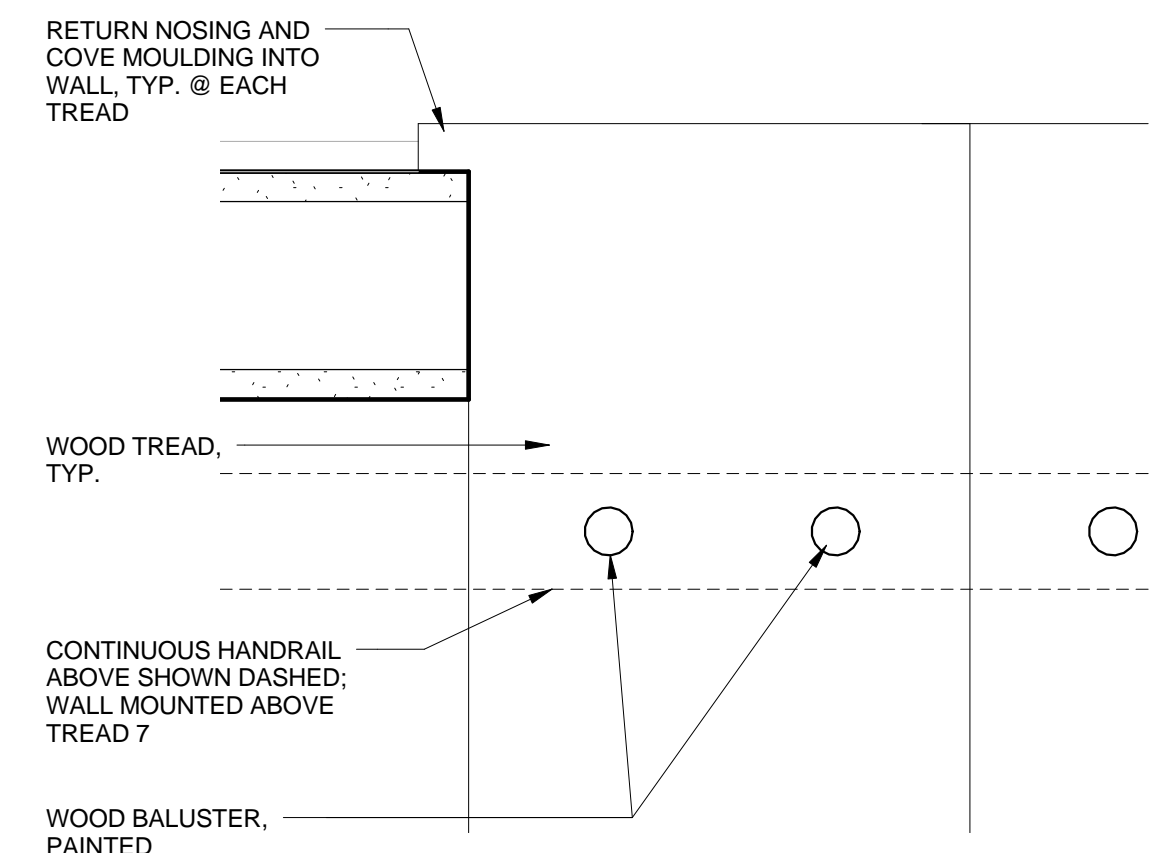

B1 STAIR DETAIL AT MID-LANDING  
1 1/2" = 1'-0"

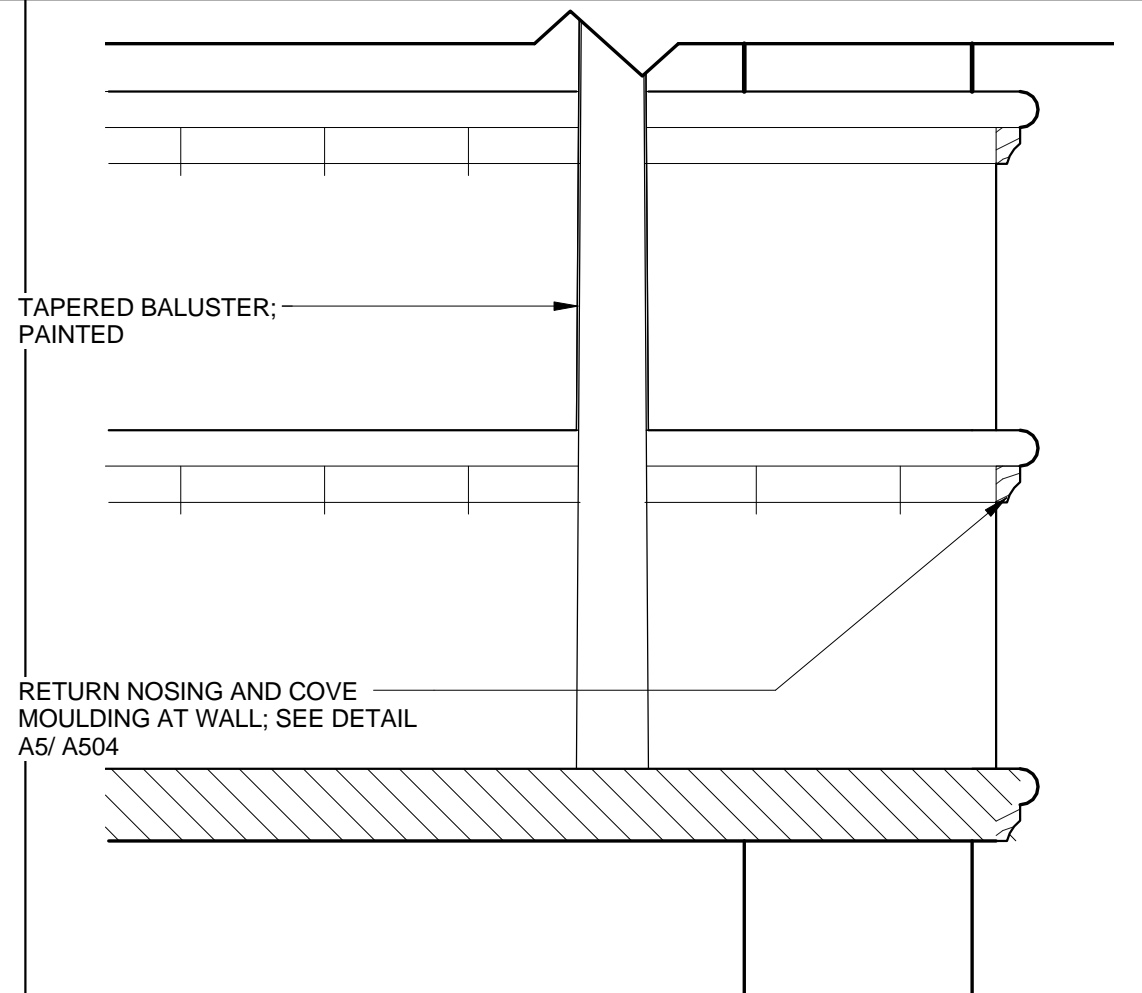

A3 HANDRAIL W/ BALUSTER DETAIL  
3" = 1'-0"

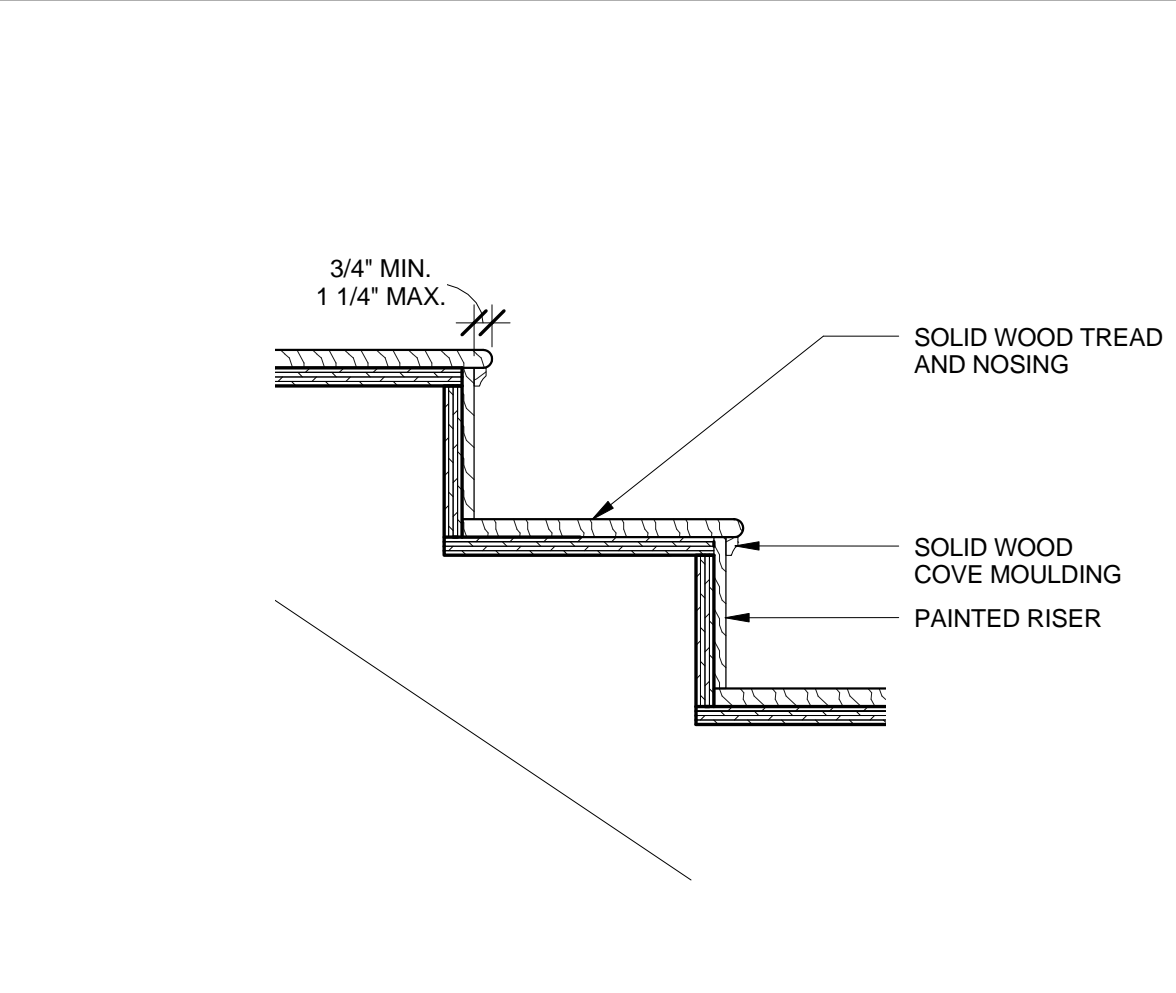

A2 WOOD STAIR DETAIL  
1 1/2" = 1'-0"

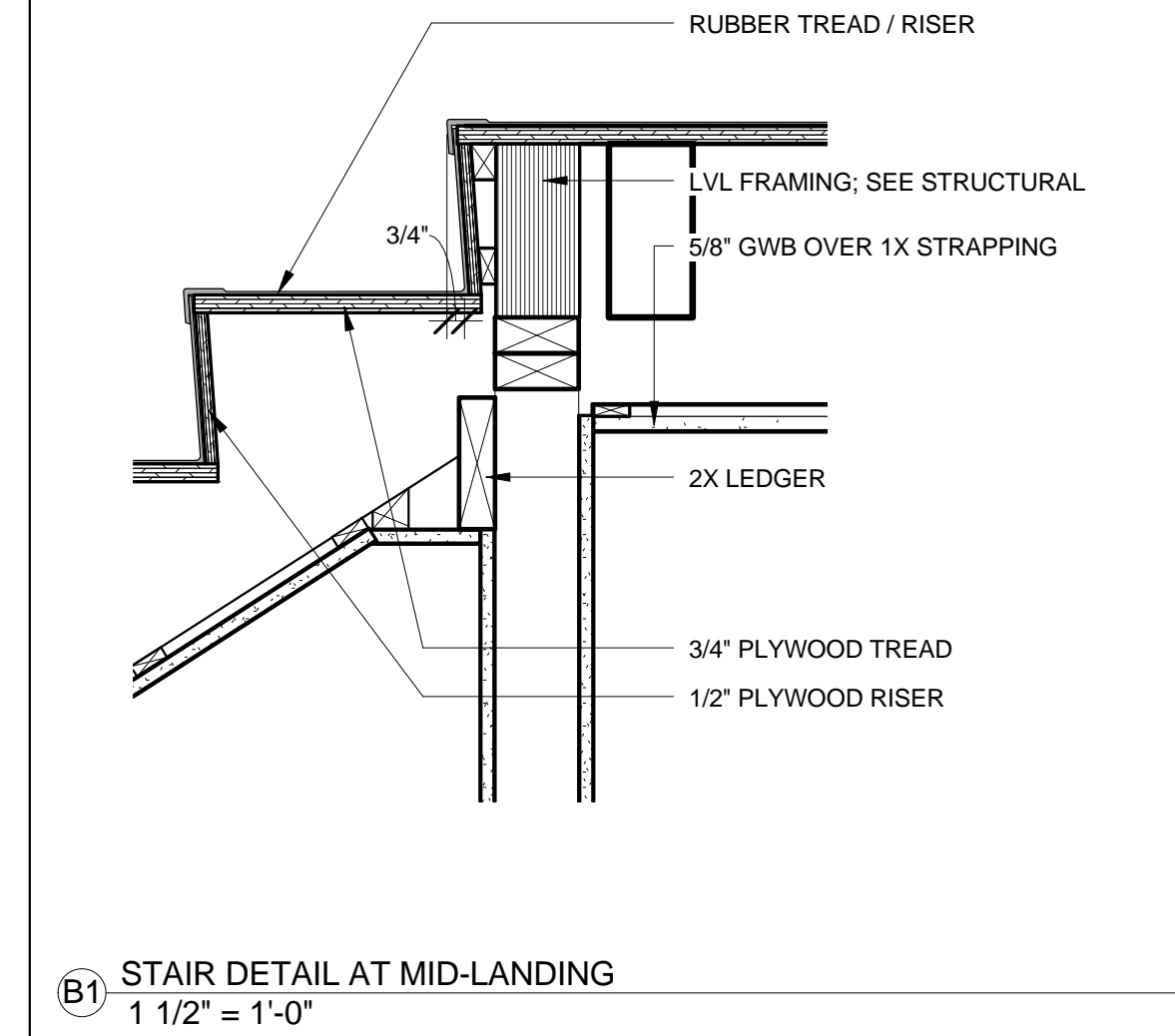

B1 STAIR DETAIL AT MID-LANDING  
1 1/2" = 1'-0"

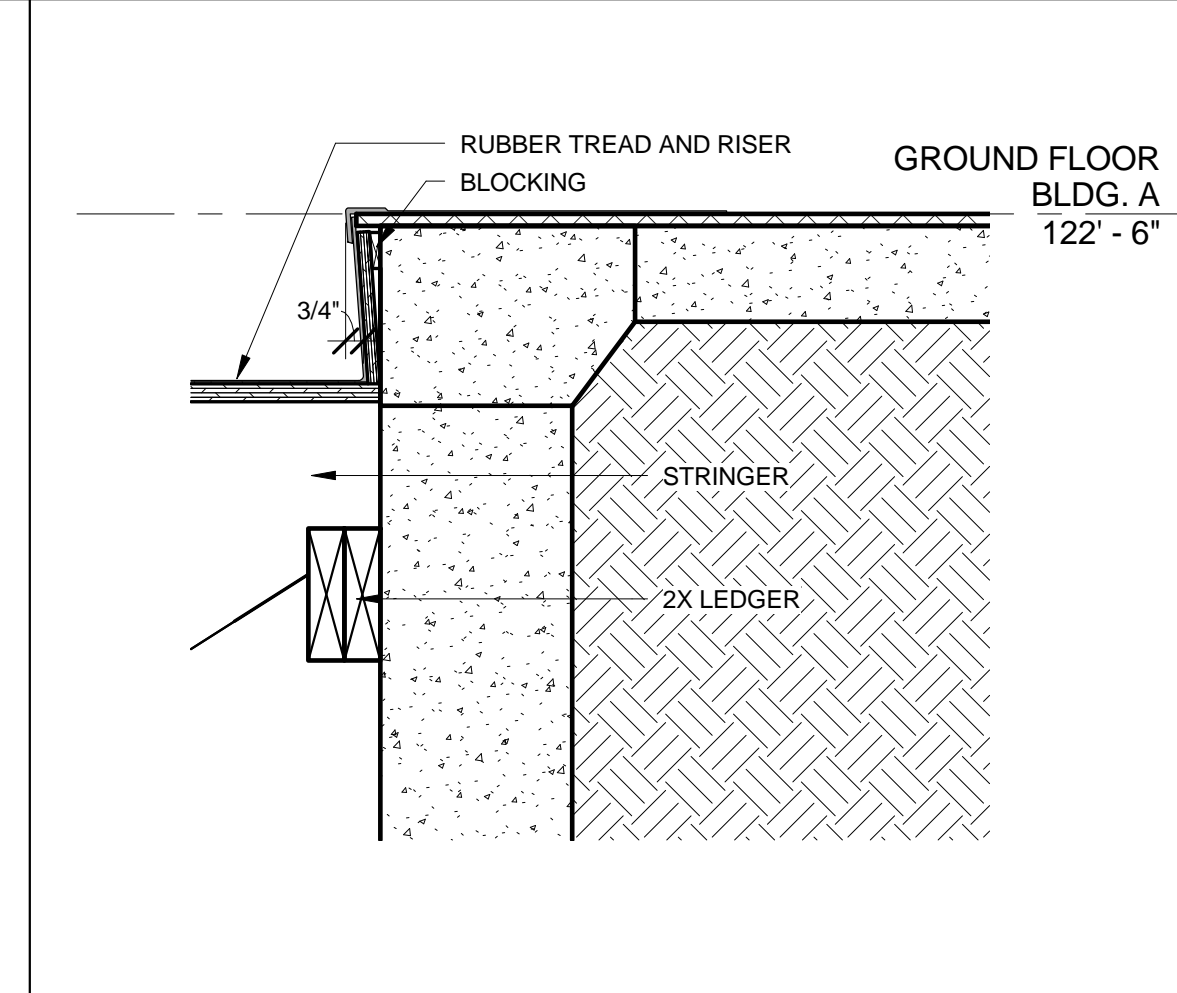

A1 STAIR @ CONCRETE SLAB  
1 1/2" = 1'-0"

5

4

3

2

1