

GORHAM FENCE COMPANY, INC.
STANDISH, MAINE 04084

36 EMERY ROAD
(207) 642-3467 FAX (207) 642-6534
info@gorhamfence.com

PROPOSAL/CONTRACT

Page 1
06/02/2017

Customer Information:

DEXTER HOLT
80 VESPER ST UNIT #1
PORTLAND, MAINE 04101

Job Information:

508-308-9788
DEXTERHOLT@GMAIL.COM

Notes:

FURNISH & INSTALL THE FOLLOWING CERTAINTeed BUFFTECH WHITE VINYL PRIVACY FENCE - ALL TO HAVE CERTAGRAIN TEXTURE:
1 - 6'H X 5'W DOUBLE SWING GATE
1 - 6'H X 6'W DOUBLE SWING GATE OF CHESTERFIELD STYLE WITH 5" X 5" POSTS AND NEW ENGLAND STYLE POST CAPS.
12' OF 8'HIGH GALVESTON STYLE WITH LATTICE ACCENT (6'8" PLUS 1'4" ACCENT) AND 5" X 5" POSTS WITH NEW ENGLAND STYLE POST CAPS.
ALL POSTS TO HAVE ALUMINUM STIFFENERS INSIDE.

IF INTERESTED PLEASE SIGN AND RETURN ONE COPY OF THIS CONTRACT WITH A 50% DEPOSIT TO SCHEDULE WORK. RIGHT NOW WE ARE ABOUT 8-10 WEEKS OUT FOR INSTALLATION.

GORHAM FENCE COMPANY, INC. agrees to guarantee above fence to be free from defects in materials and workmanship for one year. All work to be completed in a workmanlike manner according to standard practices. Our workers are fully covered by Workmen's Compensation Insurance.

Responsibility for complying with local zoning regulations and obtaining any required permits shall rest with the customer. GORHAM FENCE COMPANY, INC. will assist the customer, upon request, in determining where the fence is to be erected, but under no circumstance does GORHAM FENCE COMPANY, INC. assume any responsibility concerning property lines or in any way guarantee their accuracy. If property pins cannot be located it is recommended that the customer have the property surveyed.

GORHAM FENCE COMPANY, INC. assumes no responsibility for any damage to underground pipes, power lines, etc. in the process of installing posts, if the company is not notified of the existence and location of same.

The final billing will be based on the actual footage of fencing built and the work performed. Additional charges for any extra work not covered in this contract that was requested by the customer will also be added. The full amount of this

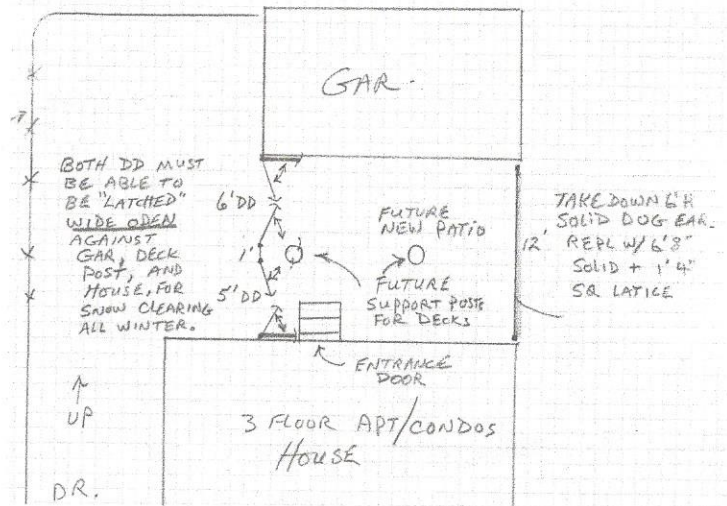

contract along with any additional charges will become payable upon completion.

A finance charge of 1 1/2% per month (or a minimum of \$1.00), which is an annual percentage rate of 18%, shall be applied to accounts that are not paid within 30 days after completion of any work invoiced. All materials will remain the property of GORHAM FENCE COMPANY, INC. until all invoices pertaining to this job are paid in full. Right of access and removal is granted to GORHAM FENCE COMPANY, INC. in the event of non-payment under the terms of this contract. The customer agrees to pay all interest and any costs incurred in the collection of this debt.

Approved & Accepted for Customer:

Contract Amount: \$ 6680.00
Down Payment: \$ _____
Balance Due: \$ 6680.00

_____	_____
Customer	Date
Accepted for GORHAM FENCE COMPANY, INC.:	
<i>Ceslee Currier</i>	06-02-17
_____	_____
Salesperson	Date