

ALL DRAWINGS, PLANS, SKETCHES ETC. ARE PROVIDED TO OUR CLIENTS BASED UPON INFORMATION PROVIDED BY THE CLIENT AND DRAWN IN ACCORDANCE WITH COMMON BUILDING PRACTICES. NONE OF THE EMPLOYEES OF MORIN DRAFTING ARE REGISTERED ARCHITECTS, STRUCTURAL ENGINEERS OR LAND SURVEYORS. CODES SHALL BE REVIEWED AND APPROVED BY APPROPRIATE REGISTERED PROFESSIONALS, IF NOT, SHALL BE RESPONSIBILITY OF CONTRACTOR OR OWNER. ALL NOTING, SPECIFICATION AND DIMENSIONS SHALL BE REVIEWED BY CLIENT/CONTRACTOR BEFORE WORK BEGINS, ALL OMISSIONS SHALL BE BROUGHT TO THE ATTENTION OF MORIN DRAFTING. IF PLANS ARE NOT VERIFIED BY CLIENT AND/OR CONTRACTOR BEFORE CONSTRUCTION BEGINS MORIN DRAFTING SHALL BE HELD HARMLESS. IN ALL EVENTS DAMAGES SHALL BE LIMITED TO THE COST OF THE PLANS. MORIN DRAFTING ASSUMES NO LIABILITY FOR CONSTRUCTION DEFECTS, CHANGES AND/OR REVISIONS TO PLANS.

NOTE:

1. ALL WINDOWS OTHER THAN NEW WINDOWS SHALL BE REPLACEMENT TYPE WINDOWS SIZED TO MATCH EXISTING OPENINGS.
2. ALL EXISTING WINDOW OPENING DIMENSIONS SHALL BE VERIFIED IN THE FIELD AND REVIEWED AND VERIFIED WITH OWNER BEFORE ORDERING.
3. ALL LIVING SPACE IS FULLY SPRINKLER.
4. KEY PLAN

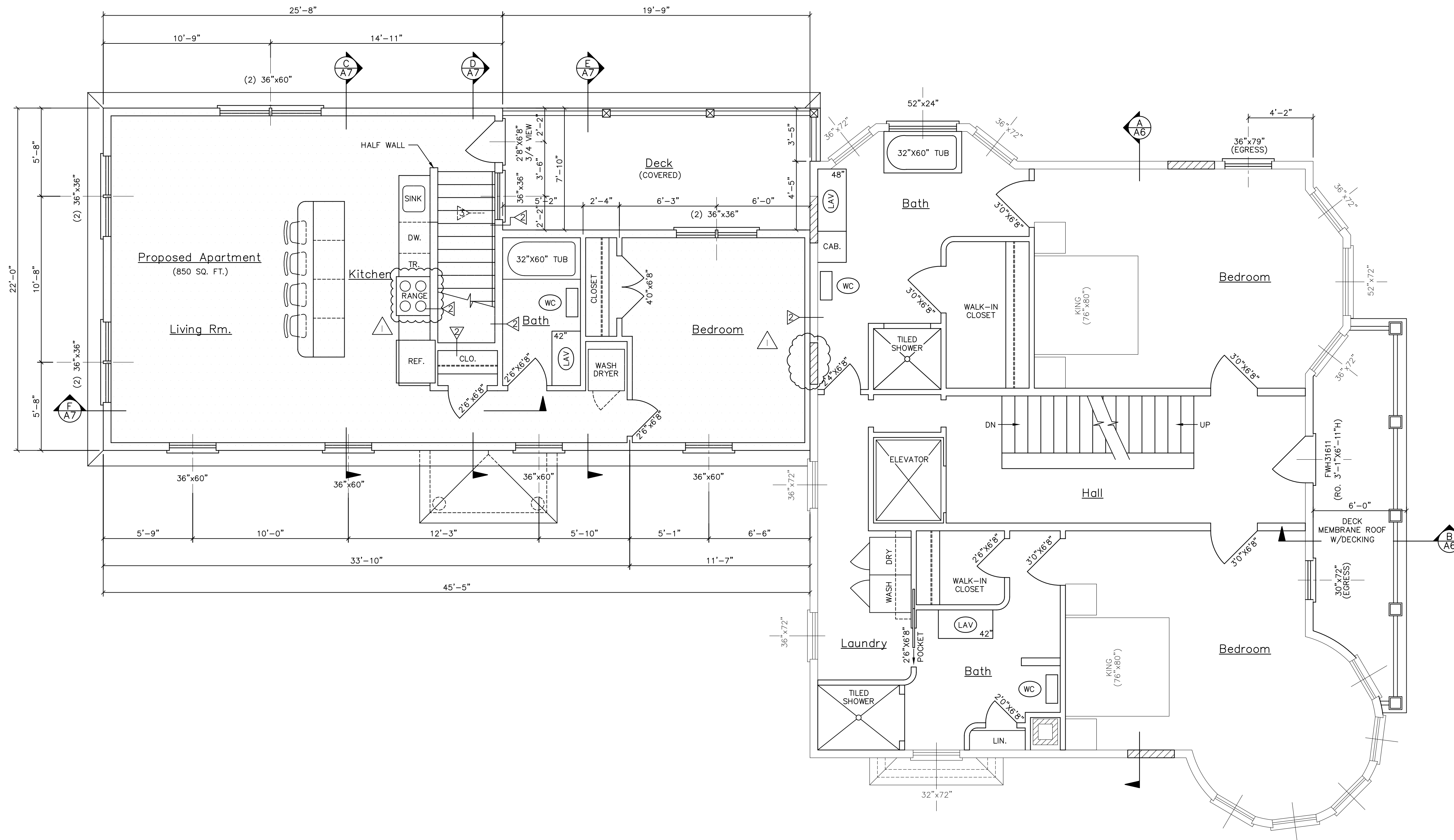
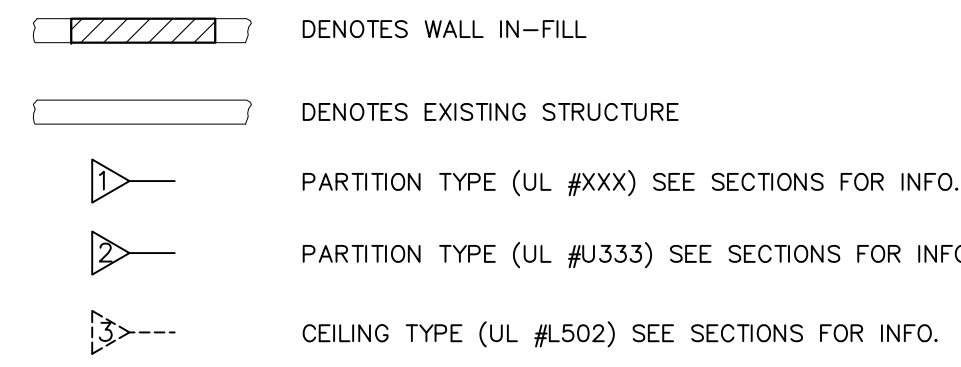

FLOOR PLAN—SECOND FLOOR

REVISED 03-30-2015

REV. 1 REMOVED ACCESS DOOR, INFILLED W/STUDS, INSULATION & GYPSUM BD. ADDED STOVE

54 EASTERN PROMENADE PORTLAND, MAINE	
MORIN DRAFTING GORHAM, ME. 318-1177	
RENOVATION	
FLOOR PLAN—SECOND FLOOR	
DRAWN: J. MORIN	A4
SCALE: 1/4"=1'-0"	
DATE: 06-12-2011	
PLAN NO:	