

EXISTING FOUNDATION
SCALE: 1/4"=1'-0"

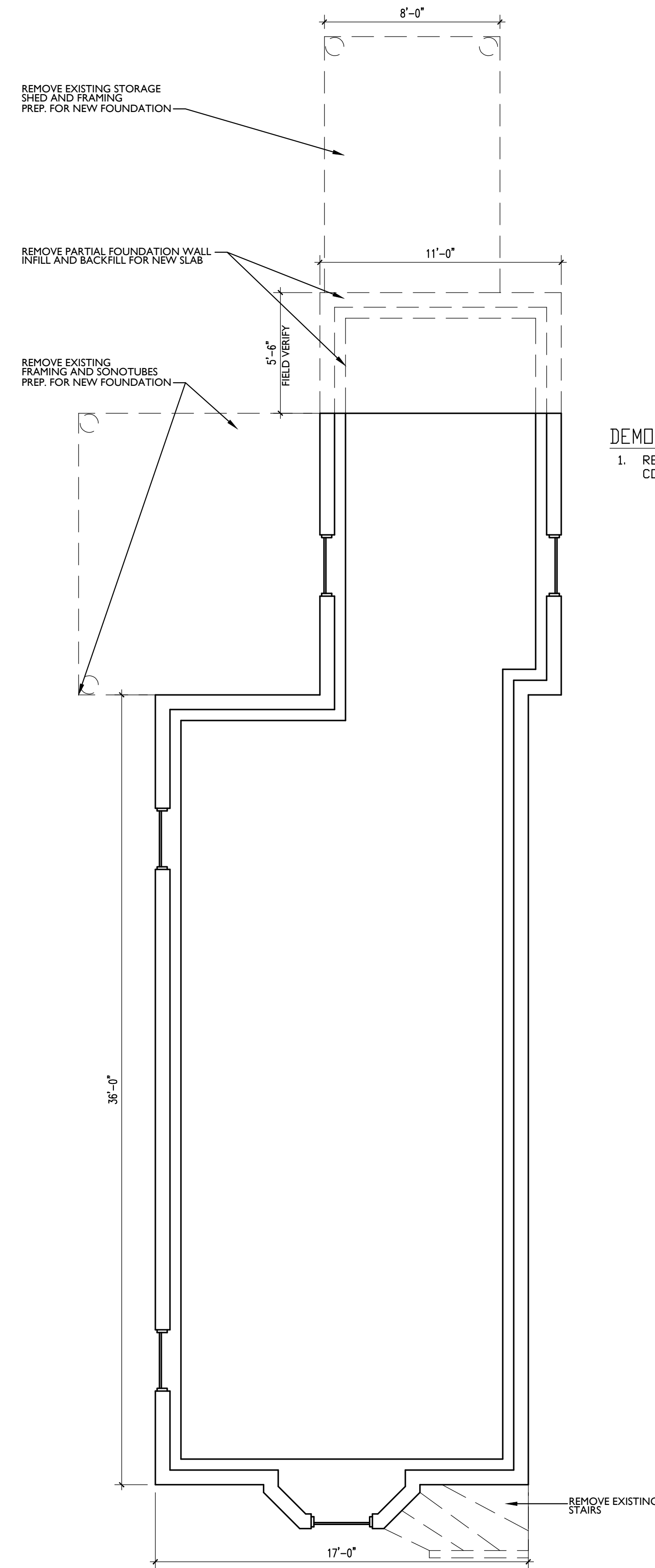

DEMOLITION PLAN
SCALE: 1/4"=1'-0"

DEMOLITION NOTES:

1. REMOVE STRUCTURE IN IT'S ENTIRETY - COORDINATE WITH OWNER ANY ITEMS TO BE SALVAGED.

NAPPI RESIDENCE
16 MORNING STREET
PORTLAND, MAINE

REVISIONS	REMOVED FROM GARAGE
DLP 1	05-16-17
CHECKED BY:	DLP
DATE:	10-05-16
ISSUED:	

EXISTING FOUNDATION PLAN
DEMOLITION PLAN/NOTES

EX1
SCALE: AS NOTED