

Window Notes	
1.	Verify jamb extension requirement with building sections and field conditions and coordinated by GC
2.	Provide integral exterior window trim and sill, color to match windows.
3.	Provide insect screens at all operable units UNO.
4.	Provide Tri glazed, Low E insulating glass with Argon UNO
5.	Refer to window elevations and elevations for window operations, muntin patterns, quantities, and head heights
6.	GC to verify rough openings with window manufacturer prior to construction
7.	Provide fully adhered bituthene flashing at all window and door openings
8.	Emergency Escape and Rescue Code (Sec R310)
R310.1 Basements and all sleeping rooms shall have at least one operable emergency escape and rescue opening. Where provided sill height shall not exceed 44" above the floor.	
R310.1.1 All emergency escape and rescue openings shall have a minimum net clear opening of 5.7 sf. Exception, grade floor openings shall have a net clear opening of 5 sf.	
R310.1.2 The minimum net clear opening height shall be 24".	
R310.1.3 The minimum net clear opening width shall be 20".	
R310.1.4 Emergency escape and rescue openings shall be operational from inside the room without the use of keys, tools, or special knowledge.	
9.	Provide tempered glazing when adjacent to a door where nearest vertical edge is within a 24 inch arc of the door in a closed position and whose bottom edge is less than 60 inches above the floor. Exceptions: when there is a wall or permanent barrier between the door and glazing Glazing in walls on the latch side of and perpendicular to the plane of the door in a closed position. Glazing adjacent to a door where access through the door it to a closet or storage area 3 feet or less in depth Glazing that is adjacent to the fixed panel of patio doors
10.	Provide tempered glazing when the exposed area of an individual pane is larger than 9 sf and the bottom edge of glazing is less than 18 inches from the floor and the top edge is more than 36 inches above the floor and the walking surface is within 36 inches horizontally of the glazing. Exceptions: When a horizontal rail is installed on the accessible side of the glazing 34 to 38 inches above the walking surface. The rail shall be capable of withstanding a horizontal load of 50 lb/ft.
11.	Provide tempered glazing when adjacent to stairways and landing within 36 inches horizontally of a walking surface when less than 60 inches off the floor. Exception: When a guard or rail is installed on the accessible side of the glazing 34 to 38 inches above the floor.
12.	When an operable window is located more than 72" above finished grade or surface below, and the lowest part of the clear opening is below 24" above the floor. Operable sections of the window shall not permit openings that allow passage of a 4" sphere. Window opening limiting devices shall be designed with release mechanisms without the need for keys, tools, or special knowledge.

Window Schedule - Marvin Clad Ultimate								
Tag	Unit	Mull Unit	Type	Rough Opening	Egress	Factory Mull	Tempered	Remarks
A	CUCA 2028		Casement	1'-9" x 2'-4 9/16"				
a	CUCA 2028		Fixed	1'-9" x 2'-4 9/16"			Yes	Stained glass insert Tempered at Stair landings
B	CUCA 2036		Casement	1'-9" x 3'-0 9/16"				
b	CUCA 2036		Fixed	1'-9" x 3'-0 9/16"				Stained glass insert
C	CUDH 2018		Doublehung	2'-2 1/4" x 3'-8"				
D	CUDH custom		Doublehung	2'-8 1/2" x 5'-7"	Yes			Egress in Bedrooms only
E	CUCA 3048E		Casement	2'-7" x 3'-11 5/8"	Yes			
F	(2) CUCA2414 OVR CUCA2440 - CUCAP4814 OVR CUCAP4840	3 units	Casement	8'-4" x 4'-11 1/4"				See elevation
G	CUDH 2620		Doublehung	2'-8 3/8" x 4'-1 1/2"			Yes	Tempered beside doors only
H	CUAWN		Awning	Determine on site				Basement window size to be determined
J	Existing		Fixed	n/a				Reseal/putty glazing
K	CUDH custom		Doublehung	3'-6 1/2" x 5'-7"	Yes			Egress in Bedrooms only

NOTE:
All windows to have painted interior.

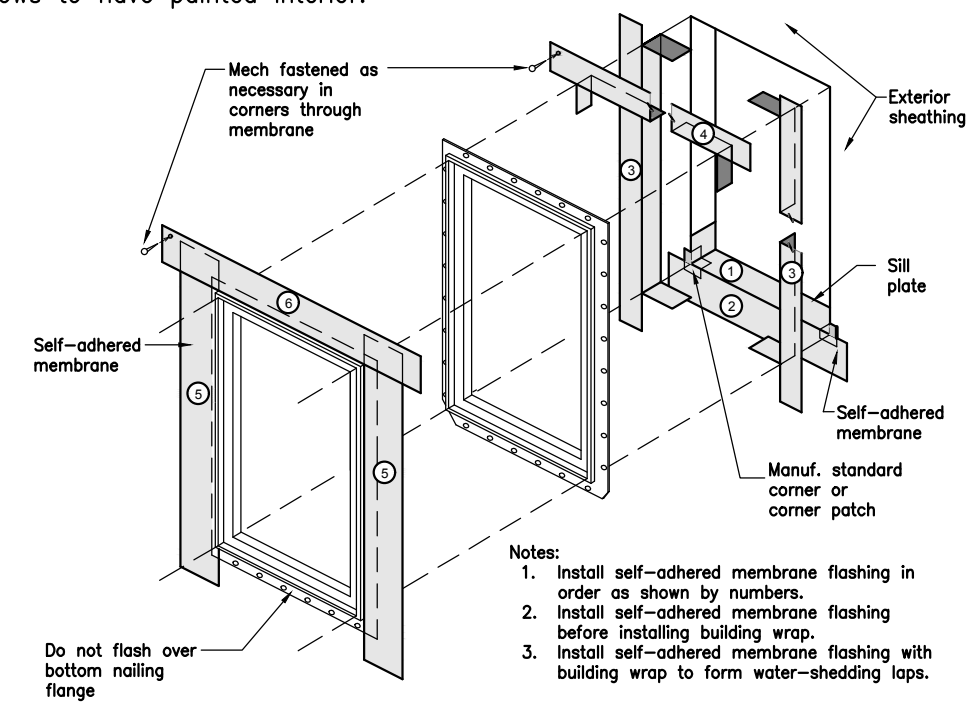

Plumbing Schedule	
P1	Floor mounted toilet
P2	Bathroom Wall sink (shown - Tecla by The Bath Outlet/ 3501011
P3	Kitchen sink
P4	Dishwasher
P5	Bar Sink
P5	Ice maker
P6	Shower controls and shower head
P7	Shower Center drain, sloped from all sides
P8	Freestanding Tub
P9	Bathroom Hand Sink
P10	Washing Machine
P11	Future Bathroom Hand Sink
P12	Future Shower
P13	Future toilet

DOOR SCHEDULE												
Door							Hardware		Miscellaneous			Remarks
No.	Room	Width	Height	Thick.	Material	Type	Type	Frame	Wstrip	Thrshld	Closer	
1-1	Entry	3'-0" (1'-2")	7'-6"	2 1/8"	Wood/Glass	A	EL	Wood	Yes	Yes		Simpson w/sidelight
1-2	Kitchen	2'-8"	7'-6"	1 3/4"	Clad/Glass	B	EL	Wood	Yes	Yes		Marvin
1-3	Entry	(2) 2'-0"	6'-8"	1 3/8"	Wood	C	PS	Wood				
1-4	Stair	2'-6"	6'-8"	1 3/8"	Wood	C	PL	Wood				
1-5	Bath	2'-6"	6'-8"	1 3/8"	Wood	C	PL	Wood				
1-6	Pantry	(2) 1'-4"	6'-8"	1 3/8"	Wood	C	PS	Wood				
1-7	Basement Entry	3'-0"	6'-8"	2 1/8"	Wood	D	EL	Wood	Yes	Yes		Simpson
2-1	Exercise	2'-4"	6'-8"	1 3/8"	Wood	C	PS	Wood				
2-2	M. Bedroom	2'-8"	6'-8"	1 3/8"	Wood	C	PL	Wood				
2-3	M. Bath	2'-8"	6'-8"	1 3/8"	Wood	C	PL	Wood				
2-4	M. Closet	2'-8"	6'-8"	1 3/8"	Wood	C	PS	Wood				
2-5	Laundry	3'-0"	6'-8"	1 3/8"	Wood	C	BD	Wood				3'-0" x 6'-8" Opening Barn door HD track & hardware
2-6	Bedroom 2	2'-8"	6'-8"	1 3/8"	Wood	C	PL	Wood				
2-7	Bath 2	2'-6"	6'-8"	1 3/8"	Wood	C	PL	Wood				
2-8	Closet	(2) 2'-0"	6'-8"	1 3/8"	Wood	C	BP	Wood				
2-9	Exercise	2'-8"	7'-6"	1 3/4"	Clad/Glass	B	EL	Wood	Yes	Yes		Marvin

Finish Legend

ACT	Acoustical Tile Ceiling
CT	Ceramic Tile
DAP	Densarmor Plus GWB
ETR	Existing to Remain
Gyp bd	Gypsum Wall Board
Manuf	Manufacturer
MR	Moisture Resistant
PC	Polished Concrete
Pnt	Paint
Pre	Prefinished
PTM	Patch to Match
PW	Pre-engineered Wood
SC	Sealed Concrete
Wd	Wood

HARDWARE ABBREVIATIONS

BP	By Pass door HW
BD	Barn door HW
DB	Dead Bolt
DP	Door Pull
EL	Entry Lock
PD	Pocket Door HW
PL	Privacy Lock
PS	Passage Set
RC	Remote Control Opener
SC	Screen Door HW
FK	Fixed Knobs

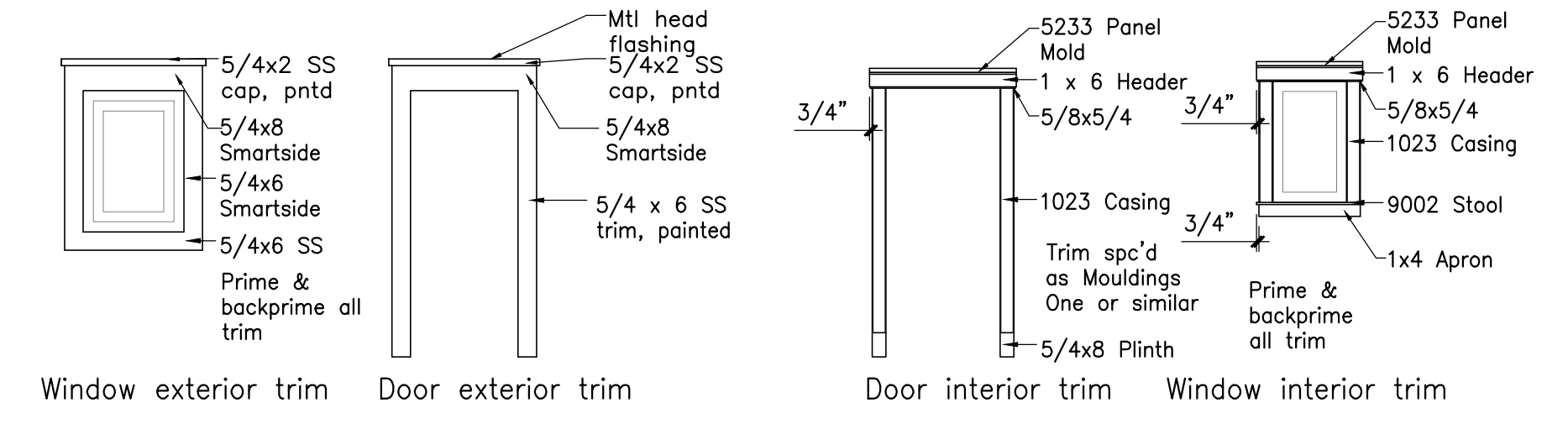
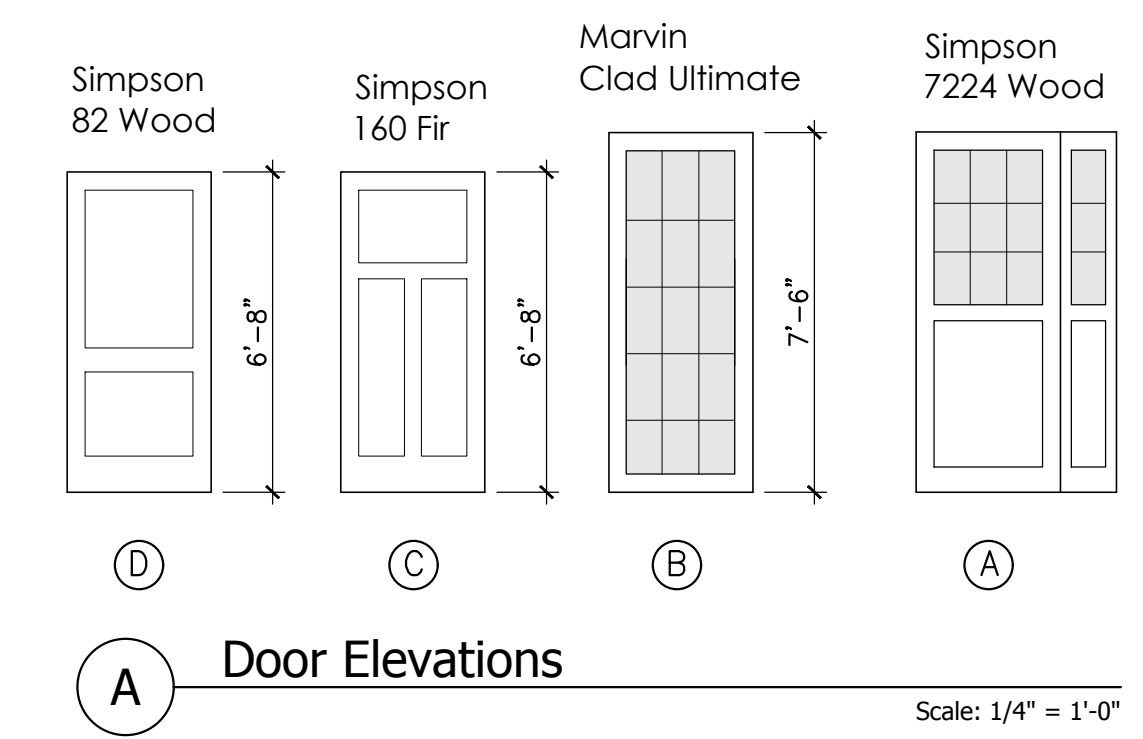

Room Finish Schedule						
No.	Name	Ceiling		Floor		Wall Type
		Height	Type	Type	Base	Refer to Interior Elevations
101	Entry	ETR	Gyp bd, pntd	CT	Wd, Pntd (see interior elev)	Gyp bd & Wd wainscot, pntd, (See interior Elev)
102	Living	ETR	Gyp bd, pntd	Wd	Wd, Pntd (see interior elev)	Gyp bd, pntd
103	Dining	ETR	Gyp bd, pntd	Wd	Wd, Pntd (see interior elev)	Gyp bd, pntd
104	Kitchen	ETR	Gyp bd, pntd	Wd	Wd, Pntd (see interior elev)	MR Gyp bd, pntd
105	TV Room	ETR	Gyp bd, pntd	Wd	Wd, Pntd (see interior elev)	Gyp bd, pntd
106	Bath 1	ETR	Gyp bd, pntd	CT	Wd, Pntd (see interior elev)	MR Gyp bd, pntd,
201	Exercise	ETR	Gyp bd, pntd	Wd	Wd, Pntd (see interior elev)	Gyp bd & Wd wainscot, pntd, (See interior Elev)
202	Master Bedroom	ETR	Gyp bd, pntd	Wd	Wd, Pntd (see interior elev)	Gyp bd, pntd
203	Master Bath	ETR	Gyp bd, pntd	CT	Wd, Pntd (see interior elev)	MR Gyp bd, pntd
204	Closet	ETR	Gyp bd, pntd	Wd	Wd, Pntd (see interior elev)	Gyp bd, pntd
205	Bedroom 2	ETR	Gyp bd, pntd	Wd	Wd, Pntd (see interior elev)	Gyp bd, pntd
206	Bath 2	ETR	Gyp bd, pntd	CT	Wd, Pntd (see interior elev)	MR Gyp bd, pntd
207	Laundry	ETR	Gyp bd, pntd	CT	Wd, Pntd (see interior elev)	MR Gyp bd, pntd