

Consultants

Casco Bay Engineering  
Structural Engineer

Revisions

26 Moody Street  
Condominium

Portland, Maine

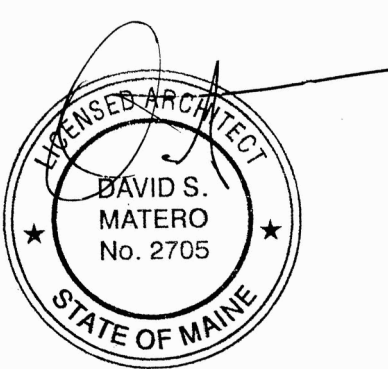

Job Number: 17.011  
Date: 06.20.17  
Scale: 1/4" = 1'-0"

Drawing Title:

Existing and  
Proposed  
Basement  
Floor Plan

A1.4

Issued for  
Permit

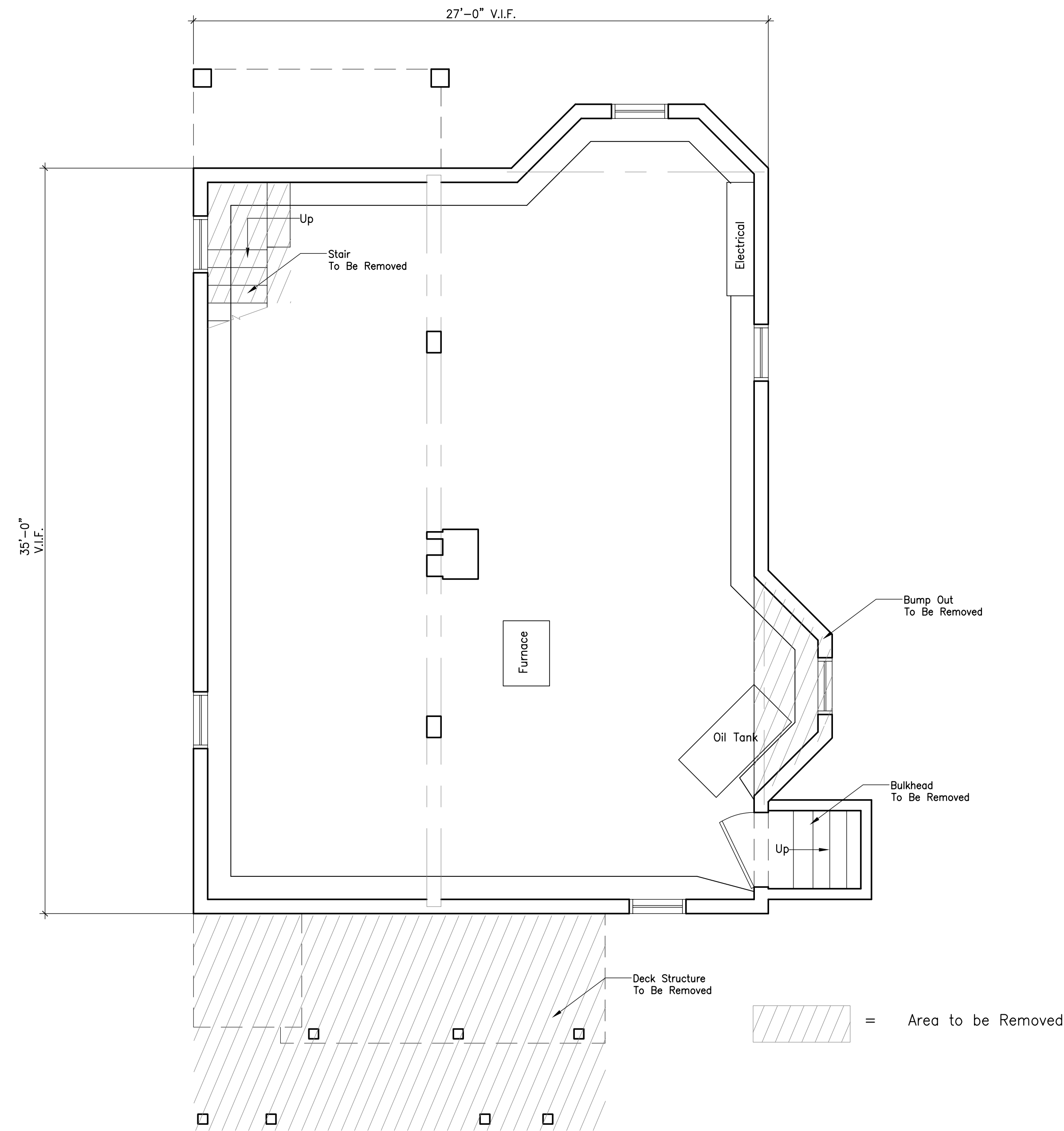

4a Existing Basement Plan

Scale: 1/4" = 1'-0"

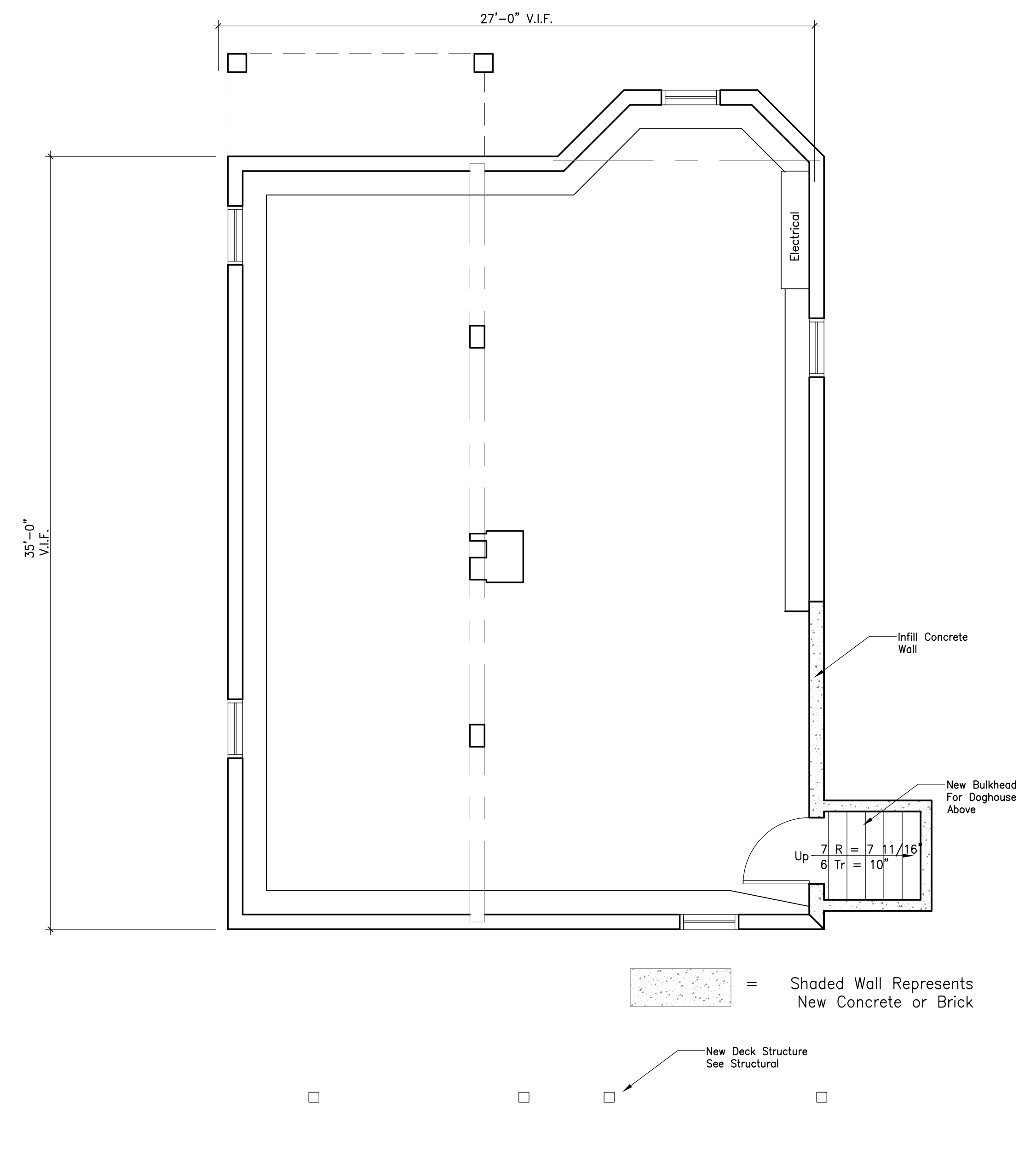

4 Proposed Basement Plan

Scale: 1/4" = 1'-0"