

PART THIRD FLOOR / BALCONY FRAMING PLAN
SCALE: 1/4" = 1'-0"

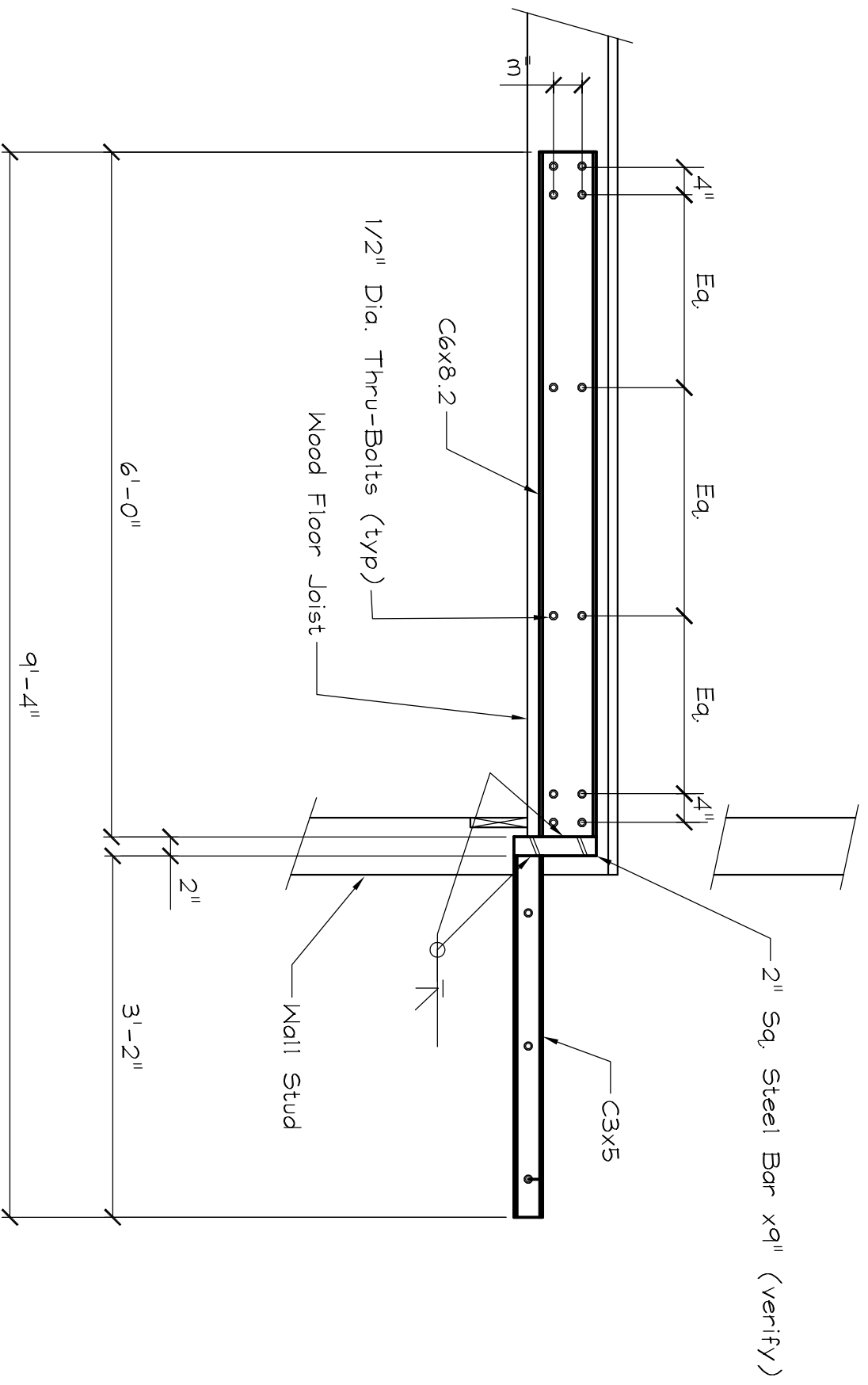

SECTION 1-S1
SCALE: 3/4" = 1'-0"

Copyright © 2010 Shelley Engineering, Inc.

GENERAL NOTES:

1. STRUCTURAL DRAWINGS SHALL BE USED IN CONJUNCTION WITH JOB SPECIFICATIONS AND ARCHITECTURAL DRAWINGS.
2. ALL DIMENSIONS AND CONDITIONS MUST BE VERIFIED IN THE FIELD. ANY DISCREPANCIES SHALL BE BROUGHT TO THE ATTENTION OF THE ENGINEER BEFORE PROCEEDING WITH THE AFFECTED PART OF THE WORK.
3. THE STRUCTURE IS DESIGNED TO BE SELF SUPPORTING AND STABLE AFTER THE BUILDING IS COMPLETE. IT IS THE CONTRACTOR'S SOLE RESPONSIBILITY TO DETERMINE ERECTION PROCEDURES AND SEQUENCE TO ENSURE SAFETY OF THE STRUCTURE AND PERSONNEL DURING ERECTION.
4. ALL APPLICABLE FEDERAL, STATE, AND MUNICIPAL REGULATIONS SHALL BE FOLLOWED, INCLUDING THE FEDERAL DEPARTMENT OF LABOR OCCUPATIONAL SAFETY AND HEALTH ACT.

STRUCTURAL DESIGN CRITERIA:

1. BUILDING CODE: 2006 EDITION OF THE INTERNATIONAL BUILDING CODE.
BUILDING CODE
2. DESIGN WIND LOADS - MAIN WIND FORCE RESISTING SYSTEM:
DESIGN WIND SPEED = 90 MPH
BUILDING USE IMPORTANCE FACTOR (WIND) = 1.1
BUILDING EXPOSURE CATEGORY = B

2. SNOW:
GROUND SNOW LOAD = 60 PSF
IMPORTANCE FACTOR, I = 1.0
EXPOSURE FACTOR, Ce = 0.7
TOTAL FLAT DRIFT SNOW LOAD = 100 PSF

STRUCTURAL STEEL NOTES - GENERAL

1. STRUCTURAL STEEL FABRICATION, ERECTION AND CONNECTION DESIGN SHALL CONFORM TO AISC "SPECIFICATION FOR THE DESIGN, FABRICATION, AND ERECTION OF STRUCTURAL STEEL" 9th EDITION.
2. ALL STEEL SHAPES TO BE A572/A992 50 KSI.
3. STEEL PLATES TO BE ASTM A36 UNLESS NOTED OTHERWISE.
4. WELDING SHALL BE IN ACCORDANCE WITH AWS D1.1 - LATEST EDITION. ALL WELDS SHALL BE MADE WITH E70XX ELECTRODES.
5. STRUCTURAL STEEL SHALL BE PAINTED WITH A SHOP APPLIED COAT OF THE FABRICATOR'S RUST INHIBITIVE PRIMER AND EXTERIOR GRADE FINISH COAT PER OWNER SPECS.
6. SUBMIT COMPLETE STRUCTURAL STEEL SHOP DRAWINGS FOR REVIEW PRIOR TO ANY STEEL FABRICATION.

SHELLEY ENGINEERING, INC.
STRUCTURAL CONSULTANTS
90 BRIDGE STREET
WESTBROOK, MAINE 04092
PHONE (207) 854-5465
FAX (207) 854-8706
WWW.SHELLEYENGINEERING.COM

—SEI—

UNIT 5 BALCONY
102 EASTERN PROMENADE

PORTLAND

MAINE

DRN BY:	TGS
CHK'D BY:	TGS
DATE:	9-8-10
SCALE:	NOTED
JOB NO.:	2010-130

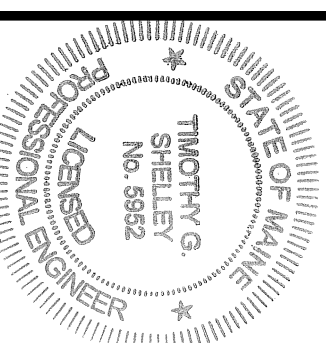

S1