

© 2007 TFH ARCHITECTS

**THE ESTATES OF LONGFELLOW INN**  
 130 EASTERN PROMENADE, PORTLAND, ME  
 CASCO BAY VENTURES

TFH ARCHITECTS  
 100 COMMERCIAL STREET  
 PORTLAND MAINE 04101  
 TELEPHONE 207 775 6141  
 ARCHITECTURE PLANNING

CONSULTANTS:  
**CIVIL:**  
 Land Consulting Engineers, PA  
 907 Grandway  
 South Portland, ME 04106  
 Tel: 207-767-7500  
 Fax: 1-888-927-9293  
**STRUCTURAL:**  
 Shelley Engineering, Inc.  
 80 Bridge St. Suite 202  
 Westbrook, ME 04092  
 Ph: 207-854-8468 ext. 10  
 Fax: 207-854-8706

REVISIONS:  
 02.14.2008 FOR  
 CONSTRUCTION

DATE: 01.31.2008

PROJECT No. 0610

DRAWN BY: SA

CHECKED BY: TST

SCALE: AS NOTED

SHEET TITLE:  
 LANDSCAPING  
 PLAN

**C1.4**

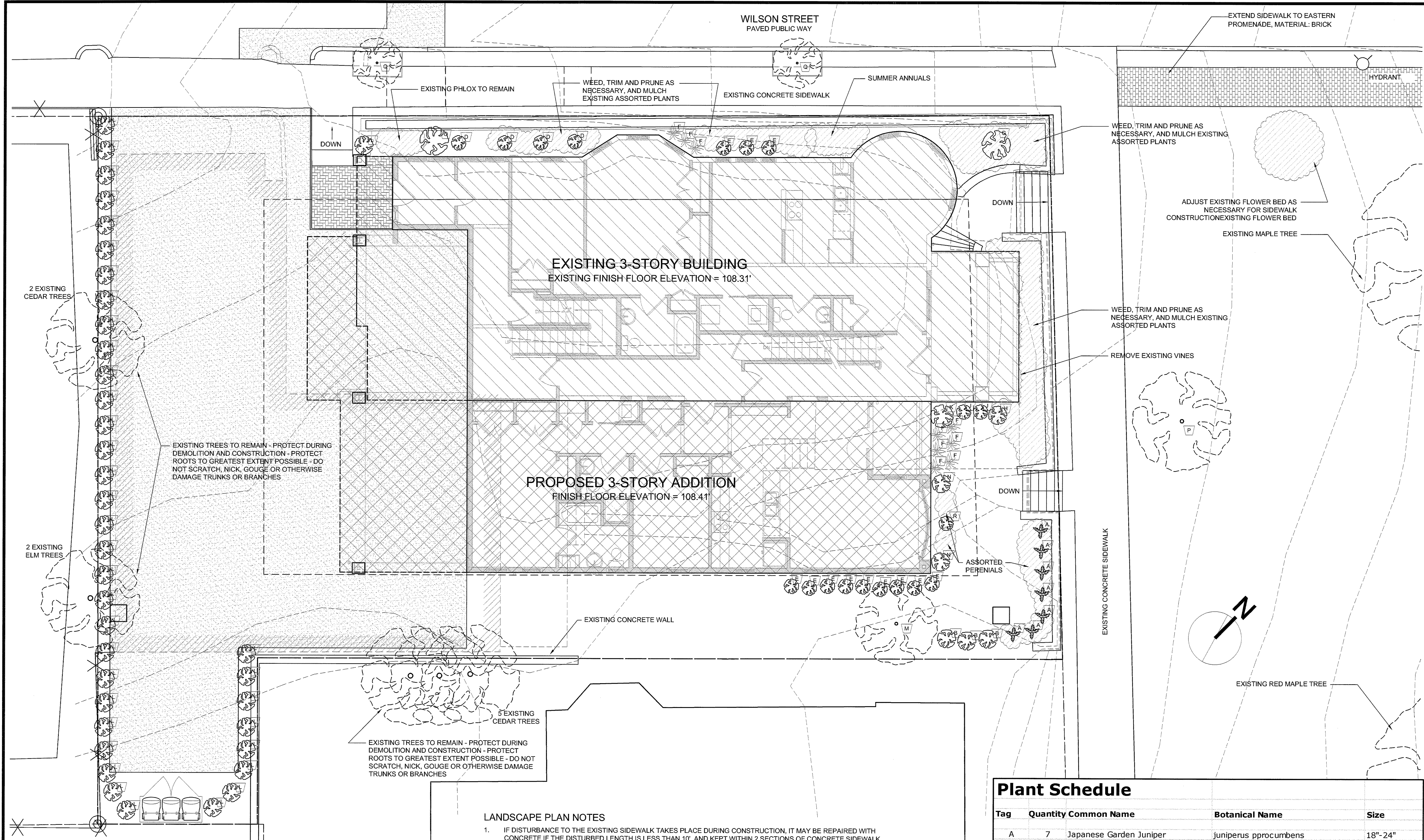

**1 LANDSCAPING PLAN**  
 3/16"=1'-0"

**LANDSCAPE PLAN NOTES**

- IF DISTURBANCE TO THE EXISTING SIDEWALK TAKES PLACE DURING CONSTRUCTION, IT MAY BE REPAIRED WITH CONCRETE IF THE DISTURBED LENGTH IS LESS THAN 10', AND KEPT WITHIN 2 SECTIONS OF CONCRETE SIDEWALK. IF A LARGER DISTURBED AREA OF SIDEWALK TAKES PLACE, THE SECTIONS MUST BE REPLACED WITH BRICK SIDEWALK. IF THE SIDEWALK IS NOT PART OF THE HISTORIC AREA (ALONG WILSON STREET), THE OPTION EXISTS FOR CONCRETE PAVEMENT BRICKS TO BE USED AS AN ALTERNATIVE TO CLAY BRICK.
- IMPACT TO THE EASTERN PROMENADE AREA HAS TO BE LIMITED DURING CONSTRUCTION. THIS INCLUDES: NO STORAGE OF TRUCKS, EQUIPMENT AND MATERIALS ON THE LAWN AREA. ALL DAMAGED AREAS HAVE TO BE REPAIRED IN A TIMELY MANNER. THE SIDEWALK PEDESTRIAN WAY ALONG THE EASTERN PROMENADE HAS TO BE MAINTAINED IN GOOD CONDITION DURING CONSTRUCTION WORK. THE PROJECT TEAM OR CONTRACTOR SHALL CONTACT PARK & RECREATION CONCERNING CONSTRUCTION ACTIVITIES THAT MIGHT EFFECT THE EASTERN PROMENADE AREAS.

**GENERAL NOTES** (SEE G-1.1 FOR MORE GENERAL NOTES)

- DRAWING NOTES:** DRAWING NOTES, UNLESS THEY INDICATE OR ARE OBVIOUS OTHERWISE, REFER TO NEW CONSTRUCTION.
- LAYOUT:** UNLESS INDICATED OTHERWISE, FLOOR PLAN DIMENSIONS ARE TO FINISH FACE OF EXISTING CONSTRUCTION AND ARE TO FACE OF FRAMING OF NEW CONSTRUCTION. DOORS AND WINDOWS ARE DIMENSIONED TO CENTERLINES OR ROUGH OPENINGS. STAIR TREAD & RISER LAYOUT DIMENSIONS ARE TO TREAD NOSINGS.

**Plant Schedule**

| Tag | Quantity | Common Name                    | Botanical Name                          | Size           |
|-----|----------|--------------------------------|---|----------------|
| A   | 7        | Japanese Garden Juniper        | juniperus procumbens                    | 18"-24"        |
| B   | 3        | Anthony Water Spirea           | spirea japonica 'anthony waterer'       | 24"-30"        |
| D   | 4        | Spirea Shibori                 | spirea japonica shibori                 | 18"-24"        |
| E   | 12       | Hydrangea Annabella            | hydrangea arborescens 'annabella'       | 18"-24"        |
| F   | 9        | Day Lilly                      |   |                |
| G   | 1        | Hydrangea PG                   | hydrangea paniculata grandiflora        | 36"-48"        |
| H   | 1        | Miss Kim Lilac                 | syringa patula                          | 24"-30"        |
| J   | 2        | Blue Hydrangea                 | nikko blue hydrangea                    | 18"-24"        |
| K   | 1        | Dwarf Burning Bush             | euonymus alatus compactus               | 30"-36"        |
| L   | 40       | Arborvitae                     |   | 48"-60" Tall   |
| M   | 1        | Snow Fountains® Weeping Cherry | prunus 'snowfozam'                      | 10'            |
| N   | 2        | PJM Rhododendron               | rhododendron 'pjm'                      | 24"-30"        |
| O   | 1        | Diablo Ninebark                | physocarpus opulifolius 'monlo'         | 36"-48"        |
| P   | 1        | Autumn Blaze Maple             | acer x freemanii                        | 2 1/2" Caliper |
| Q   | 2        | Ginkgo                         | ginkgo biloba                           | 2" Caliper     |
| R   | 1        | Gold Thread Cypress            | chamaecyparis pisifera 'filifera aurea' | 18"-24"        |