

© 2007 TFH ARCHITECTS

# THE ESTATES OF LONGFELLOW INN

130 EASTERN PROMENADE, PORTLAND, ME  
CASCO BAY VENTURES

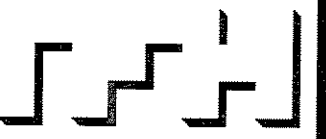

TFH ARCHITECTS  
100 COMMERCIAL STREET  
PORTLAND MAINE 04101  
TELEPHONE 207 775 8141  
ARCHITECTURE PLANNING

CONSULTANTS:  
CIVIL  
Lamb Consulting Engineers, PA  
587 Broadway  
South Portland, ME 04106  
Tel: 207-567-7300  
Fax: 1-866-207-2333  
STRUCTURAL  
Sheehy Engineering, Inc  
60 Bridge St. Suite 300  
Westbrook, ME 04092  
Ph: 207.854.5450 ext. 13  
Fax: 207.854.8706

REVISIONS:

DATE: 02.14.2008  
PROJECT No. 0610  
DRAWN BY: SA  
CHECKED BY: TST  
SCALE: AS NOTED

SHEET TITLE:  
1ST FLOOR PLAN

# A1.2

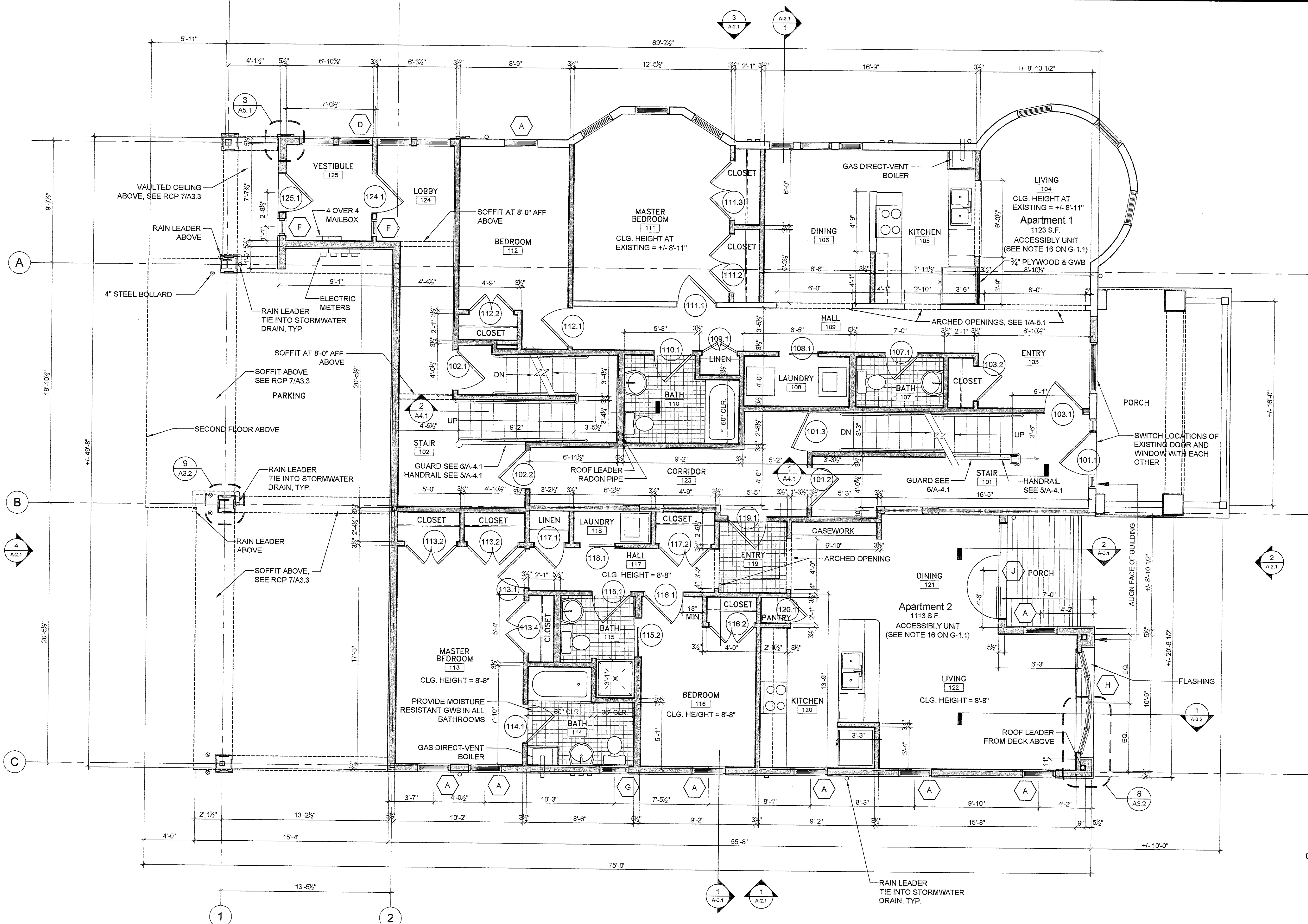

**1** FIRST FLOOR PLAN  
1/4" = 1'-0"

### LEGEND

- EXISTING CONSTRUCTION TO REMAIN
- DEMOLITION
- NEW CONSTRUCTION
- NEW CONSTRUCTION WITH SOUND INSULATION
- 1 HOUR RATED NEW CONSTRUCTION
- 1 HOUR RATED EXISTING CONSTRUCTION

NOTE: SEE A-3.1 FOR CONSTRUCTION ASSEMBLIES

### GENERAL NOTES (SEE G-1.1 FOR MORE GENERAL NOTES)

1. DRAWING NOTES: DRAWING NOTES, UNLESS THEY INDICATE OR ARE OBVIOUS, REFER TO NEW CONSTRUCTION.
2. LAYOUT: UNLESS INDICATED OTHERWISE, FLOOR PLAN DIMENSIONS ARE TO FINISH FACE OF EXISTING CONSTRUCTION AND ARE TO FACE OF FRAMING OF NEW CONSTRUCTION. DOORS AND WINDOWS ARE DIMENSIONED TO CENTERLINES OR ROUGH OPENINGS. STAIR TREAD AND RISER LAYOUT DIMENSIONS ARE TO TREAD NOSINGS.

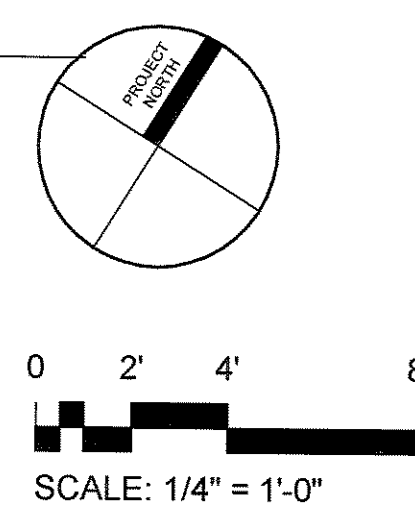

\* SEE G1.1 FOR SELECT SPECIFICATIONS