

EXTERIOR WINDOW SCHEDULE

NO.	TYPE	MANUFACTURER	CATALOG NO.	REMARKS
A	DOUBLE HUNG	INTEGRITY	ITDH3664 2W	GRILL PATTERN PER ELEVATIONS - FACTORY MULL - EGRESS AS SHOWN ON PLANS
B	CASEMENT	INTEGRITY	ICA3343	GRILL PATTERN PER ELEVATIONS
C	DOUBLE HUNG	INTEGRITY	ITDH3664	GRILL PATTERN PER ELEVATIONS - ENLARGE EXISTING OPENINGS
D	DOUBLE HUNG	INTEGRITY	ITDH3664	GRILL PATTERN PER ELEVATIONS - EGRESS AS SHOWN ON PLANS
E	DOUBLE HUNG	INTEGRITY	ITDH3664 3W	GRILL PATTERN PER ELEVATIONS - FACTORY MULL - EGRESS AS SHOWN ON PLANS
F	DOUBLE HUNG	INTEGRITY	ITDH3660 2W	GRILL PATTERN PER ELEVATIONS - FACTORY MULL - EGRESS AS SHOWN ON PLANS
G	DOUBLE HUNG	INTEGRITY	ITDH3660	GRILL PATTERN PER ELEVATIONS - ENLARGE EXISTING OPENINGS
H	DOUBLE HUNG	INTEGRITY	ITDH3660	GRILL PATTERN PER ELEVATIONS - EGRESS AS SHOWN ON PLANS
I	DOUBLE HUNG	INTEGRITY	ITDH3660 3W	GRILL PATTERN PER ELEVATIONS - FACTORY MULL - EGRESS AS SHOWN ON PLANS
J	FIXED	--	BASEMENT SASH	GRILL PATTERN PER ELEVATIONS - EXISTING OPENINGS TO REMAIN

NOTE:

G.C. TO FIELD VERIFY ALL EXISTING WINDOW LOCATIONS & ROUGH OPENINGS RELATIONSHIP TO NEW WINDOWS & NEW ROUGH OPENINGS.

NOTE:

- ALL WINDOWS & DOORS SHALL BE INTEGRITY SERIES FROM MARVIN WINDOWS.
- COLOR:
INTERIOR: WHITE
EXTERIOR: WHITE
- GRILLS:
PATTERN AS SHOWN ON THE ELEVATIONS
7/8" SIMULATED DIVIDED LIGHT
- EXTENSION JAMBS:
NO EXTENSION JAMBS (FIELD BUILT)
- GLAZING:
HIGH PERFORMANCE LOW-E GLASS W/ ARGON
- CASINGS:
INTERIOR: NO CASING (BY G.C.)
EXTERIOR: NO CASING (BY G.C.)
- SCREENS: (SHIP/ PACKAGE SEPARATE FROM WINDOWS)
STANDARD MESH INSECT SCREENS
DOUBLE HUNG COLOR TO MATCH EXTERIOR
CASEMENTS & AWNINGS TO HAVE INTERIOR SURROUND - FINISH TO MATCH INTERIOR (VERIFY)
- HARDWARE:
STAINLESS STEEL COASTAL HARDWARE OR EQUAL
SATIN NICKEL - VERIFY W/ OWNER
STYLE T.B.D. BY OWNER
- G.C. TO VERIFY WINDOW R.O. W/ WINDOW SUBMITTAL PRIOR TO CONSTRUCTION.
- G.C. SHALL SUBMIT WINDOW SPECIFICATIONS FOR APPROVAL PRIOR TO ORDER.
- ALL FACTORY MULLS SHALL BE REINFORCED.
- ALL WINDOWS IN SLEEPING ROOMS SHALL BE EGRESS WINDOWS MEETING THE FOLLOWING MINIMUM CLEAR OPENING REQUIREMENTS: 22" WIDE - 24" HIGH - 5.7 S.F.
- ALL WINDOWS WITHIN 60" HORIZ. & VERT. DIMENSION OF STAIRS MUST BE TEMPERED.
- ALL WINDOWS WITHIN 24" OF A DOOR SWING MUST BE TEMPERED.
ALL WINDOWS WITHIN A SHOWER ENCLOSURE MUST BE TEMPERED.

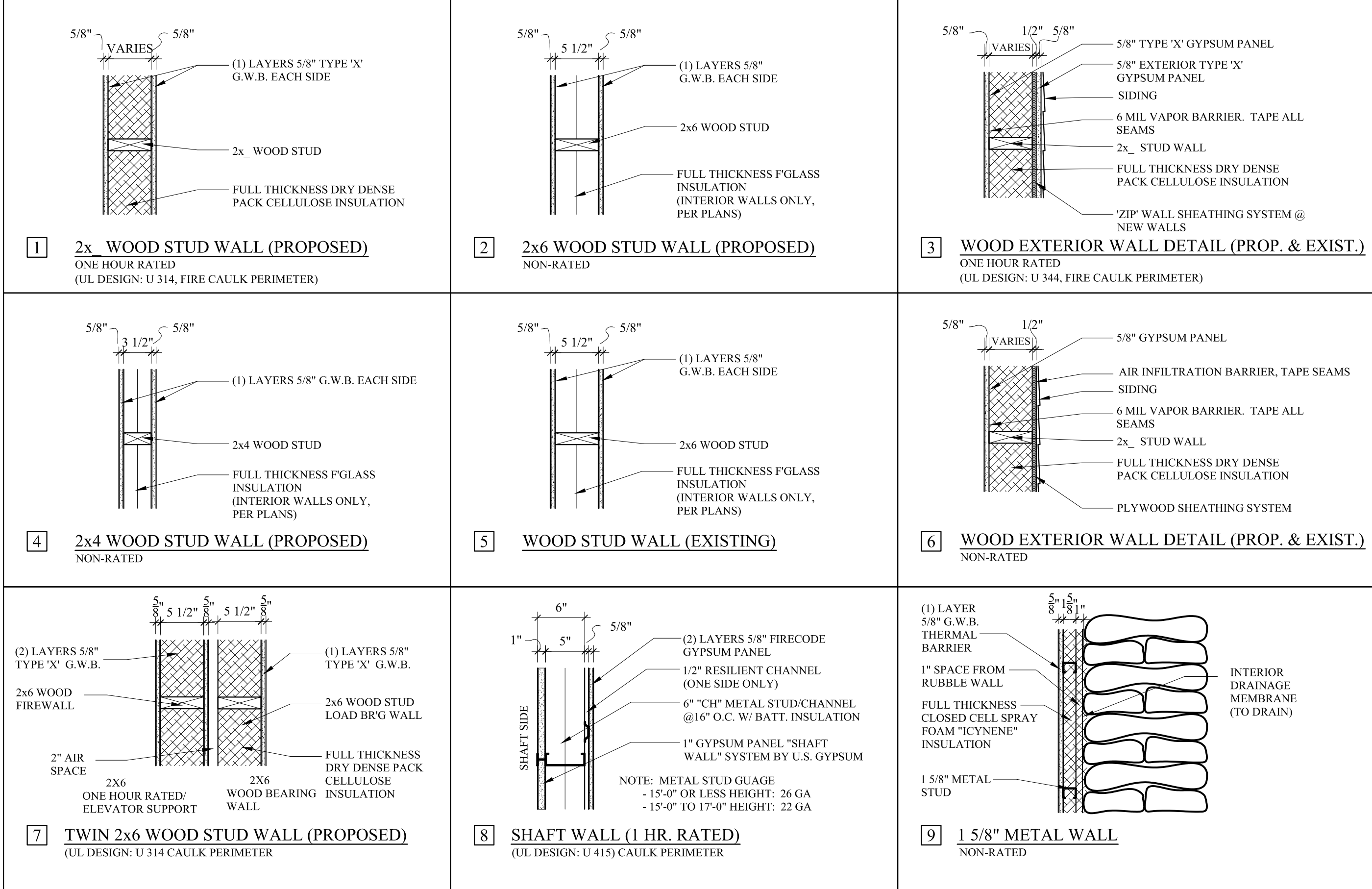

DOOR AND FRAME SCHEDULE

MARK	MODEL	MANUF.	SIZE			MATL	GLAZING	FRAME		FIRE RATING LABEL	HARDWARE		NOTES
			WD	HGT	THK			MATL	HEAD		SILL	SET NO	
002.0	--	JELDWEN OR EQUAL	3'-0"	6'-8"	1 3/4"	METAL	--	METAL	--	--	--	--	FLAT PANEL
004.0	--	JELDWEN OR EQUAL	3'-0"	6'-8"	1 3/4"	METAL	--	METAL	--	1 HR	--	--	FLAT PANEL
100.0	--	METAL	3'-0"	6'-8"	1 3/4"	METAL	--	METAL	--	--	--	--	FLAT PANEL
101.0	--	ROUGE VALLEY	3'-0"	6'-8"	1 3/4"	WOOD	--	WOOD	--	--	--	--	CUSTOM PANEL
101.1	--	--	2'-6"	6'-8"	1 3/8"	WOOD	--	WOOD	--	--	--	--	FLAT PANEL
102.0	--	--	2'-6"	6'-8"	1 3/8"	WOOD	--	WOOD	--	--	--	--	FLAT PANEL
102.0	--	--	2'-6"	6'-8"	1 3/8"	WOOD	--	WOOD	--	--	--	--	FLAT PANEL
103.0	--	--	2'-6"	6'-8"	1 3/8"	WOOD	--	WOOD	--	--	--	--	FLAT PANEL
103.0	--	--	2'-6"	6'-8"	1 3/8"	WOOD	--	WOOD	--	--	--	--	FLAT PANEL
103.1	--	--	2'-6"	6'-8"	1 3/8"	WOOD	--	WOOD	--	--	--	--	FLAT PANEL
103.1	--	--	2'-6"	6'-8"	1 3/8"	WOOD	--	WOOD	--	--	--	--	FLAT PANEL
104.0	--	--	2'-6"	6'-8"	1 3/8"	WOOD	--	WOOD	--	--	--	--	FLAT PANEL
104.0	--	--	2'-6"	6'-8"	1 3/8"	WOOD	--	WOOD	--	--	--	--	FLAT PANEL
104.1	--	--	2'-6"	6'-8"	1 3/8"	WOOD	--	WOOD	--	--	--	--	FLAT PANEL
104.1	--	--	2'-6"	6'-8"	1 3/8"	WOOD	--	WOOD	--	--	--	--	FLAT PANEL
104.2	--	--	2'-0"	6'-8"	1 3/8"	WOOD	--	WOOD	--	--	--	--	FLAT PANEL
104.2	--	--	2'-0"	6'-8"	1 3/8"	WOOD	--	WOOD	--	--	--	--	FLAT PANEL
105.0	--	--	2'-6"	6'-8"	1 3/8"	WOOD	--	WOOD	--	--	--	--	FLAT PANEL
105.1	--	--	5'-0"	6'-8"	1 3/8"	WOOD	--	WOOD	--	--	--	--	FLAT PANEL
106.0	--	--	2'-4"	6'-8"	1 3/8"	WOOD	--	WOOD	--	--	--	--	FLAT PANEL
107.0	--	--	2'-0"	6'-8"	1 3/8"	WOOD	--	WOOD	--	--	--	--	FLAT PANEL
110.0	--	EXIST	3'-0"	6'-8"	1 3/4"	EXIST	--	EXIST	--	1 HR	--	--	CUSTOM PANEL
112.0	--	--	2'-6"	6'-8"	1 3/8"	WOOD	--	WOOD	--	--	--	--	FLAT PANEL
112.1	--	--	5'-0"	6'-8"	1 3/8"	WOOD	--	WOOD	--	--	--	--	FLAT PANEL
113.0	--	--	2'-6"	6'-8"	1 3/8"	WOOD	--	WOOD	--	--	--	--	FLAT PANEL
115.0	--	ROUGE VALLEY	3'-0"	6'-8"	1 3/4"	WOOD	--	WOOD	--	1 HR	--	--	CUSTOM PANEL
115.1	--	JELDWEN OR EQUAL	3'-0"	6'-8"	1 3/4"	METAL	--	METAL	--	1 HR	--	--	FLAT PANEL
115.2	--	JELDWEN OR EQUAL	3'-0"	6'-0"	1 3/4"	METAL	--	METAL	--	1 HR	--	--	FLAT PANEL
115.3	--	JELDWEN OR EQUAL	3'-0"	6'-8"	1 3/4"	METAL	--	METAL	--	1 HR	--	--	FLAT PANEL
200.0	--	JELDWEN OR EQUAL	3'-0"	6'-8"	1 3/4"	METAL	--	METAL	--	1 HR	--	--	FLAT PANEL
201.0	--	ROUGE VALLEY	3'-0"	6'-8"	1 3/4"	WOOD	--	WOOD	--	--	--	--	CUSTOM PANEL
201.1	--	--	2'-6"	6'-8"	1 3/8"	WOOD	--	WOOD	--	--	--	--	FLAT PANEL
205.0	--	--	2'-6"	6'-8"	1 3/8"	WOOD	--	WOOD	--	--	--	--	FLAT PANEL
205.1	--	--	5'-0"	6'-8"	1 3/8"	WOOD	--	WOOD	--	--	--	--	FLAT PANEL
207.0	--	--	2'-0"	6'-8"	1 3/8"	WOOD	--	WOOD	--	--	--	--	FLAT PANEL
210.0	ISPD5068 XO	INTEGRITY	6'-0"	6'-10 1/2"	1 3/4"	--	FULL LITE	--	--	--	--	--	GRILL PATTERN PER ELEVATIONS
212.0	--	--	2'-6"	6'-8"	1 3/8"	WOOD	--	WOOD	--	--	--	--	FLAT PANEL
212.1	--	--	5'-0"	6'-8"	1 3/8"	WOOD	--	WOOD	--	--	--	--	FLAT PANEL
213.0	--	--	2'-6"	6'-8"	1 3/8"	WOOD	--	WOOD	--	--	--	--	FLAT PANEL
215.0	--	ROUGE VALLEY	3'-0"	6'-8"	1 3/4"	WOOD	--	WOOD	--	1 HR	--	--	CUSTOM PANEL
216.0	--	EXIST	3'-0"	6'-8"	1 3/4"	EXIST	--	EXIST	--	--	--	--	FLAT PANEL
217.0	--	EXIST	3'-0"	6'-8"	1 3/4"	EXIST	--	EXIST	--	60 MIN.	--	--	FLAT PANEL
300.0	--	JELDWEN OR EQUAL	3'-0"	6'-8"	1 3/4"	METAL	--	METAL	--	1 HR	--	--	FLAT PANEL
301.0	--	ROUGE VALLEY	3'-0"	6'-8"	1 3/4"	WOOD	--	WOOD	--	--	--	--	CUSTOM PANEL
301.1	--	--	2'-6"	6'-8"	1 3/8"	WOOD	--	WOOD	--	--	--	--	FLAT PANEL
302.0	--	--	2'-6"	6'-8"	1 3/8"	WOOD	--	WOOD	--	--	--	--	FLAT PANEL
303.0	--	--	2'-6"	6'-8"	1 3/8"	WOOD	--	WOOD	--	--	--	--	FLAT PANEL
303.1	--	--	2'-6"	6'-8"	1 3/8"	WOOD	--	WOOD	--	--	--	--	FLAT PANEL
304.0	--	--	2'-6"	6'-8"	1 3/8"	WOOD	--	WOOD	--	--	--	--	FLAT PANEL
304.1	--	--	2'-6"	6'-8"	1 3/8"	WOOD	--	WOOD	--	--	--	--	FLAT PANEL
304.2	--	--	2'-0"	6'-8"	1 3/8"	WOOD	--	WOOD	--	--	--	--	FLAT PANEL
305.0	--	--	2'-6"	6'-8"	1 3/8"	WOOD	--	WOOD	--	--	--	--	FLAT PANEL
305.1	--	--	2'-6"	6'-8"	1 3/8"	WOOD	--	WOOD	--	--	--	--	FLAT PANEL
305.2	--	--	2'-6"	6'-8"	1 3/8"	WOOD	--	WOOD	--	--	--	--	FLAT PANEL
307.0	--	--	2'-0"	6'-8"	1 3/8"	WOOD	--	WOOD	--	--	--	--	FLAT PANEL
309.0	ISPD5068 XO	INTEGRITY	6'-0"	6'-10 1/2"	1 3/4"	--	FULL LITE	--	--	--	--	--	GRILL PATTERN PER ELEVATIONS
311.0	--	EXIST	3'-0"	6'-8"	1 3/4"	EXIST	--	EXIST	--	--	--	--	FLAT PANEL
313.0	--	--	2'-6"	6'-8"	1 3/8"	WOOD	--	WOOD	--	--	--	--	FLAT PANEL
313.1	--	--	5'-0"	6'-8"	1 3/8"	WOOD	--	WOOD	--	--	--	--	FLAT PANEL
315.0	--	--	2'-6"	6'-8"	1 3/8"	WOOD	--	WOOD	--	--	--	--	FLAT PANEL
315.1	--	--	2'-6"	6'-8"	1 3/8"	WOOD	--	WOOD	--	--	--	--	FLAT PANEL
316.0	--	ROUGE VALLEY	3'-0"	6'-8"	1 3/4"	WOOD	--	WOOD	--	1 HR	--	--	CUSTOM PANEL
317.0	--	JELDWEN OR EQUAL	3'-0"	6'-8"	1 3/4"	METAL	--	METAL	--	--	--	--	FLAT PANEL

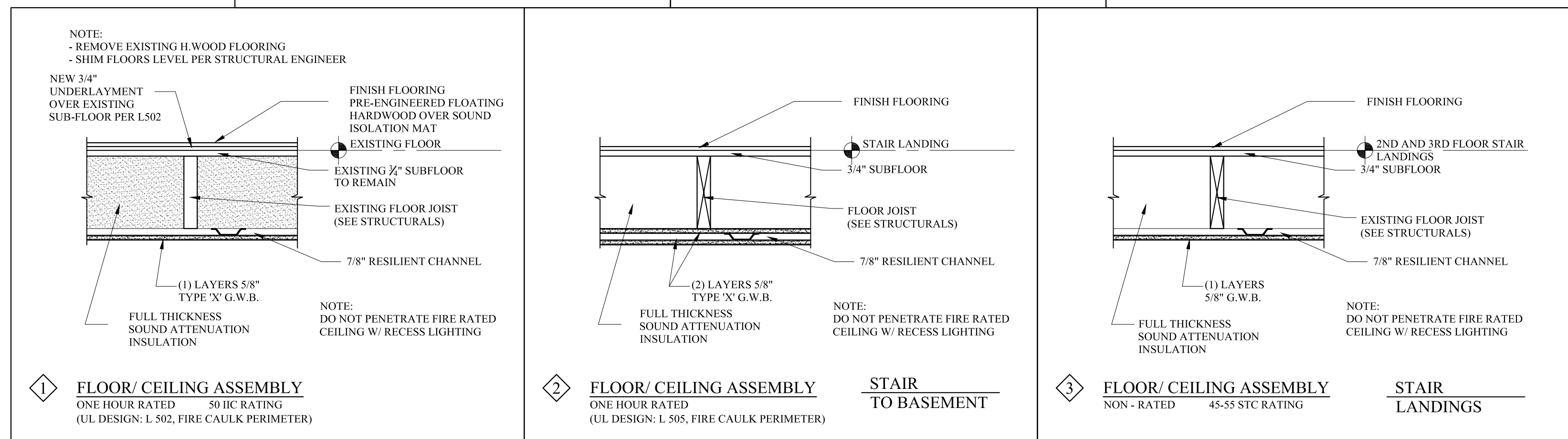

MARK MUELLER ARCHITECTS
A.I.A.
100 Commercial Street
Suite 205
Portland, Maine 04101
Phone: 207.774.9057
Email: rfm@muellerarchitects.com

PROPOSED RENOVATIONS @
130 EASTERN PROMENADE
FOR: 130 EASTERN PROMENADE LLC
110 MARGINAL WAY
PORTLAND, MAINE 04101

SCHEDULES & WALL DETAILS

REVISIONS

DATE: 02.24.2011

PROJECT: 130 E. PROM

DRAWN BY: MFP

CHECK BY: MAM