

WALL LEGEND	
EXISTING WALL	
NEW WALL	
FIRE RATED WALL	
EXISTING WALL TO BE REMOVED	
REMOVED	

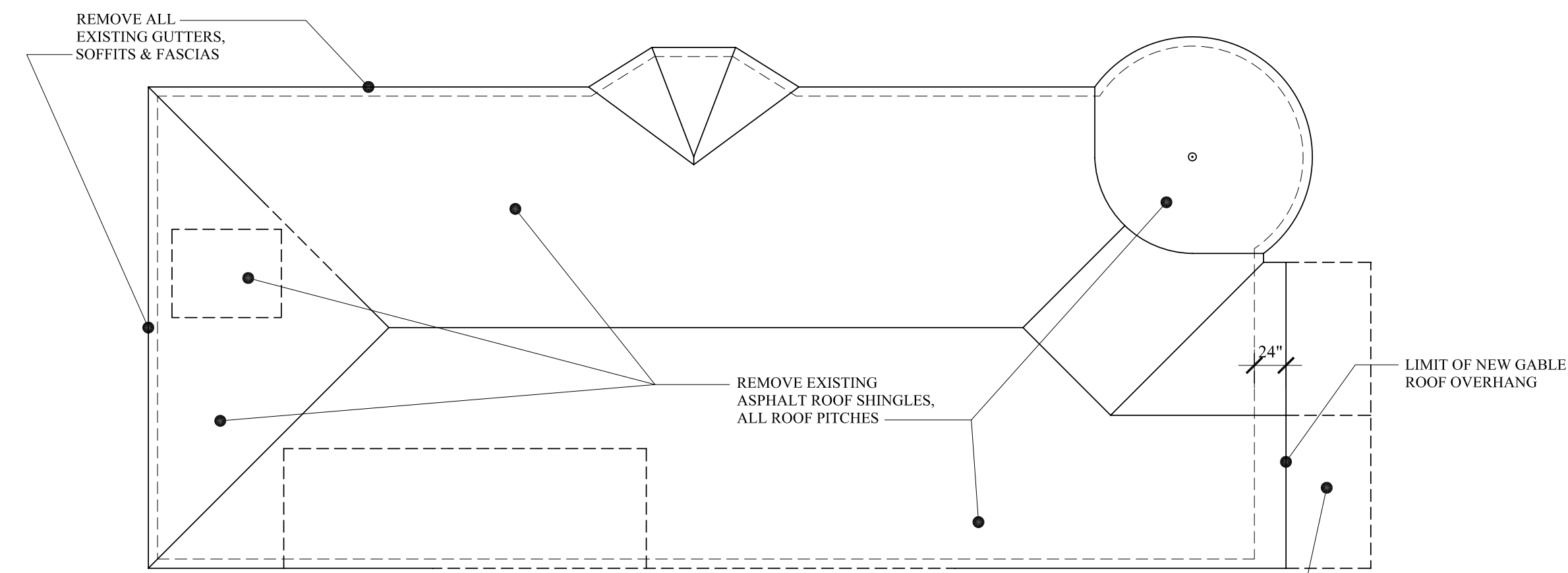

### EXISTING/ DEMO ROOF PLAN

SCALE: 1/8" = 1'-0"

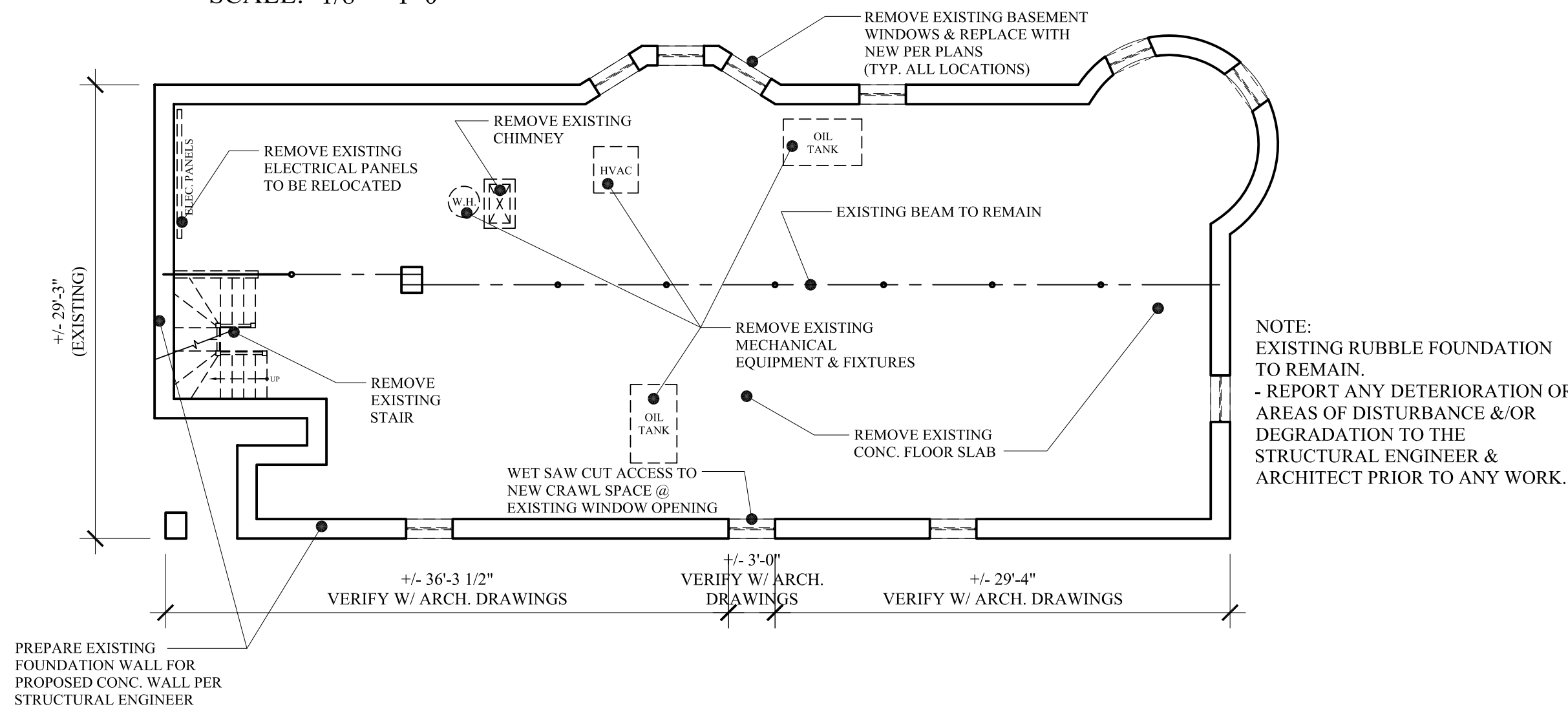

### BASEMENT/ FND DEMO PLAN

SCALE: 1/8" = 1'-0"

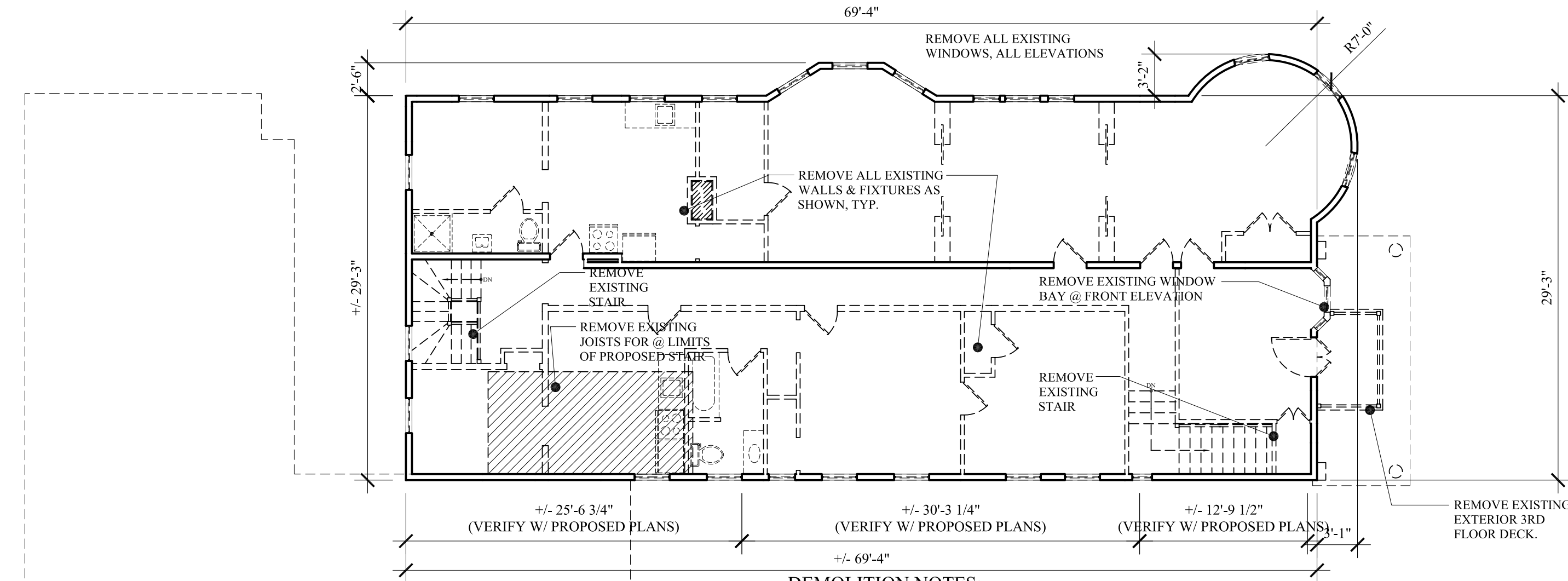

### THIRD FLOOR DEMO PLAN

SCALE: 1/8" = 1'-0"

#### DEMOLITION NOTES:

1. ALL WALLS AS SHOWN TO BE REMOVED. G.C. TO FIELD VERIFY & REPORT ANY DISCREPANCIES OR LOAD BEARING WALLS TO THE ARCHITECT.
2. ELECTRIC POWER TO THE BUILDING SHALL BE DISCONNECTED PRIOR TO DEMOLITION WORK. VERIFY WATER SHUT-OFF W/ BUILDING OWNER/ P.W.D. FIRE ALARM SYSTEMS TO REMAIN FULLY OPERATIONAL DURING DEMOLITION.
3. ALL DEMOLITION SHALL BE REMOVED FROM SITE DAILY.
4. REMOVE EXISTING FINISHED CEILINGS & FINISH FLOORING; INCLUDING ALL UNDERLAYMENTS, SUB-FLOORS TO REMAIN
5. REMOVE TWO LAYERS OF EXISTING SHINGLE AND CLAPBOARD SIDING & WINDOWS.
6. ALL FIRE PROTECTION, GYPSUM DRYWALL &/ OR FIRESPRAY ON STRUCTURAL MEMBERS; INCLUDING BEARING WALLS, FIRE SEPARATION WALLS, BEAMS, COLUMNS & FIRE RATED FLOOR/ CEILING ASSEMBLIES SHALL NOT BE REMOVED.
7. REMOVE EXISTING ASPHALT ROOF SHINGLES.
8. DIMENSIONS INDICATED +/- ARE EXISTING CONDITION DIMENSIONS TO BE VERIFIED IN FIELD.
9. REMOVE ALL EXISTING KITCHEN APPLIANCE & PLUMBING FIXTURES IF ANY, VENTING AND ASSOCIATED EXHAUST FANS.
10. G.C. TO VERIFY WITH 'DIG SAFE' PRIOR TO ANY SITE WORK.
11. FIELD VERIFY ALL STRUCTURAL COMPONENTS PRIOR TO DEMOLITION. REPORT ANY DISCREPANCIES IMMEDIATELY TO ARCHITECT.
12. REMOVE EXISTING FRONT AND REAR STAIR.
13. EXTERIOR DECK REMOVAL PER DRAWINGS.
14. EXISTING MECHANICAL, ELECTRICAL & PLUMBING SYSTEMS TO BE REMOVED IN ITS ENTIRETY.
15. TEMPORARILY BRACE ALL WALLS, FLOOR & ROOF DURING & AFTER DEMOLITION.
16. COORDINATE EXISTING PERIMETER WALL LOCATIONS TO BE MODIFIED PER NEW WINDOW LOCATIONS.
17. ALL HAZARDOUS MATERIALS SHALL BE REMOVED PER OSHA & MAINE DEP STANDARDS.

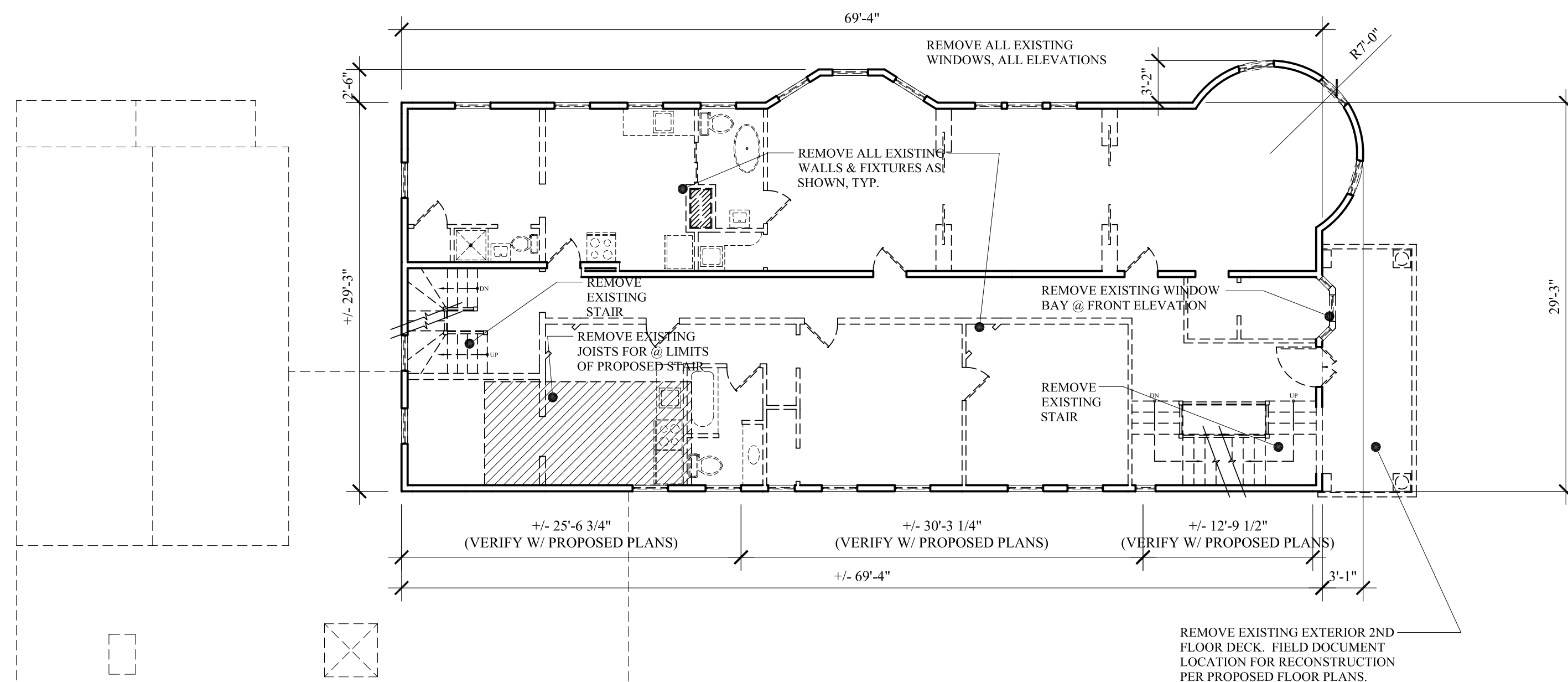

### SECOND FLOOR DEMO PLAN

SCALE: 1/8" = 1'-0"

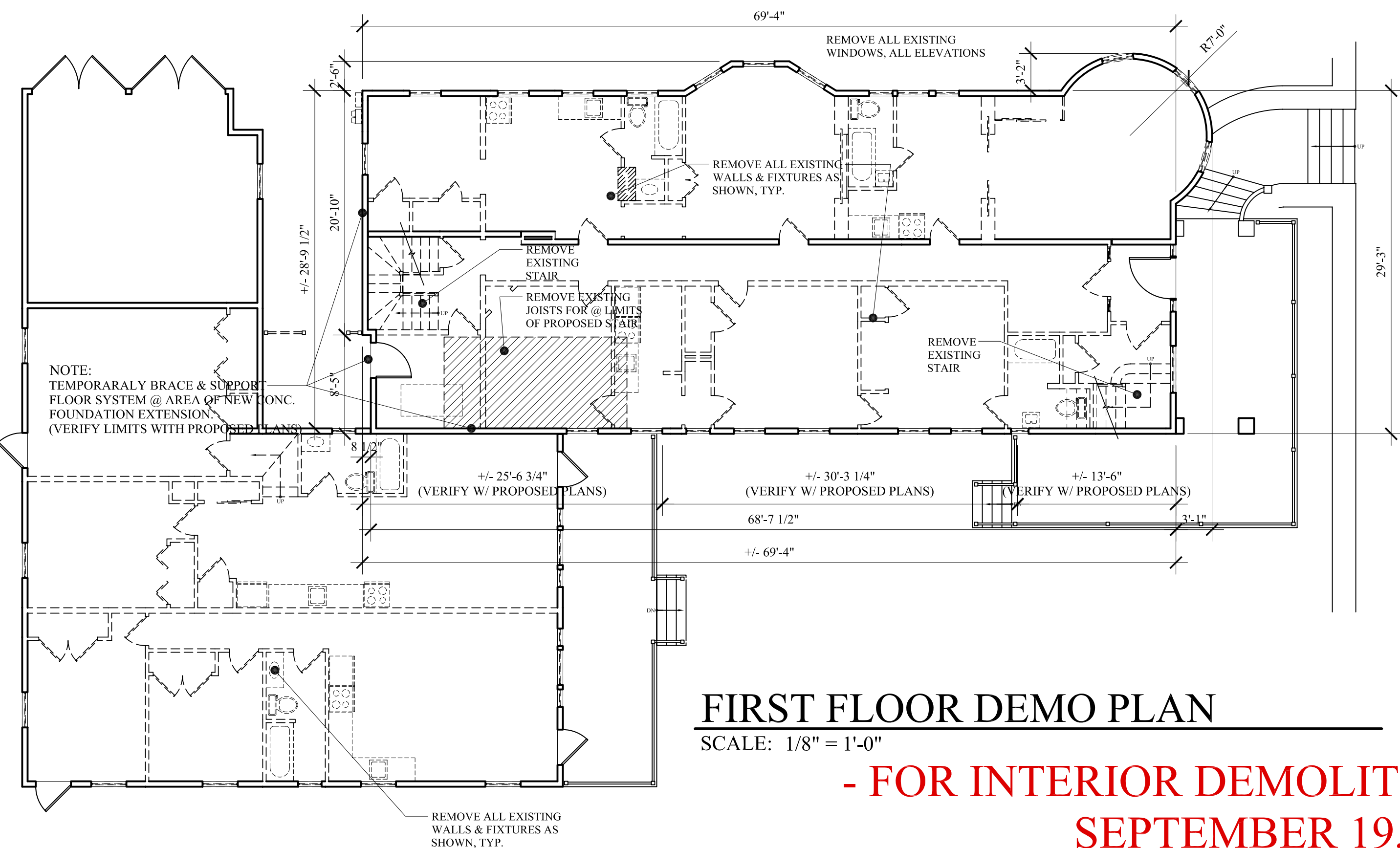

### FIRST FLOOR DEMO PLAN

SCALE: 1/8" = 1'-0"

**- FOR INTERIOR DEMOLITION -  
SEPTEMBER 19, 2013**

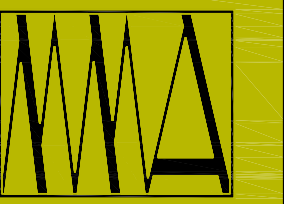

**MARK  
MUELLER  
ARCHITECTS**

A.I.A.

100 Commercial Street  
Suite 205  
Portland, Maine 04101  
Phone: 207.774.9057  
Email:  
rf@muellerarchitects.com

© COPYRIGHT 2013  
MARK MUELLER ARCHITECTS

PROPOSED RENOVATIONS @:  
**130 EASTERN PROMENADE**  
FOR: 130 EASTERN PROMENADE LLC  
110 MARGINAL WAY  
PORTLAND, MAINE 04101

DEMOLITION FLOOR PLANS

REVISIONS

DATE

02.24.2011

PROJECT

130 E. PROM

DRAWN BY

MFP

CHECK BY

MJM

D-1.1